

UNITED STATES
DEPARTMENT OF THE INTERIOR
BUREAU OF LAND MANAGEMENT

APPLICATION FOR PERMIT TO DRILL OR DEEPEN

1a. TYPE OF WORK

DRILL ☒DEEPEN ☐

95 NOV -6 PM 2:19

b. TYPE OF WELL

OIL
WELL ☐GAS
WELL ☒

OTHER

SINGLE ZONE ☒ FARMINGTON, NM

2. NAME OF OPERATOR

BHP Petroleum (Americas) Inc. 2217

3. ADDRESS AND TELEPHONE NO.

P. O. Box 977, Farmington, New Mexico, 87499, 505 - 327 - 1639

4. LOCATION OF WELL (Report location clearly and in accordance with any State requirements.)

At surface

790 ' FSL - 1720 ' FEL

At proposed prod. zone

same

14. DISTANCE IN MILES AND DIRECTION FROM NEAREST TOWN OR POST OFFICE*

4.0 miles southeast of Farmington, New Mexico

15. DISTANCE FROM PROPOSED*

LOCATION TO NEAREST
PROPERTY OR LEASE LINE, FT.
(Also to nearest drig. unit line, if any)

790 '

16. NO. OF ACRES IN LEASE

2561.19

17. NO. OF ACRES ASSIGNED
TO THIS WELL

160.37

18. DISTANCE FROM PROPOSED LOCATION*

TO NEAREST WELL, DRILLING, COMPLETED,
OR APPLIED FOR, ON THIS LEASE, FT.

120 '

19. PROPOSED DEPTH

1550 '

20. ROTARY OR CABLE TOOLS

Rotary

21. ELEVATIONS (Show whether DF, RT, GR, etc.)

5423 ' GR

22. APPROX. DATE WORK WILL START*

As soon as approved

This action is subject to technical and
procedural review pursuant to 43 CFR 3165.3

and appeal pursuant to 43 CFR 3165.4.

PROPOSED CASING AND CEMENTING PROGRAM SUBJECT TO COMPLIANCE WITH ATTACHED
GENERAL REQUIREMENTS

SIZE OF HOLE	GRADE SIZE OF CASING	WEIGHT PER FOOT	SETTING DEPTH	QUANTITY OF CEMENT
8.750 "	7.000 " - K55	20	130 '	59 cu. ft.
6.250 "	4.500 " - K55	10.5	1550 '	273.2 cu. ft.

BHP Petroleum (Americas) Inc. proposes to spud in the Nacimiento Formation. Will drill an 8 3/4 " hole to 130 feet. Run and cement surface casing with cement returns to surface. WOC 12 hours. Test casing and BOPE to 600 psig for 15 minutes. Drill a 6 1/4 " hole to 1550 ' using fresh water mud. No abnormal pressures or poisonous gases are anticipated. Adequate weight material will be on location to control any unforeseen flows from the Farmington sands. Run logs at TD. Run and cement production casing with cement returns to surface. WOC 12 hours. Move out drilling rig and move in completion unit. Pressure test production casing to 2500 psig for 15 minutes prior to perforating. Run cased hole correlation logs. Perforate Pictured Cliffs and stimulate with a fresh water base gel or foam system.

Surface ownership is Fee.

IN ABOVE SPACE DESCRIBE PROPOSED PROGRAM: If proposal is to deepen, give data on present productive zone and proposed new productive zone. If proposal is to drill or deepen directionally, give pertinent data on subsurface locations and measured and true vertical depths. Give blowout preventer program, if any.

24.

SIGNED

TITLE Operations Superintendent

DATE

11/3/95

(This space for Federal or State use)

PERMIT NO.

APPROVAL DATE

Application approval does not warrant or imply that the applicant holds legal or equitable title to those rights in the subject lease which would entitle the applicant to conduct operations thereon.

CONDITIONS OF APPROVAL, IF ANY:

APPROVED BY

TITLE

NMOC

*See Instructions On Reverse Side

APPROVED
AS AMENDED
DEC 08 1995
DISTRICT MANAGER

District II

District III

District IV

PO Box 2088, Santa Fe, NM 87504-2088

Form C-102
Revised February 21, 1994

Instructions on back

Submit to Appropriate District Office

State Lease - 4 Copies

Free Lease - 3 Copies

OIL CONSERVATION DIVISION
PO Box 2088
Santa Fe, NM 87504-2088

95 NOV -6 PM 2:19

☐ AMENDED REPORT

WELL LOCATION AND ACREAGE DEDICATION MAP

1 API Number 30-045-19322		2 Pool Code 79680		3 Pool Name West Kutz Pictured Cliffs	
4 Property Code 2038		5 Property Name GALLEGOS CANYON UNIT			6 Well Number 541
7 OGRID No. 2217		8 Operator Name BHP PETROLEUM (AMERICAS) INC.			9 Elevation 5423

¹⁰ Surface Location

UL or lot no.	Section	Township	Range	Lot Idn	Feet from the	North/South line	Feet from the	East/West line	County
0	21	29 N	12 W	12	790	South	1720	East	San Juan

" Bottom Hole Location If Different From Surface

Order lot no.	Section	Township	Range	Lot Idn	Feet from the	North/South line	Feet from the	East/West line	County
---------------	---------	----------	-------	---------	---------------	------------------	---------------	----------------	--------

¹² Dedicated Acres 160.37	¹³ Joint or Infill	¹⁴ Consolidation Code U	¹⁵ Order No.
---	-------------------------------	---------------------------------------	-------------------------

NO ALLOWABLE WILL BE ASSIGNED TO THIS COMPLETION UNTIL ALL INTERESTS HAVE BEEN CONSOLIDATED
OR A NON-STANDARD UNIT HAS BEEN APPROVED BY THE DIVISION

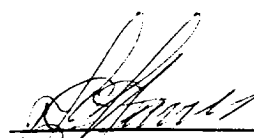
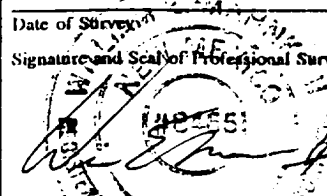
16 <i>N 89° 50' W</i> 39.81 CH 80.98 CH. NO° 50' E	39.81 CH 80.98 CH. Sec. 1	N 89° 37' W 39.78 CH. 80.96 CH. SF 078109	17 OPERATOR CERTIFICATION <p>I hereby certify that the information contained herein is true and complete to the best of my knowledge and belief.</p>  Signature J. C. Harris Printed Name Operations Superintendent Title <u>11/3/95</u> Date
RECEIVED DEC 12 1995 OIL COR. DIV. DIST. 3 S 89° 54' W	39.928 CH. 790' 39.952 CH.	17 SURVEYOR CERTIFICATION <p>I hereby certify that the well location shown on this plat was plotted from field notes of actual surveys made by me or under my supervision, and that the same is true and correct to the best of my belief.</p> <u>7 Sep. 1995</u> Date of Survey Signature and Seal of Professional Surveyer:  William G. Mahnke II Certificate Number— 8466	

New Mexico Oil Conservation Division

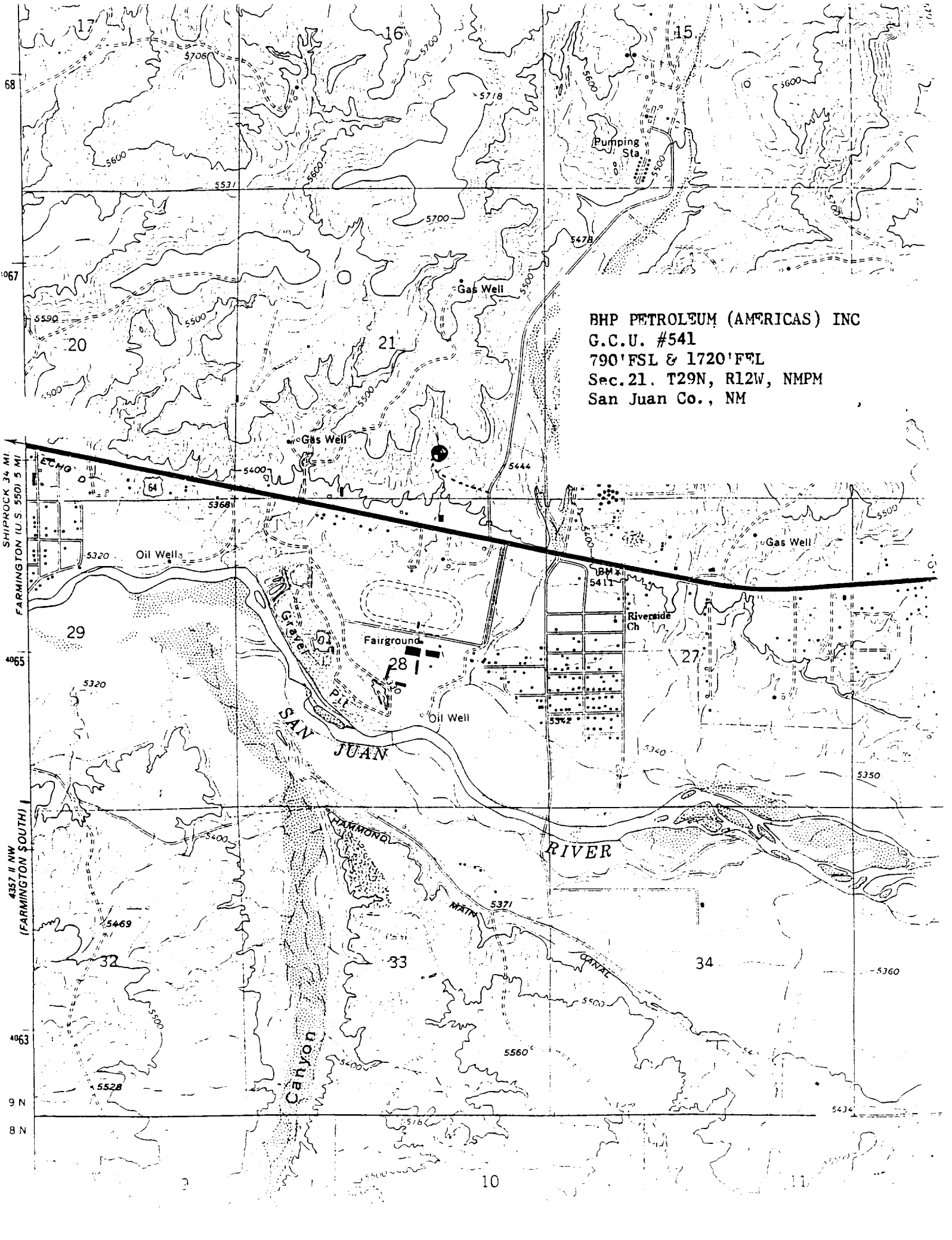

BHP PETROLEUM (AMERICAS) INC
G.C.U. #541
790' FSL & 1720' FFL
Sec. 21, T29N, R12W, NMPM
San Juan Co., NM

SHIPROCK 3.4 MI
FARMINGTON (U.S. 550) 5 MI
4357 II NW
(FARMINGTON SOUTH)
9 N
8 N