

STATE OF NEW MEXICO  
OIL CONSERVATION  
COMMISSION  
DISTRICT NO. 3  
Phone 99 P. O. Box 697  
AZTEC, NEW MEXICO

(SUBMIT IN TRIPLICATE)  
UNITED STATES  
DEPARTMENT OF THE INTERIOR  
GEOLOGICAL SURVEY

Santa Fe  
Land Office 079615  
Lease No.  
Unit

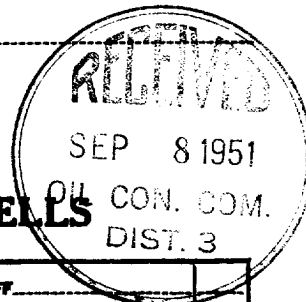

SUNDRY NOTICES AND REPORTS ON WELLS

NOTICE OF INTENTION TO DRILL	SUBSEQUENT REPORT OF WATER SHUT-OFF
NOTICE OF INTENTION TO CHANGE PLANS	SUBSEQUENT REPORT OF SHOOTING OR ACIDIZING
NOTICE OF INTENTION TO TEST WATER SHUT-OFF	SUBSEQUENT REPORT OF ALTERING CASING
NOTICE OF INTENTION TO RE-DRILL OR REPAIR WELL	SUBSEQUENT REPORT OF REDRILLING OR REPAIR
NOTICE OF INTENTION TO SHOOT OR ACIDIZE	SUBSEQUENT REPORT OF ABANDONMENT
NOTICE OF INTENTION TO PULL OR ALTER CASING	SUPPLEMENTARY WELL HISTORY
NOTICE OF INTENTION TO ABANDON WELL	

(INDICATE ABOVE BY CHECK MARK NATURE OF REPORT, NOTICE, OR OTHER DATA)

**Flourance** **September 7,** 19**51**  
Well No. **1-37** is located **1650** ft. from **(N)** line and **990** ft. from **(E)** line of sec. **6**  
**N. E. 1/4 Sec. 6** **T-30-N R-3-W** **NEPM**  
**Blanco** (No.) **San Juan** (Range) **New Mexico**  
(Field) (County or Subdivision) (State or Territory)

The elevation of the derrick floor above sea level is \_\_\_\_\_ ft. (Will be furnished later)

DETAILS OF WORK

(State names of and expected depths to objective sands; show sizes, weights, and lengths of proposed casings; indicate mudding jobs, cementing points, and all other important proposed work)

We propose to drill with rotary tools to the Cliffhouse Sand and set 7" casing, rotary tools will then be employed using gas to drill thru the Cliffhouse, Menafee and Peight Lookout for Moon Vards completion, well will then be shot with SNG.

Casing Program

100' - 13-3/8" Surface Casing - Circulate cement to surface  
2200' - 9-5/8" Intermediate String if found necessary - 200 sacks of cement.  
1300' - 7" 20# casing - 200 sacks of regular cement.  
1500' - 1.9" NEM RUE tubing.

(Designated drilling unit East 1/2 Section 6)

I understand that this plan of work must receive approval in writing by the Geological Survey before operations may be commenced.

**Leah Oil Corporation**  
Company \_\_\_\_\_  
P. O. Box 1175  
Address \_\_\_\_\_  
Farmington, New Mexico  
By **J. B. Howell**  
Superintendent  
Title \_\_\_\_\_

Land Office  
 Lease No.  
 Unit

(FURNISH IN TRIPLICATE)  
**UNITED STATES**  
**DEPARTMENT OF THE INTERIOR**  
**GEOLOGICAL SURVEY**

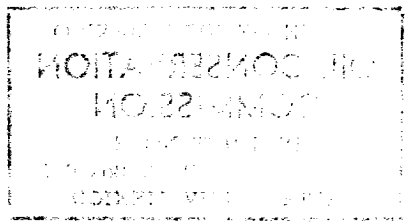

**SUNDRY NOTICES AND REPORTS ON WELLS**

REPORT OF INTENTION TO DRILL	SUBSEQUENT REPORT OF WATER SHUT-OFF
REPORT OF INTENTION TO CHANGE PLANS	SUBSEQUENT REPORT OF SHOOTING OR ACIDIZING
REPORT OF INTENTION TO TEST WATER SHUT-OFF	SUBSEQUENT REPORT OF ALTERING CASING
REPORT OF INTENTION TO REPAIR OR REPAIR WELL	SUBSEQUENT REPORT OF REPAIRING OR REPAIR
REPORT OF INTENTION TO SHUT OFF WELL	SUBSEQUENT REPORT OF ABANDONMENT
REPORT OF INTENTION TO RILL OF WATER CASING	SUBSEQUENT REPORT WELL HISTORY
REPORT OF INTENTION TO ABANDON WELL	

(INDICATE ABOVE BY CHECKING IN NATURE OF REPORT, NOTICE, OR OTHER DATA)

10

is located in the \_\_\_\_\_ line and \_\_\_\_\_ of sec \_\_\_\_\_  
 (Mileage) (Date)

\_\_\_\_\_ (Name of Landowner)  
 \_\_\_\_\_ (Name of Operator)  
 \_\_\_\_\_ (Name of Lessee)

**DETAILS OF WORK**

(This section is to be filled out by the operator of the well, and should contain a full and complete description of the work done, including the nature of the well, the location of the well, the nature of the work, the results of the work, and the cost of the work.)

\_\_\_\_\_

\_\_\_\_\_

Company \_\_\_\_\_

Address \_\_\_\_\_

By \_\_\_\_\_

Title \_\_\_\_\_

Company Delhi Oil Corporation

Santa Fe 078615A

Lease Florance Well No. 1-37

Sec. 6 T. 30 N., R. 8 W., N.M.P.M.

Location 1650' from the North line and 990'  
from the East line.

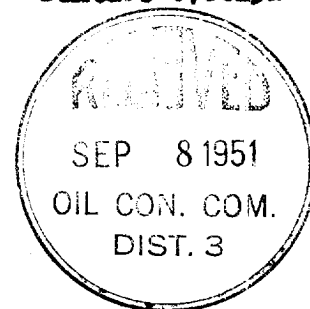

San Juan County

New Mexico

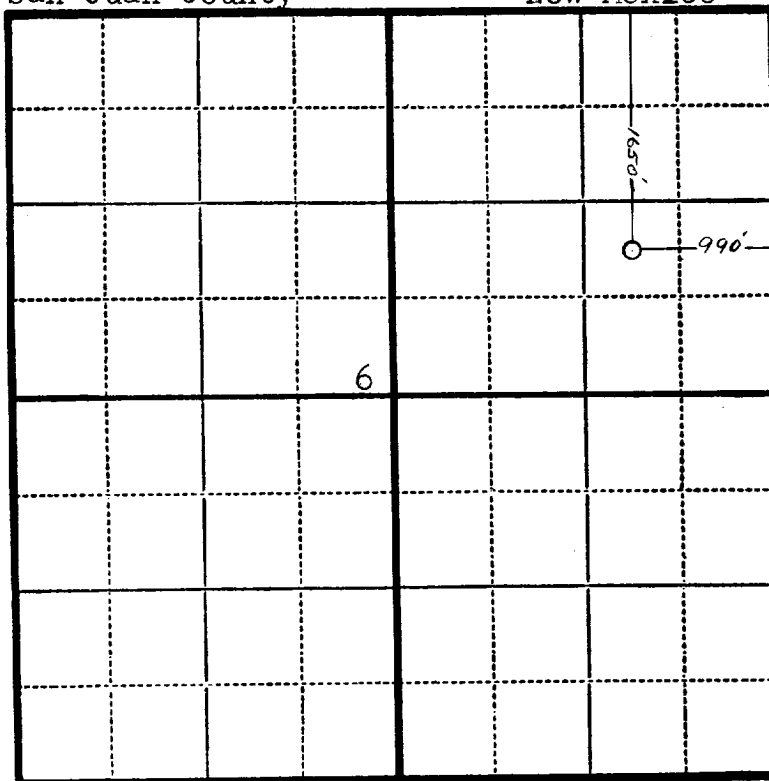

N  
|  
|  
|  
|  
|  
|  
|  
|  
|  
|

Scale—4 inches equals 1 mile.

This is to certify that the above plat was prepared from field notes of actual surveys made by me or under my supervision and that the same are true and correct to the best of my knowledge and belief.

Seal:

Registered Professional Charles J. Finklea  
Engineer and Land Surveyor. N. Mex. Reg. No. 1302

Surveyed August 17, 19 51