

NEW MEXICO OIL CONSERVATION COMMISSION
Santa Fe, New Mexico

Form C-101
Revised (12/1/55)

NOTICE OF INTENTION TO DRILL

Notice must be given to the District Office of the Oil Conservation Commission and approval obtained before drilling or recompletion begins. If changes in the proposed plan are considered advisable, a copy of this notice showing such changes will be returned to the sender. Submit this notice in QUINTUPPLICATE. One copy will be returned following approval. See additional instructions in Rules and Regulations of the Commission. If State Land submit 6 Copies Attach Form G- 128 in triplicate to first 3 copies of form C-101

Denver, Colorado

(Place)

August 28, 1958

(Date)

OIL CONSERVATION COMMISSION
SANTA FE, NEW MEXICO

Gentlemen:

You are hereby notified that it is our intention to commence the Drilling of a well to be known as

The Sharples Oil Corporation

(Company or Operator)

Gonzales

(Lease)

Well No. **1**

C

(Unit)

The well is

located **660** feet from the **North** line and **1980** feet from the

West

Projected 2*

line of Section

31N

1E

NMPM.

(GIVE LOCATION FROM SECTION LINE)

Wildcat

Pool,

Rio Arriba

County

If State Land the Oil and Gas Lease is No.

If patented land the owner is **M.A. & Consuelo B. Gonzales**

Address **Espanola, N. M.**

We propose to drill well with drilling equipment as follows: **Cable Tools**

The status of plugging bond is **in force until 2/6/59. \$10,000 blanket bond**

Drilling Contractor **Charles W. Branch, Jr.**

P. O. Box 953

Aztec, N. M.

We intend to complete this well in **xx any commercial** formation at an approximate depth of **50 to 1720** feet.

CASING PROGRAM

We propose to use the following strings of Casing and to cement them as indicated:

Size of Hole	Size of Casing	Weight per Foot	New or Second Hand	Depth	Sacks Cement
	13 3/8	-	Second Hand	40'	5 - 10 sx
6 1/4"	4 1/2	9.5#	New	1700	50-60 sx

If changes in the above plans become advisable we will notify you immediately.

ADDITIONAL INFORMATION (If recompletion give full details of proposed plan of work.)

* This location is projected from the West Boundry of the Tierra Amarilla Land Grant. Sharples has under lease approximately 7600 acres surrounding the location.

Approved.....
Except as follows:

8-29, 1958

Sincerely yours,

THE SHARPLES OIL CORPORATION

(Company or Operator)

By.....

Position **Petroleum Engineer**

Send Communications regarding well to

Name **The Sharples Oil Corporation**

Address **Suite 1001, 1700 Broadway, Denver 2, C.**

OIL CONSERVATION COMMISSION

By.....

NEW MEXICO OIL CONSERVATION COMMISSION
Well Location and Acreage Dedication Plat

Section A.

Date August 28, 1958

Operator Sharples Oil Corp. Lease Gonzales
Well No. 1 Unit Letter C Section 2 Township 31 N Range 1 E NMPN
Located 660 Feet From north Line, 1980 Feet From west Line
County Rio Arriba G. L. Elevation _____ Dedicated Acreage .40 Acres
Name of Producing Formation _____ Pool Wildcat

1. Is the Operator the only owner* in the dedicated acreage outlined on the plat below?
Yes X No _____.
2. If the answer to question one is "no," have the interests of all the owners been consolidated by communitization agreement or otherwise? Yes _____ No _____. If answer is "yes," Type of Consolidation _____
3. If the answer to question two is "no," list all the owners and their respective interests below:

Elevation will be furnished later

Owner

Land Description

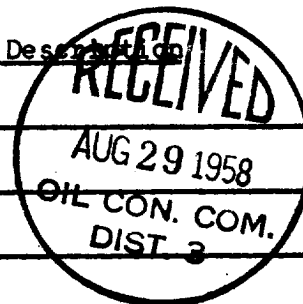

Section B

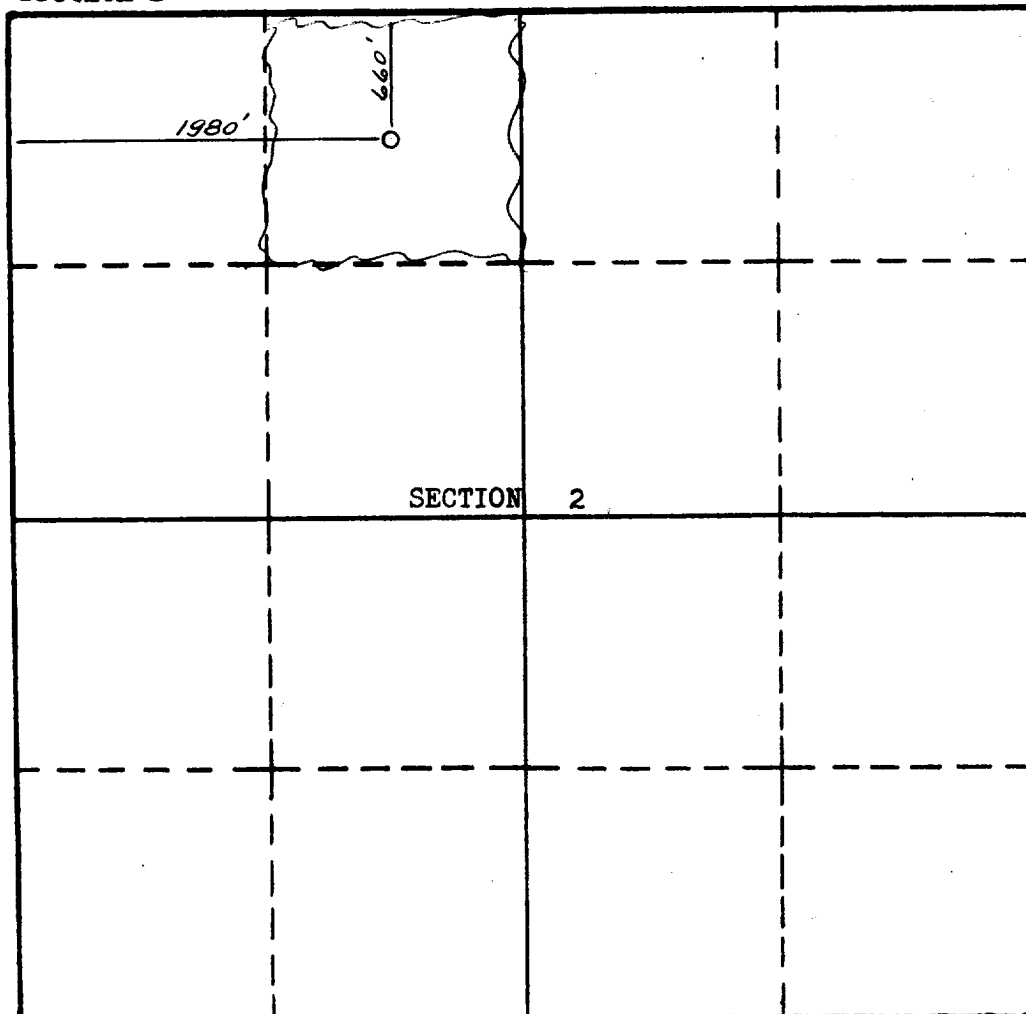

This is to certify that the information in Section A above is true and complete to the best of my knowledge and belief.

The Sharples Oil Corp.

(Operator)

Donald Brown
(Representative)

1700 Broadway
Denver 2, Colorado
Address

This is to certify that the well location shown on the plat in Section B was plotted from field notes of actual surveys made by me or under my supervision and that the same is true and correct to the best of my knowledge and belief.

Date Surveyed Aug 28, 1958

Stephen H. Minney
STEPHEN H. MINNEY

Registered Professional
Engineer and/or Land Surveyor

Certificate No. 803

WILDERNESS CONSERVATION COMMISSION		
AZTEC DISTRICT OFFICE		
No. Copies Received		
DISTRIBUTION		
	NO. FURNISHED	
Operator	1	
Santa Fe	1	
Operation Office		
State Land Office		
S. G. S.	2	
Transporter		
File	1	✓