

NEW MEXICO OIL CONSERVATION COMMISSION
Santa Fe, New Mexico

Form C-101
Revised (12/1/55)

NOTICE OF INTENTION TO DRILL

Notice must be given to the District Office of the Oil Conservation Commission and approval obtained before drilling or recompletion begins. If changes in the proposed plan are considered advisable, a copy of this notice showing such changes will be returned to the sender. Submit this notice in QUINTUPLICATE. One copy will be returned following approval. See additional instructions in Rules and Regulations of the Commission. If State Land submit 6 Copies Attach Form C-128 in triplicate to first 3 copies of form C-101

Denver, Colorado

September 24, 1958

(Place)

(Date)

OIL CONSERVATION COMMISSION
SANTA FE, NEW MEXICO

Gentlemen:

You are hereby notified that it is our intention to commence the Drilling of a well to be known as

The Sharples Oil Corporation

(Company or Operator)

Gonzales

(Lease)

2

P

(Unit)

The well is

located **330** feet from the **East** Projected line and **990** feet from the

South

Line of Section **11***, T. **31 N**, R. **1E**, NMPM.

(GIVE LOCATION FROM SECTION LINE)

Wildcat

Pool, **Rio Arriba** County

If State Land the Oil and Gas Lease is No.

If patented land the owner is **M. A. & Consuelo Gonzales**

Address **Espanola, N. M.**

We propose to drill well with drilling equipment as follows: **Cable Tools**

The status of plugging bond is **in force until 2/6/59 \$10,000**
Blanket Bond

Drilling Contractor **Charles W. Branch, Jr.**

P. O. Box 953

Aztec, New Mexico

We intend to complete this well in **xx Any commercial**
formation at an approximate depth of **50 to 1700** feet.

CASING PROGRAM

We propose to use the following strings of Casing and to cement them as indicated:

Size of Hole	Size of Casing	Weight per Foot	New or Second Hand	Depth	Sacks Cement
	13 3/8	-	New	40'	5-10 sx
6 1/4	4 1/2	9.5#	New	1700'	50-60 sx

If changes in the above plans become advisable we will notify you immediately.

ADDITIONAL INFORMATION (If recompletion give full details of proposed plan of work.)

- * This location is projected from the West Boundry of the Tierra Amarilla Land Grant. Sharples has under lease approximately 7600 acres surrounding the location.

Approved.....
Except as follows:

7-26, 19**58**

Sincerely yours,

THE SHARPLES OIL CORPORATION

(Company or Operator)

By.....

Position **Petroleum Engineer**

Send Communications regarding well to

Name **The Sharples Oil Corporation**

Address **1700 Broadway, Denver 2, Colo.**

OIL CONSERVATION COMMISSION

By.....

NEW MEXICO OIL CONSERVATION COMMISSION
Well Location and Acreage Dedication Plat

Section A.

Date Sept. 24, 1958

Operator SHARPLES OIL CORP. Lease GONZALES
Well No. 2 Unit Letter P Section 11 Township 31 N Range 1 E N.M.P.M.
Located 990 Feet From south Line, 330 Feet From east Line
County Rio Arriba G. L. Elevation 7497 Dedicated Acreage 40 Acres
Name of Producing Formation _____ Pool Wildcat

1. Is the Operator the only owner* in the dedicated acreage outlined on the plat below?
Yes X No _____.
2. If the answer to question one is "no," have the interests of all the owners been consolidated by communitization agreement or otherwise? Yes _____ No _____. If answer is "yes," Type of Consolidation _____
3. If the answer to question two is "no," list all the owners and their respective interests below:

Owner

Land Description

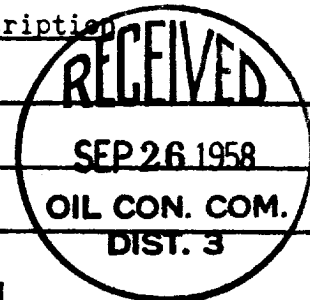

Section B

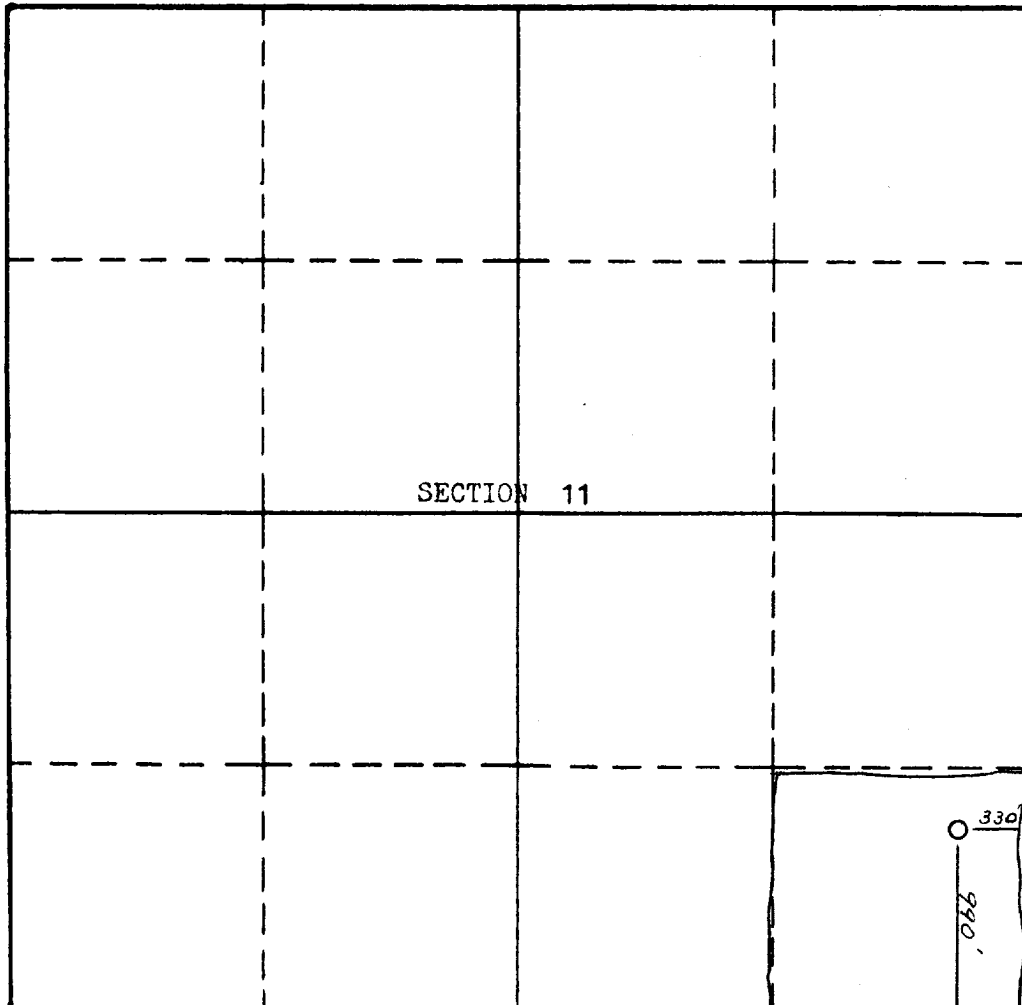

This is to certify that the information in Section A above is true and complete to the best of my knowledge and belief.

THE SHARPLES OIL CORP.

(Operator)

Donald H. Brown
(Representative)

1700 Broadway
Denver 2, Colo.

Address

This is to certify that the well location shown on the plat in Section B was plotted from field notes of actual surveys made by me or under my supervision and that the same is true and correct to the best of my knowledge and belief.

Date Surveyed Sept. 11, 1958

Stephen H. Kinn
STEPHEN H. KINN

Registered Professional
Engineer and/or Land Surveyor.

Certificate No. 803

(See instructions for completion of this form on the reverse side.)

OIL CONSERVATION COMMISSION

AZTEC DISTRICT OFFICE

No. Copies Received 5

DISTRIBUTION

	NO. FURNISHED	
Inspector	1	
County Engineer	1	
Population Office		
State Land Office		
U. S. G. S.		
Transporter		
File	1	✓