



COPY TO O. C. C.

IN REPLY REFER TO:

UNITED STATES
DEPARTMENT OF THE INTERIOR
GEOLOGICAL SURVEY
P. O. Box 965
Farmington, New Mexico

June 23, 1955

Pacific Northwest Pipe Line Corporation
413½ West Main Street
Farmington, New Mexico

Re: Santa Fe 078995
14-08-001-464

Gentlemen:

Receipt is acknowledged of your "Notice of Intention to Drill" dated June 13, 1955 covering your well No. 5-31 San Juan 31-6 Unit in NE¼ SW¼ sec. 31, T. 31 N., R. 6 W., N. M. P. M., Rio Arriba County, New Mexico, Blanco pool.

Your proposed work is hereby approved subject to compliance with the provisions of the "Oil and Gas Operating Regulations" revised May 25, 1947, a copy of which will be sent to you on request, and subject to the following conditions:

1. Drilling operations so authorized are subject to the attached sheet for general conditions of approval.
2. Furnish copies of all logs.

Very truly yours,

(Orig. Sgd.) A. P. KLEEMAN

A. P. Kleeman
Acting District Engineer

APK:leemantac



DEPARTMENT OF THE INTERIOR
BUREAU OF LAND SURVEY

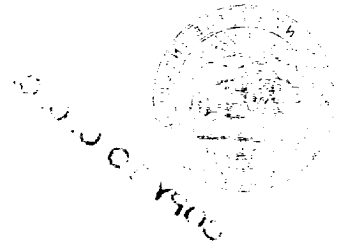

THE SECRETARY



7-9.8.0.0.
1-W.8. Johnston
1-File

Budget Bureau 42-R358.2.
Approval expires 12-31-52.

	X	

(SUBMIT IN TRIPLICATE)

UNITED STATES
DEPARTMENT OF THE INTERIOR
GEOLOGICAL SURVEY

Land Office Santa Fe
Lease No. 078995
Unit San Juan 31-6 Unit
14-03-001-464

SUNDRY NOTICES AND REPORTS ON WELLS

NOTICE OF INTENTION TO DRILL	<input checked="" type="checkbox"/>	SUBSEQUENT REPORT OF WATER SHUT-OFF	
NOTICE OF INTENTION TO CHANGE PLANS		SUBSEQUENT REPORT OF SHOOTING OR ACIDIZING	
NOTICE OF INTENTION TO TEST WATER SHUT-OFF		SUBSEQUENT REPORT OF ALTERING CASING	
NOTICE OF INTENTION TO RE-DRILL OR REPAIR WELL		SUBSEQUENT REPORT OF RE-DRILLING OR REPAIR	
NOTICE OF INTENTION TO SHOOT OR ACIDIZE		SUBSEQUENT REPORT OF ABANDONMENT	
NOTICE OF INTENTION TO PULL OR ALTER CASING		SUPPLEMENTARY WELL HISTORY	
NOTICE OF INTENTION TO ABANDON WELL			

(INDICATE ABOVE BY CHECK MARK NATURE OF REPORT, NOTICE, OR OTHER DATA)

Well No. 5-31 is located 1725 ft. from ND line and 1650 ft. from W line of sec. 31
31 (Sec. and Sec. No.) 31 (Twp.) 6 (Range) N. 15. E. 14 (Meridian)
Blanco (Field) Rio Arriba (County or Subdivision) New Mexico (State or Territory)

The elevation of the Ungraded Ground above sea level is 6201.27.

DETAILS OF WORK

(State names of and expected depths to objective sands; show sizes, weights, and lengths of proposed casings; indicate mudding jobs, cementing points, and all other important proposed work)

Drill 15" hole to 200', set 10-3/4" O.D. casing at that point and cement with 150 sq. 4% gel. cement. Drill with mud to approximately 3150, set 7-5/8" O.D. casing and cement with 150 sq. 8% gel. cement. Drill with gas from 3150 to top of Mesa Verde at approximately 5070'; set 5-1/2" casing and cement with 150 sq. 8% gel cement. Then drill the Mesa Verde formation with gas, sand frac the Point lookout and Cliff house separately with 10,000 gal. treatment, clean out well, run 2-3/8" tubing and complete well.

I understand that this plan of work must receive approval in writing by the Geological Survey before operations may be commenced.

Company PACIFIC NORTHWEST PIPELINE CORPORATION

Address 413-1/2 West Main Street

Farmington, New Mexico

By L. A. Ryan

Title Engineer

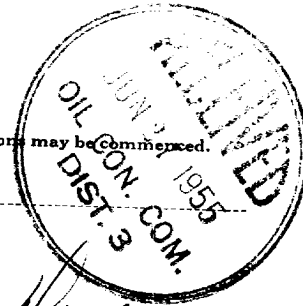

Company.....PACIFIC NORTHWEST PIPELINE CORPORATION

Lease..... Well No.....

Sec..... 31, T. 31 N., R. 6 W. N.M.P.M.....

Location..... 1725' from the South line and 1650' from
the West line.

Elevation..... 6201.27 Ungraded ground

Rio Arriba Co.

New Mexico

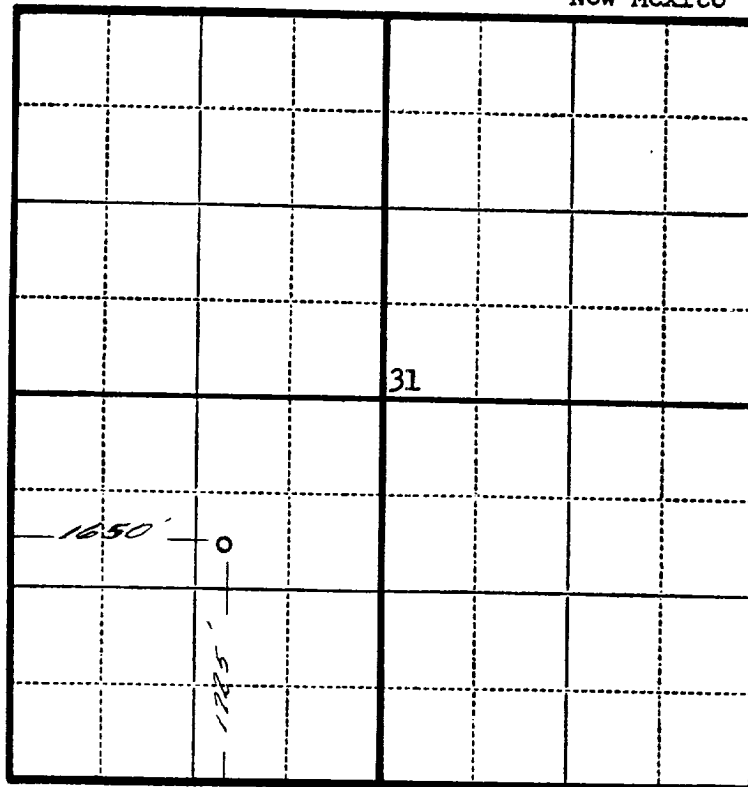

Scale—4 inches equal 1 mile.

This is to certify that the above plat was prepared from field notes of actual surveys made by me or under my supervision and that the same are true and correct to the best of my knowledge and belief.

Charles E. Walker

Seal:

Registered Professional
Engineer and Land Surveyor.

Surveyed June 7, 1955.