

UNITED STATES  
DEPARTMENT OF THE INTERIOR  
GEOLOGICAL SURVEY

**SUNDRY NOTICES AND REPORTS ON WELLS**

(Do not use this form for proposals to drill or to deepen or plug back to a different reservoir. Use Form 9-331-C for such proposals.)

1. oil well ☐ gas well ☒ other ☐  
2. NAME OF OPERATOR  
AMOCO PRODUCTION COMPANY  
3. ADDRESS OF OPERATOR  
501 AIRPORT DRIVE, FARMINGTON, NM 87401  
4. LOCATION OF WELL (REPORT LOCATION CLEARLY. See space 17 below.)  
AT SURFACE: 790' FNL x 790' FEL, Sec. 29,  
AT TOP PROD. INTERVAL: T-31-N, R-5-W  
AT TOTAL DEPTH:

16. CHECK APPROPRIATE BOX TO INDICATE NATURE OF NOTICE, REPORT, OR OTHER DATA

REQUEST FOR APPROVAL TO:	SUBSEQUENT REPORT OF:
TEST WATER SHUT-OFF <input type="checkbox"/>	<input type="checkbox"/>
FRACTURE TREAT <input type="checkbox"/>	<input type="checkbox"/>
SHOOT OR ACIDIZE <input type="checkbox"/>	<input type="checkbox"/>
REPAIR WELL <input type="checkbox"/>	<input type="checkbox"/>
PULL OR ALTER CASING <input type="checkbox"/>	<input type="checkbox"/>
MULTIPLE COMPLETE <input type="checkbox"/>	<input type="checkbox"/>
CHANGE ZONES <input type="checkbox"/>	<input type="checkbox"/>
ABANDON* <input type="checkbox"/>	<input type="checkbox"/>
(other) Location Change <input type="checkbox"/>	

17. DESCRIBE PROPOSED OR COMPLETED OPERATIONS (Clearly state all pertinent details, and give pertinent dates, including estimated date of starting any proposed work. If well is directionally drilled, give subsurface locations and measured and true vertical depths for all markers and zones pertinent to this work.)\*

The location for the above well has been re-staked from 1740' FNL x 790' FEL, Section 29, T31N, R-5-W, to 790' FNL x 790' FEL, Sec. 29, T31N, R5W. Attached are revised Survey Plat, Topographic Map showing planned access to new location, and Drill Site Specification Sheet. The only change to our Multi-Point Surface Use Plan is to Item 11, whereby vegetation also includes scattered cedar and pinon trees. The following is our revised casing program:

HOLE SIZE	CSG. SIZE	WEIGHT	SETTING DEPTH	CEMENT VOLUME
13-3/4"	10-3/4"	45#	300'	315 sx circ.
9-7/8"	7-5/8"	35#	3720'	1105 sx circ.
6-3/4"	4-1/2"	13.5#	8485'	885 sx circ.

Subsurface Safety Valve: Manu. and Type \_\_\_\_\_

18. I hereby certify that the foregoing is true and correct

SIGNED [Signature] TITLE Area Engineer DATE April 26, 1978

(This space for Federal or State office use)

APPROVED BY \_\_\_\_\_ TITLE \_\_\_\_\_ DATE \_\_\_\_\_  
CONDITIONS OF APPROVAL, IF ANY:

5. LEASE  
SF-079165 SF-078764  
6. IF INDIAN, ALLOTTEE OR TRIBE NAME  
7. UNIT AGREEMENT NAME  
Rosa Unit  
8. FARM OR LEASE NAME  
9. WELL NO.  
64  
10. FIELD OR WILDCAT NAME  
Basin Dakota  
11. SEC., T., R., M., OR BLK. AND SURVEY OR AREA  
NE/4 - NE/4 Section 29  
T-31-N, R-5-W  
12. COUNTY OR PARISH  
Rio Arriba  
13. STATE  
NM  
14. API NO.  
15. ELEVATIONS (SHOW DF, KDB, AND WD)  
6397' GL

(NOTE: Report results of multiple completion or zone change on Form 9-330.)

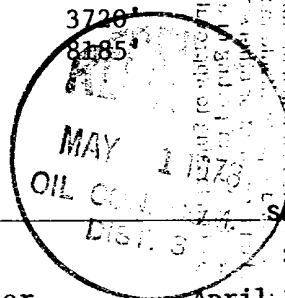

RECEIVED

APR 28 1978

U. S. GEOLOGICAL SURVEY  
DURANGO, COLO.

\*See Instructions on Reverse Side

54

Alkal

**NEW MEXICO OIL CONSERVATION COMMISSION  
WELL LOCATION AND ACREAGE DEDICATION PLAT**

Form C-102  
Supersedes C-128  
Effective 1-1-65

All distances must be from the outer boundaries of the Section.

Operator <b>AMOCO PRODUCTION COMPANY</b>			Lease <b>Rosa Unit</b>		Well No. <b>64</b>
Unit Letter <b>A</b>	Section <b>29</b>	Township <b>31N</b>	Range <b>5W</b>	County <b>Rio Arriba</b>	
Actual Footage Location of Well: <b>790</b> feet from the <b>North</b> line and <b>790</b> feet from the <b>East</b> line					
Ground Level Elev. <b>6397</b>	Producing Formation <b>Dakota</b>	Pool <b>Basin Dakota</b>		Dedicated acreage: <b>320</b> Acres	

1. Outline the acreage dedicated to the subject well by colored pencil or hachure marks on the plat below.
2. If more than one lease is dedicated to the well, outline each and identify the ownership thereof (both as to working interest and royalty).
3. If more than one lease of different ownership is dedicated to the well, have the interests of all owners been consolidated by communitization, unitization, force-pooling, etc?

☐ Yes    ☐ No    If answer is "yes," type of consolidation \_\_\_\_\_

If answer is "no," list the owners and tract descriptions which have actually been consolidated. (Use reverse side of this form if necessary.) \_\_\_\_\_

No allowable will be assigned to the well until all interests have been consolidated (by communitization, unitization, forced-pooling, or otherwise) or until a non-standard unit, eliminating such interests, has been approved by the Commission.

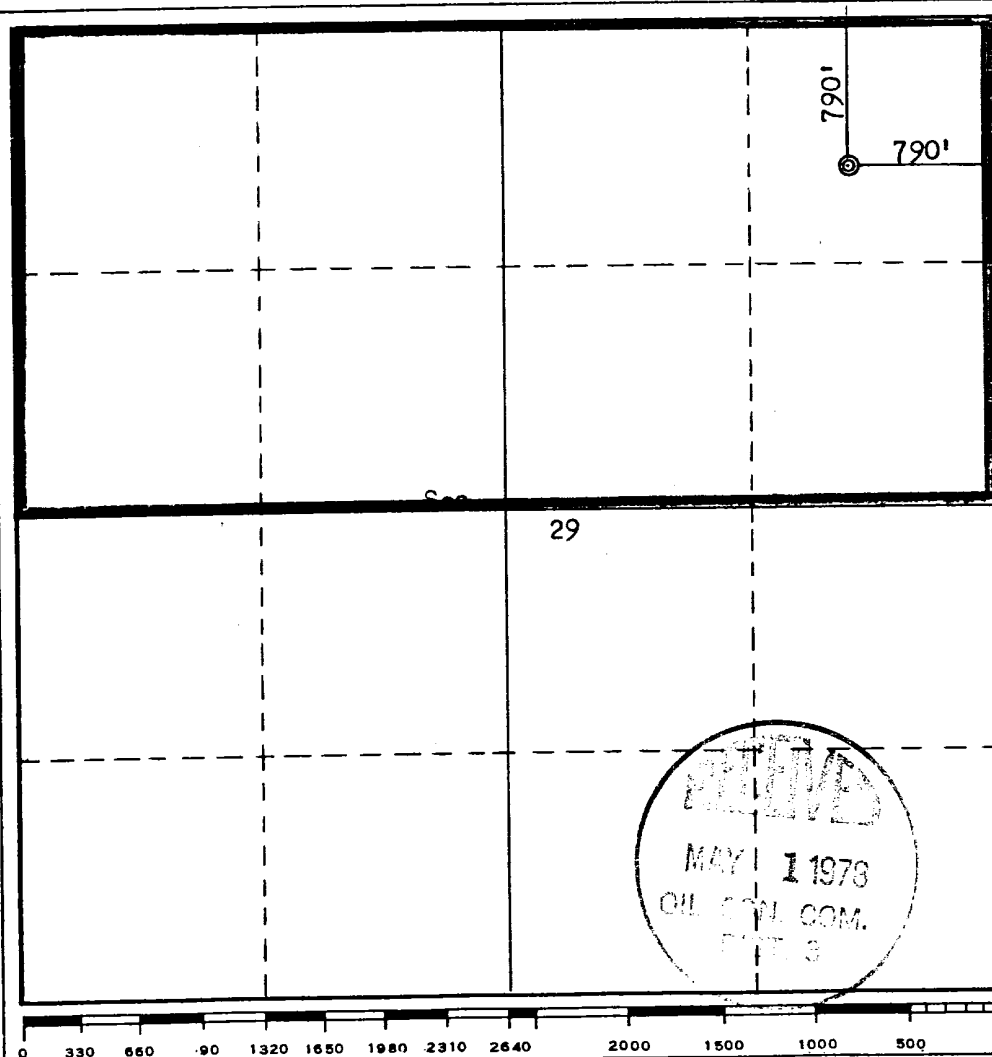

**CERTIFICATION**

I hereby certify that the information contained herein is true and complete to the best of my knowledge and belief.

Name  
**J. L. KRUPKA**

Position  
**AREA ENGINEER**

Company  
**AMOCO PRODUCTION COMPANY**

Date  
**APRIL 21, 1978**

I hereby certify that the well location shown on this plat was plotted from field notes of actual surveys made by me or under my supervision, and that the same is true and correct to the best of my knowledge and belief.

Date Surveyed  
**April 13, 1978**

Registered Professional Engineer and/or Land Surveyor

**Fred B. Kerr Jr.**

Certificate No.  
**3950**

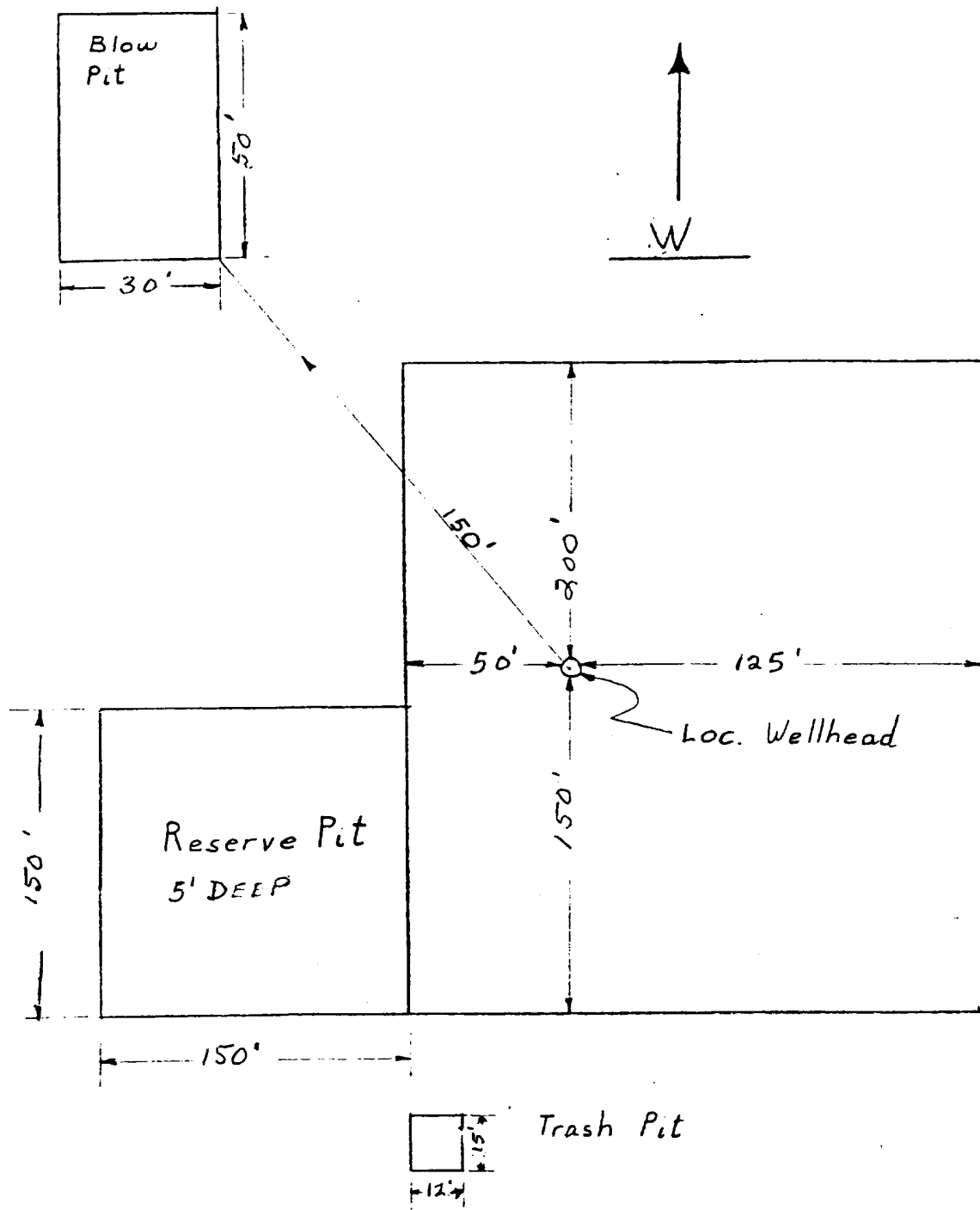

APPROXIMATELY 1.2 Acres

Amoco Production Company	SCALE: NONE
DRILLING LOCATION SPECS	
ROSA UNIT NO. 64	DRG. NO.

