

NO. OF COPIES RECEIVED	6
DISTRIBUTION	
SANTA FE	1
FILE	1
U.S.G.S.	2
LAND OFFICE	1
OPERATOR	1

# NEW MEXICO OIL CONSERVATION COMMISSION

Form C-101  
Revised 1-1-65

5A. Indicate Type of Lease	STATE <input checked="" type="checkbox"/> FEE <input type="checkbox"/>
5. State Oil & Gas Lease No.	E-347-26

## APPLICATION FOR PERMIT TO DRILL, DEEPEN, OR PLUG BACK

1a. Type of Work		7. Unit Agreement Name	
b. Type of Well OIL WELL <input type="checkbox"/> GAS WELL <input checked="" type="checkbox"/> OTHER <input type="checkbox"/>		San Juan 31-6 Unit	
DEEPEN <input type="checkbox"/> PLUG BACK <input type="checkbox"/>		8. Farm or Lease Name	
SINGLE ZONE <input checked="" type="checkbox"/> MULTIPLE ZONE <input type="checkbox"/>		San Juan 31-6 Unit	
2. Name of Operator		9. Well No.	
Northwest Pipeline Corporation		37	
3. Address of Operator		10. Field and Pool, or Wildcat	
P.O. Box 90, Farmington, New Mexico 87401		Basin Dakota	
4. Location of Well		11. Estimated Cost	
UNIT LETTER 0 LOCATED 1000' FEET FROM THE South LINE		\$272.89	
AND 900 FEET FROM THE East LINE OF SEC. 36 TWP. 31N RGE. 6W NMPM		12. County	
		Rio Arriba	
19. Proposed Depth		19A. Formation	
8010		Dakota	
20. Rotary or C.T.		21. Elevations (Show whether DF, RT, etc.)	
Rotary		6531' GR	
21A. Kind & Status Plug. Bond		21B. Drilling Contractor	
22. Approx. Date Work will start			
May 1, 1980			

## PROPOSED CASING AND CEMENT PROGRAM

SIZE OF HOLE	SIZE OF CASING	WEIGHT PER FOOT	SETTING DEPTH	SACKS OF CEMENT	EST. TOP
12-1/4"	9-5/8"	32.3#	350'	185	Surface
8-3/4"	7"	20#	3876'	175	Surface
6-1/4"	4-1/2"	11.6# & 10.5#	8010	350	Surface

Selectively perforate & stimulate the Dakota Formation.

A B.O.P. will be installed after the surface casing is set and cemented. All subsequent work will be conducted through B.O.P.'s.

The South half of Section 36 is dedicated to this well. Gas is dedicated.

APPROVAL VALID  
FOR 90 DAYS UNLESS  
DRILLING COMMENCED,

EXPIRES 5-28-80



IN ABOVE SPACE DESCRIBE PROPOSED PROGRAM: IF PROPOSAL IS TO DEEPEN OR PLUG BACK, GIVE DATA ON PRESENT PRODUCTIVE ZONE AND PROPOSED NEW PRODUCTIVE ZONE. GIVE BLOWOUT PREVENTER PROGRAM, IF ANY.

I hereby certify that the information above is true and complete to the best of my knowledge and belief.

Signed Paul C. Thompson Title Drilling Engineer Date 2-8-80  
(This space for State Use)

APPROVED BY Frank J. Chaff TITLE SUPERVISOR DISTRICT # 3 DATE FEB 28 1980

CONDITIONS OF APPROVAL, IF ANY:

write NW 1/4

All distances must be from the outer boundaries of the Section

Operator <b>NORTHWEST PIPELINE CORPORATION</b>			Lease <b>SAN JUAN 31-6 UNIT</b>		Well No. <b>37</b>
Unit Letter <b>0</b>	Section <b>36</b>	Township <b>31N</b>	Range <b>6W</b>	County <b>Rio Arriba</b>	
Actual Footage Location of Well:					
1000 feet from the South line and		900 feet from the East line			
Ground Level Elev. <b>6531</b>	Producing Formation <b>Dakota</b>	Pool <b>Basin Dakota</b>	Dedicated Acreage: <b>320272.89 Acres</b>		

1. Outline the acreage dedicated to the subject well by colored pencil or hatchure marks on the plat below.
2. If more than one lease is dedicated to the well, outline each and identify the ownership thereof (both as to working interest and royalty).
3. If more than one lease of different ownership is dedicated to the well, have the interests of all owners been consolidated by communitization, unitization, force-pooling, etc?

☒ Yes ☐ No If answer is "yes," type of consolidation \_\_\_\_\_ Unit \_\_\_\_\_

If answer is "no," list the owners and tract descriptions which have actually been consolidated. (Use reverse side of this form if necessary.) \_\_\_\_\_

No allowable will be assigned to the well until all interests have been consolidated (by communitization, unitization, forced-pooling, or otherwise) or until a non-standard unit, eliminating such interests, has been approved by the Commission.

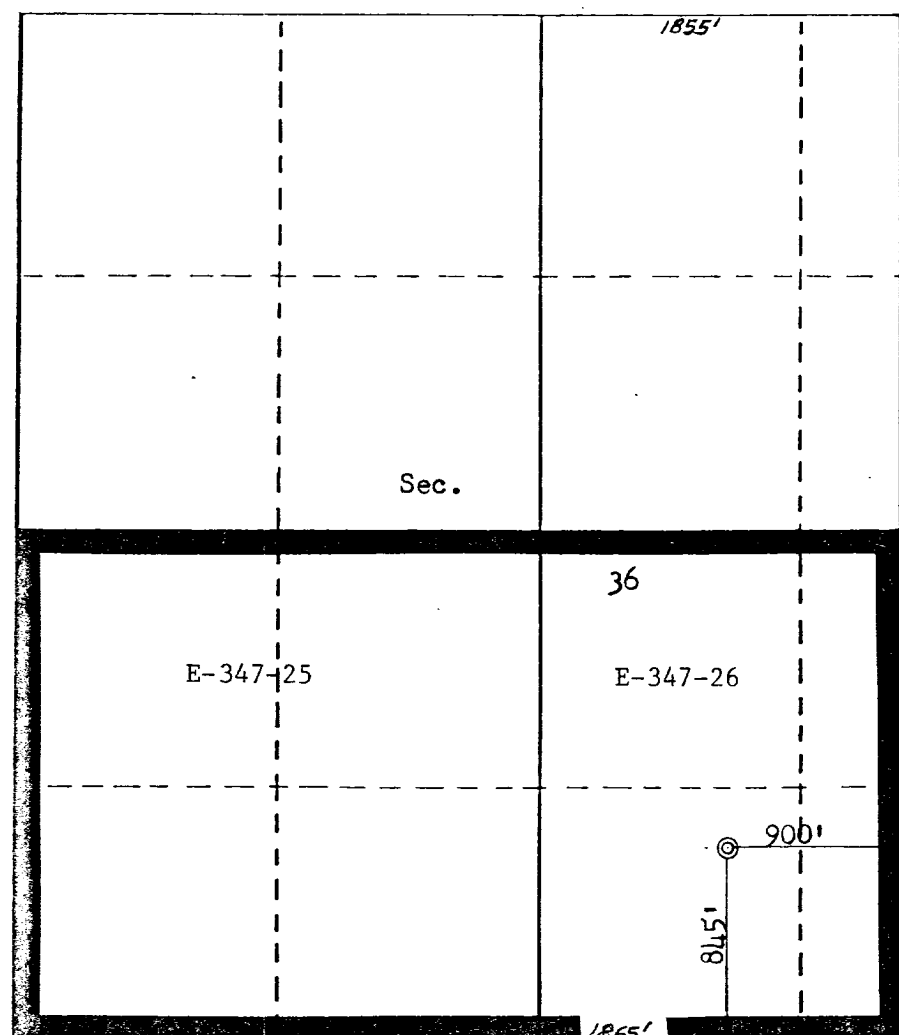

# CERTIFICATION

I hereby certify that the information contained herein is true and complete to the best of my knowledge and belief.

Name **Paul C. Thompson**  
Drilling Engineer

Position  
**Northwest Pipeline Co.**

Company  
**February 1, 1980**

Date  
*Paul C. Thompson*

I hereby certify that the well location shown on this plat was plotted from field notes of actual surveys made by me or under my supervision, and that the same is correct to the best of my knowledge and belief.

**RECEIVED**  
**FEB 28 1980**  
**OIL CON. COM.**  
**DIST. 3**

Date Surveyed  
**January 26, 1980**

Registered Professional Engineer  
and/or Land Surveyor  
**3950**

*Fred B. Kern*  
**Fred B. Kern**

Certificate No.  
**3950**