

NEW MEXICO OIL CONSERVATION COMMISSION
WELL LOCATION AND ACREAGE DEDICATION PLAT

Form C-372
Supersedes C-124
Effective 4-1-65

All distances must be from the outer boundaries of the Section.

Operator Resources Investment Corporation		Lease Rio Federal 35 35		Well No. 4 #1
Unit Letter D	Section 35	Township 31 North	Range 9 West	County Rio Arriba
Actual Footage Location of Well: 860 feet from the North line and 830 feet from the West line				
Ground Level Elev. 6964'	Producing Formation Mesa Verde	Pool Wildcat	Dedicated Acreage: 160 ACRES	

1. Outline the acreage dedicated to the subject well by colored pencil or hachure marks on the plat below.
2. If more than one lease is dedicated to the well, outline each and identify the ownership thereof (both as to working interest and royalty).
3. If more than one lease of different ownership is dedicated to the well, have the interests of all owners been consolidated by communitization, unitization, force-pooling, etc?

☐ Yes ☐ No If answer is "yes," type of consolidation **N/A**

If answer is "no," list the owners and tract descriptions which have actually been consolidated. (Use reverse side of this form if necessary.)

No allowable will be assigned to the well until all interests have been consolidated (by communitization, unitization, forced-pooling, or otherwise) or until a non-standard unit, eliminating such interests, has been approved by the Commission.

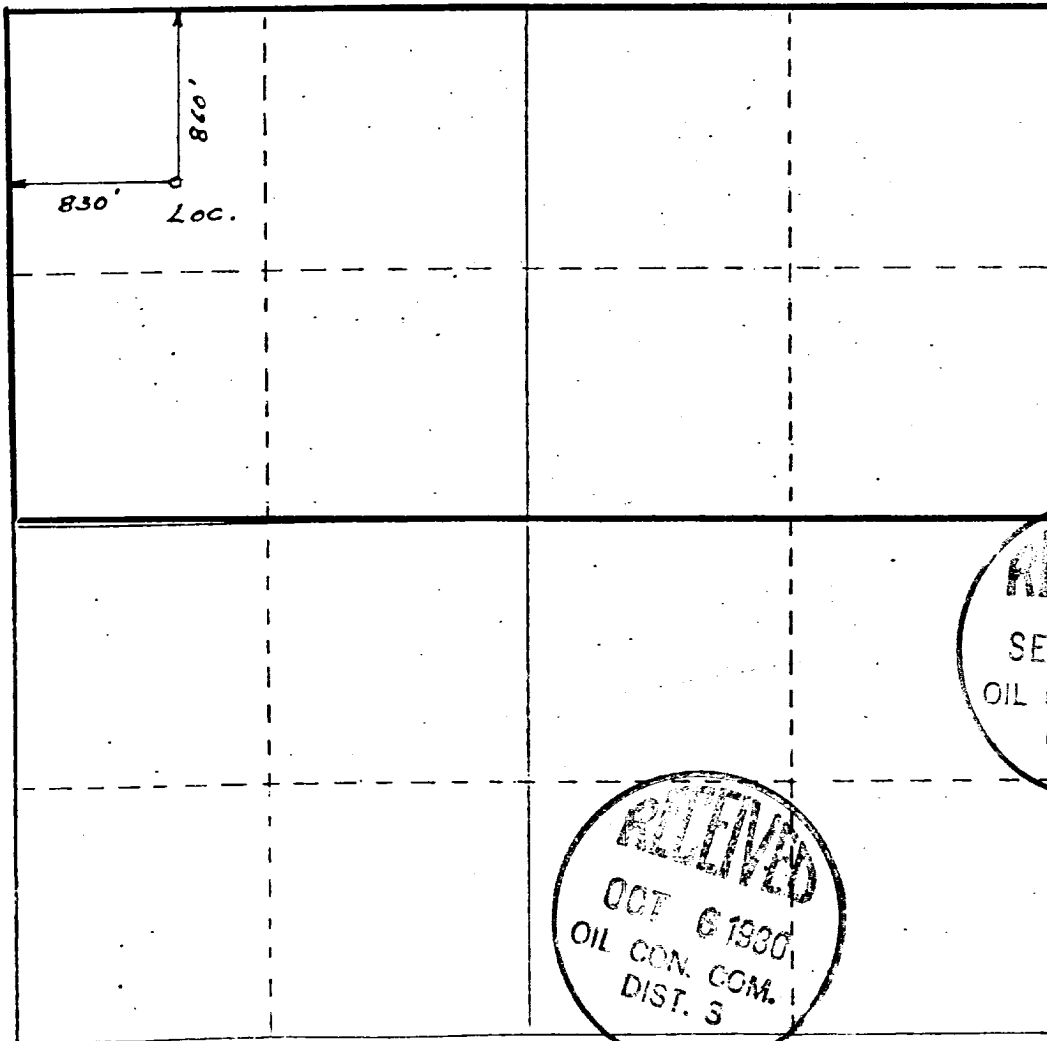

CERTIFICATION

I hereby certify that the information contained herein is true and complete to the best of my knowledge and belief.

Name **James A. L...**
Position **No. Dist. Drlg. & Prod. Mngr.**
Company **Resources Investment Corp.**
Date **10/1/80**

I hereby certify that the well location shown on this plat was plotted from field notes of actual surveys made by me or under my supervision, and that the same is true and correct to the best of my knowledge and belief.

Date Surveyed **10/1/80**
Registered Professional Engineer and Oil Well Surveyor **G. HUDDY**
Certificate No. **1000**

UNITED STATES
DEPARTMENT OF THE INTERIOR
GEOLOGICAL SURVEY

SUBMIT IN TRIPPLICATE*
(Other instructions on reverse side)

Form approved.
Budget Bureau No. 42-R1424.

SUNDRY NOTICES AND REPORTS ON WELLS

(Do not use this form for proposals to drill or to deepen or plug back to a different reservoir.
Use "APPLICATION FOR PERMIT" for such proposals.)

1. OIL WELL <input type="checkbox"/> GAS WELL <input checked="" type="checkbox"/> OTHER <input type="checkbox"/>		5. LEASE DESIGNATION AND SERIAL NO. NM 11929
2. NAME OF OPERATOR Resources Investment Corporation		6. IF INDIAN, ALLOTTEE OR TRIBE NAME None
3. ADDRESS OF OPERATOR 3500 Anaconda Tower, Denver, Colorado 80202		7. UNIT AGREEMENT NAME None
4. LOCATION OF WELL (Report location clearly and in accordance with any State requirements.* See also space 17 below.) At surface 360' FNL & 830' FWL		8. FARM OR LEASE NAME Rio Federal
14. PERMIT NO.		9. WELL NO. #1-35
15. ELEVATIONS (Show whether DF, RT, GR, etc.) 6964' GR		10. FIELD AND POOL, OR WILDCAT Wildcat
		11. SEC., T., R., M., OR BLK. AND SURVEY OR AREA Sec. 35 T31N R4W
		12. COUNTY OR PARISH Rio Arriba
		13. STATE New Mexico

18. Check Appropriate Box To Indicate Nature of Notice, Report, or Other Data

NOTICE OF INTENTION TO:		SUBSEQUENT REPORT OF:	
TEST WATER SHUT-OFF <input type="checkbox"/>	PULL OR ALTER CASING <input type="checkbox"/>	WATER SHUT-OFF <input type="checkbox"/>	REPAIRING WELLS <input type="checkbox"/>
FRACTURE TREAT <input type="checkbox"/>	MULTIPLE COMPLETE <input type="checkbox"/>	FRACTURE TREATMENT <input type="checkbox"/>	ALTERING CASING <input type="checkbox"/>
SHOOT OR ACIDIZE <input type="checkbox"/>	ABANDON* <input type="checkbox"/>	SHOOTING OR ACIDIZING <input type="checkbox"/>	ABANDONMENT* <input type="checkbox"/>
REPAIR WELL <input type="checkbox"/>	CHANGE PLANS <input type="checkbox"/>	(Other) Spud <input type="checkbox"/>	

(NOTE: Report results of multiple completion on Well Completion or Recompletion Report and Log form.)

17. DESCRIBE PROPOSED OR COMPLETED OPERATIONS (Clearly state all pertinent details, and give pertinent dates, including estimated date of starting any proposed work. If well is directionally drilled, give subsurface locations and measured and true vertical depths for all markers and zones pertinent to this work.)*

The above referenced well was spudded at 11:30 A.M. on 9/27/80. Finished building location. Drilled 20" hole to 20' and ran 24' of 15" diameter cond. pipe Cemented w/10 sx. Class "G" cement.

18. I hereby certify that the foregoing is true and correct
SIGNED [Signature] TITLE Northern District Drilling & Production Manager
DATE 10/6/80

(This space for Federal or State office use)

ACCEPTED FOR RECORD
APPROVED BY
CONDITIONS OF APPROVAL, IF ANY:

OCT 09 1980

BY [Signature] FARMINGTON DISTRICT

*See Instructions on Reverse Side

NAACCC