

THE APPLICATION OF NORTHWEST PIPELINE
CORPORATION FOR A DUAL COMPLETION

ORDER NO. MC-2909

ADMINISTRATIVE ORDER
OF THE OIL CONSERVATION DIVISION

Under the provisions of Rule 112-A Northwest Pipeline Corporation made application to the New Mexico Oil Conservation Division on July 23, 1981, for permission to dually complete its Rosa Unit Well No. 79 located in Unit K of Section 22, Township 31 North, Range 6 West, NMPM, Rio Arriba County, New Mexico, in such a manner as to permit production of gas from the Mesaverde Formation adjacent to the Blanco-Mesaverde Pool and the Basin-Dakota Pool.

NOW, on this 11th day of July, 1981, the Division Director finds:

1. That application has been filed under the provisions of Rule 112-A of the Division's Rules and Regulations;
2. That satisfactory information has been provided that all operators of offset acreage have been duly notified;
3. That no objections have been received within the waiting period as prescribed by said rule;
4. That the proposed dual completion will not cause waste nor impair correlative rights; and
5. That the mechanics of the proposed dual completion are feasible and consonant with good conservation practices.

IT IS THEREFORE ORDERED:

That the applicant herein, Northwest Pipeline Corporation, be and the same is hereby authorized to dually complete its Rosa Unit Well No. 79 located in Unit K of Section 22, Township 31 North, Range 6 West, NMPM, Rio Arriba County, New Mexico, in such a manner as to permit production of gas from the Mesaverde Formation adjacent to the Blanco-Mesaverde Pool and the Basin-Dakota Pool through parallel strings of tubing.

PROVIDED HOWEVER, That applicant shall complete, operate, and produce said well in accordance with the provisions of Rule 112-A.

PROVIDED FURTHER, That applicant shall take packer-leakage tests upon completion and annually thereafter.

IT IS FURTHER ORDERED: That jurisdiction of this cause is hereby retained for the entry of such further orders as the Division may deem necessary.

DONE at Santa Fe, New Mexico, on the day and year hereinabove designated.

STATE OF NEW MEXICO
OIL CONSERVATION DIVISION

JOE D. RAMEY
Division Director

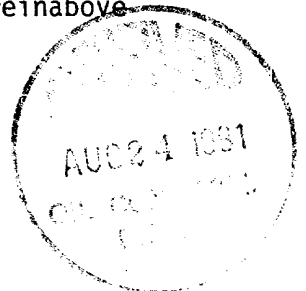

S E A L



STATE OF NEW MEXICO
ENERGY AND MINERALS DEPARTMENT

OIL CONSERVATION DIVISION
AZTEC DISTRICT OFFICE

1000 RIO BRAZOS ROAD
AZTEC, NEW MEXICO 87410
(505) 334-6172

OIL CONSERVATION DIVISION
BOX 2088
SANTA FE, NEW MEXICO 87501

DATE 5-19-81

RE: Proposed MC X
Proposed DHC _____
Proposed NSL _____
Proposed SWD _____
Proposed WFX _____
Proposed PMX _____

Gentlemen:

I have examined the application dated 5-18-81
for the M.P.C. Rosa Unit #79 K-22-31N-6W
Operator Lease and Well No. Unit, S-T-R

and my recommendations are as follows:

Approve

Yours truly,

Frank T. Chavez

NEW MEXICO OIL CONSERVATION COMMISSION
SANTA FE, NEW MEXICO
APPLICATION FOR MULTIPLE COMPLETION

Form C-107
5-1-61

Operator Northwest Pipeline Corporation		County Rio Arriba		Date 5/11/81
Address P.O. Box 90, Farmington, New Mexico		Lease Rosa Unit		Well No. #79
Location of Well	Unit K	Section 22	Townsh.p T31N	Range R6W

1. Has the New Mexico Oil Conservation Commission heretofore authorized the multiple completion of a well in these same pools or in the same zones within one mile of the subject well? YES _____ NO X
2. If answer is yes, identify one such instance: Order No. _____; Operator Lease, and Well No.: _____

3. The following facts are submitted:	Upper Zone	Intermediate Zone	Lower Zone
a. Name of Pool and Formation	Mesa Verde		Dakota
b. Top and Bottom of Pay Section (Perforations)	5282' to 5712'		7772' to 7831'
c. Type of production (Oil or Gas)	Gas		Gas
d. Method of Production (Flowing or Artificial Lift)	Flowing		Flowing

4. The following are attached. (Please check YES or NO)

- | | | |
|-------------------------------------|-------------------------------------|---|
| Yes | No | |
| <input checked="" type="checkbox"/> | <input type="checkbox"/> | a. Diagrammatic Sketch of the Multiple Completion, showing all casing strings, including diameters and setting depths, centralizers and/or turbolizers and location thereof, quantities used and top of cement, perforated intervals, tubing strings, including diameters and setting depth, location and type of packers and side door chokes, and such other information as may be pertinent. |
| <input checked="" type="checkbox"/> | <input type="checkbox"/> | b. Plat showing the location of all wells on applicant's lease, all offset wells on offset leases, and the names and addresses of operators of all leases offsetting applicant's lease. |
| <input checked="" type="checkbox"/> | <input type="checkbox"/> | c. Waivers consenting to such multiple completion from each offset operator, or in lieu thereof, evidence that said offset operators have been furnished copies of the application.* |
| <input type="checkbox"/> | <input checked="" type="checkbox"/> | d. Electrical log of the well or other acceptable log with tops and bottoms of producing zones and intervals of perforation indicated thereon. (If such log is not available at the time application is filed it shall be submitted as provided by Rule 112-A.) |

5. List all offset operators to the lease on which this well is located together with their correct mailing address.

CIG Exploration - P.O. Box 749, 2100 Prudential Plaza, Denver, Colo 80201

Wiser Oil Co. - P.O. Box 2467, Hobbs, New Mexico 88240

Phillips Petroleum - Attn: Mr. Gordon Buchman, 7800 E. Dorado Place, Englewood, Colo 80111

6. Were all operators listed in Item 5 above notified and furnished a copy of this application? YES X NO _____. If answer is yes, give date of such notification _____.

CERTIFICATE: I, the undersigned, state that I am the Drilling Engineer of the Northwest Pipeline Corporation (company), and that I am authorized by said company to make this report; and that this report was prepared under my supervision and direction and that the facts stated therein are true, correct and complete to the best of my knowledge.

M. J. Turnbaugh
M.J. Turnbaugh Signature

*Should waivers from all offset operators not accompany an application for administrative approval, the New Mexico Oil Conservation Commission will hold the application for a period of twenty (20) days from date of receipt by the Commission's Santa Fe office. If, after said twenty-day period, no protest nor request for hearing is received by the Santa Fe office, the application will then be processed.

NOTE: If the proposed multiple completion will result in an unorthodox well location and/or a non-standard proration unit in one or more of the producing zones, then separate application for approval of the same should be filed simultaneously with this application.

Rosa #79

10 3/4", 40.5#, K55, STJ set @ 373'

Cmtd. w/ 375 sk. CI 8" w/ 1/4" sleeve 7 3/4% Cactz.
Circ. out 2 0613. cmt.

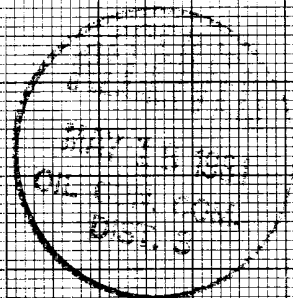

7 5/8", 26.4#, K55, STJ set @ 3750'

Cmtd. w/ 180 sk. CI 8" 65/35 poz. w/ 12% gel.
Tailed w/ 75 sk. CI 8" w/ 2% Cactz

1 1/4", 2.33#, J55, I-J set @ 5420' (production tubing)

5282
30
holes
5712

Baker model "D" production pkr @ 5870'

1 1/2", 2.89#, J55, I-J set @ 7304' (production tubing)

7712' to 7831' perforated w/ 64 holes.

5 1/2", 17#, N80 LTJ set @ 7895'

Cmtd. w/ 220 sk. CI 8" w/ 8% gel 1 1/2" sine filter sk 0.4% HR4
Tailed w/ 100 sk. CI 8" w/ 1/4" sine filter plug / sk.
Top as cmt. @ 5700'

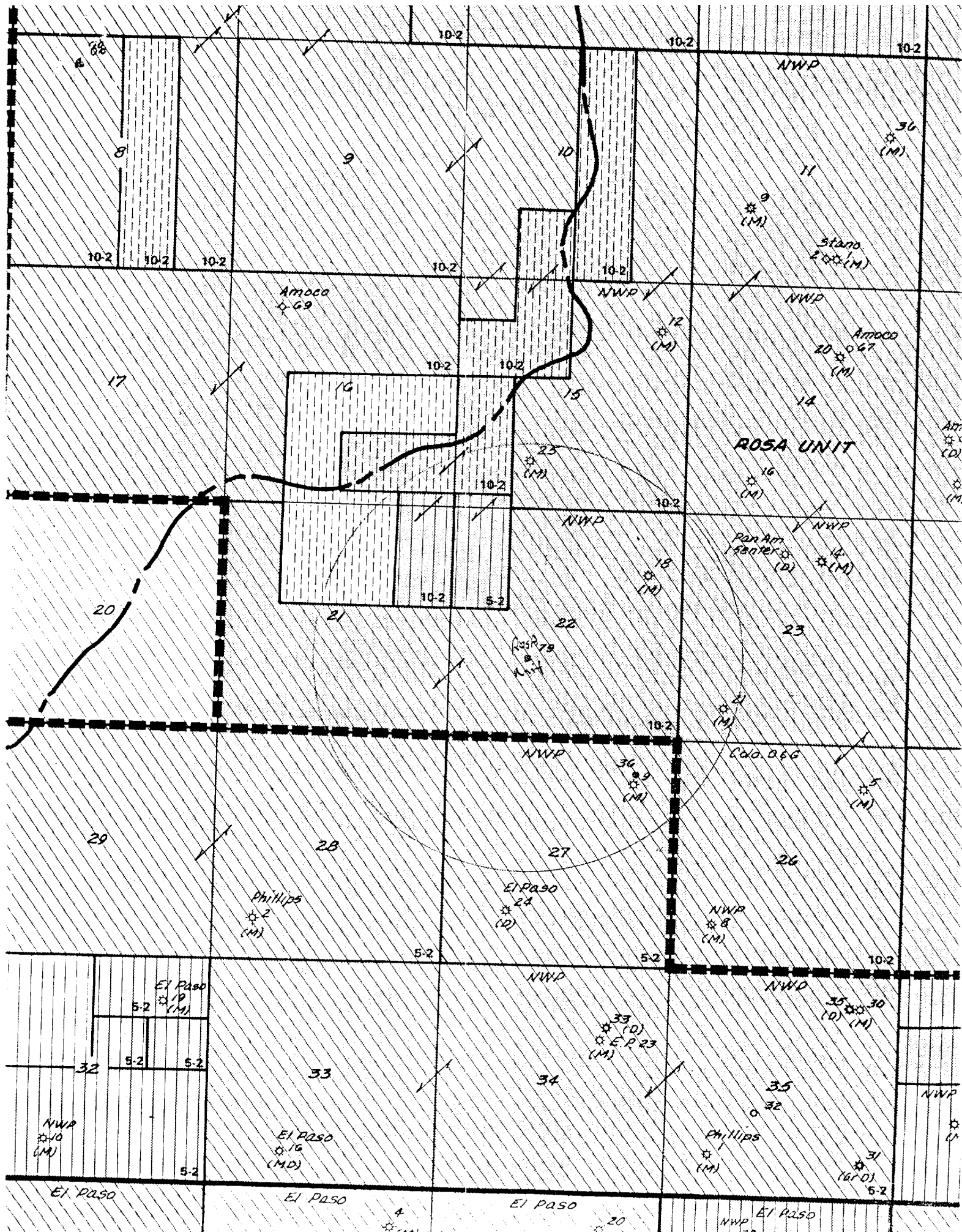

Rosa #79

Phillips Petroleum Co.
7800 East Dorado Place
Englewood, Colo 80111



Amoco Prod. Company
1670 Boradway Suite 750
Amoco Bldg
Denver, Colo 80202

PS Form 3800, Nov. 1976

CERTIFIED MAIL	
POSTAGE	\$
CERTIFIED FEE	\$
REGISTERED MAIL FEE	\$
INSURANCE FEE	\$
POSTAGE AND FEES	\$
TOTAL POSTAGE AND FEES	\$
POSTMARK	

P26 1797011

Rosa #79

CIG Exploration Inc.
P.O. Box 749
Denver, Colo 80201

PS Form 3800, Nov. 1976

CERTIFIED MAIL	
POSTAGE	\$
CERTIFIED FEE	\$
REGISTERED MAIL FEE	\$
INSURANCE FEE	\$
POSTAGE AND FEES	\$
TOTAL POSTAGE AND FEES	\$
POSTMARK	

RECEIPT FOR CERTIFIED MAIL

NO POSTAGE AND FEES PROVIDED—
FOR INTERNATIONAL MAIL
(See Reverse)

Rosa #79

Wiser Oil Company
P.O. Box 2467
Hobbs, New Mexico 88240

PS Form 3800, Nov. 1976

CERTIFIED MAIL	
POSTAGE	\$
CERTIFIED FEE	\$
REGISTERED MAIL FEE	\$
INSURANCE FEE	\$
POSTAGE AND FEES	\$
TOTAL POSTAGE AND FEES	\$
POSTMARK	

