

**UNITED STATES
DEPARTMENT OF THE INTERIOR
GEOLOGICAL SURVEY**

(Other instructions on reverse side)

30-039-22751

3. LEASE DESIGNATION AND SERIAL NO.

SF - 078995

6. IF INDIAN, ALLOTTEE OR TRIBE NAME

APPLICATION FOR PERMIT TO DRILL, DEEPEN, OR PLUG BACK

1a. TYPE OF WORK

DRILL ☒DEEPEN ☐PLUG BACK ☐

b. TYPE OF WELL

OIL WELL ☐GAS WELL ☒OTHER ☐SINGLE ZONE ☒MULTIPLE ZONE ☐

7. UNIT AGREEMENT NAME

San Juan 31-6 Unit

8. FARM OR LEASE NAME

San Juan 31-6 Unit

9. WELL NO.

#28

10. FIELD AND POOL, OR WILDCAT

Basin Dakota

11. SEC. T. R. M. OR BLK. AND SURVEY OR AREA

Sec 34, T31N, R6W

12. COUNTY OR PARISH 13. STATE

Rio Arriba New Mexico

2. NAME OF OPERATOR

Northwest Pipeline Corporation

3. ADDRESS OF OPERATOR

P.O. Box 90, Farmington, N.M. 87401

4. LOCATION OF WELL (Report location clearly and in accordance with any State requirements.)

At surface

1660' FSL & 1520' FWL Sec 34, T31N, R6W

At proposed prod. zone

Same as above

14. DISTANCE IN MILES AND DIRECTION FROM NEAREST TOWN OR POST OFFICE*

15 Miles East of Navajo Dam Post Office

15. DISTANCE FROM PROPOSED*

LOCATION TO NEAREST PROPERTY OR LEASE LINE, FT. (Also to nearest well, unit No., if any)

980'

16. NO. OF ACRES IN LEASE

N/A

17. NO. OF ACRES ASSIGNED TO THIS WELL

5/320

18. DISTANCE FROM PROPOSED LOCATION* TO NEAREST WELL, DRILLING COMPLETED, OR APPLIED FOR, ON THIS LEASE, FT.

3000'

19. PROPOSED DEPTH

8050'

20. ROTARY OR CABLE TOOLS

Rotary

21. ELEVATIONS (Show whether DF, RT, GR, etc.)

6459' GR

DRILLING OPERATIONS AUTHORIZED ARE
ON THIS LEASE AND ADJACENT

22. APPROX. DATE WORK WILL START*

July 1981

23.

PROPOSED CASING AND CEMENTING PROGRAM (See 11, 12, 13, 14, 15, 16, 17, 18, 19, 20, 21, 22, 23, 24, 25, 26, 27, 28, 29, 30, 31, 32, 33, 34, 35, 36, 37, 38, 39, 40, 41, 42, 43, 44, 45, 46, 47, 48, 49, 50, 51, 52, 53, 54, 55, 56, 57, 58, 59, 60, 61, 62, 63, 64, 65, 66, 67, 68, 69, 70, 71, 72, 73, 74, 75, 76, 77, 78, 79, 80, 81, 82, 83, 84, 85, 86, 87, 88, 89, 90, 91, 92, 93, 94, 95, 96, 97, 98, 99, 100)

SIZE OF HOLE	SIZE OF CASING	WEIGHT PER FOOT	SETTING DEPTH	QUANTITY OF CEMENT
12-1/4"	9-7/8"	36#	350'	195 cu. ft.
8-3/4"	7"	20#	3800'	355 cu. ft.
6-1/4"	4-1/2"	10.5# & 11.6#	8050'	700 cu. ft.

Selectively perforate and stimulate the Dakota Formation.
Completion plans will be determined at Total Depth

A BOP will be installed after the surface casing is set and cemented. All subsequent work will be conducted through the BOP's

The ~~West~~ half of Section 34 is dedicated to this well.

Gas is dedicated

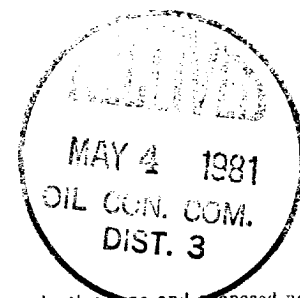

IN ABOVE SPACE DESCRIBE PROPOSED PROGRAM: If proposal is to deepen or plug back, give data on present productive zone and proposed new productive zone. If proposal is to drill or deepen directionally, give pertinent data on subsurface locations and measured and true vertical depths. Give blowout prevention program, if any.

24.

SIGNED

Paul C. Thompson

TITLE Drilling Engineer

DATE

4-9-81

(This space for Federal or State office use)

PERMIT NO.

APPROVAL DATE

APPROVED BY

TITLE

CONDITIONS OF APPROVAL, IF ANY:

*See Instructions On Reverse Side

APPROVED
AS AMENDEDAPR 30 1981
JAMES F. SMITH
DISTRICT ENGINEER

OIL CONSERVATION

P. O. BOX 2088

SANTA FE, NEW MEXICO 87501

Form C-107
Revised 10-1-78STATE OF NEW MEXICO
MINERALS DEPARTMENT

All distances must be from the outer boundaries of the Section.

Operator: NORTHWEST PIPELINE CORPORATION			Lease SAN JUAN 31-6 UNIT		Well No. 28
Unit Letter K	Section 34	Township 31N	Range 6W	County Rio Arriba	
Actual Footage Location of Well: 1660 feet from the South line and 1520 feet from the West line					
Ground Level Elev: 6459	Producing Formation Dakota	Pool Basin Dakota		Dedicated Acreage: 320	Acres

1. Outline the acreage dedicated to the subject well by colored pencil or hatchure marks on the plat below.

2. If more than one lease is dedicated to the well, outline each and identify the ownership thereof (both as to working interest and royalty).

3. If more than one lease of different ownership is dedicated to the well, have the interests of all owners been consolidated by communitization, unitization, force-pooling, etc?

☒ Yes ☐ No If answer is "yes," type of consolidation Unitization

If answer is "no," list the owners and tract descriptions which have actually been consolidated. (Use reverse side of this form if necessary.)

No allowable will be assigned to the well until all interests have been consolidated (by communitization, unitization, forced-pooling, or otherwise) or until a non-standard unit, eliminating such interests, has been approved by the Commission.

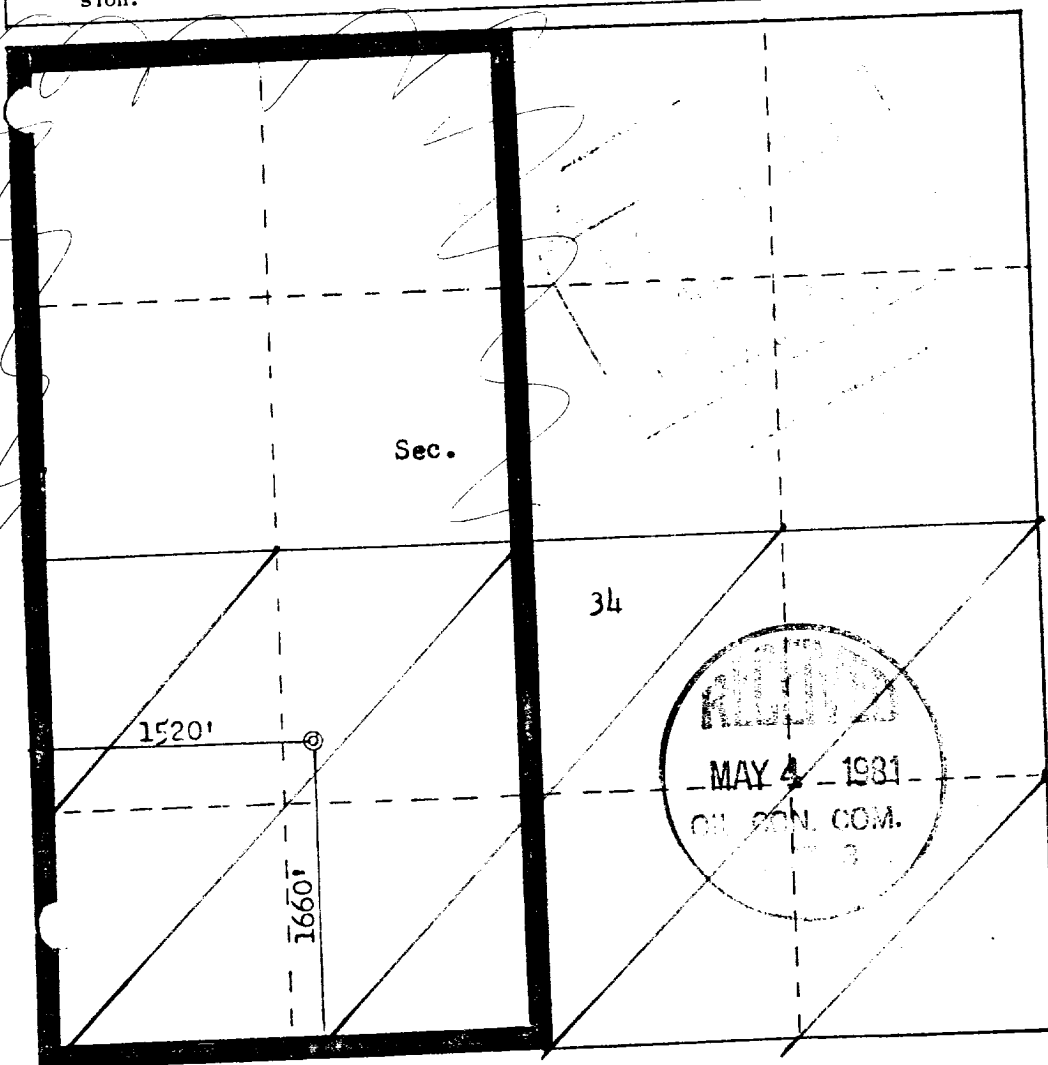

Scale: 1"=1000'

CERTIFICATION

I hereby certify that the information contained herein is true and complete to the best of my knowledge and belief.

Paul C. Thompson

Name

Paul C. Thompson

Position

Drilling Engineer

Company

Northwest Pipeline Corp

Date

2-19-81

I hereby certify that the well location shown on this plat was plotted from field notes of actual surveys made by me or under my supervision, and that the same is true and correct to the best of my knowledge and belief.

Date Surveyed

February 14, 1981

Registered Professional Engineer
and Land Surveyor*Fred B. Kerr Jr.*
Fred B. Kerr Jr.

Certificate No. Mexico

3950

FORM 24-11