

UNITED STATES  
DEPARTMENT OF THE INTERIOR  
GEOLOGICAL SURVEY

Form Approved.  
Budget Bureau No. 42-R1424

SUNDRY NOTICES AND REPORTS ON WELLS  
(Do not use this form for proposals to drill or to deepen or plug back to a different reservoir. Use Form 9-331-C for such proposals.)

1. oil ☐ well gas ☒ well other ☐
2. NAME OF OPERATOR  
Northwest Pipeline Corporation
3. ADDRESS OF OPERATOR  
P.O. Box 90, Farmington, N.M. 87499
4. LOCATION OF WELL (REPORT LOCATION CLEARLY. See space 17 below.)  
AT SURFACE: 1850 FSL & 790 FWL NE/SW  
AT TOP PROD. INTERVAL: 1850 FSL & 790 FWL  
AT TOTAL DEPTH: 1850 FSL & 790 FWL
16. CHECK APPROPRIATE BOX TO INDICATE NATURE OF NOTICE, REPORT, OR OTHER DATA

REQUEST FOR APPROVAL TO:  
TEST WATER SHUT-OFF ☐  
FRACTURE TREAT ☐  
SHOOT OR ACIDIZE ☐  
REPAIR WELL ☐  
PULL OR ALTER CASING ☐  
MULTIPLE COMPLETE ☐  
CHANGE ZONES ☐  
ABANDON\* ☐  
(other) ☐

SUBSEQUENT REPORT OF:  
☐  
☐  
☐  
☐  
☐  
☐  
☐  
☐  
☐

5. LEASE  
SF 078764
6. IF INDIAN, ALLOTTEE OR TRIBE NAME
7. UNIT AGREEMENT NAME  
Rosa Unit
8. FARM OR LEASE NAME  
Rosa Unit
9. WELL NO.  
#97
10. FIELD OR WILDCAT NAME  
Blanco MV/Basin DK/Gal
11. SEC., T., R., M., OR BLK. AND SURVEY OR AREA  
Sec 31, T31N, R5W
12. COUNTY OR PARISH  
Rio Arriba
13. STATE  
N.M.
14. API NO.
15. ELEVATIONS (SHOW DF, KDB, AND WD)  
6545' GR.

(NOTE: Report results of multiple completion or zone change on Form 9-330.)

17. DESCRIBE PROPOSED OR COMPLETED OPERATIONS (Clearly state all pertinent details, and give pertinent dates, including estimated date of starting any proposed work. If well is directionally drilled, give subsurface locations and measured and true vertical depths for all markers and zones pertinent to this work.)\*

We would like to change this location to a Gallup-Dakota Commingled well instead of a Mesa Verde/ Gallup-Dakota dual well.

Subsurface Safety Valve: Manu. and Type \_\_\_\_\_ Set @ \_\_\_\_\_ Ft.

18. I hereby certify that the foregoing is true and correct

SIGNED Donna J. Brace TITLE Production Clerk DATE 8-30-83

(This space for Federal or State office use)

APPROVED BY \_\_\_\_\_ TITLE \_\_\_\_\_ DATE \_\_\_\_\_  
CONDITIONS OF APPROVAL, IF ANY

B  
PCT/djb/2

SEP 08 1983

\*See Instructions on Reverse Side

OPERATOR

FARMINGTON RESOURCE AREA  
FARMINGTON, NEW MEXICO

BY Smm

**MEXICO OIL CONSERVATION COMMISSION**  
**WELL LOCATION AND ACREAGE DEDICATION PLAT**

Form C-102  
 Supersedes C-128  
 Effective 1-1-65

All distances must be from the outer boundaries of the Section.

Operator <b>Northwest Pipeline Corporation</b>			Lease <b>Rosa Unit</b>		Well No. <b>97</b>
Unit Letter <b>K</b>	Section <b>31</b>	Township <b>31N</b>	Range <b>5W</b>	County <b>Rio Arriba</b>	
Actual Footage Location of Well: <b>1850'</b> feet from the <b>South</b> line and <b>790</b> feet from the <b>West</b> line					
Ground Level Elev. <b>6545'</b>	Producing Formation <b>Gal- DK</b>		Pool <b>Undesignated Gal/Basin Dakota</b>		Dedicated Acreage: <b>327.63 GL-DK</b> Acres

1. Outline the acreage dedicated to the subject well by colored pencil or hachure marks on the plat below.
2. If more than one lease is dedicated to the well, outline each and identify the ownership thereof (both as to working interest and royalty).
3. If more than one lease of different ownership is dedicated to the well, have the interests of all owners been consolidated by communitization, unitization, force-pooling, etc?

☒ Yes    ☐ No    If answer is "yes," type of consolidation Unitization

If answer is "no," list the owners and tract descriptions which have actually been consolidated. (Use reverse side of this form if necessary.) \_\_\_\_\_

No allowable will be assigned to the well until all interests have been consolidated (by communitization, unitization, forced-pooling, or otherwise) or until a non-standard unit, eliminating such interests, has been approved by the Commission.

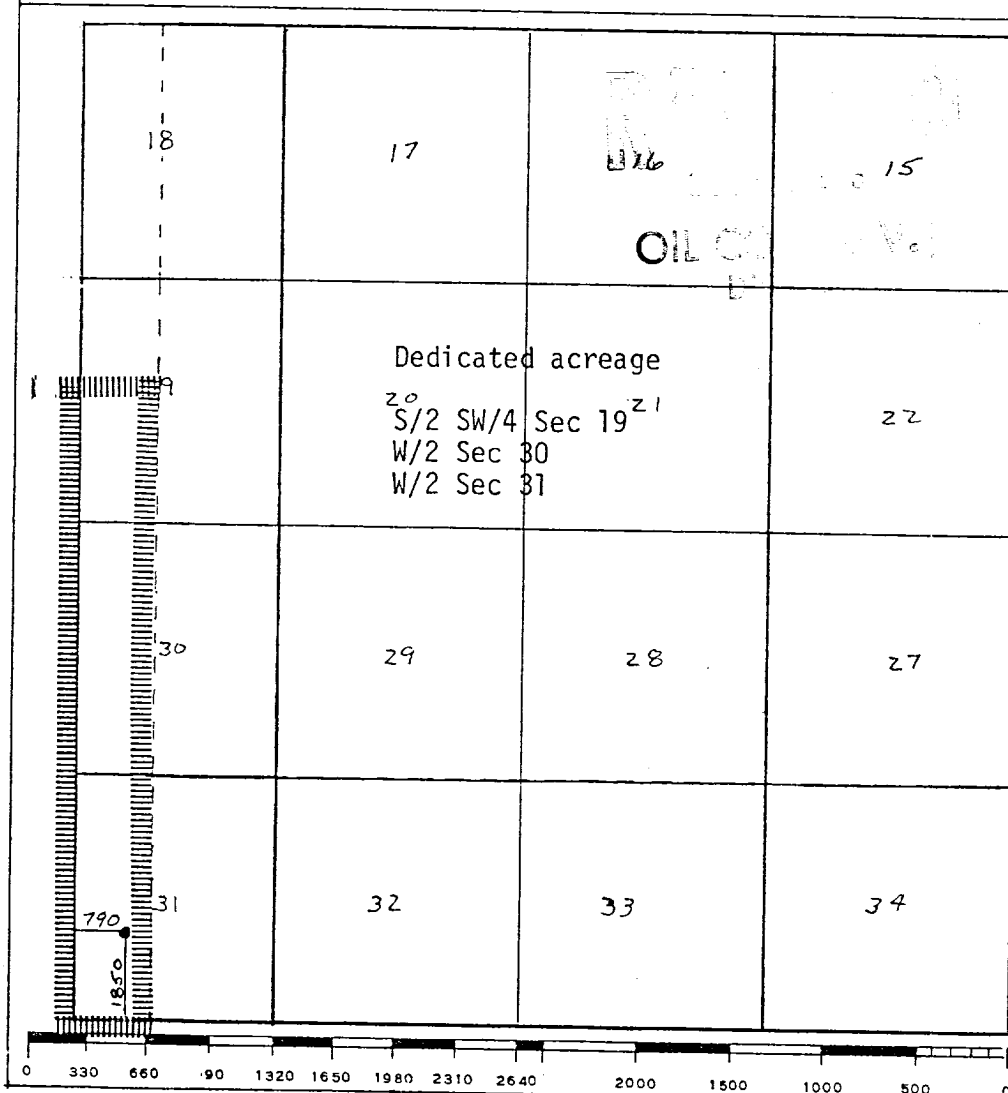

**CERTIFICATION**

*I hereby certify that the information contained herein is true and complete to the best of my knowledge and belief.*

*Paul C. Thompson*

Name <b>Paul C. Thompson</b>
Position <b>Sr. Drilling Engineer</b>
Company <b>Northwest Pipeline Corp</b>
Date <b>September 20, 1983</b>

*I hereby certify that the well location shown on this plat was plotted from field notes of actual surveys made by me or under my supervision, and that the same is true and correct to the best of my knowledge and belief.*

Date Surveyed
Registered Professional Engineer and/or Land Surveyor
Certificate No.