

UNITED STATES  
DEPARTMENT OF THE INTERIOR  
GEOLOGICAL SURVEY

## APPLICATION FOR PERMIT TO DRILL, DEEPEN, OR PLUG BACK

1a. TYPE OF WORK  
DRILL ☒ DEEPEN ☐ PLUG BACK ☐

b. TYPE OF WELL  
OIL WELL ☐ GAS WELL ☒ OTHER ☐ SINGLE ZONE ☐ MULTIPLE ZONE ☒

2. NAME OF OPERATOR  
Amoco Production Company

3. ADDRESS OF OPERATOR  
501 Airport Drive, Farmington, N.M. 87401

4. LOCATION OF WELL (Report location clearly and in accordance with any State requirements.)\*  
At surface  
1850' FSL x 1450' FWL  
At proposed prod. zone same

14. DISTANCE IN MILES AND DIRECTION FROM NEAREST TOWN OR POST OFFICE  
20 miles NE of Gobernador, N.M.

15. DISTANCE FROM PROPOSED\* LOCATION TO NEAREST PROPERTY OR LEASE LINE, FT. (Also to nearest drlg. unit line, if any)  
1450'

16. DISTANCE FROM PROPOSED\* LOCATION TO NEAREST WELL, DRILLING, COMPLETED, OR APPLIED FOR, ON THIS LEASE, FT.  
22,259'

17. NO. OF ACRES ASSIGNED TO THIS WELL  
160/320 W 320.62

18. PROPOSED DEPTH  
8450'

19. ROTARY OR CABLE TOOLS  
Rotary

20. APPROX. DATE WORK WILL START\*  
As soon as permitted

21. ELEVATIONS (Show whether DF, RT, GR, etc.)  
6866' GL

22. DRILLING OPERATIONS AUTHORIZED ARE  
SUBJECT TO COMPLIANCE WITH ATTACHED  
"GENERAL REQUIREMENTS - CEMENTING PROGRAM"

23. This action is subject to administrative appeal pursuant to 30 CFR 290.

SIZE OF HOLE	SIZE OF CASING	WEIGHT PER FOOT	SETTING DEPTH	QUANTITY OF CEMENT
17 1/2"	13 3/8"	48# H40	300'	378 cu ft Class B w/2% CaCl <sub>2</sub>
7 7/8"	5 1/2"	4,15.5, 17# K55	8450'	1st Stage: 500 cu ft Class B 50:50 POZ cement. Tail in w/148 cu ft Class B neat. 2nd Stage: 985 cu ft Class B 65:35 POZ cement. Tail in w/148 cu ft Class B neat.

Amoco proposes to drill the above well to further develop the Gallup Dakota reservoirs. The well will be drilled to the surface casing point using native mud. The well will then be drilled to TD with a low solids non-dispersed mud system. Completion design will be based on open hole logs. Copies of all logs will be filed upon completion. Amoco's standard blowout prevention will be employed; see attached drawing for blowout preventer design.

Upon completion, the well location will be cleaned and the reserve pit filled and leveled.

IN ABOVE SPACE DESCRIBE PROPOSED PROGRAM: If proposal is to deepen or plug back, give data on present productive zone and proposed new productive zone. If proposal is to drill or deepen directionally, give pertinent data on subsurface locations and measured and true vertical depths. Give blowout prevention program if any.

24. Original Signed By  
D. H. SHOEMAKER *DOL* TITLE District Engineer DATE Sept. 28, 1983

\*This space for Federal or State office use)

PERMIT NO.

APPROVED BY  
CONDITIONS OF APPROVAL, IF ANY:

RECEIVED

NOV 9 - 1983  
Nmo  
OIL CON. DIV.  
DIST. 3

APPROVED  
AS AMENDED

DATE  
NOV 9 1983  
M. TILLENBACH  
AREA MANAGER

## OIL CONSERVATION DIVISION

STATE OF NEW MEXICO

P. O. BOX 2088

Form C-107  
Revised 10-1-78

ENERGY AND MINERALS DEPARTMENT

SANTA FE, NEW MEXICO 87501

All distances must be from the outer boundaries of the Section.

Operator <b>AMOCO PRODUCTION COMPANY</b>			Lease <b>JICARILLA TRIBAL 531</b>		Well No. <b>1</b>
Unit Letter <b>K</b>	Section <b>5</b>	Township <b>31N</b>	Range <b>3W</b>	County <b>Rio Arriba</b>	
Actual Footage Location of Well: <b>1850</b> feet from the <b>South</b> line and <b>1450</b> feet from the <b>West</b> line					
Ground Level Elev. <b>6866</b>	Producing Formation <b>Gallup-Dakota</b>		Pool <b>Undesignated Gallup-Basin Dakota</b>		Dedicated Acreage: <b>160/320, 62</b> Acres

1. Outline the acreage dedicated to the subject well by colored pencil or hachure marks on the plat below.
2. If more than one lease is dedicated to the well, outline each and identify the ownership thereof (both as to working interest and royalty).
3. If more than one lease of different ownership is dedicated to the well, have the interests of all owners been consolidated by communitization, unitization, force-pooling, etc?

☐ Yes ☐ No If answer is "yes," type of consolidation \_\_\_\_\_

If answer is "no," list the owners and tract descriptions which have actually been consolidated. (Use reverse side of this form if necessary.) \_\_\_\_\_

No allowable will be assigned to the well until all interests have been consolidated (by communitization, unitization, forced-pooling, or otherwise) or until a non-standard unit, eliminating such interests, has been approved by the Commission.

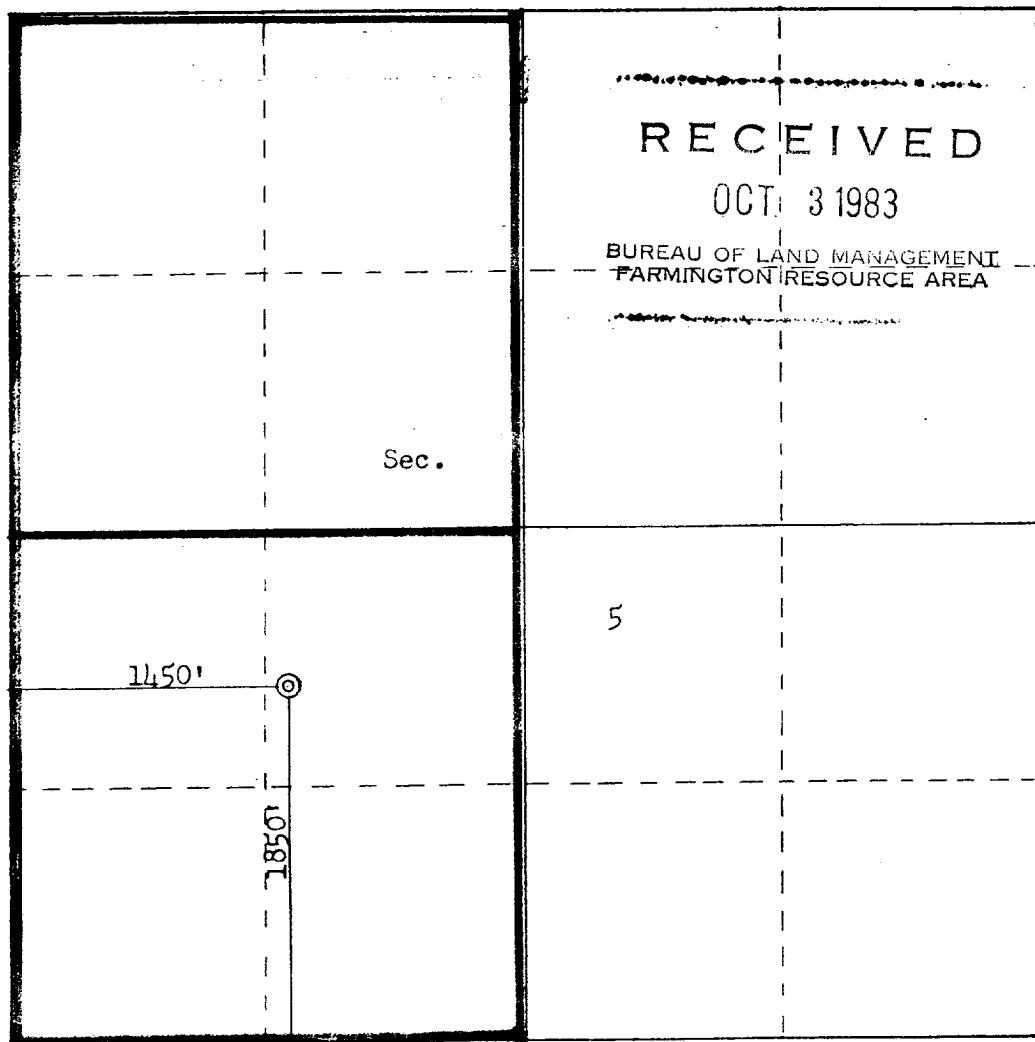

Scale: 1"=1000'

## CERTIFICATION

I hereby certify that the information contained herein is true and complete to the best of my knowledge and belief.  
Original Signed By  
**D. H. SHOEMAKER DDL**

Name

**Dale H. Shoemaker**

Position

**District Engineer**

Company

**Amoco Production Co.**

Date

**9-28-83**

I hereby certify that the well location shown on this plat was plotted from field notes of actual surveys made by me or under my supervision, and that the same is true and correct to the best of my knowledge and belief.

Date Surveyed

**August 30, 1983**

Registered Professional Engineer and Land Surveyor

**Fred B. Kerr Jr.**Certificate No. **3950**