

UNITED STATES
DEPARTMENT OF THE INTERIOR
GEOLOGICAL SURVEY

30-039-23448

APPLICATION FOR PERMIT TO DRILL, DEEPEN, OR PLUG BACK			
1a. TYPE OF WORK DRILL <input checked="" type="checkbox"/> DEEPEN <input type="checkbox"/> PLUG BACK <input type="checkbox"/>			
b. TYPE OF WELL OIL WELL <input type="checkbox"/> GAS WELL <input checked="" type="checkbox"/> OTHER <input type="checkbox"/> SINGLE ZONE <input checked="" type="checkbox"/> MULTIPLE ZONE <input type="checkbox"/>			
2. NAME OF OPERATOR Northwest Pipeline Corporation			
3. ADDRESS OF OPERATOR P.O. Box 90, Farmington, N.M. 87499			
4. LOCATION OF WELL (Report location clearly and in accordance with any State requirements.) At surface 1450 FSL & 1190 FWL NW/SW At proposed prod. zone 1450 FSL & 1190 FWL			
14. DISTANCE IN MILES AND DIRECTION FROM NEAREST TOWN OR POST OFFICE 20 Miles East of Navajo Dam Post Office			
15. DISTANCE FROM PROPOSED* LOCATION TO NEAREST PROPERTY OR LEASE LINE, FT. (Also to nearest drlg. unit line, if any)		16. NO. OF ACRES IN LEASE	
1190'		N/A	
18. DISTANCE FROM PROPOSED LOCATION* TO NEAREST WELL, DRILLING COMPLETED, OR APPLIED FOR, ON THIS LEASE, FT.		19. PROPOSED DEPTH	
500		7706'	
21. ELEVATIONS (Show whether DF, RT, GR, etc.) 6196' GR		20. ROTARY OR CABLE TOOLS Rotary	
22. APPROX. DATE WORK WILL START*		23. PROPOSED CASING AND CEMENTING PROGRAM	
April 1984		This action is subject to administrative appeal pursuant to 30 CFR 290.	
24. IN ABOVE SPACE DESCRIBE PROPOSED PROGRAM: If proposal is to deepen or plug back, give data on present productive zone and proposed new productive zone. If proposal is to drill or deepen directionally, give pertinent data on subsurface locations and measured and true vertical depths. Give blowout preventer program, if any.			
25. SIGNED <u>Paul C. Thompson</u> TITLE <u>Sr. Drlg Engineer</u> DATE <u>1-23-84</u>			
(This space for Federal or State office use)			
PERMIT NO.		APPROVAL DATE	
APPROVED BY <u>B</u>		TITLE	
CONDITIONS OF APPROVAL, IF ANY:			
PVM/djb			
*See Instructions On Reverse Side			

Selectively perforate and stimulate the Dakota Formation. Completion plans will be determined at Total Depth.

A BOP will be installed after the surface casing is set and cemented. All subsequent work will be conducted through the BOP's.

The West half of Section 31 is dedicated to this well.

Gas is dedicated.

RECEIVED
MAY 14 1984
OIL CON. DIV.
DIST. 3

IN ABOVE SPACE DESCRIBE PROPOSED PROGRAM: If proposal is to deepen or plug back, give data on present productive zone and proposed new productive zone. If proposal is to drill or deepen directionally, give pertinent data on subsurface locations and measured and true vertical depths. Give blowout preventer program, if any.

24. SIGNED <u>Paul C. Thompson</u> TITLE <u>Sr. Drlg Engineer</u> DATE <u>1-23-84</u>	
(This space for Federal or State office use)	
PERMIT NO.	APPROVAL DATE
APPROVED BY <u>B</u>	TITLE
CONDITIONS OF APPROVAL, IF ANY:	
PVM/djb	
*See Instructions On Reverse Side	



NMOCC

All distances must be from the outer boundaries of the Section.

Operator NORTHWEST PIPELINE CORPORATION			Lease SAN JUAN 31-6 UNIT		Well No. 50
Unit Letter L	Section 31	Township 31N	Range 6W	County Rio Arriba	
Actual Footage Location of Well: 1150 feet from the South line and 1190 feet from the West line					
Ground Level Elev. 6196	Producing Formation Dakota		Pool Basin Dakota		Dedicated Acreage: W/2 320 Acres

1. Outline the acreage dedicated to the subject well by colored pencil or hachure marks on the plat below.
2. If more than one lease is dedicated to the well, outline each and identify the ownership thereof (both as to working interest and royalty).
3. If more than one lease of different ownership is dedicated to the well, have the interests of all owners been consolidated by communitization, unitization, force-pooling, etc?

☒ Yes ☐ No If answer is "yes," type of consolidation Unitization

If answer is "no," list the owners and tract descriptions which have actually been consolidated. (Use reverse side of this form if necessary.)

No allowable will be assigned to the well until all interests have been consolidated (by communitization, unitization, forced-pooling, or otherwise) or until a non-standard unit, eliminating such interests, has been approved by the Commission.

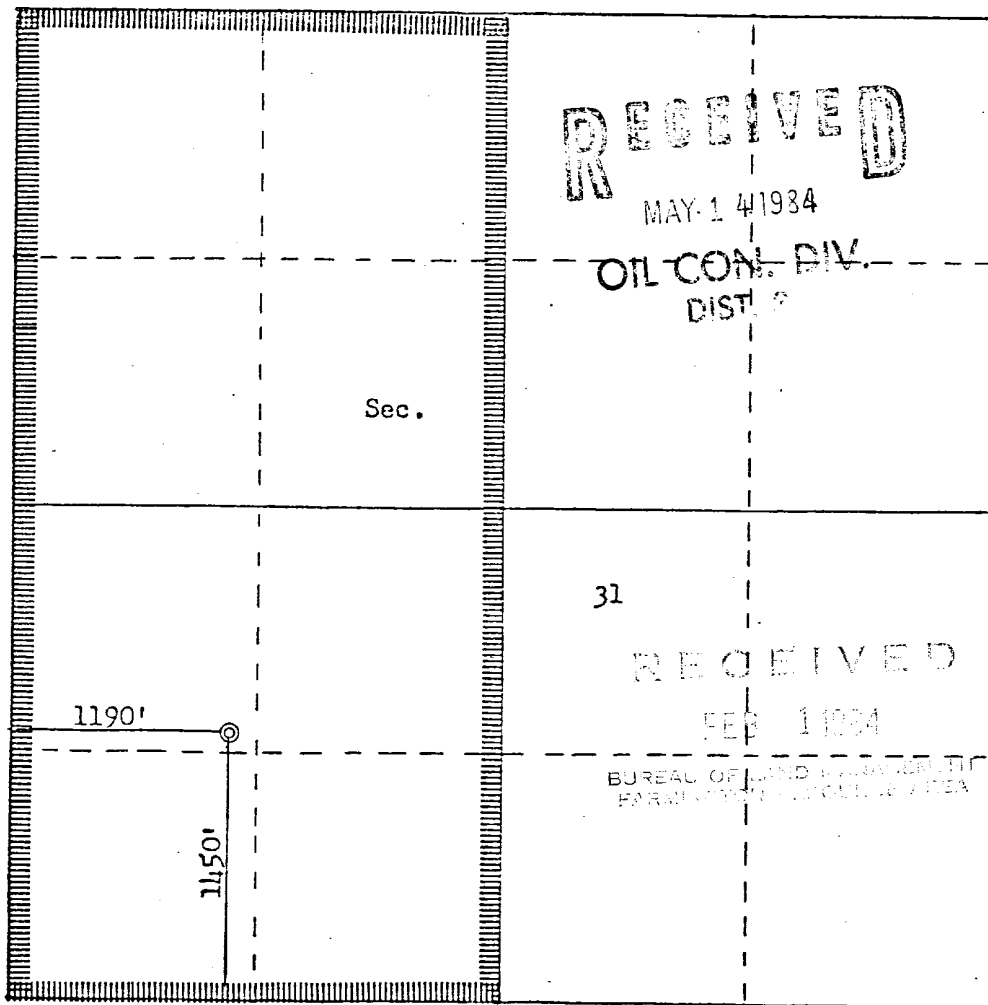

Scale: 1"=1000'

CERTIFICATION

I hereby certify that the information contained herein is true and complete to the best of my knowledge and belief.

Paul C. Thompson
Name

Paul C. Thompson
Position

Sr. Drilling Engineer
Company

Northwest Pipeline Corp
Date

January 4, 1984

I hereby certify that the well location shown on this plat was plotted from field notes of actual surveys made by me or under my supervision, and that the same is true and correct to the best of my knowledge and belief.

Date Surveyed
January 3, 1984

Registered Professional Engineer and Land Surveyor

Fred B. Kerr Jr.
Fred B. Kerr Jr.

Certificate No. 3950

GEOLOGICAL SURVEY

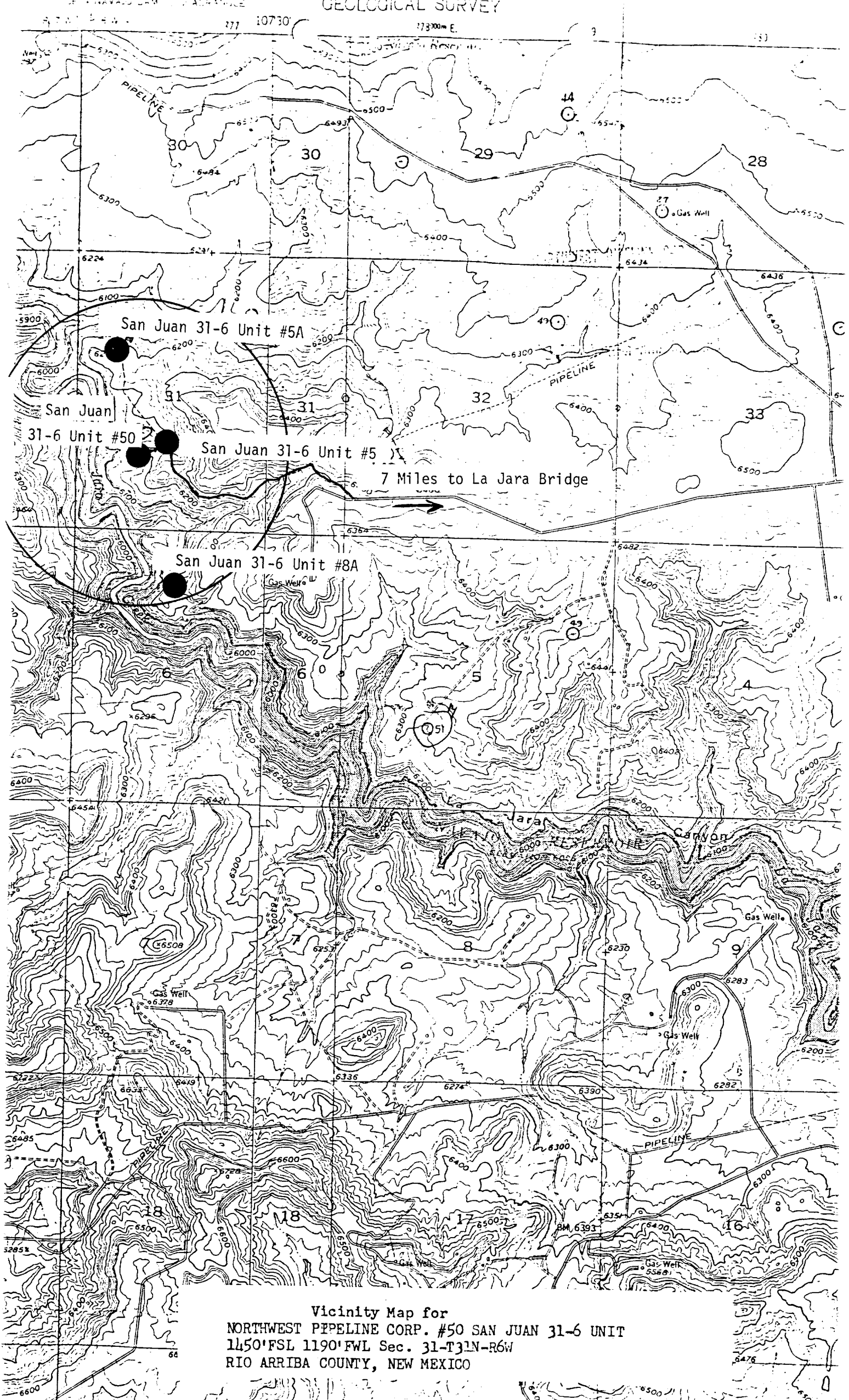

Vicinity Map for
 NORTHWEST PIPELINE CORP. #50 SAN JUAN 31-6 UNIT
 1450'FSL 1190'FWL Sec. 31-T31N-R6W
 RIO ARRIBA COUNTY, NEW MEXICO