

UNITED STATES
DEPARTMENT OF THE INTERIOR
GEOLOGICAL SURVEY

APPLICATION FOR PERMIT TO DRILL, DEEPEN, OR PLUG BACK

1a. TYPE OF WORK

DRILL ☒DEEPEN ☐PLUG BACK ☐

b. TYPE OF WELL

OIL
WELL ☐GAS
WELL ☒OTHER ☐SINGLE
ZONE ☐MULTIPLE
ZONE ☒

2. NAME OF OPERATOR

Amoco Production Company

3. ADDRESS OF OPERATOR

501 Airport Drive, Farmington, NM 87401

4. LOCATION OF WELL (Report location clearly and in accordance with any State requirements.)

At surface

1530' FNL x 1720' FEL

At proposed prod. zone

same

BUREAU OF LAND MANAGEMENT
FARMINGTON RESOURCE AREA

14. DISTANCE IN MILES AND DIRECTION FROM NEAREST TOWN OR POST OFFICE*

5 miles northwest of Gobernador

15. DISTANCE FROM PROPOSED*

LOCATION TO NEAREST
PROPERTY OR LEASE LINE, FT.
(Also to nearest drlg. unit line, if any)

890'

16. NO. OF ACRES IN LEASE

2507.3

17. NO. OF ACRES ASSIGNED
TO THIS WELL

320/160

18. DISTANCE FROM PROPOSED LOCATION*
TO NEAREST WELL, DRILLING, COMPLETED,
OR APPLIED FOR, ON THIS LEASE, FT.

16368'

19. PROPOSED DEPTH

8950'

20. ROTARY OR CABLE TOOLS

Rotary

21. ELEVATIONS (Show whether DF, RT, GR, etc.)

6971' GL

DRILLING OPERATIONS AUTHORIZED ARE
SUBJECT TO COMPLIANCE WITH ATTACHED
"GENERAL REQUIREMENTS"

22. APPROX. DATE WORK WILL START*

As soon as permitted

23. PROPOSED CASING AND CEMENTING PROGRAM

This action is subject to administrative
appeal pursuant to 30 CFR 290.

SIZE OF HOLE	SIZE OF CASING	WEIGHT PER FOOT	SETTING DEPTH	QUANTITY OF CEMENT
14-3/4"	11-3/4"	42# H40	400'	450 ft ³ Class "B" w/2% CaCl ₂
7-7/8"	4-1/2"	11.6# N80	8950'	1st stage: 900 ft ³ Class "B" 50:50 poz cmt x tail in w/118 ft ³ Class "B" Neat cmt. 2nd stage: 2800 ft ³ Class "B" 65:35 poz cmt x tail in w/118 ft ³ Class "B" Neat cmt. DV tool set at approx. 5700'

Amoco proposes to drill the above well to further develop the Basin Dakota and Undesignated Gallup reservoirs. The well will be drilled to the surface casing point using native mud. The well will then be drilled to TD with a low solids nondispersed mud system. Completion design will be based on open hole logs. Copy of all logs will be filed upon completion. Amoco's standard blowout prevention will be employed; see attached drawing for blowout preventer design. Upon completion the well site will be cleaned and the reserve pit filled and leveled. The gas from this well is not dedicated at this time.

IN ABOVE SPACE DESCRIBE PROPOSED PROGRAM: If proposal is to deepen or plug back, give data on present productive zone and proposed new productive zone. If proposal is to drill or deepen directionally, give pertinent data on subsurface locations and measured and true vertical depths. Give blowout preventer program, if any.

24.

SIGNED

B.D. Shaw

TITLE Administrative Supervisor

(This space for Federal State office)

PERMIT NO.

APPROVAL DATE

APPROVED BY

CONDITIONS OF APPROVAL

OIL CON. DIV.

DIST. 3

TITLE

NMOC

APPROVED
AS AMENDED

JUN 26 1984

James E. Edwards
AREA MANAGER
FARMINGTON RESOURCE AREA

OIL CONSERVATION DIVISION

STATE OF NEW MEXICO
GEOLOGY AND MINERALS DEPARTMENT

P. O. BOX 2048

SANTA FE, NEW MEXICO 87501

Form C-107
Revised 10-1-77

All distances must be from the outer boundaries of the Section.

Operator AMOCO PRODUCTION COMPANY			Lease ROSA UNIT		Well No. 103
Unit Letter G	Section 10	Township 31N	Range 4W	County Rio Arriba	
Actual Footage Location of Well: 1530 feet from the North line and 1790 feet from the East line					
Ground Level Elev. 6971	Producing Formation Dakota & Gallup		Pool Basin Dakota/Undes. Gallup		Dedicated Acreage: 320/160 Acres

1. Outline the acreage dedicated to the subject well by colored pencil or hachure marks on the plat below.
2. If more than one lease is dedicated to the well, outline each and identify the ownership thereof (both as to working interest and royalty).
3. If more than one lease of different ownership is dedicated to the well, have the interests of all owners been consolidated by communitization, unitization, force-pooling, etc?

☒ Yes ☐ No If answer is "yes," type of consolidation Unitized

If answer is "no," list the owners and tract descriptions which have actually been consolidated. (Use reverse side of this form if necessary.)

No allowable will be assigned to the well until all interests have been consolidated (by communitization, unitization, forced-pooling, or otherwise) or until a non-standard unit, eliminating such interests, has been approved by the Commission.

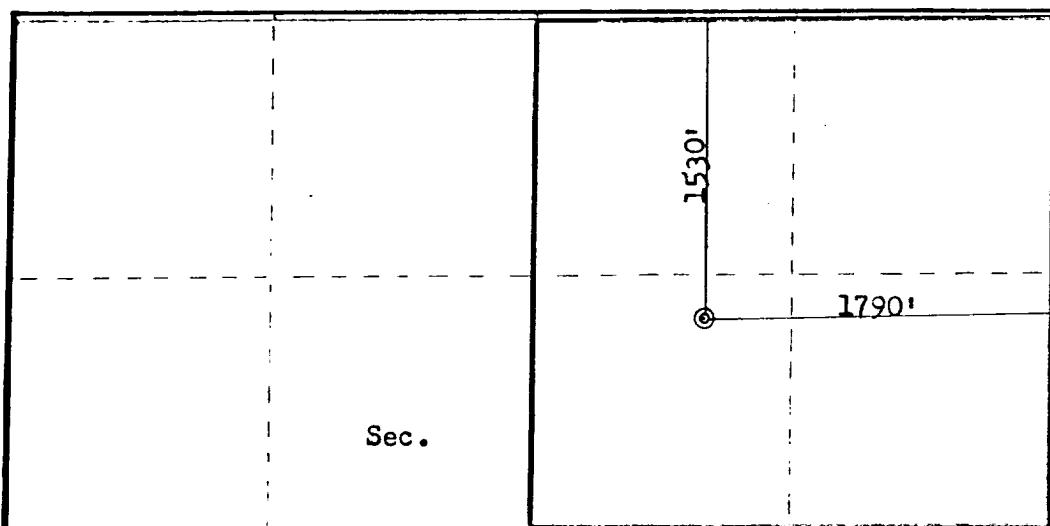

CERTIFICATION

I hereby certify that the information contained herein is true and complete to the best of my knowledge and belief.

Name
B. D. Shaw
Position
Administrative Supervisor
Company
Amoco Production Company
Date
June 8, 1984

I hereby certify that the well location shown on this plat was plotted from field notes of actual surveys made by me or under my supervision, and that the same is true and correct to the best of my knowledge and belief.

Date Surveyed
June 6, 1984
Registered Professional Engineer and Land Surveyor
<i>Fred B. Kerr Jr.</i>
Fred B. Kerr Jr.

RECEIVED
JUN 28 1984
OIL CON. DIV.
DIST. 3RECEIVED
JUN 13 1984
BUREAU OF LAND MANAGEMENT
FARMINGTON RESOURCE AREA

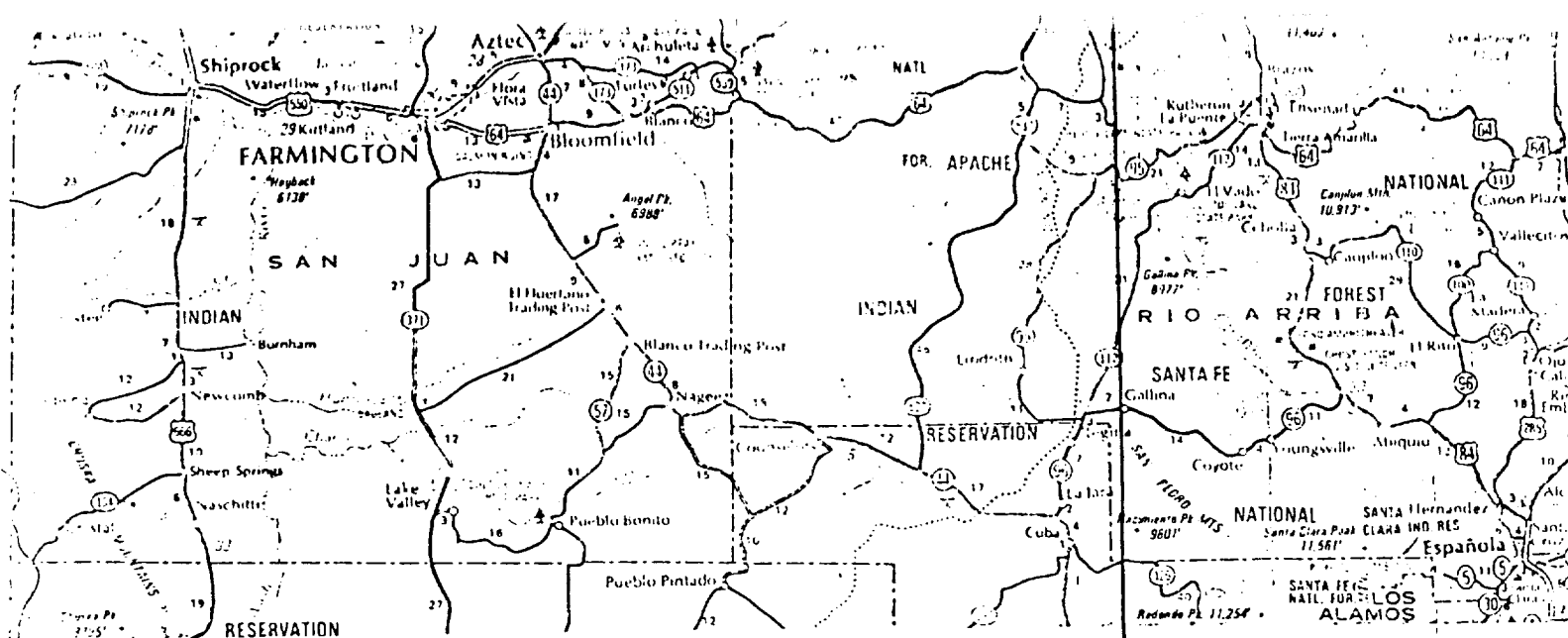

Rosa Unit 103

1530 FNL, 1790 FEL Sec. 10, T 31 N-R 4 W.

Rail Point : 218 mi. Montrose, CO

Mud Point : 81 mi. Aztec, NM

Cement Point : 85 mi. Farmington, NM

