



STATE OF NEW MEXICO  
ENERGY, MINERALS AND NATURAL RESOURCES DEPARTMENT  
OIL CONSERVATION DIVISION

OK  
5.13

GARREY CARRUTHERS  
GOVERNOR

POST OFFICE BOX 2088  
STATE LAND OFFICE BUILDING  
SANTA FE, NEW MEXICO 87504  
(505) 827-5800

July 12, 1988

Northwest Pipeline Corporation  
3539 East 30th Street  
Farmington, NM 87401

Attention: Paul C. Thompson  
Manager, Production and Drilling

Administrative Order NSP-1537

Dear Mr. Thompson:

Reference is made to your application for a 111.90-acre, more or less, non-standard gas proration unit consisting of the following acreage in the Fruitland formation:

RIO ARriba COUNTY, NEW MEXICO  
TOWNSHIP 31 NORTH, RANGE 6 WEST, NMPM  
SECTION 24: Lots 1 and 2 and the W/2 NE/4

It is my understanding that this unit is to be dedicated to your Rosa Unit Well No. 206 to be drilled at a standard gas well location 1190 feet from the North line and 1050 feet from the East line (Unit B) of said Section 24.

By authority granted me under the provisions of General Rule 104.D.II, the above non-standard gas proration unit is hereby approved.

Sincerely,

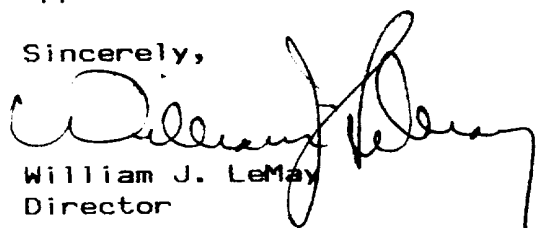
  
William J. LeMay  
Director

WJL/MES/ag

cc: Oil Conservation Division - Aztec  
U.S. Bureau of Land Management - Farmington  
New Mexico Oil and Gas Engineering Committee - Hobbs

RECEIVED  
JUL 19 1988  
OIL CON. DIV.  
DIST. 3



STATE OF NEW MEXICO  
ENERGY AND MINERALS DEPARTMENT

OIL CONSERVATION DIVISION  
AZTEC DISTRICT OFFICE

1000 RIO BRAZOS ROAD  
AZTEC, NEW MEXICO 87410  
(505) 334-6178

OIL CONSERVATION DIVISION  
BOX 2088  
SANTA FE, NEW MEXICO 87501

DATE 7-7-88

RE: Proposed MC \_\_\_\_\_  
Proposed DHC \_\_\_\_\_  
Proposed NSL \_\_\_\_\_  
Proposed SWD \_\_\_\_\_  
Proposed WFX \_\_\_\_\_  
Proposed PMX \_\_\_\_\_

NSP X

Gentlemen:

I have examined the application dated 6-24-88

for the Northwest Pipeline Corp. Rosa Unit #206 B-24-31N-6W  
Operator Lease and Well No. Unit, S-T-R

and my recommendations are as follows:

Cannot approve administratively. Please refer for  
hearing

Yours truly,

[Signature]

NORTHWEST PIPELINE CORPORATION

PRODUCTION & DRILLING  
3539 East 30th Street  
Farmington, New Mexico 87401  
4320-M-051-88

July 7, 1988

Mr. William J. Lemay  
NMOCD  
P.O. Box 2088  
Santa Fe, New Mexico 87501

RE: Application for Non-Standard Proration Unit  
Rosa Unit #206  
1190' FNL & 1050' FEL  
Sec. 24, T31N, R6W  
Rio Arriba County, New Mexico

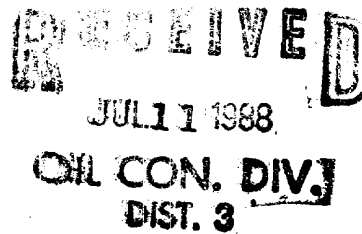

Dear Mr. Lemay:

Northwest Pipeline requests administrative approval for a Non-Standard Proration Unit for our Rosa Unit #206. The NW/4 Section 24, T31N, R6W has been dedicated to this Fruitland Coal Well. The NW/4 contains approximately 111.9 acres and is non-standard due to a variation in the legal subdivision of the U.S. Public Land Survey. Northwest Pipeline is the operator of all the offsetting acreage.

Sincerely,

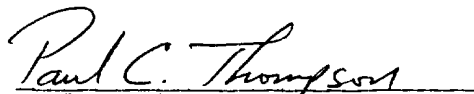
  
Paul C. Thompson  
Manager, Production & Drilling

PCT/kr

cc: Frank Chavez, NMOCD, Aztec  
M.J. Turnbaugh  
Darrell Gillen

NEW MEXICO OIL CONSERVATION COMMISSION  
WELL LOCATION AND ACREAGE DEDICATION PLAT

Form C-102  
Supersedes C-128  
Effective 1-1-65.

All distances must be from the outer boundaries of the Section.

Operator Northwest Pipeline Corporation			Lease Rosa Unit		Well No. 206
Unit Letter B	Section 24	Township 31 North	Range 6 West	County Rio Arriba	
Actual Postage Location of Well: 1190 feet from the North line and 1050 feet from the East line					
Ground Level Elev. 6264	Producing Formation Fruitland		Pool Undesignated	Dedicated Acreage: 111.9 Acres	

1. Outline the acreage dedicated to the subject well by colored pencil or hachure marks on the plat below.
2. If more than one lease is dedicated to the well, outline each and identify the ownership thereof (both as to working interest and royalty).
3. If more than one lease of different ownership is dedicated to the well, have the interests of all owners been consolidated by communitization, unitization, force-pooling, etc?

☒ Yes ☐ No If answer is "yes," type of consolidation Unitization

If answer is "no," list the owners and tract descriptions which have actually been consolidated. (Use reverse side of this form if necessary.)

No allowable will be assigned to the well until all interests have been consolidated (by communitization, unitization, forced-pooling, or otherwise) or until a non-standard unit, eliminating such interests, has been approved by the Commission.

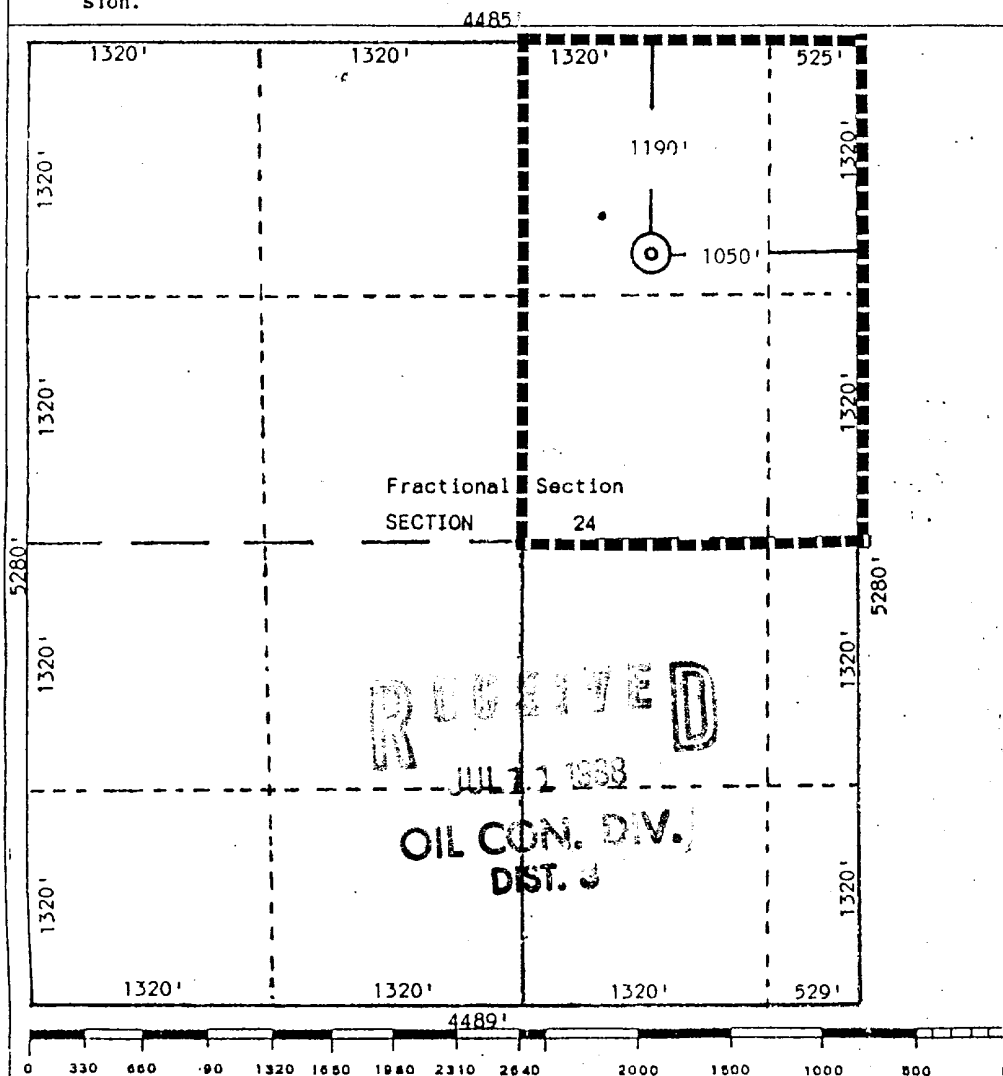

CERTIFICATION

I hereby certify that the information contained herein is true and complete to the best of my knowledge and belief.

*Mike J. Turnbaugh*  
Name  
Mike J. Turnbaugh

Position  
Sr. Drilling Engineer

Company  
Northwest Pipeline Corp.

Date  
July 6, 1988

EDGAR L. RISENHOOVER  
NEW MEXICO  
3979  
I hereby certify that the location of the well shown on this plat is from field notes of actual surveys made by me or under my supervision and that the same are true and correct to the best of my knowledge and belief.

Date Surveyed  
Revised Plat July 1, 1988

Registered Professional Engineer  
and/or Land Surveyor

*Edgar L. Risenhoover*  
Certificate No. 5979  
Edgar L. Risenhoover, L.S.



## ROSA UNIT

San Juan and Rio Arriba Counties, New Mexico

Order No. 759, Approving Rosa Unit, San Juan and Rio Arriba Counties, New Mexico, Dated April 22, 1948.

Note: Present Operator of Unit: Pacific Northwest Pipeline (August, 1959.)

*The Application of Stanolind Oil and Gas Company, Petitioner, for an Order of Approval of proposed Rosa Area Unit Agreement, the Unit Area of which embraces 54,209.49 acres, more or less, in Township 31 North, Ranges 4, 5, and 6 West and Township 32 North, Range 6 West, in the Counties of San Juan and Rio Arriba, New Mexico.*

CASE NO. 133  
Order No. 759

## ORDER OF THE COMMISSION

BY THE COMMISSION: This cause came on for hearing at 10:00 o'clock a.m. April 22, 1948, at Santa Fe, New Mexico, before the Oil Conservation Commission of New Mexico, hereinafter referred to as the "Commission".

NOW, on this the 22nd day of April, 1948, the Commission having before it for consideration the testimony and other evidence adduced at the hearing of said case and the application of petitioner and being fully advised in the premises:

FINDS that the proposed unit plan will in principle tend to promote the conservation of oil and gas and the prevention of waste, and that such plan is fair to the royalty owners and other interest owners;

## IT IS THEREFORE ORDERED:

That the order herein shall be known as the:

## "ROSA UNIT AGREEMENT ORDER"

SECTION 1. (a) That the project herein shall be known as the Rosa Unit Agreement and shall hereinafter be referred to as the Project.

(b) That the plan by which the Project shall be operated shall be embraced in the form of unit agreement for the development and operation of the Rosa Unit Area referred to in the petitioner's application and as finally submitted to the Commission in definitive revised form as a part of the testimony adduced at said hearing of April 22, 1948; and such plan shall be known as the Rosa Unit Agreement Plan.

SECTION 2. That the Rosa Agreement Plan shall be and is hereby approved in principle as a proper conservation measure; provided, however, that notwithstanding any of the provisions contained in said Unit Agreement, this approval of said agreement shall not be considered as waiving or relinquishing in any manner any rights, duties or obligations which are now

or may hereafter be vested in the New Mexico Oil Conservation Commission by law relative to the supervision and control of operations for exploration and development of any lands committed to said Rosa Unit Agreement or relative to the production of oil and gas therefrom.

SECTION 3. (a) That the Unit area shall consist of: NEW MEXICO PRINCIPAL MERIDIAN, NEW MEXICO, (San Juan and Rio Arriba Counties)

## TOWNSHIP 31 NORTH, RANGE 4 WEST

Sections 1, 2, 3, 4, 5, 6, 7, 8,  
9, 10, 11, 12, 13, 14,  
15, 16, 17, 18, 19, 20,  
21, 22, 23, 24, 25, 26,  
27, 28, 29, 30, 31: All

## TOWNSHIP 31 NORTH, RANGE 5 WEST

Sections 3, 4, 5, 6, 7, 8, 9, 10,  
11, 12, 13, 14, 15, 16,  
17, 18, 19, 20, 21, 22,  
23, 24, 25, 26, 27, 28,  
29, 30, 31, 32, 33, 34  
35, 36: All

## TOWNSHIP 31 NORTH, RANGE 6 WEST

Sections 1, 2, 3, 4, 5, 6, 7, 8, 9, 10,  
11, 12, 13, 14, 15, 16,  
17, 21, 22, 23, 24, 25,  
26: All

## TOWNSHIP 32 NORTH, RANGE 6 WEST

Sections 32, 33, 34, 35, 36: All  
total unit area 54,209.49 acres more or less.

(b) That the Unit area may be enlarged or diminished as provided in said plan.

SECTION 4. That the unit operator shall file with the Commission an executed original, or executed counterparts thereof, of the Rosa Unit Agreement not later than 30 days after the effective date thereof.

SECTION 5. That any party owning rights in the unitized substances who does not commit such rights to said Unit Agreement before the effective date thereof may thereafter become a party thereto by subscribing to such Agreement or a counterpart thereof in the manner and with the effect therein expressly provided. The unit operator shall file with the Commission within 30 days thereafter an original of any such counterpart.

SECTION 6. That the order herein shall become effective as of the first day of the calendar month next following the approval of said Unit Agreement by the Commissioner of Public Lands and the Secretary of the Interior of the United States, and it shall terminate ipso facto upon the termination of said Unit Agreement. The last unit operator shall immediately notify the Commission in writing of any such termination.



STATE OF NEW MEXICO  
ENERGY AND MINERALS DEPARTMENT  
OIL CONSERVATION DIVISION

TONEY ANAYA  
GOVERNOR

Date \_\_\_\_\_

POST OFFICE BOX 2088  
STATE LAND OFFICE BUILDING  
SANTA FE, NEW MEXICO 87501  
(505) 827-5800

Northwest Pipeline Corporation  
3539 East 30th Street  
Farmington NM 87401

Attention: Paul C. Thompson  
Manager, Production & Drilling  
Administrative Order NSP-\_\_\_\_\_ (4)

Gentlemen: Dear Mr. Thompson

Reference is made to your application for a  
111.90-acre, <sup>more or less</sup> non-standard proration unit consisting of the  
following acreage in the Fruitland Formation. Pool:

RIO ARriba COUNTY, NEW MEXICO  
TOWNSHIP 31 NORTH RANGE 6 WEST, NMPM  
Section 24: lots 1 and 2 and the W/2 NE/4

It is my understanding that this unit is <sup>drilled</sup> to be <sup>non-standard</sup>  
dedicated to your Reservoir Unit Well No. 206 to be located at a standard gas  
well location 1155 feet from the North line and 1150 feet of said Section 24.  
<sup>1190'</sup> from the East line (Unit B)

By authority granted me under the provisions of \_\_\_\_\_  
\_\_\_\_\_, the above non-standard proration unit is  
hereby approved.

Sincerely,

R. L. STAMETS, DIRECTOR

RLS/DC/dr

cc: Oil Conservation Division - \_\_\_\_\_

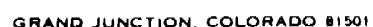
[illegible]