

*From the desk of*

**BUTCH MILLESON**

---

---

Alice,

Per my conversation with  
Mike Turnbaugh, I am  
sending copies of correspondence  
from our files and  
apparently we are waiting  
on further info from  
Mr. Stogner.

Charles  
Butch

---

---

**NORTHWEST  
PIPELINE  
CORPORATION**

---

The apparent reason that Northwest did not know the proper pool name for these wells must have been the lack of Forms C-104.

*p-12-10-100*

C-111

NORTHWEST PIPELINE CORPORATION

MAY, 1989

POOL / WELL	U	S	T	R	DATES	
					C-104	1ST DEL
<b>UNDESIGNATED FRUITLAND</b>						
<b>NORTHWEST PIPELINE CORPORATION</b>						
ROSA UNIT #203	P	18	31	5	NONE	11/21/88
ROSA UNIT #204	G	19	31	5	8/9/89	11/21/88
ROSA UNIT #206	B	24	31	6	5/24/89	11/21/88
ROSA UNIT #207	L	17	31	5	5/24/89	11/21/88

AUG 23 1989

OIL CON. DIV  
DIST. 3

NORTHWEST PIPELINE CORPORATION

PRODUCTION & DRILLING  
3539 East 30th Street  
Farmington, New Mexico 87401  
4320-PD-072-89

July 25, 1989

State Of New Mexico  
Oil Conservation Division  
P.O. Box 2088  
Santa Fe, New Mexico 87504

Reference: Rosa Unit Well No. 203

Mr. Stogner:

The subject well was drilled in 1988 prior to the implementation of the current "Basin Fruitland Pool", rules (Order No. 8768), requiring wells to be staked in the NE and SW quarters.

Northwest Pipeline will require unorthodox location approved at this well.

Sincerely,

  
Michael J. Turnbaugh  
Senior Engineer

hv/MJT165

1989 JUL 26  
OIL CON. DIV.  
DIST. 3

# OIL CONSERVATION DIVISION

STATE OF NEW MEXICO  
ENERGY AND MINERALS DEPARTMENT

P. O. BOX 2088  
SANTA FE, NEW MEXICO 87501

Form C-102  
Revised 10-1-78

All distances must be from the outer boundaries of the Section.

Operator <b>Northwest Pipeline Corporation</b>			Lease <b>Rosa Unit</b>		Well No. <b>203</b>
Unit Letter <b>P</b>	Section <b>18</b>	Township <b>31 North</b>	Range <b>5 West</b>	County <b>Rio Arriba</b>	
Actual Footage Location of Well: <div style="display: flex; justify-content: space-between;"> <span>1040 feet from the</span> <span>South line and</span> <span>820 feet from the</span> <span>East line</span> </div>					
Ground Level Elev. <b>6422</b>	Producing Formation <b>Fruitland</b>	Pool <b>Undesignated Fruitland</b>		Dedicated Acreage: <b>160 231.83 Acres</b>	

1. Outline the acreage dedicated to the subject well by colored pencil or hatchure marks on the plat below.
2. If more than one lease is dedicated to the well, outline each and identify the ownership thereof (both as to working interest and royalty).
3. If more than one lease of different ownership is dedicated to the well, have the interests of all owners been consolidated by communitization, unitization, force-pooling, etc?

☒ Yes    ☐ No    If answer is "yes," type of consolidation Unitization

If answer is "no," list the owners and tract descriptions which have actually been consolidated. (Use reverse side of this form if necessary.) \_\_\_\_\_

No allowable will be assigned to the well until all interests have been consolidated (by communitization, unitization, forced-pooling, or otherwise) or until a non-standard unit, eliminating such interests, has been approved by the Division.

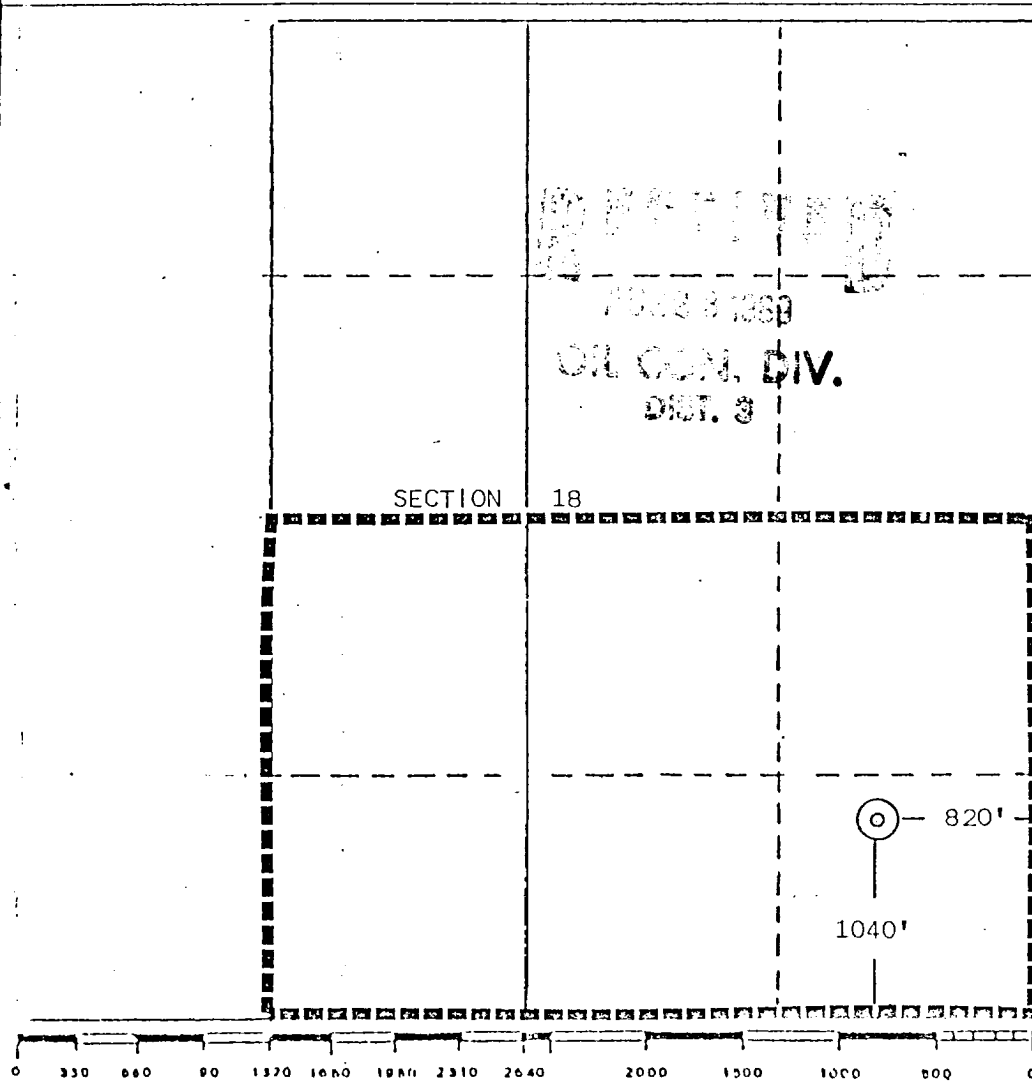

## CERTIFICATION

I hereby certify that the information contained herein is true and complete to the best of my knowledge and belief.

*Mike J. Sundrough*  
Name  
Senior Engineer  
Position  
Northwest Pipeline Corp.  
Company  
5-3-88  
Date

I hereby certify that the location shown on this plat was plotted in the field notes of actual survey made by me or under my supervision and that the same is true and correct to the best of my knowledge and belief.

Date Surveyed  
**April 25, 1988**  
Registered Professional Engineer and/or Land Surveyor  
*Edgar L. Risenhoover*  
Certificate No. 5979  
**Edgar L. Risenhoover, L.S.**



STATE OF NEW MEXICO

ENERGY, MINERALS AND NATURAL RESOURCES DEPARTMENT  
OIL CONSERVATION DIVISION  
**NORTHWEST PIPELINE CORPORATION**

**JUL 25 1989**

GARREY CARRUTHERS  
GOVERNOR

**PRODUCTION AND DRILLING**

POST OFFICE BOX 2088  
STATE LAND OFFICE BUILDING  
SANTA FE, NEW MEXICO 87504  
(505) 827-5800

July 19, 1989

Northwest Pipeline Corporation  
P.O. Box 90  
Farmington, NM 87499

Attention: Mike Turnbaugh,  
Senior Engineer

RE: Application for a  
non-standard gas  
proration unit; Rosa  
Unit Well No. 203,  
1040' FSL - 820' FEL  
(Unit P), Section  
18, Township 31  
North, Range 5 West.

Dear Mr. Turnbaugh:

The subject application shows that the proposed Rosa Unit Well No. 203 will be located in the SE/4 of said Section 18, which, pursuant to Rule 7 of the Special Rules and Regulations for the Basin-Fruitland Coal (Gas) Pool, as promulgated by Division Order No. R-8768, is an unorthodox coal gas well location.

I will therefore hold this application until such time as a request for administrative approval on this well's location is filed.

If you should have any questions concerning this matter, please contact me.

Sincerely,

Michael E. Stogner  
Administrative Application Reviewer

MES/ag

cc: Oil Conservation Division - Aztec