

STATE OF NEW MEXICO

ENERGY, MINERALS AND NATURAL RESOURCES DEPARTMENT

OIL CONSERVATION DIVISION

GARREY CARFUTHERS  
GOVERNOR

POST OFFICE BOX 2088  
STATE LAND OFFICE BUILDING  
SANTA FE, NEW MEXICO 87504  
(505) 827-5800

August 23, 1989

Northwest Pipeline Corporation  
P.O. Box 90  
Farmington, NM 87401

Attention: Mike Turnbaugh

Administrative Order NSP-1582

Dear Mr. Turnbaugh:

Reference is made to your application of May 17, 1989, for a 231.83-acre non-standard gas proration unit consisting of the following acreage in the Basin Fruitland Coal Gas Pool:

RIO ARriba COUNTY, NEW MEXICO  
~~TOWNSHIP 31 NORTH, RANGE 5 WEST, NE 1/4~~  
~~Section 18.~~ Lots 3 and 4 and the SE/4

It is my understanding that this unit is to be dedicated to your Rosa Unit Well No. 203 which is located at a previously authorized unorthodox coal gas well location pursuant to Decretory Paragraph No. 4 of Division Order No. R-8768, 1040 feet from the South line and 820 feet from the East line (Unit P) of said Section 18.

By authority granted me under the provisions of Rule 6 of the Special Rules and Regulations for the Basin-Fruitland Coal Gas Pool, as promulgated by said Order No. R-8768, the above non-standard gas proration unit is hereby approved.

Sincerely,

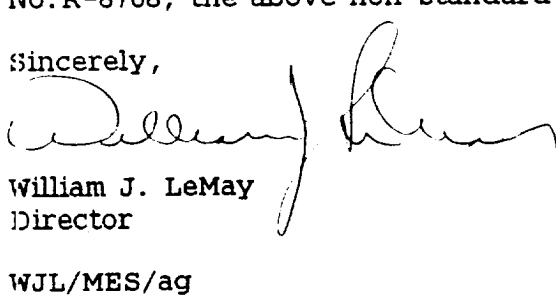
  
William J. LeMay  
Director

WJL/MES/ag

cc: Oil Conservation Division - Aztec  
NM Oil and Gas Engineering Committee - Hobbs  
US Bureau of Land Management - Farmington

RECEIVED  
OIL DIV.  
AUG 30 1989

NORTHWEST PIPELINE CORPORATION

PRODUCTION & DRILLING

3539 East 30th Street

Farmington, New Mexico 87401

4320-PD-072-89

July 25, 1989

State Of New Mexico  
Oil Conservation Division  
P.O. Box 2088  
Santa Fe, New Mexico 87504

Reference: Rosa Unit Well No. 203

Mr. Stogner:

The subject well was drilled in 1988 prior to the implementation of the current "Basin Fruitland Pool", rules (Order No. 8768), requiring wells to be staked in the NE and SW quarters.

Northwest Pipeline will require unorthodox location approved at this well.

Sincerely,

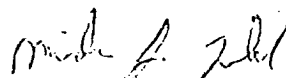

Michael J. Turnbaugh  
Senior Engineer

hv/4JT165

**RECEIVED**  
AUG 1 5 1989  
OIL CON. DIV.



STATE OF NEW MEXICO

ENERGY, MINERALS AND NATURAL RESOURCES DEPARTMENT  
OIL CONSERVATION DIVISION

NORTHWEST PIPELINE  
CORPORATION

JUL 25 1989

GARREY CARRUTHERS  
GOVERNOR

PRODUCTION AND DRILLING

POST OFFICE BOX 2088  
STATE LAND OFFICE BUILDING  
SANTA FE, NEW MEXICO 87504  
(505) 827-5800

July 19, 1989

Northwest Pipeline Corporation  
P.O. Box 90  
Farmington, NM 87499

Attention: Mike Turnbaugh,  
Senior Engineer

RE: Application for a  
non-standard gas  
production unit; Rosa  
Unit Well No. 203,  
1040' FSL - 820' FEL  
(Unit P), Section  
18, Township 31  
North, Range 5 West.

Dear Mr. Turnbaugh:

The subject application shows that the proposed Rosa Unit Well No. 203 will be located in the SE/4 of said Section 18, which, pursuant to Rule 7 of the Special Rules and Regulations for the Basin-Fruitland Coal (Gas) Pool, as promulgated by Division Order No. R-8768, is an unorthodox coal gas well location.

I will therefore hold this application until such time as a request for administrative approval on this well's location is filed.

If you should have any questions concerning this matter, please contact me.

Sincerely,

Michael E. Stogner  
Administrative Application Reviewer

MES/ag

cc: Oil Conservation Division - Aztec

RECEIVED

AUG 5 1989

OIL CON. DIV.

All distances must be from the outer boundaries of the Section.

Operator Northwest Pipeline Corporation		Lease Rosa Unit		Well No. 203	
Unit Letter P	Section 18	Township 31 North	Range 5 West	County Rio Arriba	
Actual Footage Location of Well: 1040 feet from the South line and 820 feet from the East line					
Ground Level Elev. 6422	Producing Formation Fruitland		Pool Undesignated Fruitland		Dedicated Acreage: 160 231.83 acres

1. Outline the acreage dedicated to the subject well by colored pencil or hachure marks on the plat below.
2. If more than one lease is dedicated to the well, outline each and identify the ownership thereof (both as to working interest and royalty).
3. If more than one lease of different ownership is dedicated to the well, have the interests of all owners been consolidated by communitization, unitization, force-pooling, etc?

☒ Yes ☐ No If answer is "yes," type of consolidation Unitization

If answer is "no," list the owners and tract descriptions which have actually been consolidated. (Use reverse side of this form if necessary.)

No allowable will be assigned to the well until all interests have been consolidated (by communitization, unitization, forced-pooling, or otherwise) or until a non-standard unit, eliminating such interests, has been approved by the Division.

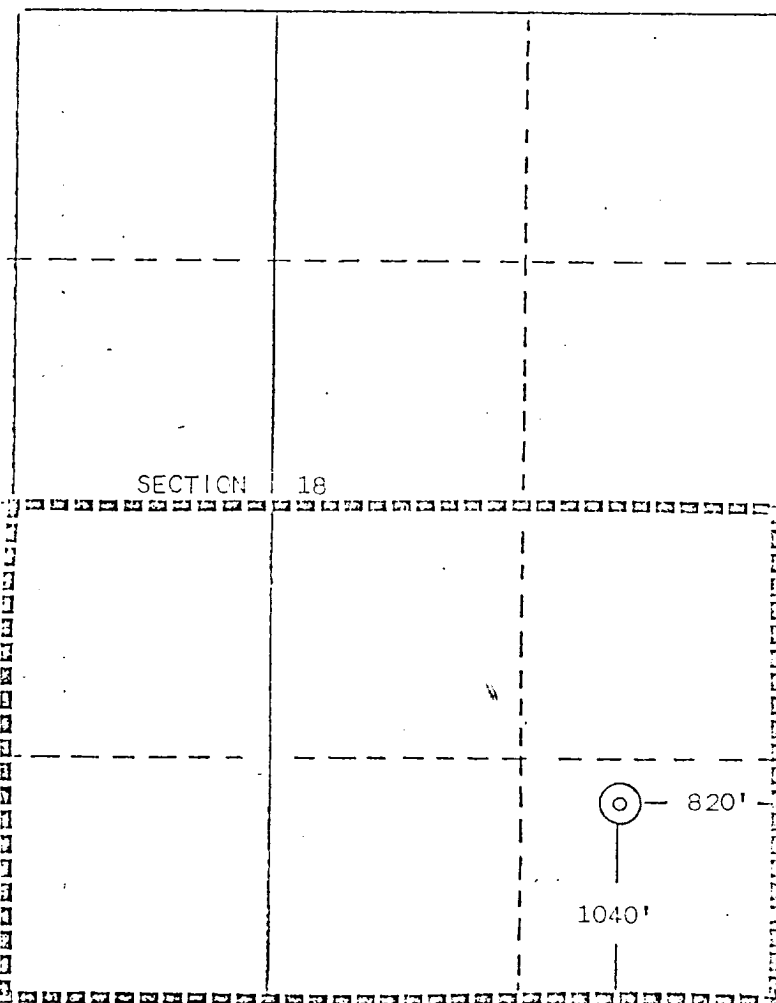

#### CERTIFICATION

I hereby certify that the information contained herein is true and complete to the best of my knowledge and belief.

Mike J. Sundberg  
Name

Senior Engineer  
Position

Northwest Pipeline Corp.  
Company

5-3-83  
Date

I hereby certify that the location shown on this plat was obtained from field notes of fact, made by me or under my supervision and that the same is true and correct to the best of my knowledge and belief.

Date Surveyed

April 25, 1988

Registered Professional Engineer  
and/or Land Surveyor

Edgar L. Risenhoover

Certificate No. 5979

Edgar L. Risenhoover, L.S.

330 660 990 1320 1650 1980 2310 2640 2970 3300 3630 3960 4290 4620 4950 5280 5610 5940 6270 6600