

UNITED STATES  
DEPARTMENT OF THE INTERIOR  
BUREAU OF LAND MANAGEMENT

APPLICATION FOR PERMIT TO DRILL, DEEPEN, OR PLUG BACK

1a. TYPE OF WORK DRILL <input checked="" type="checkbox"/> DEEPEN <input type="checkbox"/> PLUG BACK <input type="checkbox"/>		5. LEASE DESIGNATION AND SERIAL NO. SF-078764 & 079165
b. TYPE OF WELL OIL WELL <input type="checkbox"/> GAS WELL <input type="checkbox"/> OTHER <input type="checkbox"/>		6. IF INDIAN, ALLOTTEE OR TRIBE NAME
2. NAME OF OPERATOR Northwest Pipeline Corporation		7. UNIT AGREEMENT NAME Rosa Unit
3. ADDRESS OF OPERATOR 3539 East 30th - Farmington, NM 87401		8. FARM OR LEASE NAME Rosa Unit
4. LOCATION OF WELL (Report location clearly and in accordance with any State requirements.)* At surface 1265' FNL & 1475' FEL NW/4 NE/4 At proposed prod. zone Same		9. WELL NO. #200
14. DISTANCE IN MILES AND DIRECTION FROM NEAREST TOWN OR POST OFFICE* Approximately 20 miles to Gobernador		10. FIELD AND POOL, OR WILDCAT Basin Fruitland Pool
15. DISTANCE FROM PROPOSED* LOCATION TO NEAREST PROPERTY OR LEASE LINE, FT. (Also to nearest drlg. unit line, if any) 1265'		11. SEC., T., R., M., OR BLK. AND SURVEY OR AREA K Sec. 29, T31N, R5W
16. NO. OF ACRES IN LEASE #A 2507.30		12. COUNTY OR PARISH 13. STATE Rio Arriba New Mexico
17. NO. OF ACRES ASSIGNED TO THIS WELL 320		
18. DISTANCE FROM PROPOSED LOCATION* TO NEAREST WELL, DRILLING, COMPLETED, OR APPLIED FOR, ON THIS LEASE, FT. + 8000'		20. ROTARY OR CABLE TOOLS Rotary
19. PROPOSED DEPTH 3267'		22. APPROX. DATE WORK WILL START* March 1, 1989
21. ELEVATIONS (Show whether DF, RT, GR, etc.) 6200' CD		

PROPOSED CASING AND CEMENTING PROGRAM

	SIZE OF CASING	WEIGHT PER FOOT	SETTING DEPTH	QUANTITY OF CEMENT
12-1/4"	9-5/8"	32#	200'	125 cu.ft.
8-3/4"	7"	20#	3127'	150 cu.ft.
6-1/4"	5-1/2"	23#	3127'-3267'	Open hole completion

The E/2 of Section 29 is dedicated to this well.

RECEIVED  
APR 17 1989  
OIL CON. DIV  
DIST. 3

IN ABOVE SPACE DESCRIBE PROPOSED PROGRAM: If proposal is to deepen or plug back, give data on present productive zone and proposed new productive zone. If proposal is to drill or deepen directionally, give pertinent data on subsurface locations and measured and true vertical depths. Give blowout preventer program, if any.

SIGNED <u>mike Zuley</u>	TITLE <u>Sr. Engineer</u>	DATE <u>11-8-88</u>
(This space for Federal or State office use)		
PERMIT NO. _____	APPROVAL DATE _____	
APPROVED BY _____	TITLE _____	
CONDITIONS OF APPROVAL, IF ANY:		

APPROVED  
AS ATTACHED  
APR 13 1989  
AREA MANAGER

\*See Instructions On Reverse Side

All distances must be from the outer boundaries of the Section.

Operator Northwest Pipeline Corporation			Lease Rosa Unit		Well No. 200
Unit Letter B	Section 29	Township 31 North	Range 5 West	County Rio Arriba	
Actual Footage Location of Well:					
1255 feet from the North line and		1475 feet from the East line			
Ground Level Elev. 6368	Producing Formation Fruitland	Pool Basin Fld. Coal		Dedicated Acreage 320 Acres	

1. Outline the acreage dedicated to the subject well by colored pencil or hatchure marks on the plat below.
2. If more than one lease is dedicated to the well, outline each and identify the ownership thereof (both as to working interest and royalty).
3. If more than one lease of different ownership is dedicated to the well, have the interests of all owners been consolidated by communitization, unitization, force-pooling, etc?

☒ Yes ☐ No If answer is "yes," type of consolidation unitization

If answer is "no," list the owners and tract descriptions which have actually been consolidated. (Use reverse side of this form if necessary.)

\_\_\_\_\_ will be assigned to the well until all interests have been consolidated (by communitization, unitization, otherwise), or until a non-standard unit, eliminating such interests, has been approved by the Division.

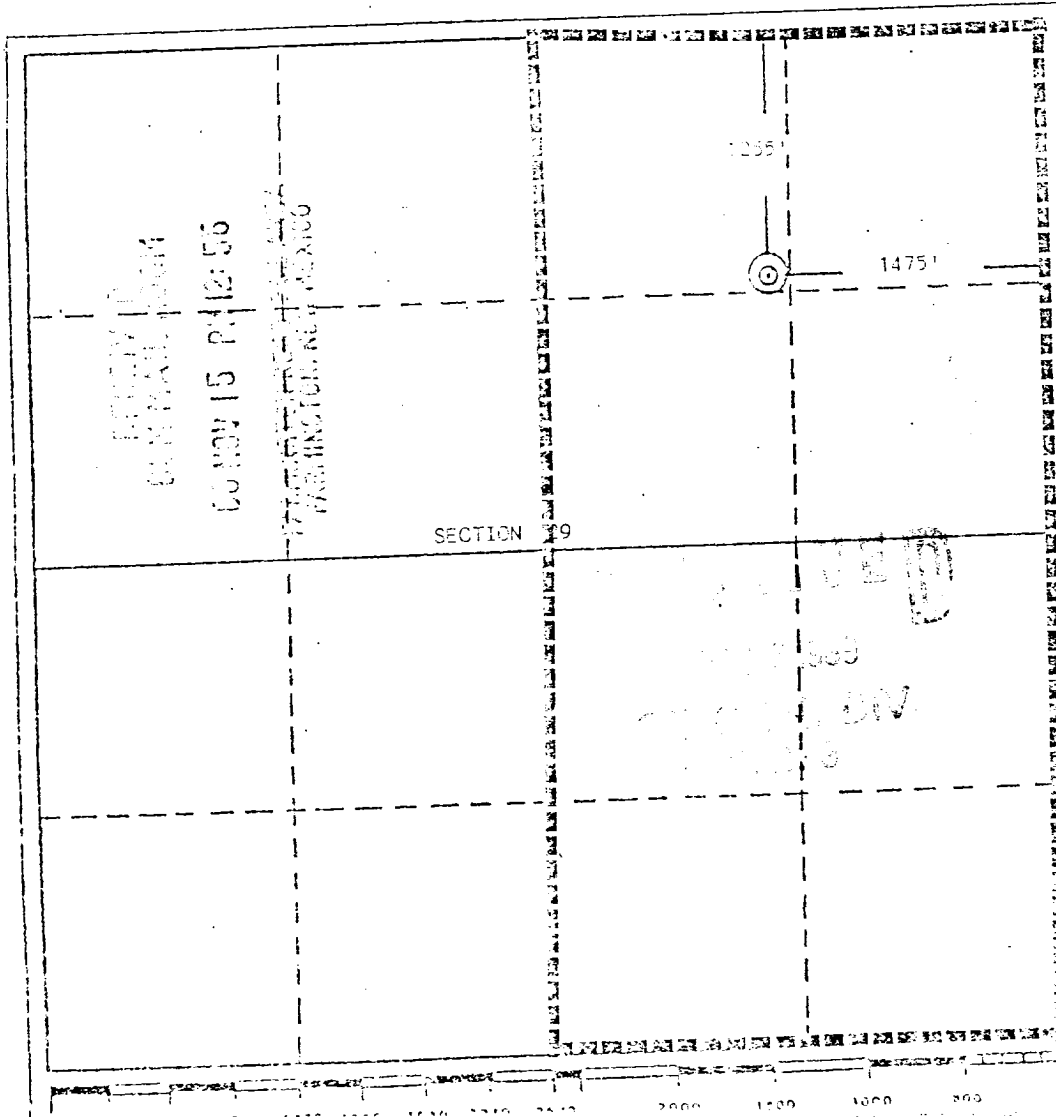

CERTIFICATION

I hereby certify that the information contained hereon is true and complete to the best of my knowledge and belief.

Mike Tumbrough  
Name  
Mike Tumbrough  
Position  
Senior Engineer  
Company  
Northwest Pipeline Corp.  
Date  
10-21-82

I hereby certify that the location shown on the map is correct and that the notes and/or survey data are correct and under my supervision and that the same is true and correct to the best of my knowledge and belief.

Date Surveyed  
September 21, 1982  
Registered Professional Engineer and/or Land Surveyor

Edgar L. Risen  
Certificate No. 5079  
Edgar L. Risen, P.E.