

UNITED STATES  
DEPARTMENT OF THE INTERIOR  
BUREAU OF LAND MANAGEMENT

30-039-24425

APPLICATION FOR PERMIT TO DRILL, DEEPEN, OR PLUG BACK

1a. TYPE OF WORK DRILL <input checked="" type="checkbox"/> DEEPEN <input type="checkbox"/> PLUG BACK <input type="checkbox"/>			5. LEASE DESIGNATION AND SERIAL NO. SF-078764		
b. TYPE OF WELL OIL WELL <input type="checkbox"/> GAS WELL <input checked="" type="checkbox"/> OTHER <input type="checkbox"/>			6. IF INDIAN, ALLOTTEE OR TRIBE NAME		
2. NAME OF OPERATOR Northwest Pipeline Corporation			7. UNIT AGREEMENT NAME Rosa Unit		
3. ADDRESS OF OPERATOR 3539 East 30th Street - Farmington, NM 87401			8. FARM OR LEASE NAME Rosa Unit		
4. LOCATION OF WELL (Report location clearly and in accordance with any State requirements.)* At surface 1205' FNL & 1185' FEL NE/4 NE/4 At proposed prod. zone Same			9. WELL NO. #223		
14. DISTANCE IN MILES AND DIRECTION FROM NEAREST TOWN OR POST OFFICE* Approximately 20 miles to Gobernador			10. FIELD AND POOL, OR WILDCAT Basin Fruitland Pool		
15. DISTANCE FROM PROPOSED* LOCATION TO NEAREST PROPERTY OR LEASE LINE, FT. (Also to nearest drlg. unit line, if any) 1185'			11. SEC., T., R., M., OR BLK. AND SURVEY OR AREA A Sec. 30, T31N, R5W		
16. NO. OF ACRES IN LEASE N/A 2507.30			12. COUNTY OR PARISH Rio Arriba		
17. NO. OF ACRES ASSIGNED TO THIS WELL 232.69			13. STATE New Mexico		
18. DISTANCE FROM PROPOSED LOCATION* TO NEAREST WELL, DRILLING, COMPLETED, OR APPLIED FOR, ON THIS LEASE, FT. + 4000'			20. ROTARY OR CABLE TOOLS Rotary		
21. ELEVATIONS (Show whether DF, RT, GR, etc.) 6361' GR			22. APPROX. DATE WORK WILL START* 3-1-89		
23. PROPOSED CASING AND CEMENTING PROGRAM This action is subject to technical and procedural review pursuant to 43 CFR 3105.1 and 3105.4. DRILLING OPERATIONS AUTHORIZED ARE SUBJECT TO COMPLIANCE WITH ATTACHED GENERAL REQUIREMENTS					
SIZE OF HOLE	SIZE OF CASING	WEIGHT PER FOOT	SETTING DEPTH	GENERAL REQUIREMENTS	
12-1/4"	9-5/8"	32.3#	200'	125 cu.ft.	
8-3/4"	7"	20#	3067'	145 cu.ft.	
6-1/4"	5-1/2"	23#	3235'	Open hole completion	

The N/2 of Section 30 is dedicated to this well.

RECEIVED  
BLM MAIL ROOM  
88 NOV 10 PM 3:19  
FARMINGTON RESOURCE AREA  
FARMINGTON, NEW MEXICO

RECEIVED  
MAY 15 1989  
OIL CON. DIV.  
DIST. 3

IN ABOVE SPACE DESCRIBE PROPOSED PROGRAM: If proposal is to deepen or plug back, give data on present productive zone and proposed new productive zone. If proposal is to drill or deepen directionally, give pertinent data on subsurface locations and measured and true vertical depths. Give blowout preventer program, if any.

24. SIGNED <u>Mike J. Lornbaugh</u> (This space for Federal or State office use)		TITLE <u>Sr. Engineer</u>		DATE <u>11-8-88</u>	
PERMIT NO. _____		APPROVAL DATE _____		APPROVED AS AMENDED <u>kr</u>	
APPROVED BY _____		TITLE _____		MAY 09 1989	
CONDITIONS OF APPROVAL, IF ANY:				JOEL FARRELL FOR AREA MANAGER	

ch-1

NSP-1561

NMDCB

\*See Instructions On Reverse Side

**NEW MEXICO OIL CONSERVATION COMMISSION  
WELL LOCATION AND ACREAGE DEDICATION PLAT**

Form C-102  
Supersedes C-128  
Effective 1-1-65

All distances must be from the outer boundaries of the Section.

Operator Northwest Pipeline Corporation			Lease Rosa Unit		Well No. 223
Unit Letter A	Section 30	Township 31 North	Range 5 West	County Rio Arriba	
Actual Footage Location of Well: 1205 feet from the North line and 1185 feet from the East line					
Ground Level Elev. 6361	Producing Formation Fruitland	Pool Basin Fruitland Pool		Dedicated Acreage: 232.69 Acres	

1. Outline the acreage dedicated to the subject well by colored pencil or hachure marks on the plat below.
2. If more than one lease is dedicated to the well, outline each and identify the ownership thereof (both as to working interest and royalty).
3. If more than one lease of different ownership is dedicated to the well, have the interests of all owners been consolidated by communitization, unitization, force-pooling, etc?

☒ Yes    ☐ No    If answer is "yes," type of consolidation unitization

If answer is "no," list the owners and tract descriptions which have actually been consolidated. (Use reverse side of this form if necessary.)

No allowable will be assigned to the well until all interests have been consolidated (by communitization, unitization, forced-pooling, or otherwise) or until a non-standard unit, eliminating such interests, has been approved by the Commission.

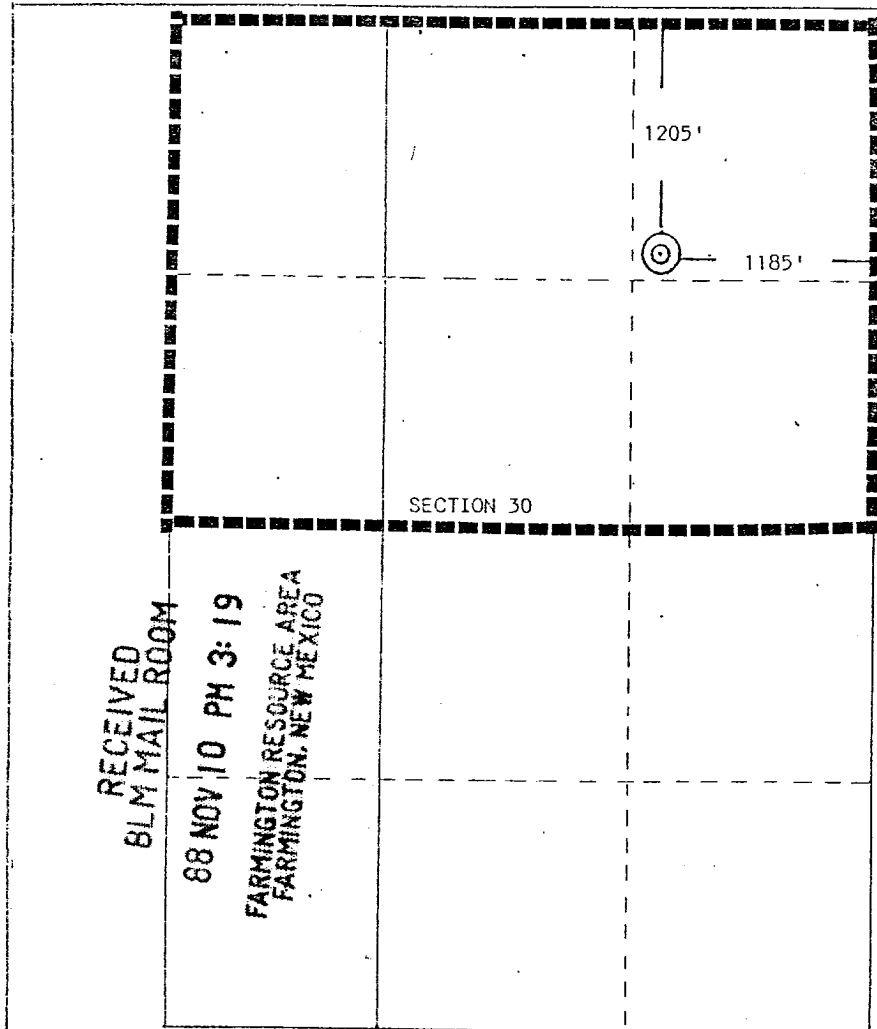

**CERTIFICATION**

I hereby certify that the information contained herein is true and complete to the best of my knowledge and belief.

*Mike Turnbaugh*

Name

Mike Turnbaugh

Position

Senior Engineer

Company

Northwest Pipeline Corp.

Date

10-21-88

I hereby certify that the well location shown on this plat was taken from field notes or actual surveys made by me or under my supervision, and that the same is true and correct to the best of my knowledge and belief.

Date Surveyed

September 26, 1988

Registered Professional Engineer and/or Land Surveyor

*Edgar L. Risenhoover*

Certificate No. 5979

Edgar L. Risenhoover, L.S.

