

UNITED STATES  
DEPARTMENT OF THE INTERIOR  
BUREAU OF LAND MANAGEMENT

APPLICATION FOR PERMIT TO DRILL, DEEPEN, OR PLUG BACK

|  |                |                                      |               |  |  |
|--|----------------|--------------------------------------|---------------|--|--|
| 1a. TYPE OF WORK<br>DRILL <input checked="" type="checkbox"/> DEEPEN <input type="checkbox"/> PLUG BACK <input type="checkbox"/>   |                |                                      |               | 5. LEASE DESIGNATION AND SERIAL NO.<br>SF-078771       |  |
| b. TYPE OF WELL<br>OIL WELL <input type="checkbox"/> GAS WELL <input checked="" type="checkbox"/> OTHER <input type="checkbox"/>   |                |                                      |               | 6. IF INDIAN, ALLOTTEE OR TRIBE NAME                   |  |
| 2. NAME OF OPERATOR<br>Northwest Pipeline Corporation  |                |                                      |               | 7. UNIT AGREEMENT NAME<br>Rosa Unit                    |  |
| 3. ADDRESS OF OPERATOR<br>3539 E. 30th Street - Farmington, NM 87401   |                |                                      |               | 8. FARM OR LEASE NAME<br>Rosa Unit                     |  |
| 4. LOCATION OF WELL (Report location clearly and in accordance with any State requirements.)*<br>At surface 795' FSL & 1730' FWL SE/4 SW/4<br>At proposed prod. zone Same                      |                |                                      |               | 9. WELL NO.<br>#214                                    |  |
| 14. DISTANCE IN MILES AND DIRECTION FROM NEAREST TOWN OR POST OFFICE*<br>Approximately 20 miles to Gobernador  |                |                                      |               | 10. FIELD AND POOL, OR WILDCAT<br>Basin Fruitland Pool |  |
| 15. DISTANCE FROM PROPOSED* LOCATION TO NEAREST PROPERTY OR LEASE LINE, FT.<br>(Also to nearest drlg. unit line, if any) 795'  |                | 16. NO. OF ACRES IN LEASE<br>NA 2560 |               | 17. NO. OF ACRES ASSIGNED TO THIS WELL<br>320          |  |
| 18. DISTANCE FROM PROPOSED LOCATION* TO NEAREST WELL, DRILLING, COMPLETED, OR APPLIED FOR, ON THIS LEASE, FT.<br>+ 2500'   |                | 19. PROPOSED DEPTH<br>3159'          |               | 20. ROTARY OR CABLE TOOLS<br>Rotary                    |  |
| 21. ELEVATIONS (Show whether DF, RT, GR, etc.)<br>6339' GR   |                |                                      |               | 22. APPROX. DATE WORK WILL START*<br>March 1, 1989     |  |
| 23. PROPOSED CASING AND CEMENTING PROGRAM<br>GENERAL REQUIREMENTS<br>This action is subject to technical and procedural review pursuant to 43 CFR 3165.3 and appeal pursuant to 43 CFR 3165.4. |                |                                      |               |  |  |
| SIZE OF HOLE   | SIZE OF CASING | WEIGHT PER FOOT                      | SETTING DEPTH |  |  |
| 12-1/4"  | 9-5/8"         | 32#                                  | 200'          | 125 cu. ft.  |  |
| 8-3/4"   | 7"             | 20#                                  | 3000'         | 150 cu. ft.  |  |
| 5-1/4"   | 5-1/2"         | 23#                                  | 3159'         | Open hole completion                                   |  |

The W/2 of Section 14 is dedicated to this well.

RECEIVED  
MAY 15 1989  
AL CON. DIV.  
DIST. 3

IN ABOVE SPACE DESCRIBE PROPOSED PROGRAM: If proposal is to deepen or plug back, give data on present productive zone and proposed new productive zone. If proposal is to drill or deepen directionally, give pertinent data on subsurface locations and measured and true vertical depths. Give blowout preventer program, if any.

24. SIGNED Mike Turnbaugh TITLE Senior Engineer DATE 12-19-88  
(This space for Federal or State office use)

PERMIT NO. \_\_\_\_\_ APPROVAL DATE \_\_\_\_\_  
APPROVED BY \_\_\_\_\_ TITLE \_\_\_\_\_  
CONDITIONS OF APPROVAL, IF ANY:

ch-1

\*See Instructions On Reverse Side

Title 18 U.S.C. Section 1001, makes it a crime for any person knowingly and willfully to make to any department or agency of the United States any false, fictitious or fraudulent statements or representations as to any matter within its jurisdiction.

APPROVED K4  
AS AMENDED  
MAY 09 1989  
Joel Farrell

FOR AREA MANAGER

All distances must be from the outer boundaries of the Section.

|   |                                  |                              |                                 |                      |
|---|----------------------------------|------------------------------|---------------------------------|----------------------|
| Operator<br>Northwest Pipeline Corporation  |                                  | Lease<br>Rosa Unit           |                                 | Well No.<br>214      |
| Unit Letter<br>N  | Section<br>14                    | Township<br>31 North         | Range<br>6 West                 | County<br>Rio Arriba |
| Actual Footage Location of Well:<br>795 feet from the South line and 1730 feet from the West line |                                  |                              |                                 |                      |
| Ground Level Elev.<br>6339  | Producing Formation<br>Fruitland | Pool<br>Basin Fruitland Pool | Dedicated Acreage:<br>320 Acres |                      |

1. Outline the acreage dedicated to the subject well by colored pencil or hachure marks on the plat below.
2. If more than one lease is dedicated to the well, outline each and identify the ownership thereof (both as to working interest and royalty).
3. If more than one lease of different ownership is dedicated to the well, have the interests of all owners been consolidated by communitization, unitization, force-pooling, etc?

☒ Yes ☐ No If answer is "yes," type of consolidation unitization

If answer is "no," list the owners and tract descriptions which have actually been consolidated. (Use reverse side of this form if necessary.)

No allowable will be assigned to the well until all interests have been consolidated (by communitization, unitization, forced-pooling, or otherwise) or until a non-standard unit, eliminating such interests, has been approved by the Division.

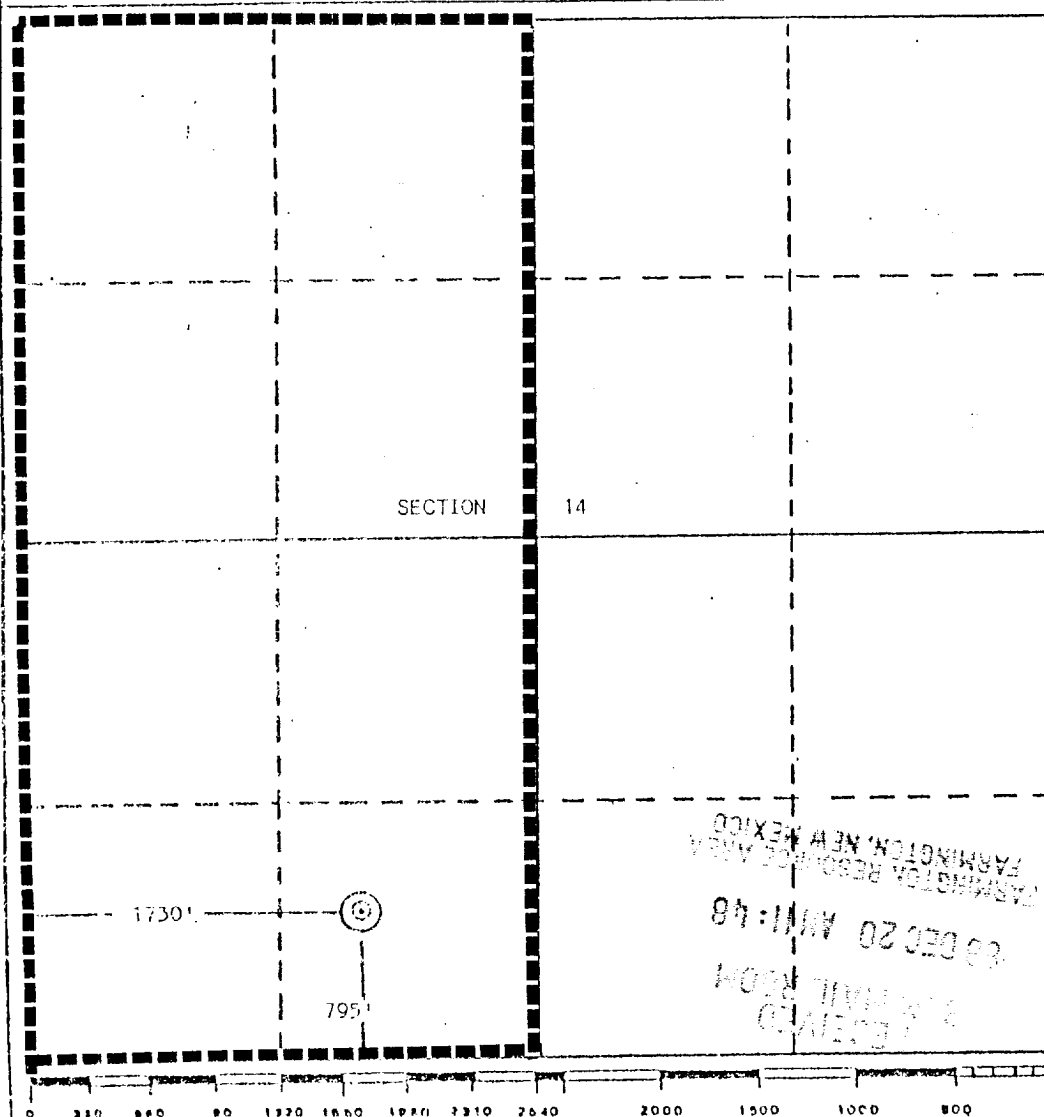

#### CERTIFICATION

I hereby certify that the information contained herein is true and complete to the best of my knowledge and belief.

*Mike Turnbaugh*

Name

Mike Turnbaugh

Position

Senior Engineer

Company

Northwest Pipeline Corp.

Date

10-21-88

I hereby certify that the well location shown on this plat was plotted from field notes of actual surveys made by me or under my supervision, and that the same is true and correct to the best of my knowledge and belief.

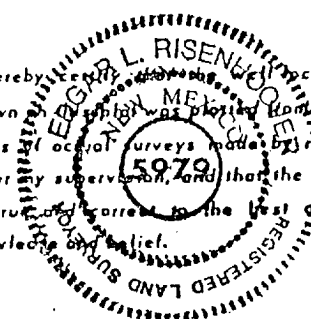

Date Surveyed

September 14, 1988

Registered Professional Engineer and/or Land Surveyor

*Edgar L. Risenhoover*

Certificate No. 5979

Edgar L. Risenhoover, L.S.



NORTHWEST PIPELINE CORP.

ROSA UNIT 214

1795' F/SL      1730' F/WL  
Sec. 14, T-31-N, R-6-W, NMPM  
Rio Arriba County, New Mexico

SCALE 1:24 000

