

UNITED STATES  
DEPARTMENT OF THE INTERIOR  
BUREAU OF LAND MANAGEMENT

30-039-24496

APPLICATION FOR PERMIT TO DRILL, DEEPEN, OR PLUG BACK

1a. TYPE OF WORK  
DRILL ☒ DEEPEN ☐ PLUG BACK ☐

b. TYPE OF WELL  
OIL WELL ☐ GAS WELL ☒ OTHER ☐ SINGLE ZONE ☒ MULTIPLE ZONE ☐

2. NAME OF OPERATOR  
Northwest Pipeline Corporation

3. ADDRESS OF OPERATOR  
3539 East 30th Street - Farmington, NM 87401

4. LOCATION OF WELL (Report location clearly and in accordance with any State requirements.)\*  
At surface 1025' FWL & 1750' FSL NW/4 SW/4

At proposed prod. zone  
Same

14. DISTANCE IN MILES AND DIRECTION FROM NEAREST TOWN OR POST OFFICE\*  
Approximately 20 miles to Gobernador

15. DISTANCE FROM PROPOSED\*  
LOCATION TO NEAREST  
PROPERTY OR LEASE LINE, FT.  
(Also to nearest drlg. unit line, if any) 1025'

16. NO. OF ACRES IN LEASE  
N/A 2507.30

17. NO. OF ACRES ASSIGNED  
TO THIS WELL W/320

18. DISTANCE FROM PROPOSED LOCATION\*  
TO NEAREST WELL, DRILLING, COMPLETED,  
OR APPLIED FOR, ON THIS LEASE, FT. + 6000'

19. PROPOSED DEPTH  
3302'

20. ROTARY OR CABLE TOOLS  
Rotary

21. ELEVATIONS (Show whether DF, RT, GR, etc.)

22. APPROX. DATE WORK WILL START\*  
3-1-89

PROPOSED CASING AND CEMENTING PROGRAM

SIZE OF HOLE	SIZE OF CASING	WEIGHT PER FOOT	SETTING DEPTH	EST. QTY. QUANTITY OF CEMENT
12-1/4"	9-5/8"	32.3#	200'	125 cu.ft.
8-3/4"	7"	20#	3139'	145 cu.ft.
6-1/4"	5-1/2"	23#	3302'	Open hole completion

The W/2 of Section 29 is dedicated to this well.

RECEIVED  
JUL 19 1989  
OIL CON. DIV  
DIST. 3

IN ABOVE SPACE DESCRIBE PROPOSED PROGRAM: If proposal is to deepen or plug back, give data on present productive zone and proposed new productive zone. If proposal is to drill or deepen directionally, give pertinent data on subsurface locations and measured and true vertical depths. Give blowout preventer program, if any.

24.  
SIGNED Mike J. Turnbaugh  
(This space for Federal or State office use)

TITLE Sr. Engineer

APPROVED  
AS AMENDED

PERMIT NO. \_\_\_\_\_ APPROVAL DATE \_\_\_\_\_

APPROVED BY \_\_\_\_\_ TITLE \_\_\_\_\_  
CONDITIONS OF APPROVAL, IF ANY:

JUL 17 1989  
AREA MANAGER

ch-1

\*See Instructions On Reverse Side

All distances must be from the outer boundaries of the Section.

Operator Northwest Pipeline Corporation		Lease Rosa Unit		Well No. 229
Unit Letter L	Section 29	Township 31 North	Range 5 West	County Rio Arriba
Actual Footage Location of Well				
1750	feet from the South	line and	1025	feet from the West
Ground Level Elevation 6436	Producing Formation Fruitland	Pool Basin Fruitland	Dedicated Acreage: 320 Acres	

1. Outline the acreage dedicated to the subject well by colored pencil or hatchure marks on the plat below.
2. If more than one lease is dedicated to the well, outline each and identify the ownership thereof (both as to working interest and royalty).
3. If more than one lease of different ownership is dedicated to the well, have the interests of all owners been consolidated by communitization, unitization, force-pooling, etc?

☒ Yes ☐ No If answer is "yes," type of consolidation unitization

If answer is "no," list the owners and tract descriptions which have actually been consolidated. (Use reverse side of this form if necessary.)

No allowable will be assigned to the well until all interests have been consolidated (by communitization, unitization, forced-pooling, or otherwise) or until a non-standard unit, eliminating such interests, has been approved by the Division.

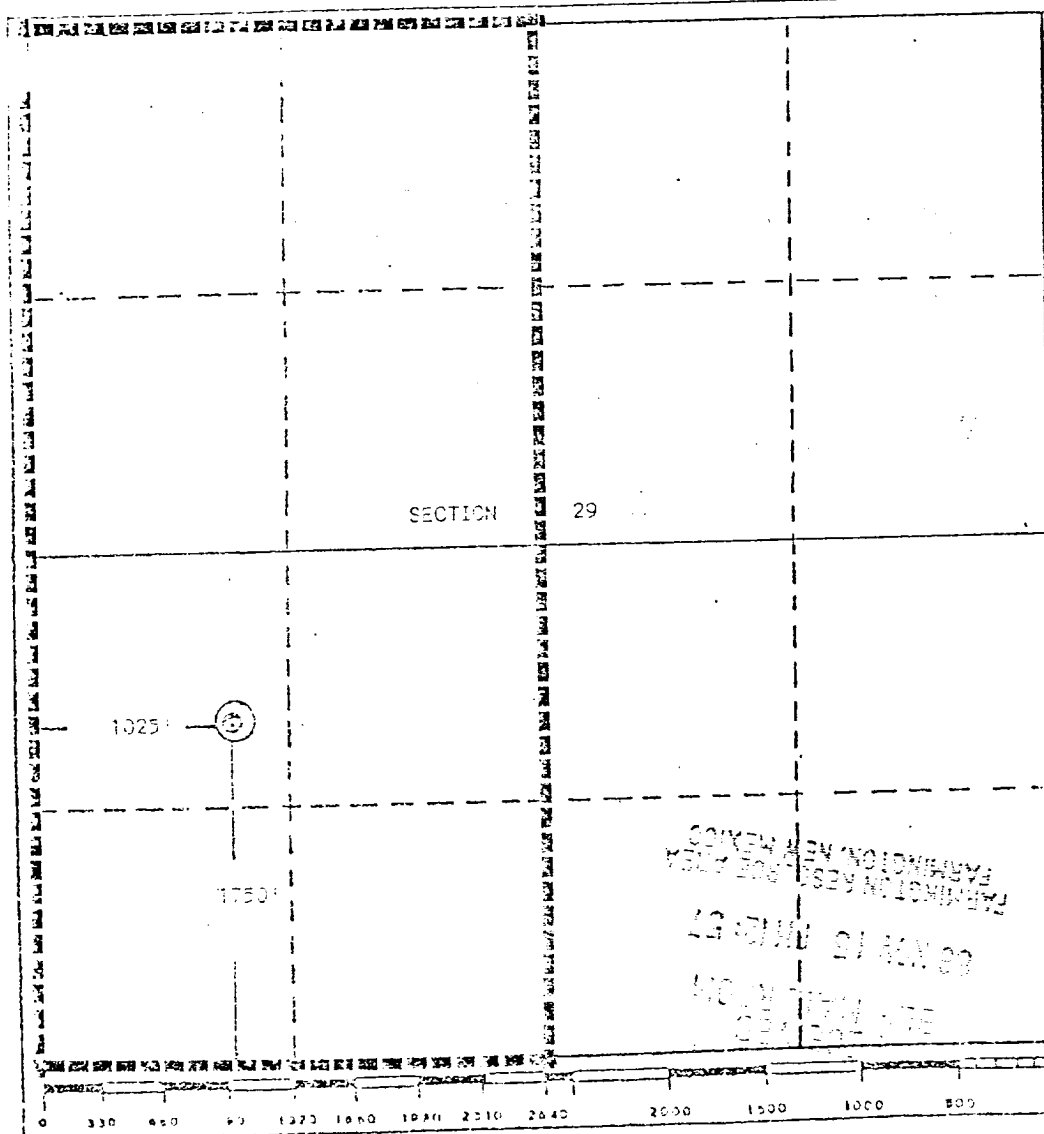

### CERTIFICATION

I hereby certify that the information contained herein is true and complete to the best of my knowledge and belief.

Mike Turnbaugh  
Name  
Mike Turnbaugh  
Position  
Senior Engineer  
Company  
Northwest Pipeline Corp.  
Date  
10-21-88

I hereby certify that the well location shown on this plat was plotted from field notes of actual surveys made by me or under my supervision, and that the same is true and correct to the best of my knowledge and belief.

Edgar L. Risenhoover  
Date Surveyed  
September 21, 1988  
Registered Professional Engineer  
and/or Land Surveyor  
Certificate No. 5979  
Edgar L. Risenhoover, L.S.