



STATE OF NEW MEXICO  
ENERGY, MINERALS AND NATURAL RESOURCES DEPARTMENT  
OIL CONSERVATION DIVISION

*Hold C-104 For  
Operator Change to  
Plat C*

GARREY CARRUTHERS  
GOVERNOR

October 9, 1990

POST OFFICE BOX 2088  
STATE LAND OFFICE BUILDING  
SANTA FE, NEW MEXICO 87504  
(505) 827-5800

**RECEIVED**  
OCT 15 1990  
OIL CON. DIV.  
DIST. 3

Meridian Oil, Inc.  
P.O. Box 4289  
Farmington, NM 87499-4289

Attention: Peggy Bradfield

Amended Administrative Order NSP-1576(L)

Dear Ms. Bradfield:

Reference is made to your applications dated July 31 and September 12, 1990 to amend the unorthodox location of your proposed Rosa Unit Well No. 238 (which was the subject of division Administrative Order NSP-1576(L), dated July 18, 1989) from the previously approved location 2270 feet from the South line and 1840 feet from the East line (Unit J) of Section 3, Township 31 North, Range 6 West, NMPM, Basin-Fruitland Coal Gas Pool, Rio Arriba County, New Mexico, to a new location being 2045 feet from the South line and 1960 feet from the East line (Unit J) of said Section 3.

It is our understanding that the proposed amendment is sought because of a survey error made by Northwest Pipeline Corporation, furthermore, such error was discovered because Meridian Oil, Inc., who assumed operatorship of the subject wellsite and the Rosa Unit on October 20, 1990, elected to verify the previously approved staked location as reported in Northwest Pipeline's original APD. The location of the stake was not moved, only the footages describing the staked location have been corrected.

The applicant in this matter, Meridian Oil, Inc. has made a proper filing to amend the subject location pursuant to Rule 8 of the Special Rules and Regulations for the Basin-Fruitland Coal Gas Pool as promulgated by Division Order No. R-8768. The subject application is hereby approved and said Order NSP-1576(L) is hereby amended to reflect the well location for the Rosa Unit No. 238 as 2045 feet from the South line and 1960 feet from the East line (Unit J) of said Section 3.

All other provisions of original Order NSP-1576(L) shall remain in full force and effect until further notice.

Sincerely,

William J. LeMay  
Director

WJL/MES/ag

cc: Oil Conservation Division - Aztec  
US Bureau of Land Management - Farmington  
US Bureau of Reclamation - Durango  
Northwest Pipeline Corporation - Farmington



STATE OF NEW MEXICO  
ENERGY AND MINERALS DEPARTMENT  
OIL CONSERVATION DIVISION  
AZTEC DISTRICT OFFICE

1000 RIO BRAZOS ROAD  
AZTEC, NEW MEXICO 87410  
(505) 334-0170

GARREY CARPENTERS  
GOVERNOR

Date: 10-3-90

ATTN: M. Hogen

Oil Conservation Division  
P.O. Box 2088  
Santa Fe, NM 87504-2088

Re: Proposed MC \_\_\_\_\_  
Proposed DHC \_\_\_\_\_  
Proposed NSL X \_\_\_\_\_  
Proposed SWD \_\_\_\_\_  
Proposed WFX \_\_\_\_\_  
Proposed PMX \_\_\_\_\_

Gentlemen:

I have examined the application dated 9-14-90  
for the Mendocino Oil Co. Block Unit # 238  
Operator Lease & Well No.

J-3-31N-6W and my recommendations are as follows:  
Unit, S-T-R

Approved  
\_\_\_\_\_  
\_\_\_\_\_  
\_\_\_\_\_  
\_\_\_\_\_

Yours truly,

Ernest Brails

# MERIDIAN OIL

September 12, 1990

Mr. William LeMay  
New Mexico Oil Conservation Division  
Post Office Box 2088  
Santa Fe, New Mexico 87501

**RECEIVED**  
SEP 14 1990

Re: Meridian Oil Inc. Rosa Unit #238  
2045'S, 1960'E, Section 3, T-31-N, R-6-W,  
Rio Arriba County, New Mexico  
Administrative Order NSP-1576 (L)

**OIL CON. DIV.**  
**DIST. 3**

Dear Mr. LeMay:

Meridian Oil Inc. is applying for amendment to NSP-1576(L) due to the relocation of the Rosa Unit #238 at the referenced footages.

This well was originally staked and permitted by Northwest Pipeline at 2270'S, 1840'E, Section 3, T-31-N, R-6-W on December 19, 1988 and approved July 12, 1989. The well was resurveyed and the stake was found by Meridian Oil Inc. at 2045'S, 1960'E, Section 3, T-31-N, R-6-W after assuming operatorship on October 20, 1989.

The following attachments are for your review:

1. Approved Application for Permit to Drill - submitted by Northwest Pipeline at 2270'S, 1840'E, Sec.3, T-31-N, R-6-W.
2. Completed C-102 at referenced footages, attached to sundry notice for corrected location.
3. Offset owners/operators plat and affidavit of notification to offset owners/operators.
4. 7.5 minute topographic map showing the orthodox windows for the south-half dedication, and enlargement of the map to define topographic features.
5. This well would be deemed economically unfeasible to drill directionally to a standard bottom hole location due to incremental directional drilling costs of \$95,000.00.
6. Archaeological report for corrected 2045'S, 1960'E location.
7. Copy of NSP-1576(L).

Please let me know if you require any other information.

Sincerely,



Peggy Bradfield

xc: Bureau of Land Management, Farmington District

New Mexico Oil Conservation Division - Aztec District

Meridian Oil Inc., 3535 East 30th St., P.O. Box 4289, Farmington, New Mexico 87499-4289, Telephone 505-327-0251

All distances must be from the outer boundaries of the Section.

Operator Northwest Pipeline Corporation			Lease Rosa Unit		Well No. 238
Unit Letter J	Section 3	Township 31 North	Range 6 West	County Rio Arriba	
Actual Footage Location of Well: 2270 feet from the South line and 1840 feet from the East line					
Ground Level Elev. 6365	Producing Formation Fruitland		Pool Basin Fruitland Pool		Dedicated Acres 352.87

1. Outline the acreage dedicated to the subject well by colored pencil or hachure marks on the plat below.
2. If more than one lease is dedicated to the well, outline each and identify the ownership thereof (both as to working interest and royalty).
3. If more than one lease of different ownership is dedicated to the well, have the interests of all owners been consolidated by communitization, unitization, force-pooling, etc?

☒ Yes ☐ No If answer is "yes," type of consolidation unitization

If answer is "no," list the owners and tract descriptions which have actually been consolidated. (Use reverse side of this form if necessary.)

No allowable will be assigned to the well until all interests have been consolidated (by communitization, unitization, forced-pooling, or otherwise) or until a non-standard unit, eliminating such interests, has been approved by the Division.

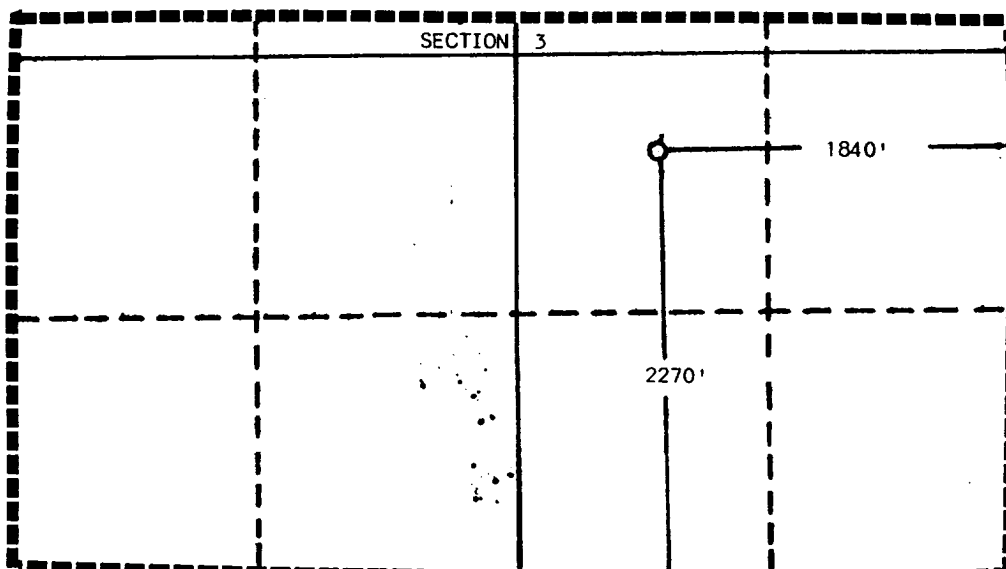

CERTIFICATION

I hereby certify that the information contained herein is true and complete to the best of my knowledge and belief.

*Mike Turnbaugh*

Name  
Mike Turnbaugh

Position  
Senior Engineer

Company  
Northwest Pipeline Corp.

Date  
11-1-88

I hereby certify that the well location shown on this plat was plotted from field notes of actual surveys made by me or under my supervision, and that the same is true and correct to the best of my knowledge and belief.

Date Surveyed  
September 28, 1988

Registered Professional Engineer  
and/or Land Surveyor

*Edgar L. Risenbower*  
Certificate No. 5070

HARTFORD PIPELINE CO.,

NO. 3A UNIT 233

2270' F/SI 1040' F/EL

Sec. 2, T-31-N, R-6-W, 103M

Rio Arriba County, New Mexico

WJL/MES/ag

cc: Oil Conservation Division - Aztec  
NM Oil and Gas Engineering Committee - Hobbs  
US Bureau of Land Management - Farmington