

UNITED STATES
DEPARTMENT OF THE INTERIOR
GEOLOGICAL SURVEY

30-039-24659

5. LEASE DESIGNATION AND SERIAL NO.
SF079010

6. IF INDIAN, ALLOTTEE OR TRIBE NAME

7. UNIT AGREEMENT NAME
Northeast Blanco

8. FARM OR LEASE NAME
Northeast Blanco Unit

9. WELL NO.
491

10. FIELD AND POOL, OR WILDCAT
Bastin Fruitland Coal

11. SEC., T., R., M., OR BLK.
AND SURVEY OR AREA
J
Sec. 25, T31N, R7W

12. COUNTY OR PARISH
Rio Arriba

13. STATE
NM

APPLICATION FOR PERMIT TO DRILL, DEEPEN, OR PLUG BACK

1a. TYPE OF WORK
DRILL ☒ DEEPEN ☐ PLUG BACK ☐

b. TYPE OF WELL
OIL WELL ☐ GAS WELL ☒ OTHER ☐ SINGLE ZONE ☒ MULTIPLE ZONE ☐

2. NAME OF OPERATOR
Blackwood and Nichols Co., Ltd.

3. ADDRESS OF OPERATOR
P.O. Box 1237, Durango, CO 81302-1237

4. LOCATION OF WELL (Report location clearly and in accordance with any State requirements.*)
At surface
1756' FSL - 1442' FEL
At proposed prod. zone

14. DISTANCE IN MILES AND DIRECTION FROM NEAREST TOWN OR POST OFFICE*
19 1/2 miles NE of Blanco, New Mexico

15. DISTANCE FROM PROPOSED*
LOCATION TO NEAREST
PROPERTY OR LEASE LINE, FT.
(Also to nearest drlg. unit line, if any) 1442'

16. NO. OF ACRES IN LEASE
520 2560

17. NO. OF ACRES ASSIGNED
TO THIS WELL
5/320

18. DISTANCE FROM PROPOSED LOCATION*
TO NEAREST WELL, DRILLING, COMPLETED,
OR APPLIED FOR, ON THIS LEASE, FT. 2100'

19. PROPOSED DEPTH
3222'

20. ROTARY OR CABLE TOOLS
Rotary

21. ELEVATIONS (Show whether DF, RT, GR, etc.)
6268' GL
This action is subject to technical and
procedural review pursuant to 43 CFR 3165.3
and appeal pursuant to 43 CFR 3165.3

22. APPROX. DATE WORK WILL START*
April 1, 1990

DRILLING OPERATIONS AUTHORIZED ARE SUBJECT TO COMPLIANCE WITH ATTACHED GENERAL REQUIREMENTS			
SIZE OF HOLE	SIZE OF CASING	WEIGHT PER FOOT	SETTING DEPTH
12 1/4"	9 5/8"	36#	300'
8 3/4"	7"	23 1/2#	2947'
6 1/4"	5 1/2"	17#	2847'-3222'
			295 cuft/circulate to surface
			940 cuft/circulate to surface
			39 cuft/circulate to liner top

Proposes to spud in the San Jose formation. Will drill a 12 1/4" hole to a TD of 300'. Run surface casing and cement with cement returns to surface. WOC 12 hours. Test to 600 psi/30 mins. Drill a 8 3/4" hole to a TD of 2947' using fresh water mud. No poisonous gases or abnormal pressures are anticipated. Run intermediate casing and cement with cement returns to surface. WOC 12 hours. Test to 1500 psi/30 mins. Drill a 6 1/4" hole to a TD of 3222' using water and air. Run a mud logging unit while drilling this interval. Run the production liner. The liner will be cemented if the wells natural flow capacity indicates the need for fracture stimulation.

Surface ownership is Bureau of Reclamation.

RECEIVED
MAR 16 1990
OIL CON. DIV.

IN ABOVE SPACE DESCRIBE PROPOSED PROGRAM: If proposal is to deepen or plug back, give data on present productive zone and proposed new productive zone. If proposal is to drill or deepen directionally, give pertinent data on subsurface locations and measured and true vertical depths. Give blowout preventer program, if any.

24. SIGNED William F. Clark TITLE Operations Manager DATE 24 Jan '90

(This space for Federal or State office use)

PERMIT NO. _____ APPROVAL DATE _____
APPROVED BY _____ TITLE _____
CONDITIONS OF APPROVAL, IF ANY: _____

APPROVED
AS AMENDED

MAR 12 1990

AREA MANAGER

*See Instructions On Reverse Side

NSL-2755

Q CG

RECEIVED
JUN 10 1967
OIL COM. DIV.
DIST. 3

Submit to Appropriate
District Office
State Lease - 4 copies
Fee Lease - 3 copies

State of New Mexico
Energy, Minerals and Natural Resources Department

Form C-102
Revised 1-1-89

OIL CONSERVATION DIVISION

P.O. Box 2088
Santa Fe, New Mexico 87504-2088

DISTRICT I
P.O. Box 1980, Hobbs, NM 88240

DISTRICT II
P.O. Drawer DD, Artesia, NM 88210

DISTRICT III
1000 Rio Brazos Rd., Aztec, NM 87410

WELL LOCATION AND ACREAGE DEDICATION PLAT

All Distances must be from the outer boundaries of the section

Operator BLACKWOOD & NICHOLS CO.			Lease N.E.B.U.		Well No. 491
Unit Letter J	Section 25	Township T.31 N.	Range R.7 W.	County RIO ARriba COUNTY	
Actual Footage Location of Well: 1756 feet from the SOUTH line and 1442 feet from the EAST line					
Ground level Elev. 6268	Producing Formation Fruitland Coal		Pool Basin Fruitland Coal	Dedicated Acreage: 320 Acres	

1. Outline the acreage dedicated to the subject well by colored pencil or hatchure marks on the plat below.
2. If more than one lease is dedicated to the well, outline each and identify the ownership thereof (both as to working interest and royalty).
3. If more than one lease of different ownership is dedicated to the well, have the interest of all owners been consolidated by communitization, unitization, force-pooling, etc?
☐ Yes ☐ No If answer is "yes" type of consolidation NA
If answer is "no" list the owners and tract descriptions which have actually been consolidated. (Use reverse side of this form if necessary.)
No allowable will be assigned to the well until all interests have been consolidated (by communitization, unitization, forced-pooling, or otherwise) or until a non-standard unit, eliminating such interest, has been approved by the Division.

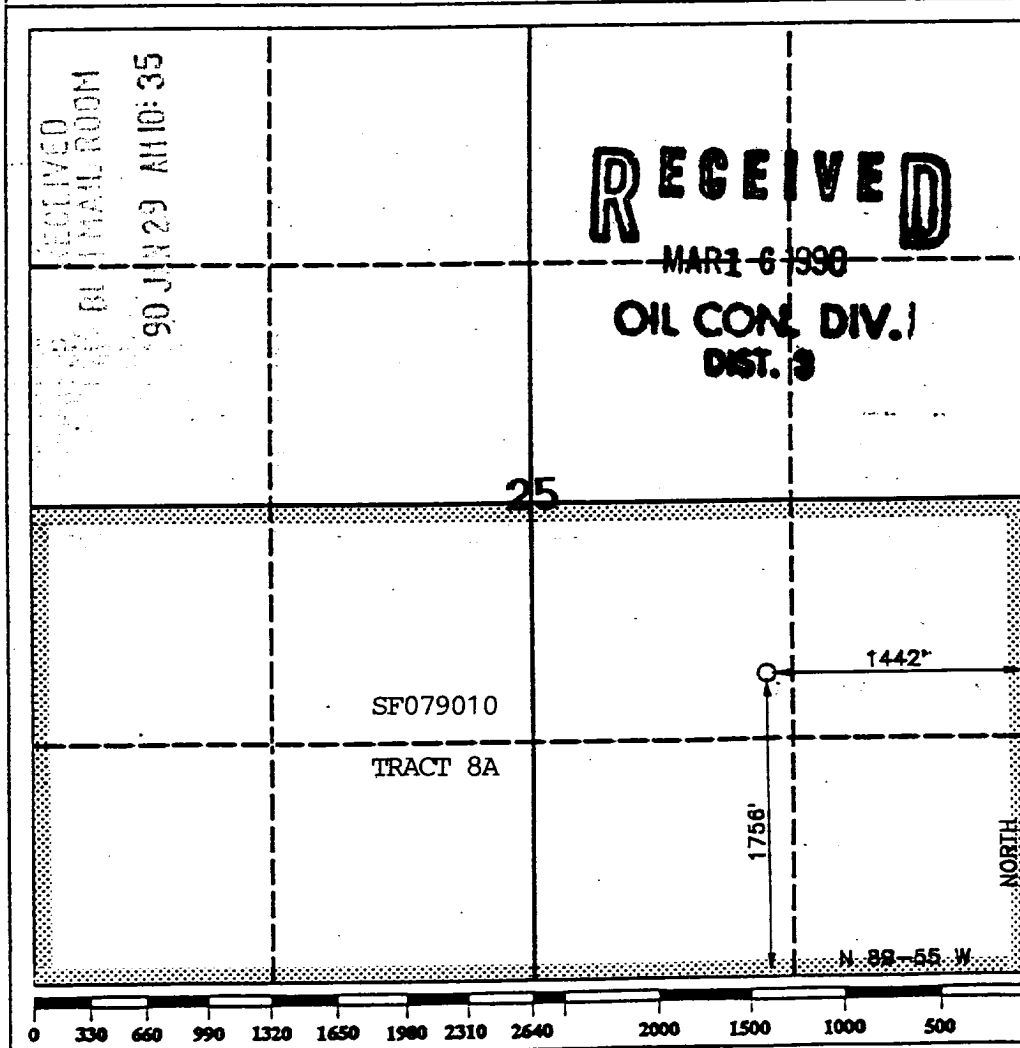

OPERATOR CERTIFICATION

I hereby certify that the information contained herein is true and complete to the best of my knowledge and belief.

Signature William F. Clark
Printed Name **William F. Clark**
Position **Operations Manager**
Company **Blackwood & Nichols Co., Lt**
Date

SURVEYOR CERTIFICATION

I hereby certify that the well location shown on this plat was plotted from field notes of actual surveys made by me or under my supervision, and that the same is true and correct to the best of my knowledge and belief.

Date Surveyed **JANUARY 10 1990**
Signature & Seal **R. EDWARD DAGGETT**
Professional Surveyor
Certificate No. **9679**
Registered Professional
Land Surveyor

REPORT

02413 14233

1. VIO . MOD HO
E . T210

E. 1340