

A. R. KENDRICK

P.O. BOX 516 • AZTEC, NEW MEXICO 87410 • (505) 334-2555

July 20, 1990

Oil Conservation Division
P.O. Box 2088
Santa Fe, New Mexico 87504-2088

Re Application for Approval to Intentionally Deviate From Vertical
Parker & Parsley Petroleum Company
Rosa Unit #296, D-12-31N-4W
Basin Fruitland Coal Gas Pool
Rio Arriba County

Gentlemen:

We, on behalf of Parker & Parsley Petroleum Company, hereby request approval to intentionally deviate the subject well from the surface location of 1190 feet from the North line and 670 feet from the West line of Section 12, Township 31 North, Range 4 West, to a target location of 1190 feet from the North line and 900 feet from the West line of Section 12.

The lateral displacement will be 230 feet to the East.

The deviation is intended to be a long radius, low angle operation.

The reasons for the request are:

1. The US Forest Service requested the surface location to be as close as possible to the existing Rosa Unit #86 well (1100' FNL 790' FWL) due to topographical and ecological conditions in the southwest quarter of the section (This is the archaeologically approved site); and,
2. Because of the desire to bottom the well away from the northeast-southwest trending dike located in Section 11 to the west.

Offset owners have been notified of this application by hand delivery or by FAX. Their waivers of objection are either enclosed herewith or will be sent by FAX direct to your office.

If further information is desired, please contact us.

Yours very truly,

A. R. Kendrick

Enclosures

RECEIVED
JUL 23 1990
OIL CON. DIV
DIST. 3

Deviation From Vertical, Rosa Unit #296

Surface: 1190' FNL 670' FWL Sec. 12

Target: 1190' FNL 900' FWL Sec. 12

Basin Fruitland Coal Gas Pool

R 4 W

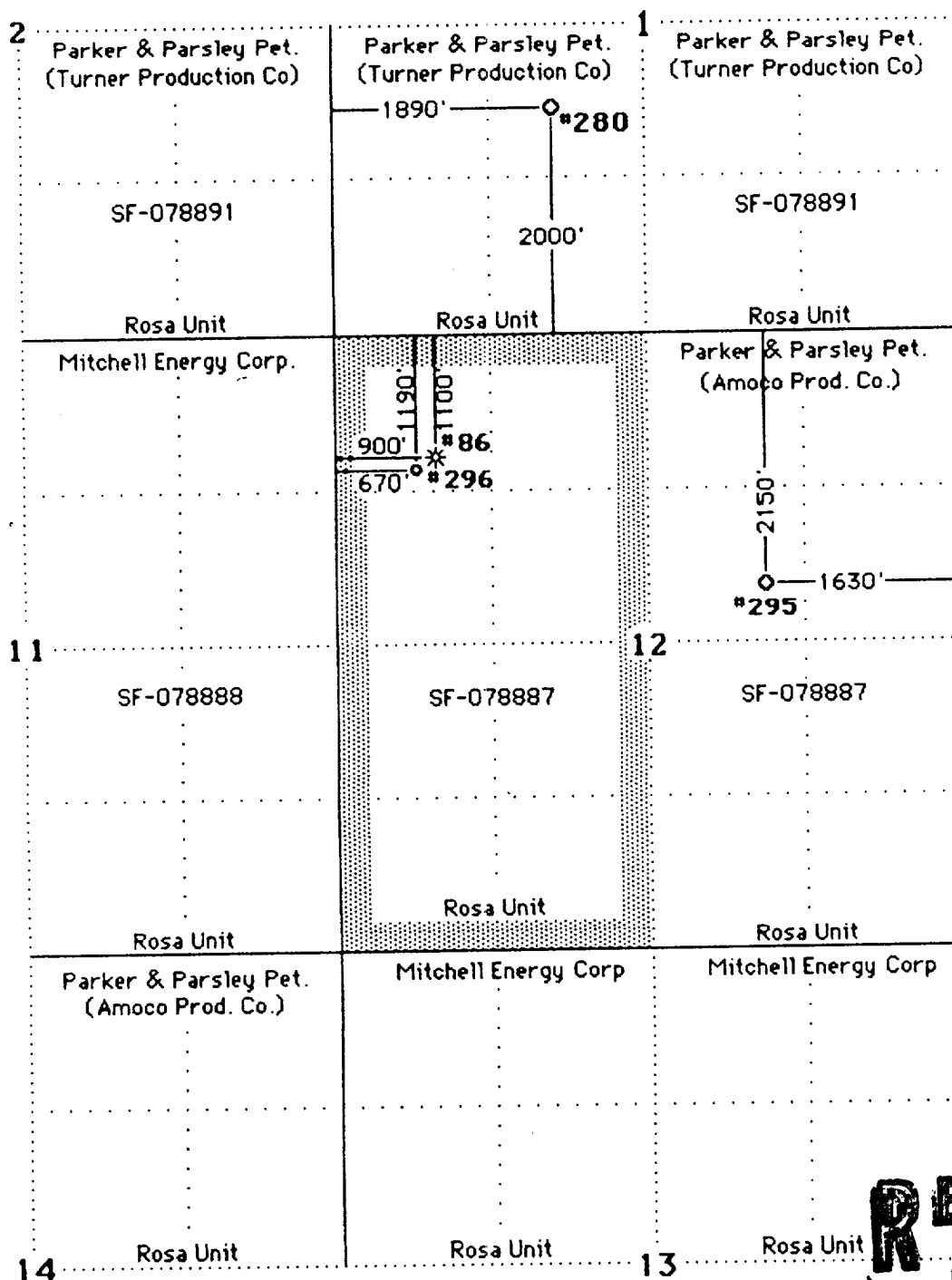

T
31
N

RECEIVED

JUL 23 1990

OIL CON. DIV.
DIST. 3

DEVIATION FROM VERTICAL: ROSA UNIT #296

1190' FNL 670' FWL Sec 12 - T 31 N - R 4 W

Target: 1190' FNL 900' FWL

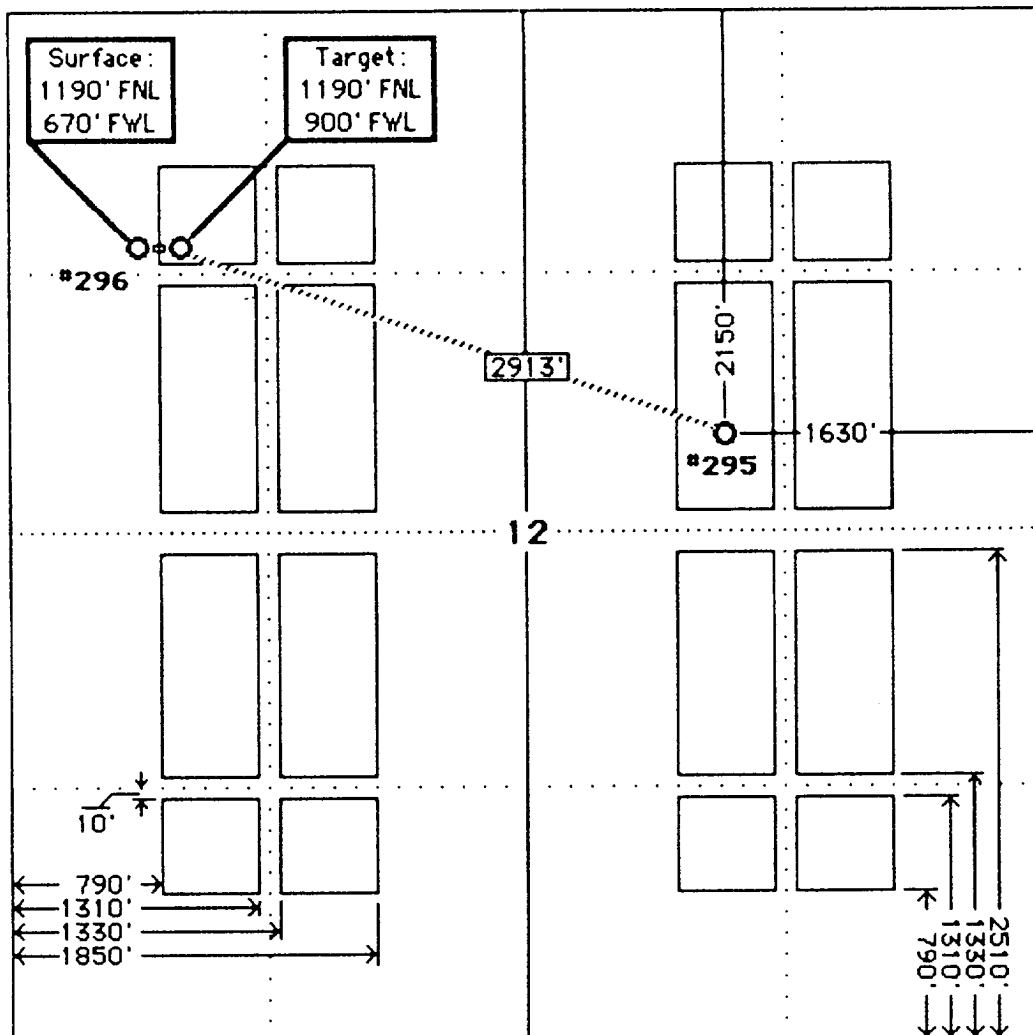

RECEIVED

JUL 23 1990

OIL CON. DIV
DIST. 3

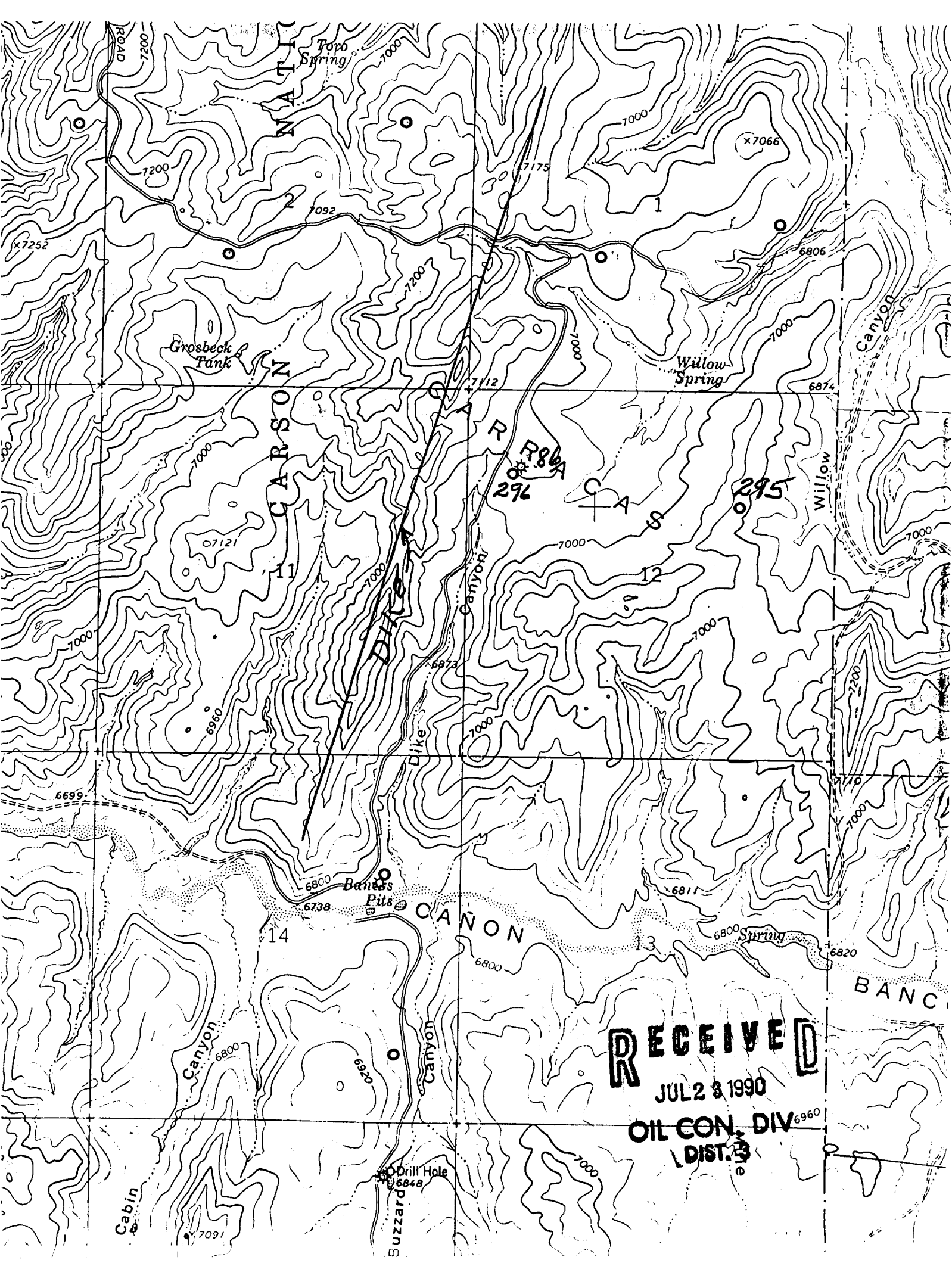

NAMES AND ADDRESSES OF OFFSET OWNERS AND INTERESTED PARTIES

Parker & Parsley Petroleum Company Rosa Unit #296

1190' FNL 670' FWL, Section 12-T31N-R4W
Basin Fruitland Coal Gas Pool
Rio Arriba County, New Mexico

Amoco Production Company •
P. O. Box 800
Denver, Colorado 80201

Mitchell Energy Corporation •
Suite 3500
555 17th Street
Denver, Colorado 80202

Turner Production Company •
852 One Energy Square
4925 Greenville Avenue
Dallas, Texas 75206

US Forest Service •
Jicarilla Ranger District
Gobernador Route
Blanco, New Mexico 87412

Bureau of Land Management
1235 La Plata Highway
Farmington, New Mexico 87401

Oil Conservation Division
1000 Rio Brazos Road
Aztec, New Mexico 87410

RECEIVED
JUL 23 1990
OIL CON. DIV.
DIST. ?

• Notified by FAX or hand delivery.