

RECEIVED

NOV 08 1990

OIL CON. DIV.

DIST. 3

UNITED STATES
DEPARTMENT OF THE INTERIOR
BUREAU OF LAND MANAGEMENT

30-039-25013

APPLICATION FOR PERMIT TO DRILL, DEEPEN, OR PLUG BACK

1a. TYPE OF WORK DRILL	5. LEASE NUMBER SF-078773
1b. TYPE OF WELL GAS	6. IF INDIAN, ALL. OR TRIBE NAME
2. OPERATOR MERIDIAN OIL INC.	7. UNIT AGREEMENT NAME ROSA UNIT
3. ADDRESS & PHONE NO. OF OPERATOR P O BOX 4289 FARMINGTON, NM 87499	8. FARM OR LEASE NAME ROSA UNIT
4. LOCATION OF WELL 1375'FNL 1420'FEL	9. WELL NO. 269
14. DISTANCE IN MILES FROM NEAREST TOWN 15 miles navajo dam po	10. FIELD, POOL, OR WILDCAT BASIN FRUITLAND COAL
15. DISTANCE FROM PROPOSED LOCATION 1375' TO NEAREST PROPERTY OR LEASE LINE.	11. SEC. T. R. M OR BLK. G SEC. 34 T31N R05W NMPM
16. ACRES IN LEASE 17. ACRES ASSIGNED TO WELL E/320.00	12. COUNTY RIO ARRIBA
18. DISTANCE FROM PROPOSED LOCATION TO NEAREST WELL DR. 2500' COMPL., OR APPLIED FOR ON THIS LEASE.	13. STATE NM
19. PROPOSED DEPTH 3620'	20. ROTARY OR CABLE TOOLS ROTARY
21. ELEVATIONS (DF, FT, GR, ETC.) 6743'GL	22. APPROX. DATE WORK WILL START 7/20/90
23. PROPOSED CASING AND CEMENTING PROGRAM *SEE OPERATIONS PLAN	
24. AUTHORIZED BY:  REG. DRILLING ENGR.	DATE

DRILLING OPERATIONS AUTHORIZED ARE
SUBJECT TO COMPLIANCE WITH ATTACHED
"GENERAL REQUIREMENTS".

PERMIT NO. _____ APPROVAL DATE _____
APPROVED BY _____ TITLE _____ DATE _____

NOTE: THIS FORMAT IS ISSUED IN LIEU OF US BLM FORM 3160-3.

Submit to Appropriate
District Office
State Lease - 4 copies
Fee Lease - 3 copies

State of New Mexico
Energy, Minerals and Natural Resources Department

Form C-102
Revised 1-1-82

OIL CONSERVATION DIVISION

P.O. Box 2088
Santa Fe, New Mexico 87504-2088

DISTRICT I
P.O. Box 1980, Hobbs, NM 88240

DISTRICT II
P.O. Drawer DD, Artesia, NM 88210

DISTRICT III
1000 Rio Brazos Rd., Aztec, NM 87410

WELL LOCATION AND ACREAGE DEDICATION PLAT
All Distances must be from the outer boundaries of the section

Operator Meridian Oil Inc.			Lease Rosa Unit (SF-078773)		Well No. 269
Unit Letter G	Section 34	Township 31 North	Range 5 West	County Rio Arriba	
Actual Footage Location of Well: 1375 feet from the North line and 1420 feet from the East line					
Ground level Elev. 6743'	Producing Formation Fruitland Coal		Pool Basin	Dedicated Acreage: 320 Acres	

1. Outline the acreage dedicated to the subject well by colored pencil or ballpoint marker on the plat below.
2. If more than one lease is dedicated to the well, outline each and identify the ownership thereof (both as to working interest and royalty).
3. If more than one lease of different ownership is dedicated to the well, have the interest of all owners been consolidated by communitization, unitization, force-pooling, etc.?
☒ Yes ☐ No If answer is "yes" type of consolidation unitization
If answer is "no" list the owners and tract descriptions which have actually been consolidated. (Use reverse side of this form if necessary.)
No allowable will be assigned to the well until all interests have been consolidated (by communitization, unitization, force-pooling, or otherwise) or until a non-standard unit, eliminating such interest, has been approved by the Division.

OPERATOR CERTIFICATION:

I hereby certify that the information herein is true and complete to the best of my knowledge and belief.

Signature Peggy Bradfield

Printed Name
Regulatory Affairs

Position
Meridian Oil Inc.

Company
Date 7-18-90

Date

SURVEYOR CERTIFICATION

I hereby certify that the well location shown on this plat was plotted from field notes actual surveys made by me or under supervision, and that the same is true, correct to the best of my knowledge and belief. 5-4-90

Date Surveyed

Signature of Surveyor
Professional Surveyor

NEW MEXICO
REGISTERED LAND SURVEYOR
6857
Neale C. Edwards

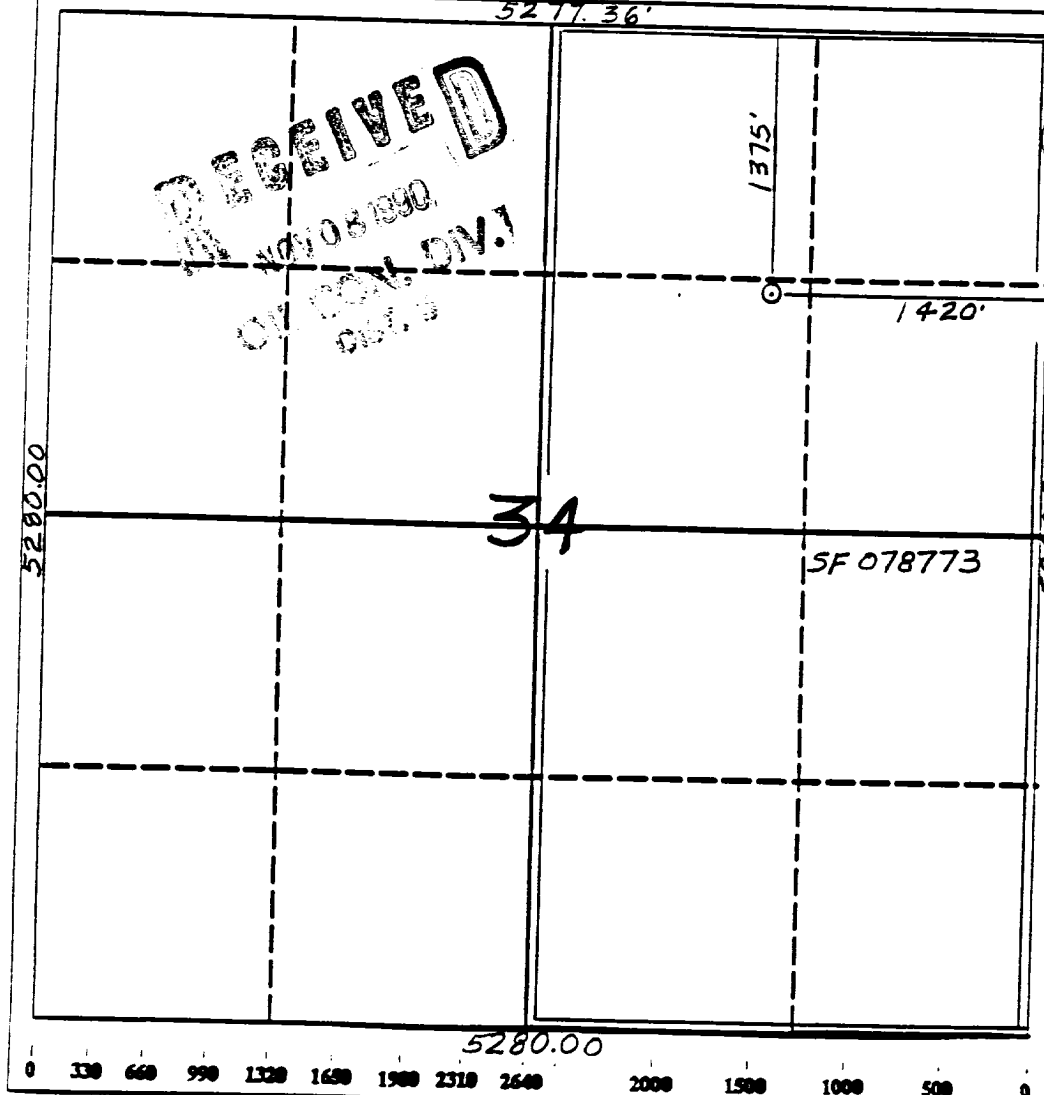

Well Name: 269 ROSA UNIT 1375'FNL 1420'FEL
 Sec. 34 T31N R05W RIO ARRIBA NEW MEXICO
 BASIN FRUITLAND COAL Elevation 6743'GL

Formation tops: Surface- SAN JOSÉ
 Ojo Alamo- 2865
 Kirtland- 3040
 Fruitland- 3415
 Fruitland Coal Top- 3494 Intermediate TD- 3454
 Fruitland Coal Base- 3616 Total Depth- 3620
 Pictured Cliffs- 3634

Logging Program: Mud logs from intermediate to total depth.

Mud Program:	Interval	Type	Weight	Visc.	Fl. Loss
	0 - 200	Spud	8.4 - 8.9	40-50	no control
	200 - 3454	Non-dispersed	8.4 - 9.1	30-60	no control
	3454 - 3620	Formation Water	8.4		no control

Casing Program:	Hole Size	Depth Interval	Csg. Size	Weight	Grade
	12 1/4"	0 - 200	9 5/8"	32.3#	H-40
	8 3/4"	0 - 3454	7"	20.0#	K-55
	6 1/4"	3404 - 3620	5 1/2"	15.5#	K-55
Tubing Program:		0 - 3620	2 7/8"	6.5#	J-55

Float Equipment: 9 5/8" surface casing - saw tooth guide shoe. Centralizers will be run in accordance with Onshore Order #2.

7" intermediate casing - guide shoe and self-fill insert float valve. Three centralizers run every other joint above shoe. Run insert float one joint above the guide shoe. Two turbolizing type centralizers - one below and one into the base of the Ojo Alamo @ 3040'. Standard centralizers thereafter every fourth joint up to the base of the surface pipe.

5 1/2" production casing - float shoe on bottom and a pre-drilled liner run to the 7" casing with a minimum 50' overlap. Liner hanger is a double slip grip type.

Wellhead Equipment: 9 5/8" x 7" x 2 7/8" x 11" 3000 psi xmas tree assembly.

Cementing:

9 5/8" surface casing - cement with 160 sacks of class "B" cement with 1/4# flocele/sack and 3% calcium chloride (189 cu ft. of slurry, 200% excess to circulate to surface). WOC 12 hours. Test casing to 600 psi for 30 minutes.

7" intermediate casing - lead with 509 sacks of 65/35 class "B" poz with 6% gel, 2% calcium chloride and 1/2 cu ft. Perlite/sack (10.3 gallons of water/sack) tail with 100 sacks of class "B" with 2% calcium chloride. 1100 cu ft. of slurry, 110% excess to circulate to surface. If hole conditions permit, a 600 ft spacer will be run ahead of the cement slurry to avoid mud contamination of the cement. WOC 12 hours. If cement does not circulate to surface, a temperature log will be run after 8 hours to determine TOC.

5 1/2" liner - do not cement.

Figure 1

Proposed Project Area

DCA-90-124

DCA-90-125

Abandoned Project Area

Canyon

Miller

Garrison Spring

Project: Proposed and Abandoned
San Juan 32-9 Unit No.269
Gas Well Pad
USGS 7.5' Mount Nebo N.Mex.-Colo.
1985 Provisional Edition
T.31N, R.10W, Section 1 NMPM
San Juan County, NM

Abandoned Footages; 1620' FSL/1365'FWL
Proposed Footages: 1620' FSL/1265'FWL