

UNITED STATES
DEPARTMENT OF THE INTERIOR
BUREAU OF LAND MANAGEMENT

30-039-25088

APPLICATION FOR PERMIT TO DRILL, DEEPEN, OR PLUG BACK

1. TYPE OF WORK
DRILL ☒ DEEPEN ☐ PLUG BACK ☐

2. TYPE OF WELL
Oil Well ☐ Gas Well ☒ OTHER ☐ SINGLE ZONE ☐ MULTIPLE ZONE ☐

3. NAME OF OPERATOR
Robert L. Bayless

4. ADDRESS OF OPERATOR
P.O. Box 168, Farmington, NM 87499

5. LOCATION OF WELL (Report location clearly and in accordance with any State requirements.)*
At surface
1500' FSL & 790' FWL
At proposed prod. zone
same

6. DISTANCE IN MILES AND DIRECTION FROM NEAREST TOWN OR POST OFFICE*

7. DISTANCE FROM PROPOSED*
LOCATION TO NEAREST
PROPERTY OR LEASE LINE, FT.
(Also to nearest drlg. unit line, if any)
18. DISTANCE FROM PROPOSED LOCATION*
TO NEAREST WELL, DRILLING, COMPLETED,
OR APPLIED FOR, ON THIS LEASE, FT.
16. NO. OF ACRES IN LEASE
17. NO. OF ACRES ASSIGNED
TO THIS WELL
19. PROPOSED DEPTH
3615'
20. ROTARY OR CABLE TOOLS
Rotary

21. ELEVATIONS (Show whether DF, RT, GR, etc.)
6900' GL; 6912' RKB
22. APPROX. DATE WORK WILL START*
ASAP

23. This action is subject to technical and
procedural review pursuant to 43 CFR 3135.9
and appeal pursuant to 43 CFR 3165.9.

SIZE OF HOLE	SIZE OF CASING	WEIGHT PER FOOT	SETTING DEPTH
12-1/4"	8-5/8"	24.0#	125'
7-7/8"	4-1/2"	10.5#	3615'

24. QUANTITY OF CEMENT
"GENERAL REQUIREMENTS"
90 sx Class B (106 ft³)
500 sx assorted cements-see long-
string cementing guidelines for
details

Will drill 12-1/4" hole to 125' and set 125' of 8-5/8" 24.0#/ft J-55 used casing, cementing with 106 ft³ Class B cement, circulated to surface. Will drill 7-7/8" hole to 3615' and run 3615' of 4-1/2" 10.5#/ft J-55 new casing and cement as per attached longstring cementing guidelines. Circulating medium while drilling will be clear water, natural mud and waterloss control additives. No abnormal pressures or temperatures are anticipated. Will run Induction and Density Logs. Blowout preventer and safety equipment schematics are attached. The gas from this formation is not dedicated to a gas contract.

ESTIMATED TOPS: Ojo Alamo - 2772'
Kirtland - 3012'
Fruitland - 3052'
Pictured Cliffs - 3442'
Total Depth - 3615'

RECEIVED

JUL 31 1991

CON. DIV.
DIST. 3

IN ABOVE SPACE DESCRIBE PROPOSED PROGRAM: If proposal is to deepen or plug back, give data on present productive zone and proposed new zone. If proposal is to drill or deepen directionally, give pertinent data on subsurface locations and measured and true vertical depths. Give blowout preventer program, if any.

24. SIGNED: Kevin H. McCord TITLE: Petroleum Engineer DATE: 8/2/90
(This space for Federal or State office use)

PERMIT NO. APPROVAL DATE

APPROVED BY: TITLE: APPROVED AS AMENDED

NMOCD

*See Instructions On Reverse Side

Title 18 U.S.C. Section 1001, makes it a crime for any person knowingly and willfully to make to any department or agency of the United States any false, fictitious or fraudulent statements or representations as to any matter within its jurisdiction.

Submit to Appropriate
District Office
State Leases - 4 copies
Fee Leases - 3 copies

State of New Mexico
Energy, Minerals and Natural Resources Department

Form C-102
Revised 1-1-89

OIL CONSERVATION DIVISION

P.O. Box 2088
Santa Fe, New Mexico 87504-2088

DISTRICT I
P.O. Box 1980, Hobbs, NM 88240

DISTRICT II
P.O. Drawer DD, Artesia, NM 88210

DISTRICT III
1000 Rio Brazos Rd., Aztec, NM 87410

WELL LOCATION AND ACREAGE DEDICATION PLAT

All Distances must be from the outer boundaries of the section

Operator Robert L. Bayless			Lease JICARILLA 31-3-17		Well No. 31-3-17-1
Unit Letter L	Section 17	Township 31N	Range 3W	County NMPM Rio Arriba	

Actual Footage Location of Well:

1500 feet from the South line and 790 feet from the West line	Ground level Elev. 6900'	Producing Formation Basin Fruitland Coal	Pool Basin Fruitland Coal	Dedicated Acreage: 319.50 Acres
---	-----------------------------	---	------------------------------	------------------------------------

- Outline the acreage dedicated to the subject well by colored pencil or hatchure marks on the plat below.
- If more than one lease is dedicated to the well, outline each and identify the ownership thereof (both as to working interest and royalty).
- If more than one lease of different ownership is dedicated to the well, have the interest of all owners been consolidated by communitization, unitization, force-pooling, etc.?
☐ Yes ☐ No If answer is "yes" type of consolidation _____
If answer is "no" list the owners and tract descriptions which have actually been consolidated. (Use reverse side of this form if necessary.)
No allowable will be assigned to the well until all interests have been consolidated (by communitization, unitization, forced-pooling, or otherwise) or until a non-standard unit, eliminating such interest, has been approved by the Division.

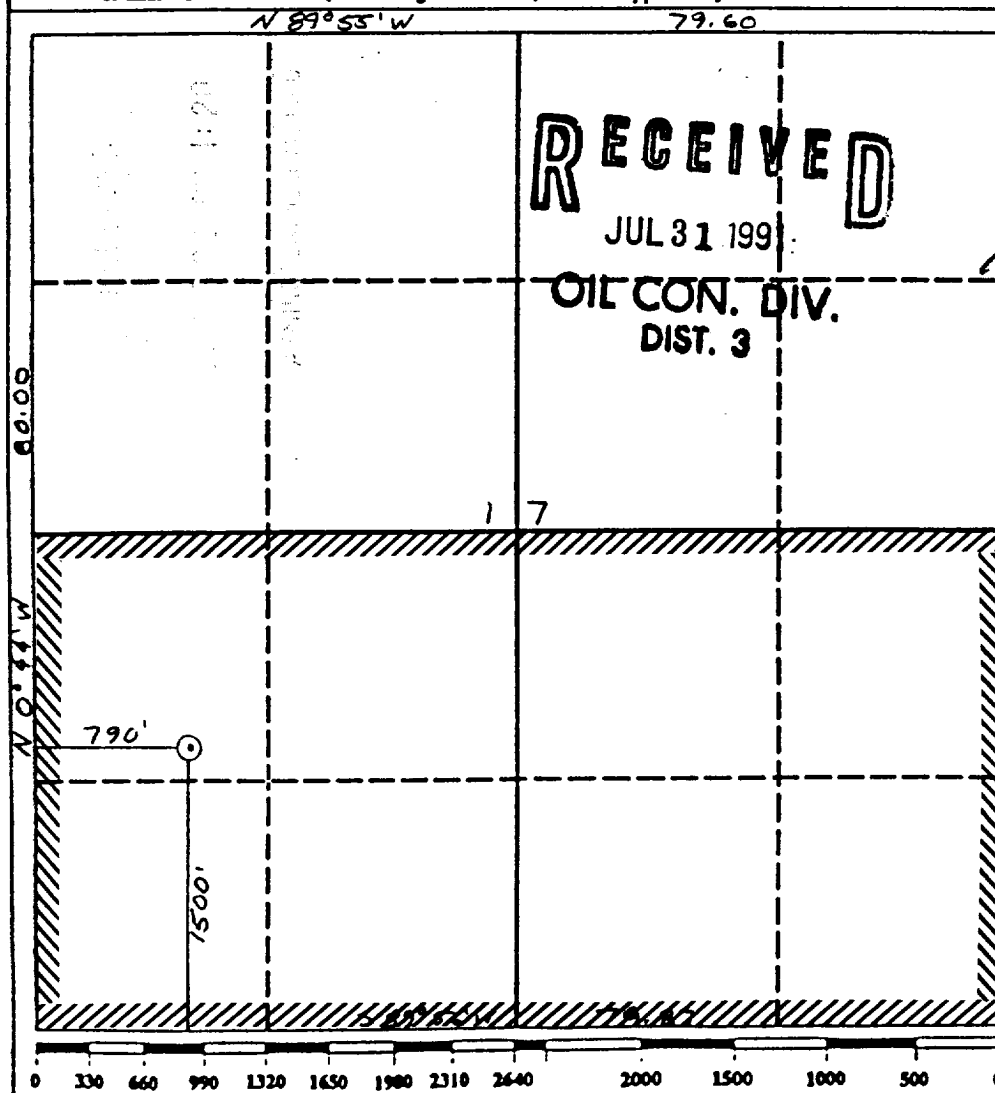

OPERATOR CERTIFICATION

I hereby certify that the information contained herein is true and complete to the best of my knowledge and belief.

Signature
Printed Name
Robert L. Bayless
Position
Operator
Company
Robert L. Bayless
Date
August 7, 1990

SURVEYOR CERTIFICATION

I hereby certify that the well location shown on this plat was plotted from field notes of actual surveys made by me or under my supervision, and that the same is true and correct to the best of my knowledge and belief.

Date Surveyed
8-02-90
Roy A. Rush

Signature & Seal of
Professional Surveyor
ROY A. RUSH
NEW MEXICO
8894
Certificate
8894

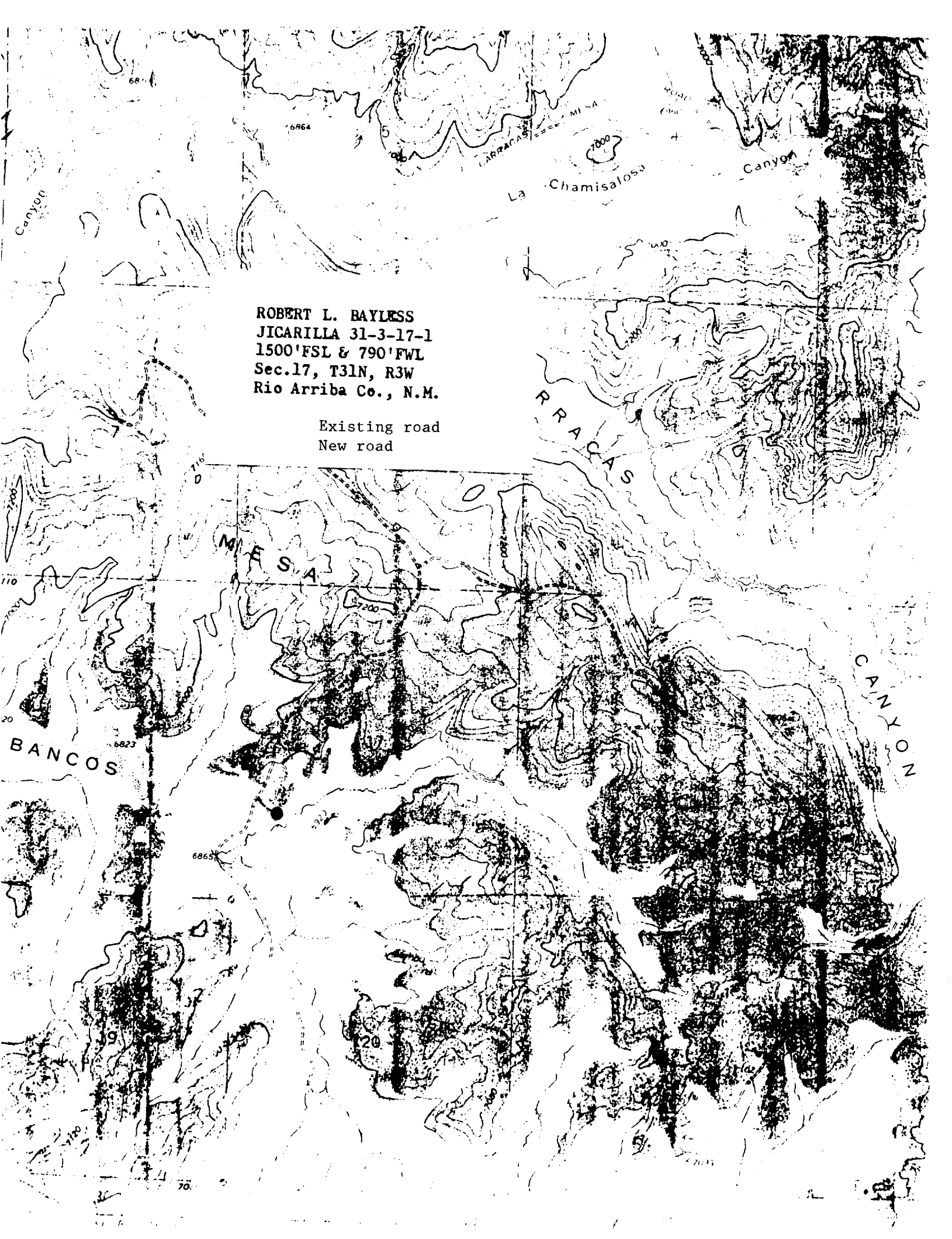

ROBERT L. BAYLESS
JICARILLA 31-3-17-1
1500' FSL & 790' FWL
Sec. 17, T31N, R3W
Rio Arriba Co., N.M.

The map is a topographic representation of a rugged landscape. It features numerous contour lines indicating elevation changes. A network of roads is shown, with some segments highlighted in a darker, thicker line to represent 'New roads' and others in a lighter, dashed line for 'Existing roads'. The map is divided into sections by a grid, with labels for 'MESA' and 'BANCOS' visible. The terrain is characterized by steep slopes and deep valleys, with several 'CANYON' labels scattered across the map. A specific area is marked with a dot and labeled with the text 'ROBERT L. BAYLESS' and other identifying information.

Existing road
New road