

UNITED STATES  
DEPARTMENT OF THE INTERIOR  
BUREAU OF LAND MANAGEMENT

FORM APPROVED  
Budget Bureau No. 1004-0135  
Expires: March 31, 1993

SUNDRY NOTICES AND REPORTS ON WELLS

Do not use this form for proposals to drill or to deepen or reentry to a different reservoir. Use "APPLICATION FOR PERMIT--" for such proposals

SUBMIT IN TRIPLICATE

1. Type of Well <input type="checkbox"/> Oil Well <input checked="" type="checkbox"/> Gas Well <input type="checkbox"/> Other	5. Lease Designation and Serial No. SF-078767
2. Name of Operator WILLIAMS PRODUCTION COMPANY	6. If Indian, Allottee or Tribe Name
3. Address and Telephone No. PO BOX 3102 MS 37-4, TULSA, OK 74101 (918) 588-4592	7. If Unit or CA, Agreement Designation ROSA UNIT
4. Location of Well (Footage, Sec., T., R., M., or Survey Description) 970' FNL & 1190' FEL, NW/4 NE/4 SEC 13B-31N-6W	8. Well Name and No. ROSA UNIT #125
	9. API Well No. 30-039-25144
	10. Field and Pool, or Exploratory Area BASIN DAKOTA-71599
	11. County or Parish, State RIO ARRIBA, NM

CHECK APPROPRIATE BOX(S) TO INDICATE NATURE OF NOTICE, REPORT, OR OTHER DATA

TYPE OF SUBMISSION	TYPE OF ACTION
<input checked="" type="checkbox"/> Notice of Intent <input type="checkbox"/> Subsequent Report <input type="checkbox"/> Final Abandonment	<input type="checkbox"/> Abandonment <input checked="" type="checkbox"/> Recompletion <input type="checkbox"/> Plugging Back <input type="checkbox"/> Casing Repair <input type="checkbox"/> Altering Casing <input type="checkbox"/> Other _____ <input type="checkbox"/> Change of Plans <input type="checkbox"/> New Construction <input type="checkbox"/> Non-Routine Fracturing <input type="checkbox"/> Water Shut-Off <input type="checkbox"/> Conversion to Injection <input type="checkbox"/> Dispose Water (Note: Report results of multiple completion on Well Completion or Recompletion Report and Log form.)

13. Describe Proposed or Completed Operations (Clearly state all pertinent details, and give pertinent dates, including estimated date of starting any proposed work. If well is directionally drilled, give subsurface locations and measured and true vertical depths for all markers and zones pertinent to this work.)\*

Williams Production Company proposes to P&A the existing non-productive Dakota interval and recomplete this well to the Mesaverde formation as per the attached procedure.

Keep this in Stamp BL in  
Copy - Till we get an  
Approved fr. BLM.

RECEIVED  
APR 14 1997  
OIL CON. DIV.  
DIST. 3

14. I hereby certify that the foregoing is true and correct

Signed Susan Griguhn  
SUSAN GRIGUHN

Title CLERK

Date April 10, 1997

(This space for Federal or State office use)

Approved by \_\_\_\_\_

Title \_\_\_\_\_

Date \_\_\_\_\_

Conditions of approval, if any:

Title 18 U.S.C. Section 1001, makes it a crime for any person knowingly and willfully to make to any department or agency of the United States any false, fictitious or fraudulent statements or representations as to any matter within its jurisdiction.

\*See Instruction on Reverse Side

DISTRICT I  
P O Box 1980, Hobbs, NM 88240  
DISTRICT II  
P O Drawer DD, Artesia, NM 88210  
DISTRICT III  
1000 Rio Brazos, Aztec, NM 87410  
DISTRICT IV  
2040 South Pacheco, Santa Fe, NM 87505

State of New Mexico  
Energy, Minerals & Natural Resources Department  
**OIL CONSERVATION DIVISION**  
2040 South Pacheco  
Santa Fe, NM 87504

Hall C-104  
Fernsle (4)

Form C-102  
Revised October 18, 1994  
Instructions on back  
Submit to Appropriate District Office  
State Lease - 4 copies  
Fee Lease - 3 copies

☐ AMENDED REPORT

## WELL LOCATION AND ACREAGE DEDICATION PLAT

1. API Number 30-039-25144	2. Pool Code 72319	3. Pool Name BLANCO
4. Property Code 008480	5. Property Name ROSA UNIT	6. Well Number #125
7. OGRID No. 120782	8. Operator Name WILLIAMS PRODUCTION COMPANY	9. Elevation 6491'

### 10 Surface Location

UL or log no. B	Section 13	Township 31N	Range 6W	Lot Idn	Feet from the 970	North/South line NORTH	Feet from the 1190	East/West line EAST	County RIO ARriba
--------------------	---------------	-----------------	-------------	---------	----------------------	---------------------------	-----------------------	------------------------	----------------------

### 11 Bottom Hole Location If Different From Surface

UL or log no.	Section	Township	Range	Lot Idn	Feet from the	North/South line	Feet from the	East/West line	County
12. Dedicated Acres 223.28	13. Joint or Infill	14. Consolidation Code	15. Order No.						

NO ALLOWABLE WILL BE ASSIGNED TO THIS COMPLETION UNTIL ALL INTERESTS HAVE BEEN CONSOLIDATED OR A NON-STANDARD UNIT HAS BEEN APPROVED BY THE DIVISION

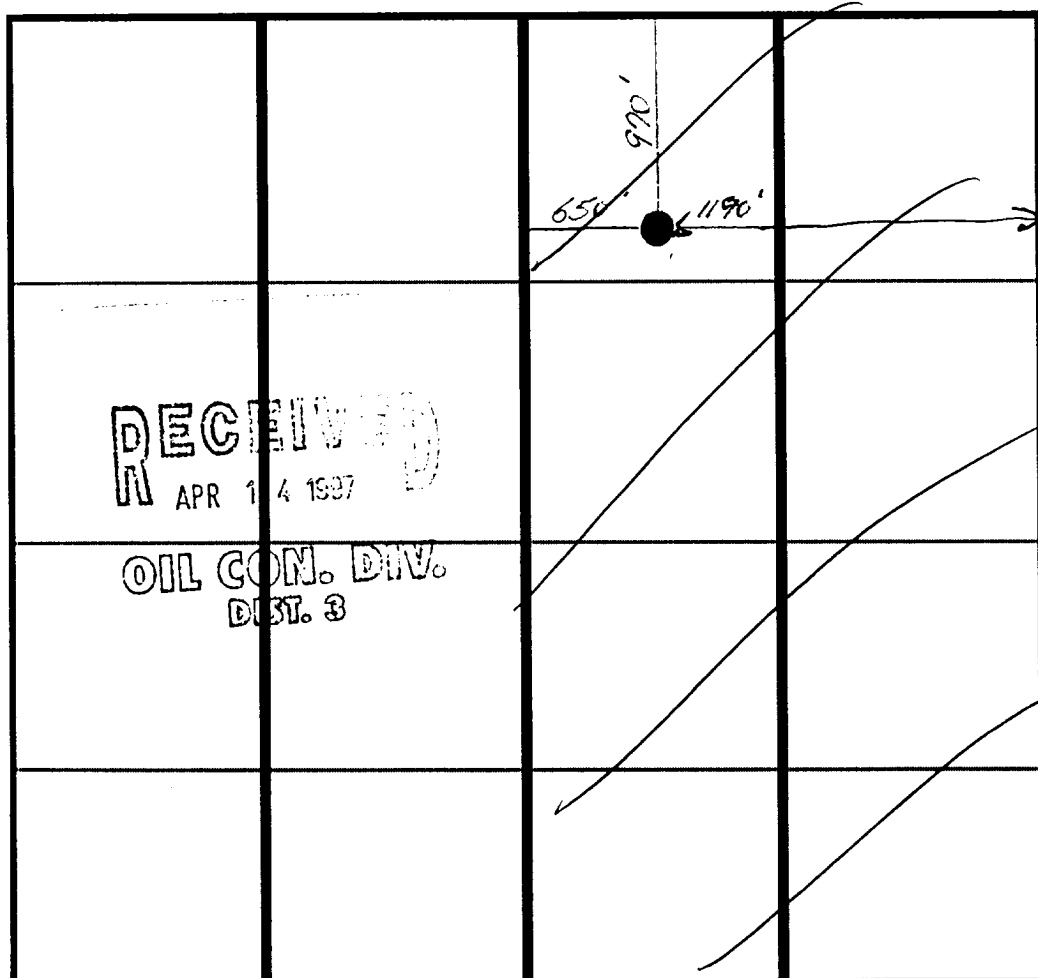

<b>OPERATOR CERTIFICATION</b> <i>I hereby certify that the information contained herein is true and complete to the best of my knowledge and belief.</i>	
<i>Susan Griguhn</i> Signature	
Susan Griguhn Printed Name	
Clerk Title	
April 10, 1997 Date	
<b>18. SURVEYOR CERTIFICATION</b> <i>I hereby certify that the well location shown on this plat was plotted from field notes of actual surveys made by me or under my supervision, and that the same is true and correct to the best of my knowledge and belief.</i>	
Date Surveyed	
Signature & Seal of Professional Surveyor	
Certification No.	

Submit to Appropriate  
District Office  
State Lease - 4 copies  
Fee Lease - 3 copies

DISTRICT I  
P.O. Box 1980, Hobbs, NM 88240

DISTRICT II  
P.O. Drawer DD, Artesia, NM 88210

DISTRICT III  
1000 Rio Brazos Rd., Aztec, NM 87410

State of New Mexico  
Energy, Minerals and Natural Resources Department

Form C-107  
Revised 1-1-89

# OIL CONSERVATION DIVISION

P.O. Box 2088  
Santa Fe, New Mexico 87504-2088

RECEIVED  
BLM

RECEIVED  
BLM

91 OCT 15 PM 2:22  
97 JAN 30 PM 12:11

## WELL LOCATION AND ACREAGE DEDICATION PLAT

All Distances must be from the outer boundaries of the section

Operator <b>AMOCO PRODUCTION COMPANY</b>			Lease <b>ROSA UNIT</b>		Well No. <b>#125</b>
Unit Letter <b>B</b>	Section <b>13</b>	Township <b>31 NORTH</b>	Range <b>6 WEST</b>	County <b>RIO ARriba</b>	
Actual Footage Location of Well: <b>970</b> feet from the <b>NORTH</b> line and <b>1190</b> feet from the <b>EAST</b> line					
Ground level Elev. <b>6495</b>	Producing Formation			Pool	Dedicated Acreage: <b>E/2</b> Acres

- Outline the acreage dedicated to the subject well by colored pencil or hatchure marks on the plat below.
- If more than one lease is dedicated to the well, outline each and identify the ownership thereof (both as to working interest and royalty).
- If more than one lease of different ownership is dedicated to the well, have the interest of all owners been consolidated by communitization, unitization, force-pooling, etc?  
☐ Yes ☐ No If answer is "yes" type of consolidation \_\_\_\_\_  
If answer is "no" list the owners and tract descriptions which have actually been consolidated. (Use reverse side of this form if necessary.)  
No allowable will be assigned to the well until all interests have been consolidated (by communitization, unitization, forced-pooling, or otherwise) or until a non-standard unit, eliminating such interest, has been approved by the Division.

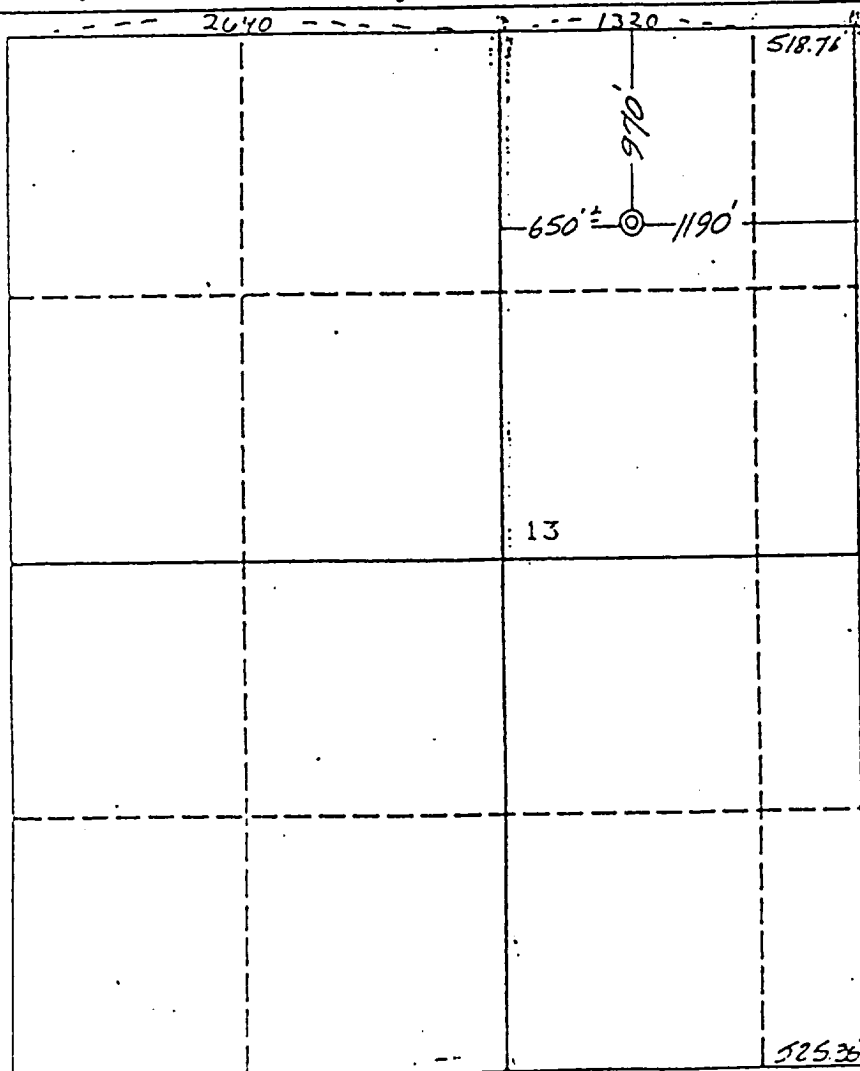

### OPERATOR CERTIFICATION

I hereby certify that the information contained herein is true and complete to the best of my knowledge and belief.

Signature

Printed Name

Position

Company

Date

### SURVEYOR CERTIFICATION

I hereby certify that the well location shown on this plat was plotted from field notes of actual surveys made by me or under my supervision, and that the same is true and correct to the best of my knowledge and belief.

Date Surveyed  
**September 9, 1991**

Signature & Seal of  
Professional Surveyor

Gary

Certification

7016

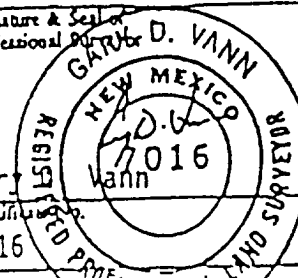

10/30/96

WILLIAMS PRODUCTION COMPANY  
RECOMPLETION PROGNOSIS  
Rosa #125

**PURPOSE:** To plug back the Dakota completion and recomplete uphole to the Mesaverde.

1. Check location and rig anchors. Repair as necessary. Tie in drill gas and set compressor.  
Spot and fill 9 - 400 bbl tanks with 1% KCl water. Filter water to 25 microns if necessary.
2. MIRUSU. Nipple up BOP, stripping head, blooie line, working valves and 2" relief line. Test BOP.
3. TOH w/ 2-3/8" tubing

DAKOTA P & A

4. Pick up cement retainer for ~~5-1/2"~~ <sup>4 1/2"</sup> liner. TIH w/ 2-3/8" tubing and set retainer @ 7900'.
5. Sting into retainer and establish circulation into perfs. Pump 65 sx Class "B" cement (required by BLM) below retainer and spot 10 sx on top of retainer. Pull up above cement plug and reverse out any cement.

MESAVERDE COMPLETION

6. On wireline run CBL and GR/CCL in 7" casing from 6200'-5400' and cased hole neutron (Blue Jet processed GSL) from 6200'-5400' and correlate back to open hole log. Review logs with engineering to choose perfs and determine if a squeeze is needed.
7. TIH w/ 2-3/8" tubing and pressure test casing to 3300 psi. Spot 500 gals 15% HCl acid across Point Lookout perforations. Acid to contain 1 gal/1000 gals surfactant, iron control, and corrosion inhibitor (24 hr inhibition at 150 F). TOH.
8. Using Blue Jet GSL cased hole log, perforate the Point Lookout formation in 5-1/2" liner using 0.36" holes using a 3-1/2" select fire casing gun from top down. Perfs will be based on log analysis.
9. Breakdown and attempt to balloff the Point Lookout down casing w/ 1000 gals 15% HCl acid and 1.3 S.G. - 7/8" neutral density RCN perf balls.  
Maximum pressure = 3300 psi.  
Acid to contain 1 gal/1000 gals surfactant, iron control and inhibitor (24 hour inhibition at 150 F).
10. RIH with wireline junk basket and retrieve frac balls.

11. Rig up pump trucks and fracture stimulate the Point Lookout formation with 80,000# 20/40 Arizona sand in 82,500 gals water at 2 BPM/perf. DO NOT OVERFLUSH.

<u>STAGE</u>	<u>FLUID (gals)</u>	<u>SAND (lbs)</u>
Pad	15,000 gals	-
0.5 ppq	20,000 gals	10,000# sand
1.0 ppq	15,000 gals	15,000# sand
1.5 ppq	20,000 gals	30,000# sand
2.0 ppq	12,500 gals	25,000# sand
Flush	(To be determined)	-

---

80,000 # 20/40 Arizona sd

Max Pressure 3300 psi

All frac fluid to contain 0.5 - 1.0 gal/1000 gals FR-30 friction reducer, surfactant and biocide.

Record 15 minute ISIP.

12. Set retrievable bridge plug at  $\pm 5794'$ . Drop sand on top of RBP.
13. TIH w/ 2-3/8" tubing and pressure test to 3300 psi. and spot 500 gals 15% HCl acid across the Cliff House and Menefee. Acid to contain 1 gal/1000 gals surfactant, iron control and corrosion inhibitor (24 hr inhibition at 150 F). TOH.
14. Using Blue Jet Processed GSL log perforate the Cliff House and Menefee formations in 5-1/2" liner w/ 0.36" holes using a 3-1/2" select fire casing gun from top down. Perfs will be based on log analysis.
15. Breakdown and attempt to balloff the Cliff House and Menefee down casing. w/ 1000 gals 15% HCl acid and 1.3 S.G. - 7/8" neutral density RCN perf balls. Maximum pressure = 3300 psi. Acid to contain 1 gal/1000 gals surfactant, iron control and inhibitor (24 hour inhibition at 150F).
16. RIH with wireline junk basket and retrieve balls.
17. Rig up pump trucks and fracture stimulate the Cliff House and Menefee formation with 80,000# 20/40 Arizona sand in 87,500 gals water at 2 BPM/perf. DO NOT OVER FLUSH.

<u>STAGE</u>	<u>FLUID (gals)</u>	<u>SAND (lbs)</u>
Pad	20,000 gals	-
0.5 ppq	20,000 gals	10,000# sand
1.0 ppq	15,000 gals	15,000# sand
1.5 ppq	20,000 gals	30,000# sand
2.0 ppq	12,500 gals	25,000# sand
Flush	To be determined	-

---

80,000 # 20/40 Arizona sd

Maximum STP =3300 psi.

All frac fluid to contain 0.5 - 1.0 gal/1000 gals FR-30 friction reducer, surfactant and biocide.

Record 15 minute ISIP.

18. Shut well overnight. TIH with 2-3/8" and notched collar and cleanout to RBP w/ gas. Obtain pitot tube gauge when possible. TOH. TIH with 2-3/8" tubing and retrieving head and retrieve RBP. TIH w/ tubing and notched collar. Clean out to PBTD. Obtain pitot tube gauge when possible. TOH.
19. TIH w/ 2-3/8", J-55, 4.7#, 8rd, EUE tubing w/ notched collar on bottom and SN 1 joint up. Clean out to PBTD. Land tubing near bottom perf. Pump out plug if used and reverse circulate clean. Obtain pitot tube gauge.
20. ND BOP and NU wellhead. Shut well in for buildup.
21. Cleanup location and release rig. Notify Production Dept.

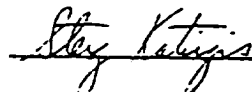
  
\_\_\_\_\_  
Sterg Katirgis  
Senior Engineer

# DATA SHEET

WELLNAME: Rosa #125 FIELD: Basin Dakota  
LOCATION: NW/4, NE/4 SEC. 13, T31N, R6W ELEVATION: 6491' GR KB: 15'  
COUNTY: Rio Arriba State: NM TD: 8242' KB

FORMATION TOPS:	Ojo Alamo	2710'	Menefee	5582'
	Kirtland	2904'	Point Lookout	5824'
	Fruitland	3170'	Mancos	6151'
	Pictured Cliffs	3427'	Gallup	6562'
	Lewis	3640'	Dakota	8008'
	Cliff House	5232'	Morrison	8210'

## CASING RECORD:

CASING	SIZE	WT. & GRADE	DEPTH SET	CEMENT	TOC
SURFACE	10-3/4"	40.5# K-55	416'	400SX	surface
INTERMEDIATE	7-5/8"	24.6# K-55	4225'	1st 555 sx, 2nd 950 sx	surface
PRODUCTION LINER	5-1/2"	17& 15.5# J-55	8330'	DV @ 2760'	
				875 sx	
				Sqz 320 sx	No returns

WELLHEAD EQUIPMENT: Casing Head: 11" - 3000# ERC Tubing Head: 11"- 3000" X 7 1/16"-5000#

TUBING EQUIPMENT: 2-3/8", 4.7#, J-55 8rd, EUE @ 8046'.

LOGGING RECORD: Compensated Neutron-Litho Density, Natural Gamma Ray Spectrometry, Dual Induction Log, Array Sonic, Microlog.

STIMULATION: Dakota 414,000# of Ottawa using Purgel III

PRODUCTION HISTORY: Well is currently shut in.

# WELLBORE DIAGRAM

## ROSA UNIT #125

970' FNL 1190' FEL  
13-31N-6W  
RIO ARRIBA, NM

Elevation: 6491' GR  
KB: 15'

Ojo Alamo	2710
Fruitland	3170
Pictured Cliffs	3427
Lewis	3640
Cliff House	5232
Menefee	5582
Point Lookout	5824
Mancos	6151
Graneros	7900
Dakota	8008
PBTD	8230

TD: 8242'

