



STATE OF NEW MEXICO
ENERGY, MINERALS AND NATURAL RESOURCES DEPARTMENT
OIL CONSERVATION DIVISION



BRUCE KING
GOVERNOR

ANITA LOCKWOOD
CABINET SECRETARY

July 28, 1992

POST OFFICE BOX 2088
STATE LAND OFFICE BUILDING
SANTA FE, NEW MEXICO 87504
(505) 827-5800

Evergreen Operating Corporation
c/o A.R. Kendrick
P.O. Box 516
Aztec, New Mexico 87410

RECEIVED
AUG 12 1992
OIL CON. DIV
DIST. 3

Administrative Order NSL-3134

Dear Mr. Kendrick:

Reference is made to your application dated July 3, 1992 on behalf of the operator, Evergreen Operating Corporation, for a non-standard coal gas well location for the Rosa Unit Well No. 298 to be located 850 feet from the South line and 790 feet from the East line (Unit P) of Section 14, Township 31 North, Range 4 West, NMPM, Basin Fruitland Coal (Gas) Pool, Rio Arriba County, New Mexico. The S/2 of said Section 14 shall be dedicated to the well forming a standard 320-acre gas spacing and proration unit for said pool.

By the authority granted me under the provisions of Rule 8 of the Special Rules and Regulations for the Basin-Fruitland Coal (Gas) Pool as promulgated by Division Order No. R-8768, as amended, the above-described unorthodox coal gas well location is hereby approved.

Sincerely,

WILLIAM J. LEMAY
Director

WJL/MES/jc

cc: Oil Conservation Division - Aztec ✓
U.S. BLM - Farmington
U.S. - Forest Service - Blanco



STATE OF NEW MEXICO
ENERGY, MINERALS and NATURAL RESOURCES DEPARTMENT
OIL CONSERVATION DIVISION
AZTEC DISTRICT OFFICE

1000 RIO BRAZOS ROAD
AZTEC, NEW MEXICO 87410
(505) 334-6178

Date: 8-5-92

Attn: Mr. Stagner

Oil Conservation Division
P.O. Box 2088
Santa Fe, NM 87504-2088

RE: Proposed MC _____
Proposed NSL X _____
Proposed WFX _____
Proposed NSP _____

Proposed DHC _____
Proposed SWD _____
Proposed PMX _____
Proposed DD _____

Gentlemen:

I have examined the application received on 7-7-92

for the Evergreen Operating Corp. Lease #298
OPERATOR LEASE & WELL NO.

P-14-31N-4W and my recommendations are as follows:
UL-S-T-R

Approved

Yours truly,

Ernest L. Lench

A. R. KENDRICK

P.O. BOX 516 • AZTEC, NEW MEXICO 87410 • (505) 334-2555

July 3, 1992

Oil Conservation Division
P. O. Box 2088
Santa Fe, New Mexico 87504-2088

Re: Application for Non-Standard Location
Evergreen Operating Corporation
Rosa Unit #298
850' FSL 790' FEL Sec. 14-T31N-R4W
Basin Fruitland Coal Gas Pool
Rio Arriba County, New Mexico

RECEIVED
JUL - 7 1992
OIL CON. DIV
DIST. 3

Gentlemen:

We, on behalf of Evergreen Operating Corporation, hereby make application for approval of the location of the Rosa Unit #298 well to be located 850' FSL 790' FEL of Section 14 Township 31 North, Range 4 West, Basin Fruitland Coal Gas Pool, Rio Arriba County, New Mexico.

The reason for the non-standard location is because of topography and at the request of the U.S. Forest Service to avoid further damage to the environment and wildlife habitat.

We believe that directional drilling should not be required because a beam pump and rods may be required to lift water from the wellbore to sustain production.

The distances between wells is within the footage parameters required by Order R-8759.

The attached exhibits show the situation at the location and surrounding area.

It is our belief that the information contained in this application is true and correct according to the information available to us.

All offset operators and lease owners are being notified by certified mail at this mailing. The Return Receipt Cards will be provided when they are returned.

If further information is needed, please contact us.

Yours very truly,

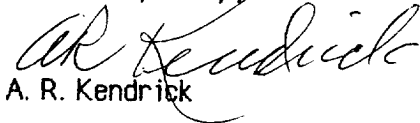
A. R. Kendrick

Enclosures

xc: Offset owners and interested parties as listed on Exhibit 0

Exhibits for Application for Non-Standard Location

**Evergreen Operating Corporation
Rosa Unit #298**

850' FSL 790' FEL Sec. 14-T31N-R4W
Basin Fruitland Coal Gas Pool
Rio Arriba County, New Mexico

The following exhibits are enclosed :

- EXHIBIT A Form C- 102, Well Location and Acreage Dedication Plat, showing the location of the well with respect to the section lines, the dedicated acreage, and the proration unit.
- EXHIBIT B Copy of Topographic Map showing the location.
(Notice that the Contour Interval is 40 feet.)
- EXHIBIT C Ownership and Offset Well Location Plat showing the location and ownership and offset wells.
- EXHIBIT D Location Windows Plat showing the "windows" for standard locations as provided by Order R-8768 with the #293 and #294 wells spotted in their approximate locations.
- EXHIBIT E Copy of Application for Permit to Drill.
- EXHIBIT F On-Site Inspection report showing the findings of the On-Site Inspection.
- EXHIBIT G List of names and addresses of offset owners and other interested parties.

Submit to Appropriate
District Office
State Lease - 4 copies
Fee Lease - 3 copies

State of New Mexico
Energy, Minerals and Natural Resources Department

Form C-102
Revised 1-1-89

OIL CONSERVATION DIVISION

P.O. Box 2088
Santa Fe, New Mexico 87504-2088

DISTRICT I

P.O. Box 1980, Hobbs, NM 88240

DISTRICT II

P.O. Drawer DD, Artesia, NM 88210

DISTRICT III

1000 Rio Brazos Rd., Aztec, NM 87410

WELL LOCATION AND ACREAGE DEDICATION PLAT

All Distances must be from the outer boundaries of the section

Operator Evergreen Operating Corporation			Lease Rosa Unit		Well No. 298
Unit Letter P	Section 14	Township 31 North	Range 4 West	County Rio Arriba	
Actual Footage Location of Well: 850 feet from the South line and 790 feet from the East line					
Ground level Elev. 6834	Producing Formation Fruitland Coal		Pool Basin Fruitland Coal	Dedicated Acreage: 320 Acres	
<p>1. Outline the acreage dedicated to the subject well by colored pencil or hatchure marks on the plat below.</p> <p>2. If more than one lease is dedicated to the well, outline each and identify the ownership thereof (both as to working interest and royalty).</p> <p>3. If more than one lease of different ownership is dedicated to the well, have the interest of all owners been consolidated by communitization, unitization, force-pooling, etc.? <input type="checkbox"/> Yes <input type="checkbox"/> No If answer is "yes" type of consolidation _____</p> <p>If answer is "no" list the owners and tract descriptions which have actually been consolidated. (Use reverse side of this form if necessary.) _____</p> <p>No allowable will be assigned to the well until all interests have been consolidated (by communitization, unitization, forced-pooling, or otherwise) or until a non-standard unit, eliminating such interest, has been approved by the Division.</p>					

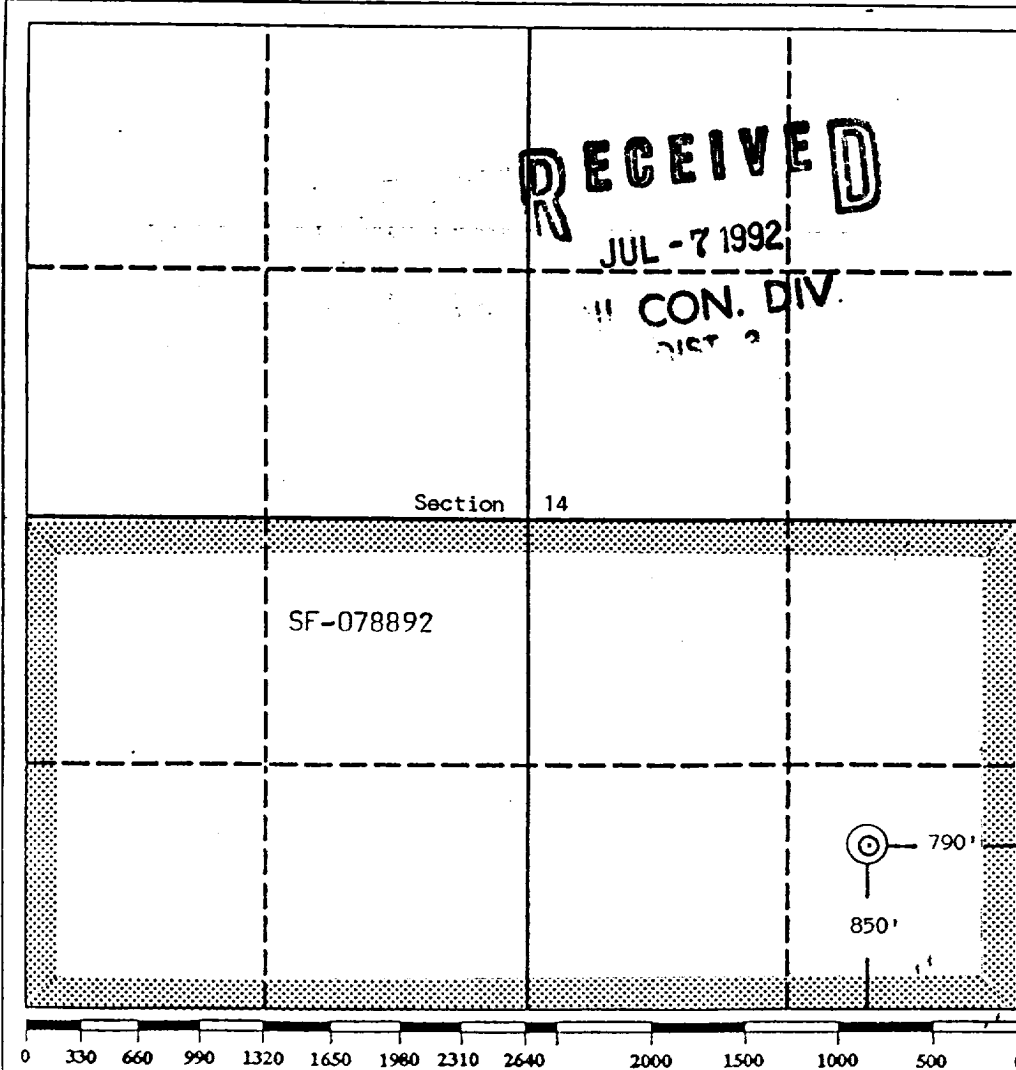

OPERATOR CERTIFICATION

I hereby certify that the information contained herein is true and complete to the best of my knowledge and belief.

Signature *A. R. Kendrick*
Printed Name A. R. Kendrick
Position Agent
Company Evergreen Operating Corp.
Date July 2, 1992

SURVEYOR CERTIFICATION

I hereby certify that the well location shown on this plat was plotted from field notes of actual surveys made by me or under my supervision, and that the same is true and correct to the best of my knowledge and belief.

Date Surveyed September 4, 1990

Signature & Seal of Professional Surveyor
Edgar L. Risenhoover
Edgar L. Risenhoover
Certificate No. 5989
New Mexico

EXHIBIT A



EXHIBIT B

Non-Standard Location for Rosa Unit #298
850' FSL 790' FEL, P-14-T31N-R4W
Basin Fruitland Coal Gas Pool

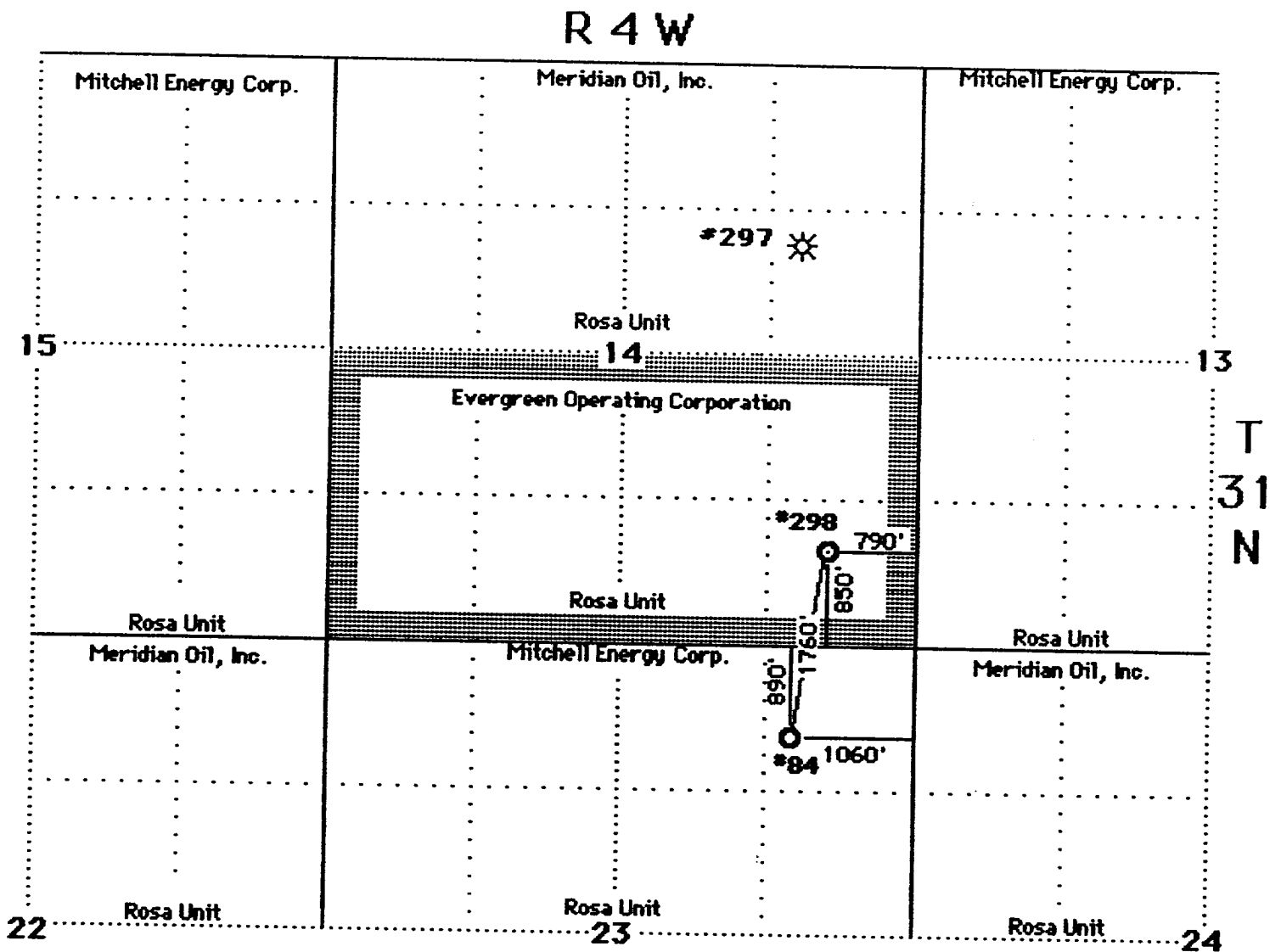

WINDOWS PLAT

Non-Standard Location for Rosa Unit #298
850' FSL 790' FEL, P-14-T31N-54W
Basin Fruitland Coal Gas Pool

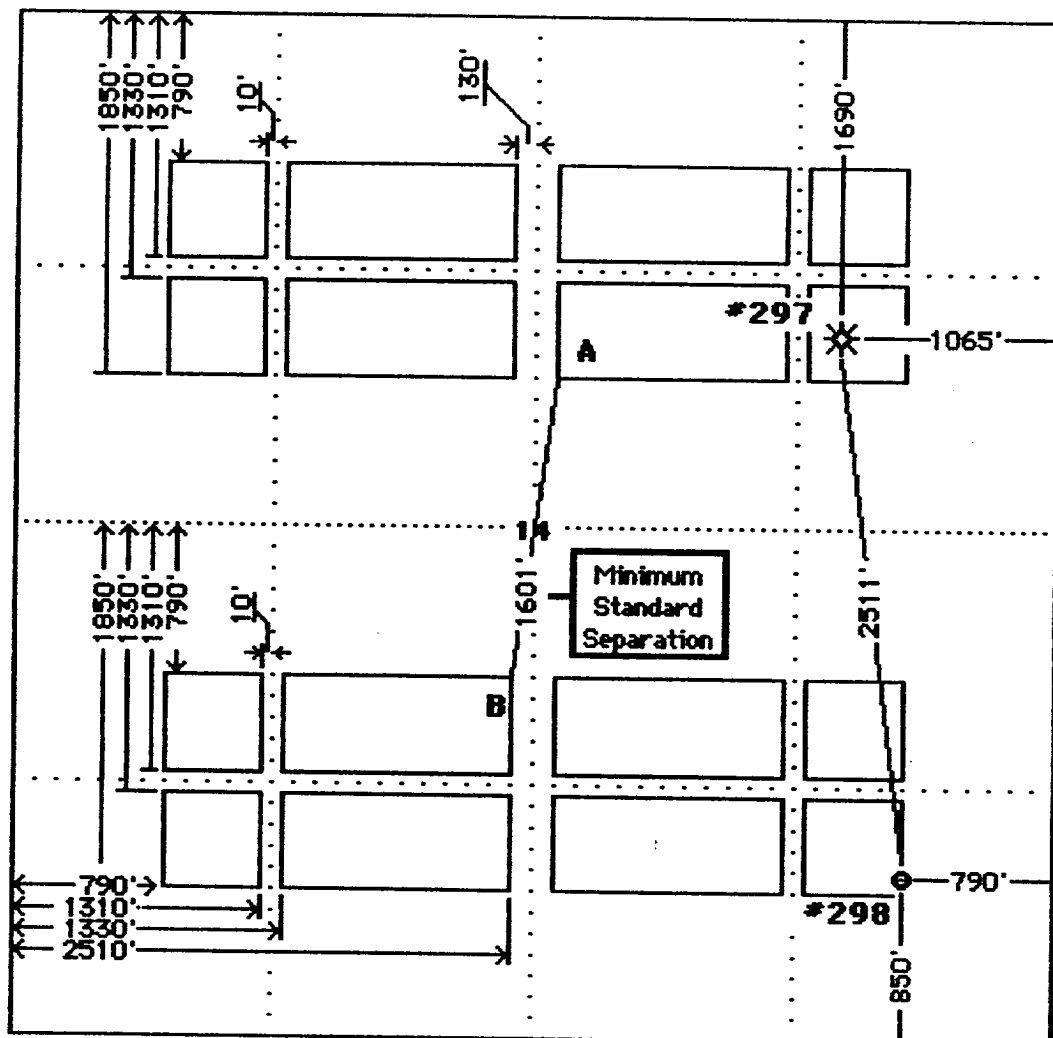

UNITED STATES
DEPARTMENT OF THE INTERIOR
BUREAU OF LAND MANAGEMENT

APPLICATION FOR PERMIT TO DRILL, DEEPEN, OR PLUG BACK

1a. Type of Work DRILL		5. Lease Number SF-078892	
1b Type of Well GAS		6. If Indian, Name of Tribe or Allottee 	
2. Operator Evergreen Operating Corp.		7. Unit Agreement Name ROSA UNIT	
3. Address & Phone No. of Operator SA. R. KENDRICK BOX 516, AZTEC, NM 87410 (505) 334-2555		8. Farm or Lease Name ROSA UNIT	
4. Location of Well (Unit P) 850' FSL 790' FEL		9. Well Number 298	
14. Distance in Miles from Nearest Town 18 MILES WEST OF DULCE, NM		10. Field, Pool, or Wildcat BASIN-FRUITLAND COAL GAS POOL	
15. Distance from Proposed Location To Nearest Property Line or Lease Line. 790'		11. Section, Township, & Range, Meridian, or Block 14-31N-4W	
16. Acres in Lease 1920 Acres		12. County RIO ARRIBA	
17. Acres Assigned to Well S-320		13. State NEW MEXICO	
18. Distance From Proposed Location To Nearest Well Dr, Compl., Or Applied For On Lease. 2511'		19. Proposed Depth 3995'	
20. Rotary or Cable Tools ROTARY		21. Elevations (DF, RT, GR, Etc.) 6834' GR	
22. Approximate Date Work Will Start. Summer to fall 1992		23. Proposed Casing and Cementing Program: 	

Exhibits attached as follows:

- | | |
|--|--|
| "A" Location and Elevation Plat
"B" Vicinity Map - Access Roads
"C" Ten-Point Compliance Program
"D" Multi-Point Requirements for APD
"E" Blowout Preventer Schematic | "F" Location Profile
"G" Drill Rig Layout
"H" Completion Rig Layout
"I" Production Facility Schematic |
|--|--|

24. Signed *A.R. Kendrick* Title Agent Date JUL 3 1992

Permit No. _____ Approval Date _____

Approved By _____ Title _____ Date _____

NOTE: THIS FORMAT IS ISSUED IN LIEU OF U.S. BLM FORM 3160-3.

E

ON-SITE FIELD INSPECTION

**Evergreen Operating Corporation
Rosa Unit #298**

850' FSL 790' FEL Sec. 14-T31N-R4W
Basin Fruitland Coal Gas Pool
Rio Arriba County, New Mexico

During our On-Site Inspection, we found the following to exist:

- The location is within the Carson National Forest.
- The terrain in the area is severe.
- The location was staked according to the instructions we received earlier from the US Forest Service with respect to avoiding unnecessary road construction, excessive cuts and fills, excessive timber removal, and other ecological damage.
- The location does not crowd any drill tract inside or outside of Section 14 according to the footage requirements in Order R-8768.
- The location is satisfactory to the Forest Service.

EXHIBIT F

**LIST OF OFFSET OWNERS AND
OTHER INTERESTED PARTIES**

Evergreen Operating Corporation

Rosa Unit #298

850' FSL 790' FEL Sec. 14-T31N-R4W
Basin Fruitland Coal Gas Pool
Rio Arriba County, New Mexico

Amoco Production Company •
P. O. Box 800
Denver, Colorado 80201

Meridian Oil, Inc. •
P.O. Box 4289
Farmington, New Mexico 87499-4289

Mitchell Energy Corporation •
2001 Timberlock Place
The Woodlands, Texas 77380

U. S. Forest Service •
Jicarilla Ranger District
Gobernador Route
Blanco, New Mexico 87412

Bureau of Land Management
1235 La Plata Highway
Farmington, New Mexico 87401

Oil Conservation Division
1000 Rio Brazos Road
Aztec, New Mexico 87410

• Notified by certified mail Return Receipt.

UNITED STATES
DEPARTMENT OF INTERIOR
BUREAU OF LAND MANAGEMENT

5. Lease Designation and Serial No.
SF-078892

6. If Indian, Allottee or Tribe Name.

7. If Unit or CA, Agreement Designation.

ROSA UNIT

8. Well Name and No.

ROSA UNIT #298

9. API Well No.

30-039-25213

10. Field and Pool, or Exploration Area

Basin-Fruitland Coal Gas Pool

11. County or Parish, State

Rio Arriba, New Mexico

SUNDRY NOTICES AND REPORTS ON WELLS

(Do not use this form for proposals to drill or to deepen or plug back to a different reservoir.

Use Form 3160-3 for such proposals.)

1. Oil well ☐ Gas Well ☒ Other ☐

Gas Well

2. Name of Operator

Evergreen Operating Corporation

3. Address & Telephone No. (505) 334-2555

c/o A. R. Kendrick, Box 516, Aztec, NM 87410

4. Location of Well (Footage & S.T.R.)

1305' FSL 2040' FWL

N - 14 - 31N - 4W

12 CHECK APPROPRIATE BOX(s) TO INDICATE NATURE OF NOTICE, REPORT, OR OTHER DATA

☒ Notice of Intent

☐ Abandonment

☐ Change Plans

☐ Recompletion

☐ New Construction

☐ Subsequent Report

☐ Plugging Back

☐ Non-Routine Fracturing

☐ Casing Repair

☐ Water Shut-Off

☐ Final Abandonment Notice

☐ Altering Casing

☐ Conversion to Injection

☒ Other _____ Change location _____ ☐ Dispose Water

17. Describe Proposed or Completed Operations (Give Pertinent Details and Dates.)

Move the well location from 850' FSL 790' FEL to: 1305' FSL 2040' FWL of section 14.

See attached plat.

RECEIVED

FEB 9 1993

**OIL CON. DIV.
DIST. 3**

APPROVED

FEB 11 1993

AREA MANAGER

NOTE: This format is issued in lieu of U.S. BLM Form 3160-5.

14. I hereby certify that the foregoing is true and correct.

Signed A. R. Kendrick Title _____ Agent _____ Date **10/2/92**

Approved by _____ Title _____ Date _____

Conditions of approval, if any:

NMOCD

RECEIVED
TELEMAIL ROOM
93 JAN 11 AM 11:55
BLM FARMINGTON, N.M.

Submit to Appropriate
District Office
State Lease - 4 copies
Fee Lease - 3 copies

State of New Mexico
Energy, Minerals and Natural Resources Department

Form C-102
Revised 1-1-89

OIL CONSERVATION DIVISION

P.O. Box 2088
Santa Fe, New Mexico 87504-2088

DISTRICT I

P.O. Box 1940, Hobbs, NM 88240

DISTRICT II

P.O. Drawer DD, Artesia, NM 88210

DISTRICT III

1000 Rio Brazos Rd., Aztec, NM 87410

WELL LOCATION AND ACREAGE DEDICATION PLAT

All Distances must be from the outer boundaries of the section

Operator Evergreen Operating Corporation		Lease Rosa Unit		Well No. 298
Unit Letter <i>N</i>	Section 14	Township 31 North	Range 4 West	County Rio Arriba
Actual Footage Location of Well: 1305 feet from the South line and 2040 feet from the West line				
Ground level Elev. 6750 Est.	Producing Formation Fruitland Coal	Pool Basin Fruitland Coal	Dedicated Acreage: 320 Acres	

- Outline the acreage dedicated to the subject well by colored pencil or hatchure marks on the plat below.
- If more than one lease is dedicated to the well, outline each and identify the ownership thereof (both as to working interest and royalty).
- If more than one lease of different ownership is dedicated to the well, have the interest of all owners been consolidated by communitization, unitization, force-pooling, etc.?
☐ Yes ☐ No If answer is "yes" type of consolidation _____
If answer is "no" list the owners and tract descriptions which have actually been consolidated. (Use reverse side of this form if necessary).
No allowable will be assigned to the well until all interests have been consolidated (by communitization, unitization, forced-pooling, or otherwise) or until a non-standard unit, eliminating such interest, has been approved by the Division.

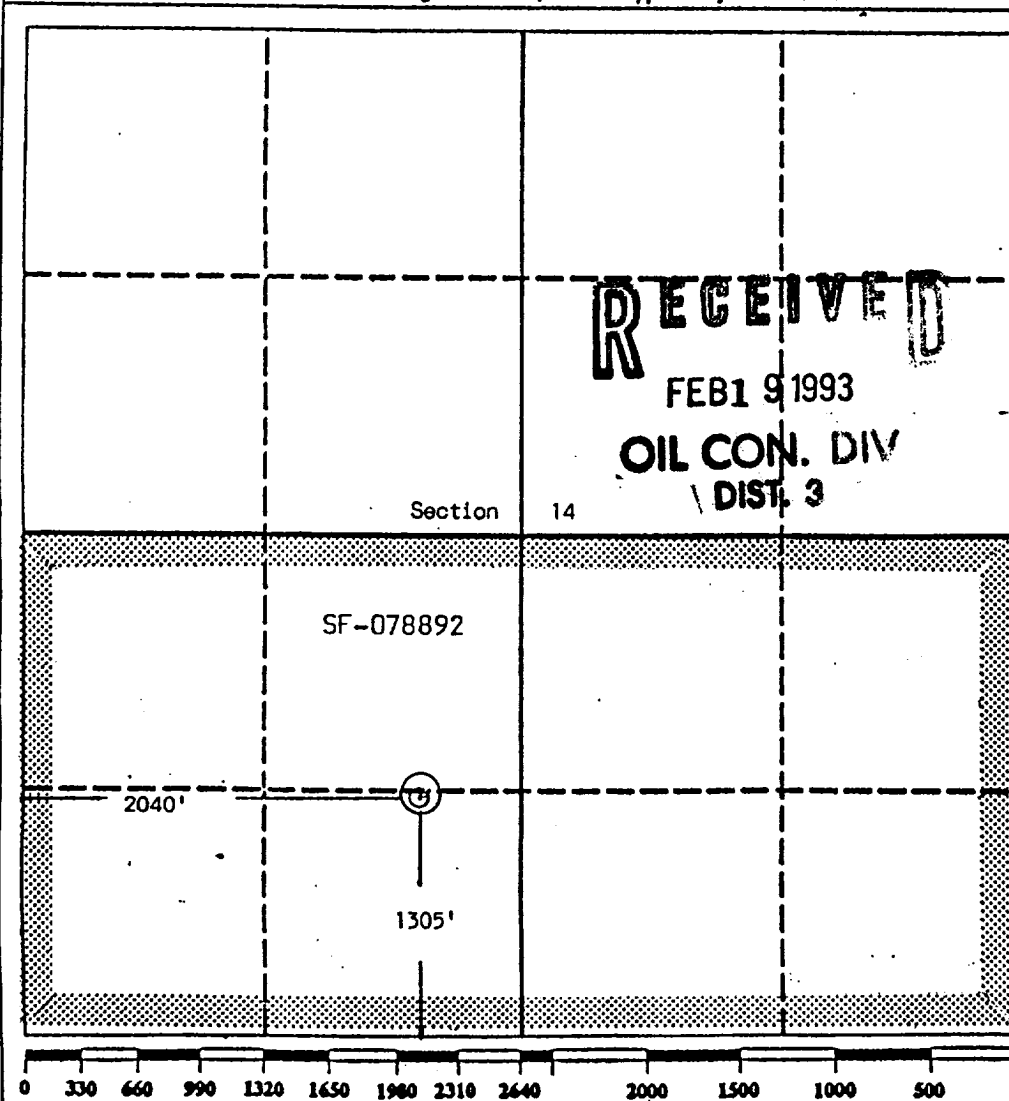

OPERATOR CERTIFICATION I hereby certify that the information contained herein is true and complete to the best of my knowledge and belief.	
Signature <i>A. R. Kendrick</i>	Printed Name A. R. Kendrick
Position Agent	
Company Evergreen Operating Corp.	
Date October 2, 1992	
SURVEYOR CERTIFICATION I hereby certify that the well location shown on this plat was plotted from field notes of actual surveys made by me or under my supervision, and that the same is true and correct to the best of my knowledge and belief.	
Date Surveyed September 26, 1992	
Signature & Seal of Professional Surveyor <i>Edgar L. Risenhoover</i> Edgar L. Risenhoover, Registered Land Surveyor, New Mexico, Certificate No. 5979	

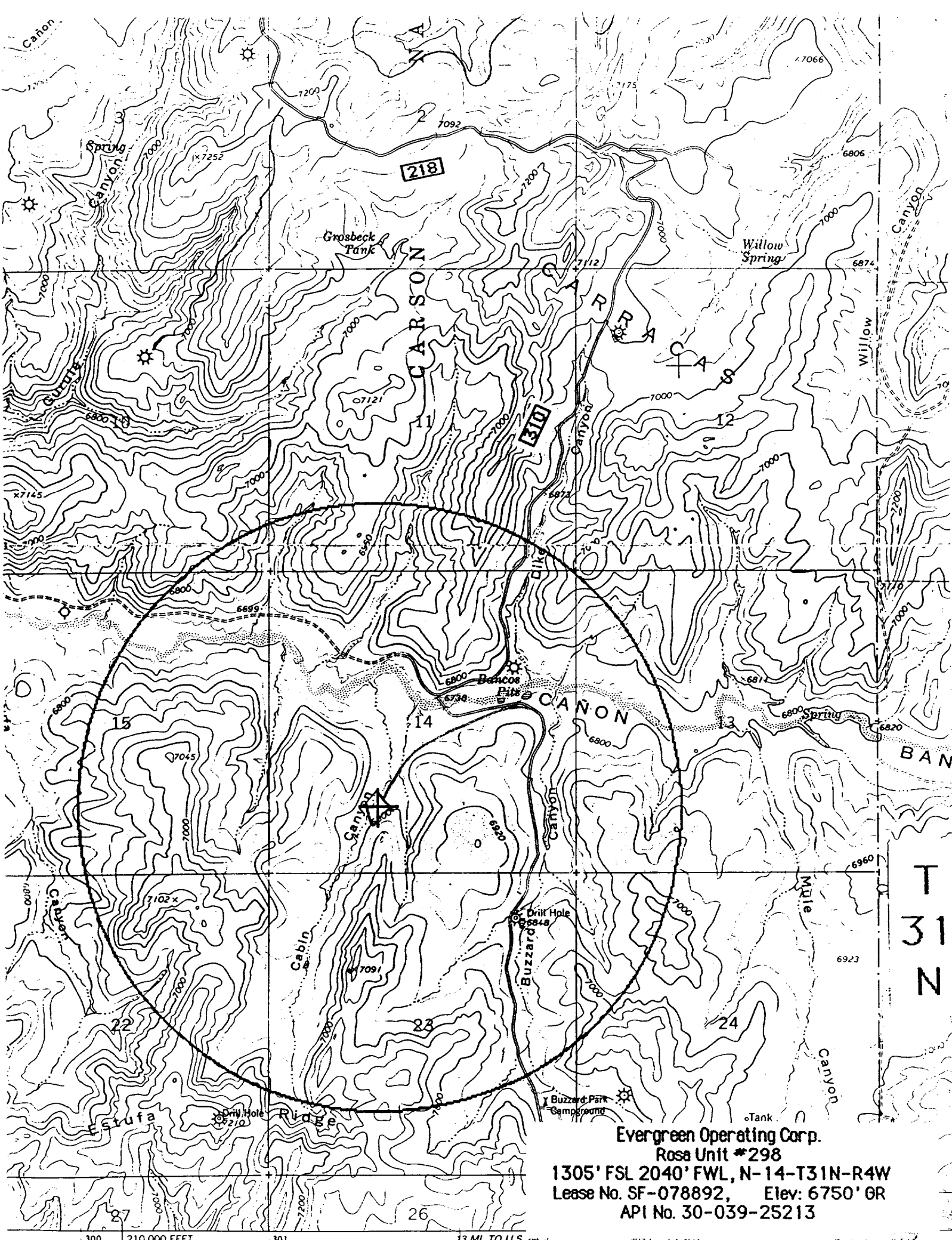

T
31
N

Evergreen Operating Corp.
Rosa Unit #298
1305' FSL 2040' FWL, N-14-T31N-R4W
Lease No. SF-078892, Elev: 6750' GR
API No. 30-039-25213

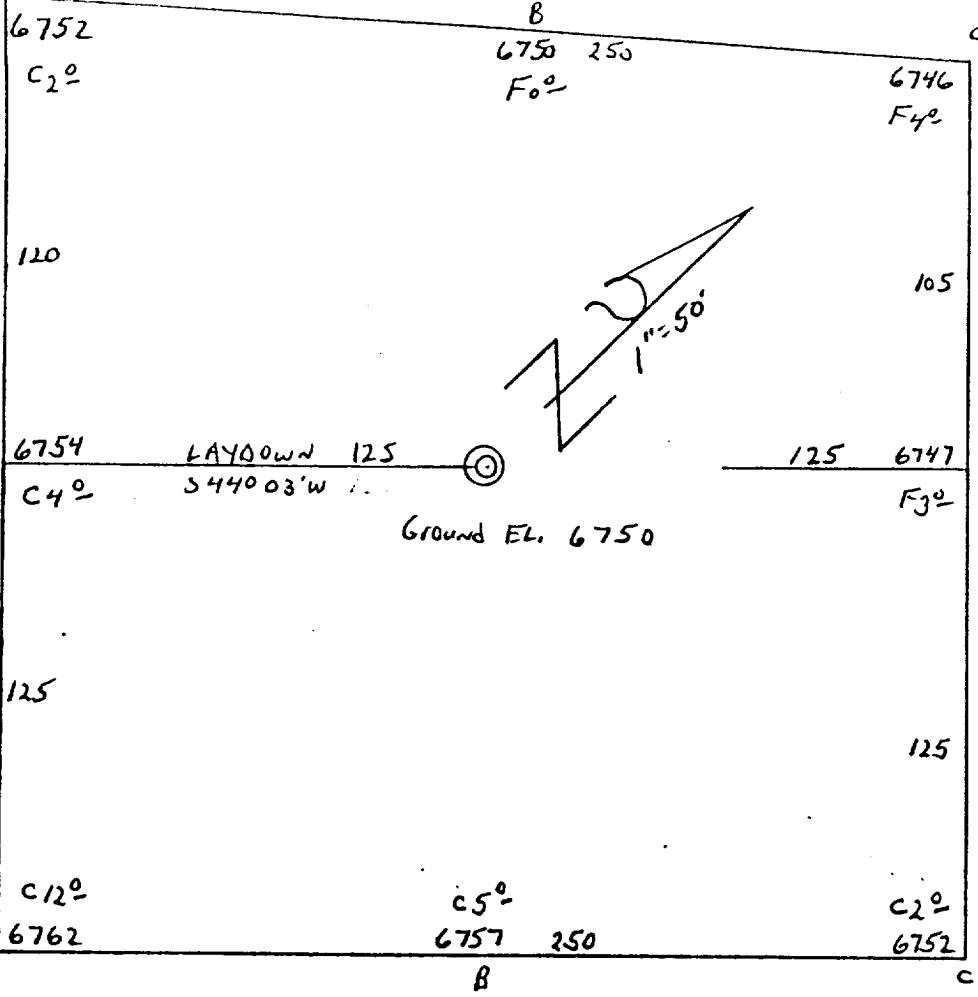

Evergreen Operating Corp.

OPERATOR

Rosa Unit 298

WELL NAME and NUMBER

1305' F/SL 2040' F/WL

FOOTAGES

14	31N	4W
SEC.	TWP.	RGB.

Rio Arriba, New Mexico

COUNTY	STATE
--------	-------

September 26, 1992

DATE

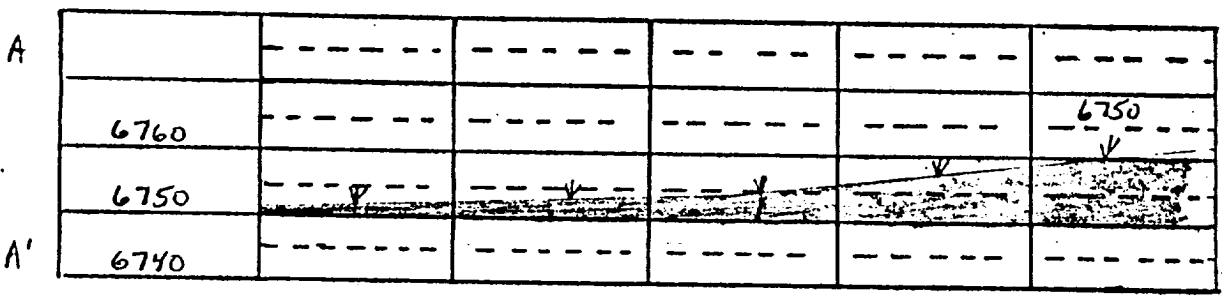

SCALE

Horiz. 1" = 50'

Vert. 1" = 30'

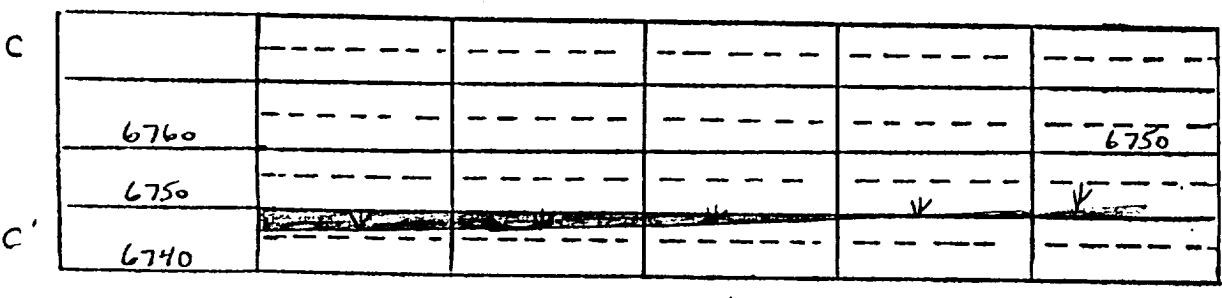
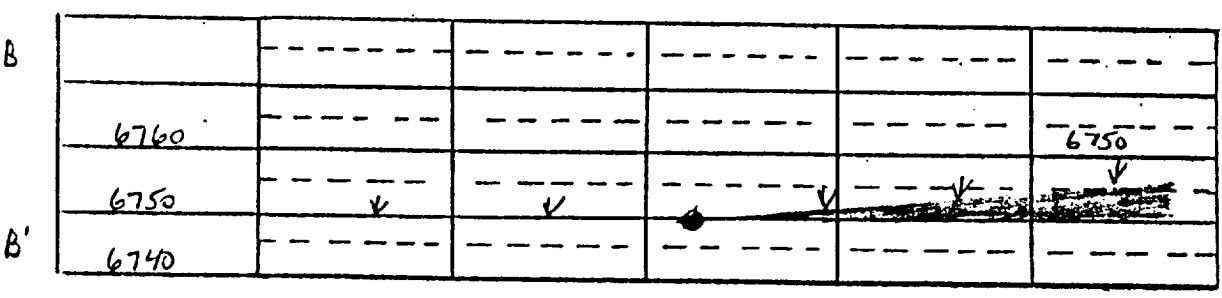

MULTI-POINT SURFACE USE PROGRAM

Evergreen Operating Corp.
Rosa Unit #298
1305' FSL 2040' FWL Sec. 14 - T 31 N - R 4 W
Elev: 6750' OR
Lease No. **SF-078892**

1. EXISTING ROADS:

- a. See Exhibit A for well site and elevation plat, Form C-102.
- b. Directions: turn north off U.S. 64 one quarter mile west of the east boundary of the Carson National Forest onto Road 310 for approximately 17 miles to the south edge of Bancos Canyon. The well pad is in Cabin Canyon, one-half mile south of Bancos Canyon.
- d. All existing roads are shown on Exhibit B
- e. This is a development well.
- f. All existing and newly constructed roads will be maintained in the same or better condition.

2. PLANNED ACCESS ROAD:

- a. The access road is approximately 3,000 feet in length as shown on Exhibit B.
- b. The grade will be 10% or less.
- c. No turnouts are planned.
- d. Any necessary water bars will be installed.
- e. Culverts will be installed as necessary. No major cuts and fills are planned.
- f. Only native materials will be used.
- g. Gates or cattleguards will be installed only where necessary.
- h. New access roads and existing roads will be flat bladed and/or upgraded as deemed necessary by the dirt contractor.

3. LOCATION OF EXISTING WELLS WITHIN ONE MILE: See EXHIBIT B.

- a. Water wells: none.
- b. Abandoned wells: one.
- c. Temporarily abandoned wells: none.
- d. Disposal wells: none.
- e. Drilling wells: none.
- f. Producing wells: none.
- g. Shut-in wells: three.
- h. Injection wells: none.
- i. Monitoring wells: none.

MULTI-POINT SURFACE USE PROGRAM

Evergreen Operating Corp.
Rosa Unit #298
1305' FSL 2040' FWL Sec. 14 - T 31 N - R 4 W
Elev: 6750' OR
Lease No. **SF-078892**

4. LOCATION OF PRODUCING FACILITIES:

- a. There are no production facilities owned or controlled by Operator within one mile of the proposed well. However, additional wells are proposed at this time.
- b. New facilities contemplated in the event of production are shown on Exhibit I.
 1. A tank battery will be required.
 2. All flow lines from the well site to battery will be buried below frost line depth.
 3. Dimensions of the facility will be approximately 250' by 250'.
 4. Native materials will be used except for gravel.
 5. An earthen dike will be built around the tank battery. All production facilities will be fenced to keep domestic and wild animals out.
 6. The reserve pit will be fenced, top-screened and allowed to dry. Rehabilitation whether the well is dry or productive will be made on all unused areas in accordance with BLM and/or Forest Service stipulations.

5. LOCATION AND TYPE OF WATER SUPPLY:

- a. Water will be hauled from the nearest water source, possibly produced water.
- b. Water will be trucked to the location.
- c. No water well is anticipated at this time.

6. SOURCE OF CONSTRUCTION MATERIAL:

- a. Only native soils will be utilized.
- b. No construction materials will be removed from Federal or Indian lands.
- c. Surface and subsoil materials in the immediate area will be utilized. Any gravel will be purchased from a commercial source.
- d. All major access roads are shown on Exhibit B.

7. METHOD FOR HANDLING WASTE DISPOSAL:

- a. Drill cuttings are to be contained and buried in the reserve pit.
- b. Drilling fluids are to be contained in the reserve pit. (Lined)

MULTI-POINT SURFACE USE PROGRAM

Evergreen Operating Corp.
Rosa Unit #298
1305' FSL 2040' FWL Sec. 14 - T 31 N - R 4 W
Elev: 6750' GR
Lease No. SF-078892

- c. The produced fluids will be stored in a production tank. Flammable waste is to be contained in the trash bin. Any spills of oil, gas, water or other production fluids will be cleaned up and removed.
 - d. Chemical facilities will be provided for human waste.
 - e. Garbage and non-flammable waste are to be contained in the trash bin and hauled away in the trash bin. Flammable waste is to be contained in the trash bin. The reserve pit will be fenced on three sides during drilling operations and the forth side fenced and top-screened when the drill rig is removed off location.
 - f. All trash, garbage, etc. is to be contained and hauled away at the end of drilling operations. Reserve and mud pits will be allowed to dry after drilling and completion operations are completed and then adequately filled and leveled. All garbage and sewage pits will be filled as soon as the completion rig leaves the location.
8. **ANCILLARY FACILITIES:** none required.
9. **WELL SITE LAYOUT:**
- a. Location profile plat is Exhibit F.
 - b. Drilling rig layout shown as Exhibit G.
 - c. Completion rig layout show as Exhibit H.
10. **SURFACE RESTORATION PLAN:**
- a. Restoration of the well site and access road will begin as soon as all pits have dried. Waste disposal and spoil materials will be buried or hauled away immediately after drilling is completed. If production is obtained, the unused area will be restored as soon as feasible.
 - b. Should the well be abandoned, the drilling site will be reshaped as closely to the original contour as possible. The access road will be plowed and shaped. Both road and location will have topsoil replaced and reseeded when germination can occur. The portion of the location needed for daily operations and access road will be kept in good repair and clean.
 - c. In either case, cleanup of the well site will include removal of all waste, fencing of all pits, removal of all oil accumulated on pits, and filling of pits.

MULTI-POINT SURFACE USE PROGRAM

Evergreen Operating Corp.

Rosa Unit #298

1305' FSL 2040' FWL Sec. 14 - T 31 N - R 4 W

Elev: 6750' GR

Lease No. SF-078892

11. OTHER INFORMATION:

- a. General topography is shown on Exhibit B.
- b. All known archaeological or cultural sites near the proposed roadway or location have been identified and will be left intact.
- c. Animal life: mule deer, elk, rodents, and scavengers.
- d. Dwellings: none.
- e. Surface jurisdiction: Carson National Forest, Jicarilla Ranger District.
- f. Restrictions: As specified by BLM and Forest Service.
- g. Drilling is planned for summer, 1993. Completion time: approximately 15 days.

12. OPERATOR REPRESENTATIVES:

(Paperwork)
A. R. Kendrick
Consultant
Box 516
Aztec, NM 87410
(505) 334-2555

(Office)
Bob Brady or Dennis Carlton
Evergreen Operating Corporation
1512 Larimer Street, Suite 1000
Denver, CO 80202
(303) 534-0400

13. CERTIFICATION:

I hereby certify that I, or persons under my direct supervision, have inspected the proposed drill site and access route; that I am familiar with the conditions which currently exist; that the statements made in this plan are, to the best of my knowledge, true and correct; and, that the work associated with the operations proposed herein will be performed by the operator, his contractors and subcontractors in conformity with this plan and the terms and conditions under which it is approved. This statement is subject to the provisions of 18 U.S.C. 1001 for the filing of a false statement.

EVERGREEN OPERATING CORPORATION

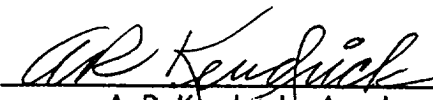
A. R. Kendrick, Agent

Revised EXHIBIT D

A. R. KENDRICK

P.O. Box 516 • Aztec, New Mexico 87410 • (505) 334-2555

Evergreen Operating Corp.
Rosa Unit #298
1305' FSL 2040' FWL
N-14-T31N-R4W

I hereby certify the following to be the deviation record of the wellbore of the Rosa Unit #298 well as determined from the available records:

DEPTH	DEVIATION
100'	1°
191'	1/2°
342'	3/4°
554'	1/2°
762'	3/4°
1070'	1°
1356'	1°
1502'	1-3/4°
1721'	1-3/4°
2032'	3-1/4°
2127'	3-1/2°
2221'	3-1/4°
2346'	2-3/4°
2471'	3°
2638'	2-1/2°
2723'	3-1/2°
2846'	3°
2973'	3°
3096'	3°
3247'	3-1/4°
3341'	3°
3498'	2-3/4°
3747'	2°

RECEIVED
AUG 10 1993
OIL CON. DIST. 3

A. R. Kendrick, Agent

SUBSCRIBED AND SWORN TO BEFORE ME this 10th day of August, 1993.

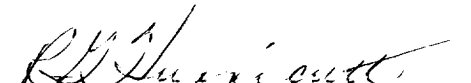
Notary Public

My commission expires March 29, 1994.