

NO. OF COPIES RECEIVED	5
DISTRIBUTION	
SANTA FE	1
FILE	1
U.S.G.S.	2
LAND OFFICE	
OPERATOR	1

NEW MEXICO OIL CONSERVATION COMMISSION

Form C-101
Revised 1-1-65

5A. Indicate Type of Lease
STATE ☐ FEE ☒

5. State Oil & Gas Lease No.

APPLICATION FOR PERMIT TO DRILL, DEEPEN, OR PLUG BACK

1a. Type of Work b. Type of Well OIL WELL <input type="checkbox"/> GAS WELL <input checked="" type="checkbox"/> OTHER <input type="checkbox"/> SINGLE ZONE <input checked="" type="checkbox"/> MULTIPLE ZONE <input type="checkbox"/>		DRILL <input checked="" type="checkbox"/> DEEPEN <input type="checkbox"/> PLUG BACK <input type="checkbox"/>		7. Unit Agreement Name
2. Name of Operator PAN AMERICAN PETROLEUM CORPORATION		3. Address of Operator P. O. Box 480, Farmington, New Mexico		8. Farm or Lease Name Ulibarri Gas Unit Comp.
4. Location of Well UNIT LETTER N LOCATED 790 FEET FROM THE South LINE AND 1685 FEET FROM THE West LINE OF SEC. 35 TWP. 30N RGE. 9W NMPM		9. Well No. 3		10. Field and Pool, or Wildcat Basin Dakota
12. County San Juan				
19. Proposed Depth 6900		19A. Formation Dakota		20. Rotary or C.T. Rotary
21. Elevations (Show whether DF, RT, etc.) Will Report Later		21A. Kind & Status Plug. Bond Statewide		22. Approx. Date Work will start July 2, 1965

PROPOSED CASING AND CEMENT PROGRAM

SIZE OF HOLE	SIZE OF CASING	WEIGHT PER FOOT	SETTING DEPTH	SACKS OF CEMENT	EST. TOP
13-3/4"	10-3/4"	32.5#	300	300	Surface
9-7/8"	7-5/8"	24 #	2500	600	Surface
6-3/4"	4-1/2"	10.5#	6900	475	Surface

(Two stage tool set 100' below Mesaverde)

Copies of location plat are attached.

Copies of any logs run will be furnished upon completion of well.

Verbal approval received 7-2-65 E. C. Arnold to F. H. Hollingsworth



IN ABOVE SPACE DESCRIBE PROPOSED PROGRAM: IF PROPOSAL IS TO DEEPEN OR PLUG BACK, GIVE DATA ON PRESENT PRODUCTIVE ZONE AND PROPOSED NEW PRODUCTIVE ZONE. GIVE BLOWOUT PREVENTER PROGRAM, IF ANY.

I hereby certify that the information above is true and complete to the best of my knowledge and belief.

ORIGINAL SIGNED BY
F. H. HOLLINGSWORTH

Fred L. Nabors, District Engineer

Signed _____ Title _____ Date July 6, 1965

(This space for State Use)

APPROVED BY _____ DATE 6-8-65

CONDITIONS OF APPROVAL, IF ANY:

APPROVAL VALID
FOR 90 DAYS UNLESS
DRILLING COMMENCED,

EXPIRES 10-6-65

JULY 2, 1965

PAN AMERICAN PETROLEUM CORPORATION

ULIBARRI GAS ~~UNIT~~ *Comm*

35 NORTH 1685 WEST
790 SOUTH 1685 WEST

SAN JUAN REPORT LATER

320 BASIN DAKOTA

DAKOTA

1. Is the operator the full owner in the field? ☒ Yes ☐ No
2. Is the operator a corporation? ☒ Yes ☐ No

Unitized Common, tied

Unit.

RECEIVED

JUL 8 1965

OIL CON. COM.
DIST. 3

PAN AMERICAN PETROLEUM CORP.

F. H. Hollingsworth

P. O. Box 480

Farmington, New Mexico

Sec 35

Ref: GLO plat dated July 2, 1952.

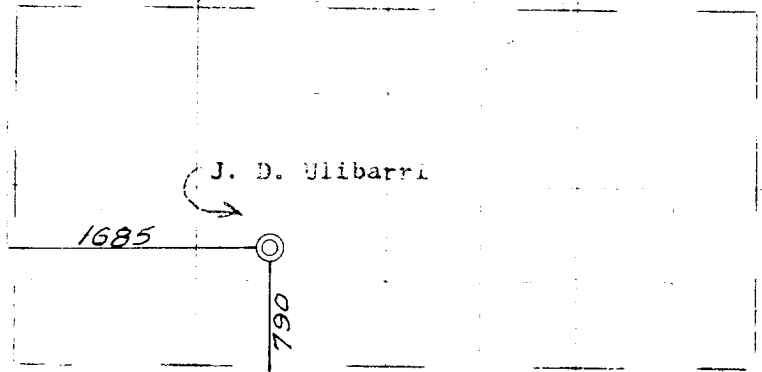

Scale 1 inch equals 1 mile

This plat was prepared for the purpose of a unitized gas field and that the same be for the benefit of the unit.

June 10, 1965.

James P. Leese
James P. Leese, R. Reg. No. 11403
San Juan Engineering Company

