

	34	
		0

**30
N**

(SUBMIT IN TRIPLICATE)

UNITED STATES
DEPARTMENT OF THE INTERIOR
GEOLOGICAL SURVEY

Budget Bureau No. 42-R358.4.
Approval expires 12-31-60.

Santa Fe
Land Office **080466**
Lease No. _____
Unit _____

SUNDRY NOTICES AND REPORTS ON WELLS

NOTICE OF INTENTION TO DRILL	<input checked="" type="checkbox"/>	SUBSEQUENT REPORT OF WATER SHUT-OFF	
NOTICE OF INTENTION TO CHANGE PLANS		SUBSEQUENT REPORT OF SHOOTING OR ACIDIZING	
NOTICE OF INTENTION TO TEST WATER SHUT-OFF		SUBSEQUENT REPORT OF ALTERING CASING	
NOTICE OF INTENTION TO RE-DRILL OR REPAIR WELL		SUBSEQUENT REPORT OF RE-DRILLING OR REPAIR	
NOTICE OF INTENTION TO SHOOT OR ACIDIZE		SUBSEQUENT REPORT OF ABANDONMENT	
NOTICE OF INTENTION TO PULL OR ALTER CASING		SUPPLEMENTARY WELL HISTORY	
NOTICE OF INTENTION TO ABANDON WELL			

(INDICATE ABOVE BY CHECK MARK NATURE OF REPORT, NOTICE, OR OTHER DATA)

April 5, 1961

Well No. **1-34** is located **790** ft. from **1/4** line and **790** ft. from **E/W** line of sec. **34**
SE SE 34 **30 N** **14W** **NMPM**
 (1/4 Sec. and Sec. No.) (Twp.) (Range) (Meridian)
Basin-Dakota **San Juan** **New Mexico**
 (Field) (County or Subdivision) (State or Territory)

The elevation of the derrick floor above sea level is _____ ft. **5485 G.L.**

DETAILS OF WORK

(State names of and expected depths to objective sands; show sizes, weights, and lengths of proposed casings; indicate mudding jobs, cementing points, and all other important proposed work)

Operator proposes to drill a well to a total depth of approximately **6200** feet to test the Dakota formation for oil and/or gas.

CASING PROGRAM: Set 8-5/8" surface casing at approximately 250' with approximately 200 sacks cement; if warranted, set 5-1/2" production string with approximately 300 sacks cement.

I understand that this plan of work must receive approval in writing by the Geological Survey before operations may be commenced.

Company **Compass Exploration, Inc.**
 Address **101 University Boulevard**
Denver 6, Colorado
DU 8-6464

By **RJ Fanelly**
 Title **Chief Geologist**

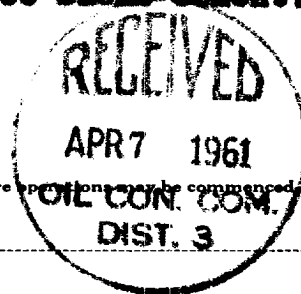

NEW MEXICO OIL CONSERVATION COMMISSION
Well Location and Acreage Dedication Plat

Section A.

Date April 5, 1961

Operator COMPASS EXPLORATION INC. Lease AZTEC
Well No. 1-34 Unit Letter P Section 34 Township 30N Range 11W NMPN
Located 790 Feet From South Line, 790 Feet From East Line
County San Juan G. L. Elevation 5485 Dedicated Acreage 320 Acres
Name of Producing Formation Dakota Pool Basin-Dakota

1. Is the Operator the only owner* in the dedicated acreage outlined on the plat below?
Yes X No .
2. If the answer to question one is "no," have the interests of all the owners been consolidated by communitization agreement or otherwise? Yes No . If answer is "yes," Type of Consolidation
3. If the answer to question two is "no," list all the owners and their respective interests below:

Owner

Land Description

Section B

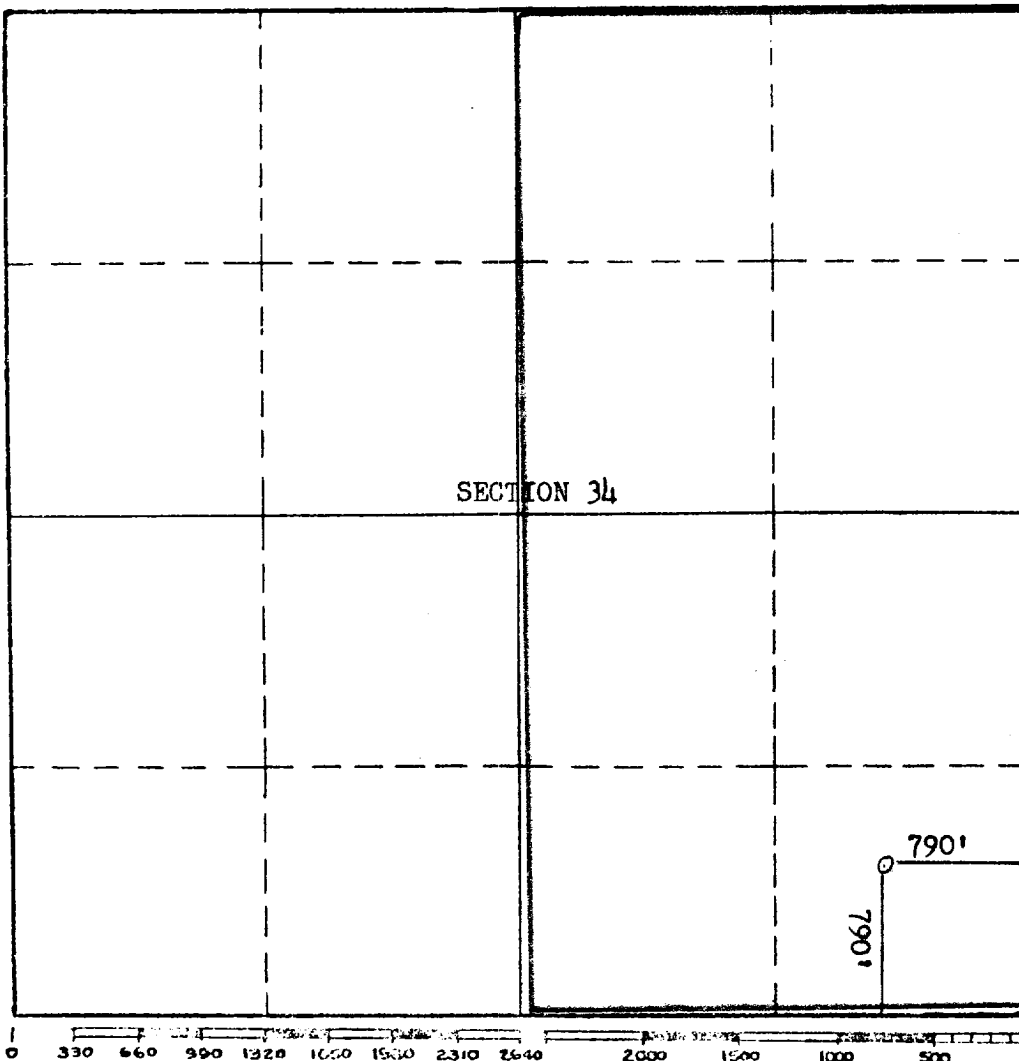

This is to certify that the information in Section A above is true and complete to the best of my knowledge and belief.

COMPASS EXPLORATION, INC.

(Operator)
**101 University Boulevard
Denver 6, Colorado**

(Representative)

P. J. Farrelly
Address Jes

This is to certify that the well location shown on the plat in Section B was plotted from field notes of actual surveys made by me or under my supervision and that the same is true and correct to the best of my knowledge and belief.

Date Surveyed March 31, 1961

Stephen H. Koney
STEPHEN H. KONEY

Registered Professional
Engineer and/or Land Surveyor.

Certificate No. 803