

30-045-08972

NO. OF COPIES RECEIVED	5
DISTRIBUTION	
SANTA FE	1
FILE	1 ✓
U.S.G.S.	2
LAND OFFICE	
OPERATOR	1

NEW MEXICO OIL CONSERVATION COMMISSION

Form C-101
Revised 1-1-65

5A. Indicate Type of Lease
STATE FEE

5. State Oil & Gas Lease No.

APPLICATION FOR PERMIT TO DRILL, DEEPEN, OR PLUG BACK

1a. Type of Work
DRILL DEEPEN PLUG BACK

b. Type of Well
OIL WELL GAS WELL OTHER
SINGLE ZONE MULTIPLE ZONE

2. Name of Operator
PAN AMERICAN PETROLEUM CORPORATION

3. Address of Operator
P. O. Box 480, Farmington, New Mexico

4. Location of Well
UNIT LETTER **I** LOCATED **1750** FEET FROM THE **South** LINE
AND **870** FEET FROM THE **East** LINE OF SEC. **33** TWP. **30-N** RGE. **9-W** NMPM

7. Unit Agreement Name
8. Farm or Lease Name
Elliott Gas Unit #1

9. Well No.
10. Field and Pool, or Wildcat
Basin Dakota

12. County
San Juan

19. Proposed Depth **6900** 19A. Formation **Dakota** 20. Rotary or C.T.
Rotary

21. Elevations (Show whether DF, RT, etc.) **Will Report Later** 21A. Kind & Status Plug. Bond **Statewide** 21B. Drilling Contractor **Brinkerhoff Drlg. Corp.** 22. Approx. Date Work will start **2-16-65**

PROPOSED CASING AND CEMENT PROGRAM

SIZE OF HOLE	SIZE OF CASING	WEIGHT PER FOOT	SETTING DEPTH	SACKS OF CEMENT	EST. TOP
13-3/4"	10-3/4"	32.75#	300	300	Surface
9-7/8"	7-5/8"	24#	2600	600	Surface
6-3/4"	4-1/2"	10.5#	6900*	450	2500'

(*Stage Tool set 100' Below Base of Mesaverde)

Copies of Location Plat are attached.



IN ABOVE SPACE DESCRIBE PROPOSED PROGRAM: IF PROPOSAL IS TO DEEPEN OR PLUG BACK, GIVE DATA ON PRESENT PRODUCTIVE ZONE AND PROPOSED NEW PRODUCTIVE ZONE. GIVE BLOWOUT PREVENTER PROGRAM, IF ANY.

I hereby certify that the information above is true and complete to the best of my knowledge and belief.

Signed Fred L. Nabors, District Engineer Title _____ Date February 3, 1965

ORIGINAL SIGNED BY
(This spot) F. H. ROLLINGSWORTH

APPROVED BY Ernest C. Mendenhall TITLE Sup. Dist. III DATE 2-5-65

CONDITIONS OF APPROVAL, IF ANY:

NEW MEXICO OIL CONSERVATION COMMISSION

Well Location and Acreage Dedication Plat

Section A.

Date February 2, 1965

Operator PAN AMERICAN PETROLEUM CORPORATION ELLIOTT GAS UNIT "N"
 Well No. 1 Unit Letter I Section 33 Township 30 NORTH Range 9 WEST NMPM
 Located 1750 Feet From the SOUTH Line, 870 Feet From the EAST Line
 County SAN JUAN G. L. Elevation REPORT LATER Dedicated Acreage 320 Acres
 Name of Producing Formation DAKOTA Pool BASIN DAKOTA

1. Is the Operator the only owner in the dedicated acreage outlined on the plat below?
 Yes _____ No X

2. If the answer to question one is "no", have the interests of all the owners been consolidated by communitization agreement or otherwise? Yes X No _____ If answer is "yes", Type of Consolidation Communitization & Operating Agreements being prepared. Pan American has all acreage except 2 1/2 acres belonging to J. W. Wilkinson, 923 Willow, Duncan, Okla., who has agreed to join in the drilling of the well.

3. If the answer to question two is "no", list all the owners and their respective interests below:

Owner _____ Land Description _____



Section B.

Note: All distances must be from outer boundaries of section.

This is to certify that the information in Section A above is true and complete to the best of my knowledge and belief.

PAN AMERICAN PETROLEUM CORP.
F. H. Hollingsworth (Operator)
F. H. Hollingsworth
 (Representative)
P. O. Box 480
 (Address)
Farmington, New Mexico

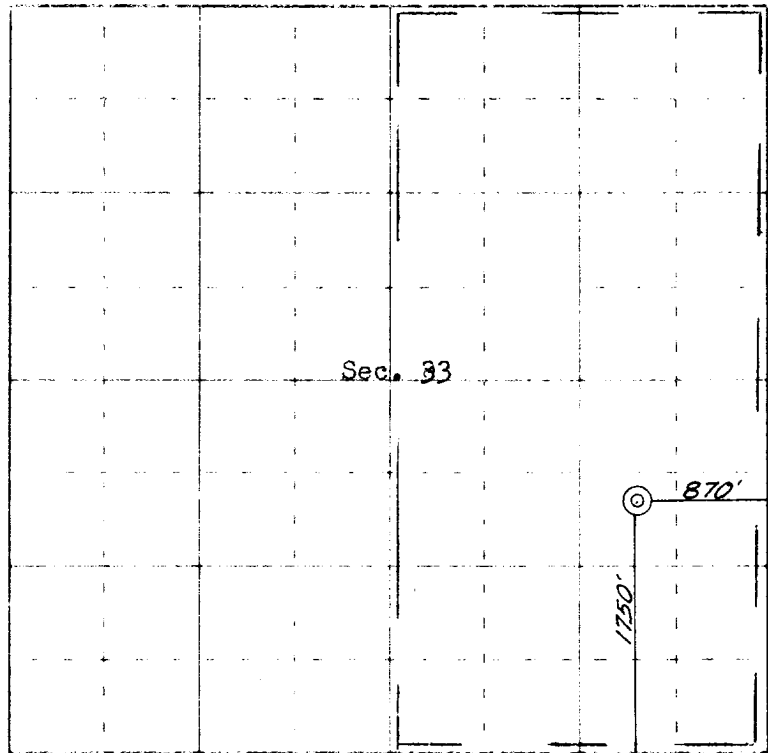

0 330 660 990 1320 1650 1980 2310 2640 2000 1500 1000 500 0

Scale 4 inches equal 1 mile

Ref: GLO plat dated 2 July 1952



This is to certify that the above plat was prepared from field notes of actual surveys made by me or under my supervision and that the same are true and correct to the best of my knowledge and belief.

(Sign)

Date Surveyed February 2, 1965

Farmington, New Mexico

James P. Leese
 Registered Professional Engineer and/or Land Surveyor
James P. Leese, N. Mex. Reg. No. 1463
 San Juan Engineering Company