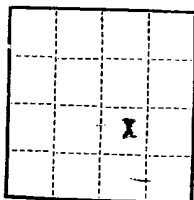

(SUBMIT IN TRIPLICATE)

Land Office Santa FeLease No. NH 03998

Unit _____

UNITED STATES
DEPARTMENT OF THE INTERIOR
GEOLOGICAL SURVEY

SUNDRY NOTICES AND REPORTS ON WELLS

NOTICE OF INTENTION TO DRILL	<input checked="" type="checkbox"/>	SUBSEQUENT REPORT OF WATER SHUT-OFF	
NOTICE OF INTENTION TO CHANGE PLANS		SUBSEQUENT REPORT OF SHOOTING OR ACIDIZING	
NOTICE OF INTENTION TO TEST WATER SHUT-OFF		SUBSEQUENT REPORT OF ALTERING CASING	
NOTICE OF INTENTION TO RE-DRILL OR REPAIR WELL		SUBSEQUENT REPORT OF RE-DRILLING OR REPAIR	
NOTICE OF INTENTION TO SHOOT OR ACIDIZE		SUBSEQUENT REPORT OF ABANDONMENT	
NOTICE OF INTENTION TO PULL OR ALTER CASING		SUPPLEMENTARY WELL HISTORY	
NOTICE OF INTENTION TO ABANDON WELL			

(INDICATE ABOVE BY CHECK MARK NATURE OF REPORT, NOTICE, OR OTHER DATA)

October 1, 1953

Well No. Pueblo Triad #1 located 1650 ft. from NH line and 1650 ft. from E line of sec. 33S&A Sec. 33 (1/4 Sec. and Sec. No.) 30W (Twp.) 10W (Range) N.M.P.M. (Meridian)Blanco Pictured Cliff (Field) San Juan (County or Subdivision) New Mexico (State or Territory)

ungraded ground

The elevation of the surface floor above sea level is 6030 ft.

DETAILS OF WORK

(State names of and expected depths to objective sands; show sizes, weights, and lengths of proposed casings; indicate landing jobs, cementing points, and all other important proposed work)

It is proposed to drill with rotary mud to the top of the Pictured Cliff formation, estimated to be at a depth of 2000' + and thereafter to drill with cable tools through the Pictured Cliff formation or the top of the Lewis shale. Final total depth estimated to be 2500' +. It is further proposed to shoot the Pictured Cliff section with solid nitro glycerine. Tentative casing program is as follows:

10 3/4" surface casing	32.75'	new	90-125'	cement circulated
7" casing	23 x 20'	new	2500' +	cement w/200 sacks

The S&A of the section is the designated drilling unit.

A Blanket Drilling Bond has been approved Dec. 8, 1952. (Refer to SF 076215-B)

I understand that this plan of work must receive approval in writing by the Geological Survey before operations may be commenced.

Company PUECO DEVELOPMENT, INC.Address P.O. BOX 1360Albuquerque, New MexicoBy Frank D. Gorham, Jr.
Title Vice President

Company Pubco Development, Inc.

Lease Pubco Trieb Well No. 1

Sec. 33, T. 30 N., R. 10 W., N.M.P.M.

Location 1650' from the South line and 1650' from the East line.

Elevation 6030 Ungraded ground.

RECEIVED
OCT 2 1953
U. S. GEOLOGICAL SURVEY
FARMINGTON, N. M.

San Juan County

New Mexico

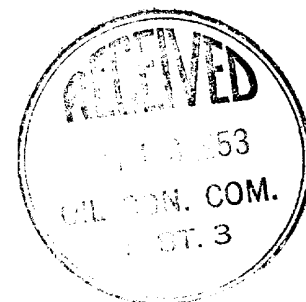
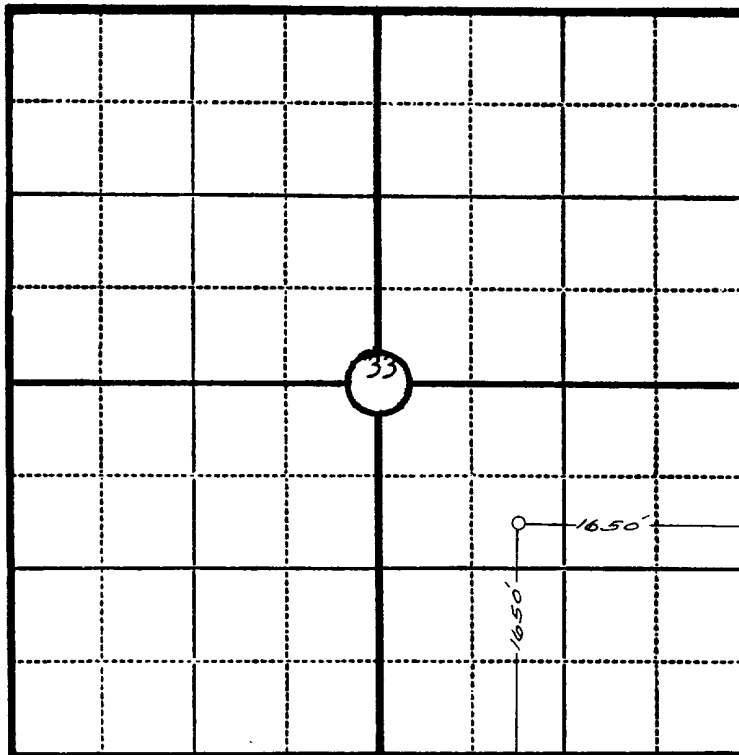

Scale—4 inches equal 1 mile.

This is to certify that the above plat was prepared from field notes of actual surveys made by me or under my supervision and that the same are true and correct to the best of my knowledge and belief.

Ernest V. Echohawk

Seal:

Registered Professional
Engineer and Land Surveyor.

Ernest V. Echohawk
N. Mex. Reg. No. 1545

Surveyed September 27, 19 53

RECEIVED
SEP 30 1953
PUBLIC AFFAIRS UNIT, R.A.

NEW MEXICO
OIL CONSERVATION COMMISSION

Gas Well Plat

Date March 25, 1954

Pubco Development, Inc. Tribe-Federal 1
Operator Lease Well No.

Name of Producing Formation Pictured Cliffs Pool Aztec Pictured Cliffs

No. Acres Dedicated to the Well 160

Indicate land status and show ownership Federal
SECTION 33 TOWNSHIP 30N RANGE 10W

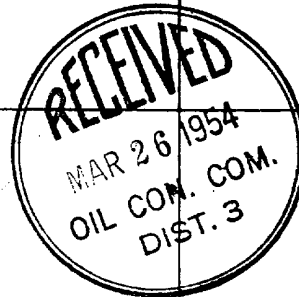

I hereby certify that the information given above is true and complete to the best of my knowledge.

H. E. Maxwell Jr.
Name Supt. Prod. Dept.
Position Pubco Development, Inc.
Representing Box 844, Aztec, New Mexico
Address

(over)

OIL CONSERVATION COMMISSION

AZTEC DISTRICT OFFICE

No. Copies Received 3

DISTRIBUTION

	NO. FURNISHED	
Operator		
Santa Fe	1	
Operation Office		
State Land Office		
S. C. S.	1	
Transporter		
File	1	✓

Adapters—Material

Size

SHOOTING RECORD

Size	Shell used	Explosive used	Quantity	Date	Depth shot	Depth cleaned out
2 x 4"	Dump	SNG	280	11-19-53	2479-2550	2555

TOOL LOG

Rotary tools were used from Surface feet to 2577 feet, and from 2577 feet to 2577 feet.
 Cable tools were used to shoot well, make out & run tubing feet to 2577 feet.

DATES

Comp 11-73

1953

Put to producing _____, 19____

The production for the first 24 hours was _____ barrels of fluid of which _____% was oil; _____% emulsion; _____% water; and _____% sediment. Gravity, °Bé. _____

If gas well, cu. ft. per 24 hours 1612 M Gallons gasoline per 1,000 cu. ft. of gas _____

Rock pressure, lbs. per sq. in. 670 (51CP)

EMPLOYEES

_____, Driller _____, Driller
 _____, Driller _____, Driller

FORMATION RECORD

FROM—	TO—	TOTAL FEET	FORMATION
Surface	1330	1330	Tertiary Sands & shales
1330	2112	780	Kirtland
2112	2464	552	Fruitland
2464	2550	86	Pictured Cliffs
2550	2577	27	Lewis
	TD 2577		
LEON	LO	JOLYF REEL	(OVER) ROBYNATION

16-43094-2

FORMATION RECORD—Continued

Size casing	5/8 1 1/2	Where set	98 2463	Number sacks of cement	150 187	Method used	Howo Howo	Mud gravity		Amount of mud used	
-------------	--------------	-----------	------------	------------------------	------------	-------------	--------------	-------------	--	--------------------	--

NEW MEXICO OIL CONSERVATION COMMISSION

Santa Fe, New Mexico

It is necessary that Form C-104 be approved before this form can be approved an *initial* allowable be assigned to any completed Oil or Gas well. Submit this form in **QUADRUPLICATE**.

CERTIFICATE OF COMPLIANCE AND AUTHORIZATION TO TRANSPORT OIL AND NATURAL GAS

Company or Operator..... **Pubco Development Inc.** Lease..... **Trieb**
Address..... **Box 844, Artes, New Mexico** **Box 1360, Albuquerque, New Mexico**
(Local or Field Office) (City or Town)
Unit..... **J** Well(s) No..... **1** Sec..... **33** T..... **30N** R..... **10W** Pool..... **Artes Pictured Cliffs**
County..... **San Juan** Kind of Lease:..... **Federal**
If Oil well Location of Tanks.....
Authorized Transporter..... **El Paso Natural Gas Co.** Address of Transporter
..... **Farmington, New Mexico** **El Paso, Texas**
(Local or Field Office) (Place of Business)
Per cent of **Oil** or Natural Gas to be Transported..... **100%** Other Transporters authorized to transport Oil or Natural Gas
from this unit are.....

REASON FOR FILING: (Please check proper box)

NEW WELL..... ☒ CHANGE IN OWNERSHIP..... ☐
CHANGE IN TRANSPORTER..... ☐ OTHER (Explain under Remarks)..... ☐

REMARKS:

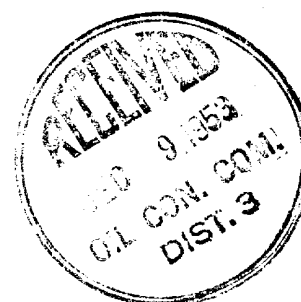

The undersigned certifies that the Rules and Regulations of the Oil Conservation Commission have been complied with.

Executed this the 8th day of December 1951

Approved: 12-9- 1953 Pubco Development Inc.

OIL CONSERVATION COMMISSION
Original signed by

By John J. Abendschan

By K. D. Sharp T. K. Sharpe

Title... **Geologist**.....

Title PETROLEUM ENGINEER DIST. NO. 3

(See Instructions on Reverse Side)

INSTRUCTIONS

This form shall be executed and filed in QUADRUPLICATE with the District Office of the Oil Conservation Commission, covering each unit from which oil or gas is produced. A separate certificate shall be filed for each transporter authorized to transport oil or gas from a unit. After said certificate has been approved by the Oil Conservation Commission, one copy shall be forwarded to the transporter, one copy returned to the producer, and two copies retained by the Oil Conservation Commission.

A new certificate shall be filed to cover each change in operating ownership and each change in the transporter, except that in the case of a temporary change in the transporter involving less than the allowable production for one proration period, the operator shall in lieu of filing a new certificate notify the Oil Conservation Commission District Office, and the transporter authorized by certificate on file with the Commission, by letter of the estimated amount of oil or gas to be moved by the transporter temporarily moving oil or gas from the unit and the name of such temporary transporter and a copy of such notice shall also be furnished such temporary transporter. Such temporary transporter shall not move any more oil or gas than the estimated amount shown in said notice.

This certificate when properly executed and approved by the Oil Conservation Commission shall constitute a permit for pipe line connection and authorization to transport oil and gas from the property named therein and shall remain in full force and effect until

- (a) Operating ownership changes
- (a) The transporter is changed or
- (c) The permit is cancelled by the Commission.

If any of the rules and regulations of the Oil Conservation Commission have not been complied with at the same time this report is filed, explain fully under the heading "REMARKS."

In all cases where this certificate is filed to cover a change in operating ownership or a change in the transporter designated to move oil or gas, show under "REMARKS" the previous owner or operator and the transporter previously authorized to transport oil or gas.

A separate report shall be filed to cover each producing unit as designated by the Oil Conservation Commission.

OIL CONSERVATION COMMISSION		
AZTEC DISTRICT OFFICE		
No. Copies Received		4
DISTRIBUTION		
	NO. FURNISHED	
Operator	1	
Santa Fe	1	
Proration Office		
State Land Office		
U. S. G. S.		
Transporter	1	
File	1	✓

NEW MEXICO OIL CONSERVATION COMMISSION
Santa Fe, New Mexico

REQUEST FOR (OIL) - (GAS) ALLOWABLE

New Well
Recompletion

This form shall be submitted by the operator before an initial allowable will be assigned to any completed Oil or Gas well. Form C-104 is to be submitted in QUADRUPLICATE to the same District Office to which Form C-101 was sent. The allowable will be assigned effective 7:00 A.M. on date of completion or recompletion, provided this form is filed during calendar month of completion or recompletion. The completion date shall be that date in the case of an oil well when oil is delivered into the stock tanks. Gas must be reported on 15.025 psia at 60° Fahrenheit.

Astec, New Mexico 12-8-53
(Place) (Date)

WE ARE HEREBY REQUESTING AN ALLOWABLE FOR A WELL KNOWN AS:

Pubco Development Inc. Trieb, Well No. 1, in NW $\frac{1}{4}$ SE $\frac{1}{4}$,
(Company or Operator) (Lease)
1, Sec. 33, T. 30N, R. 10W, NMPM., Astec Pictured Cliffs Pool
(Unit)
San Juan County. Date Spudded 10-23-53, Date Completed 10-31-53

Please indicate location:

		●	

Elevation 6038 Total Depth 2577, P.B.Top oil/gas pay 2064 Prod. Form.

Casing Perforations:

Depth to Casing shoe of Prod. String 2463

Natural Prod. Test BOPD

based on bbls. Oil in Hrs. Mins.

Test after acid or shot 1612 MCF after 3 hrs. open flow BOPD

Based on bbls. Oil in Hrs. Mins.

Gas Well Potential 1612 MCF after 3 hrs. open flowSize choke in inches 2"

Date first oil run to tanks or gas to Transmission system:

Transporter taking Oil or Gas: El Paso Natural Gas

Casing and Cementing Record

Size Feet Sax

9 5/8	98	150
5 1/2	2463	187

Remarks:

I hereby certify that the information given above is true and complete to the best of my knowledge.

Approved 12-9-53, 1953

OIL CONSERVATION COMMISSION

Original signed by

By: John J. AbendschanTitle PETROLEUM ENGINEER DIST. NO. 3Pubco Development Inc.
(Company or Operator)By: K. M. Sharp
(Signature)Title Geologist

Send Communications regarding well to:

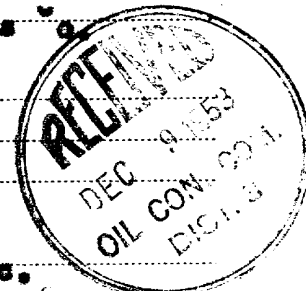
Name Pubco Development Inc.Address Box 844, Astec, New Mexico

OIL CONSERVATION COMMISSION		
AZTEC DISTRICT OFFICE		
No. Copies Received		4
DISTRIBUTION		
	NO. FURNISHED	
Operator	1	
Santa Fe	1	
Proration Office	1	
State Land Office		
U. S. G. S.		
Transporter		
File	1	✓

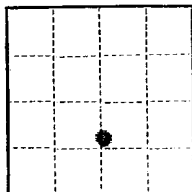

(SUBMIT IN TRIPLICATE)

UNITED STATES
DEPARTMENT OF THE INTERIOR
GEOLOGICAL SURVEY

Land Office _____
Lease No. **NY 6290**
Unit _____

SUNDRY NOTICES AND REPORTS ON WELLS

NOTICE OF INTENTION TO DRILL		SUBSEQUENT REPORT OF WATER SHUT-OFF	1
NOTICE OF INTENTION TO CHANGE PLANS		SUBSEQUENT REPORT OF SHOOTING OR ACIDIZING	
NOTICE OF INTENTION TO TEST WATER SHUT-OFF		SUBSEQUENT REPORT OF ALTERING CASING	
NOTICE OF INTENTION TO RE-DRILL OR REPAIR WELL		SUBSEQUENT REPORT OF RE-DRILLING OR REPAIR	
NOTICE OF INTENTION TO ABANDON WELL Frac	X	SUBSEQUENT REPORT OF ABANDONMENT	
NOTICE OF INTENTION TO PULL OR ALTER CASING		SUPPLEMENTARY WELL HISTORY	
NOTICE OF INTENTION TO ABANDON WELL			

(INDICATE ABOVE BY CHECK MARK NATURE OF REPORT, NOTICE, OR OTHER DATA)

November 28, 19**55**

Well No. **1** is located **1880** ft. from **S** line and **1840** ft. from **E** line of sec. **35**

22E Sec. 35 (1/4 Sec. and Sec. No.) **22E** (Twp.) **10W** (Range) **N. 1. 1. 1. N.** (Meridian)
Blanco, PC (Field) **San Juan** (County or Subdivision) **New Mexico** (State or Territory)

The elevation of the derrick floor above sea level is **6030** ft.

DETAILS OF WORK

(State names of and expected depths to objective sands; show sizes, weights, and lengths of proposed casings; indicate mudding jobs, cementing points, and all other important proposed work)

FRAC WORKOVER: October 30, 1955.

Moved in cable tool rig. pulled tubing, cleaned out small amount of savings. On October 31st, fraced with 400 bbls water, 45 BPM rate. Breakdown at 1200'. Treated at 800'. Used 20,000 # fine sand flushed with 75 bbls water.

Reran tubing. 2540' tubing in hole.

Interval treated, 2482' to 2577', TD.

ave. daily prod. October 1955 227 MCFD
Indicated production after frac 424 MCFD

I understand that this plan of work must receive approval in writing by the Geological Survey before operations may be commenced.

Company **PURCO DEVELOPMENT, INC.**

Address **167 West Chase**

Astec, New Mexico

By **H. E. Maxwell, Jr.**

Title **Supt. Prod. Dept.**

OIL CONSERVATION COMMISSION
 AZTEC DISTRICT OFFICE

No. Copies Received 2

DISTRIBUTION

Director			
Assistant			
Chief Clerk			
Chief of Office			
U.S. G. S.			
Inspector			

NEW MEXICO OIL CONSERVATION COMMISSION
SANTA FE, NEW MEXICO

Form C-110
Revised 7/1/55

(File the original and 4 copies with the appropriate district office)

CERTIFICATE OF COMPLIANCE AND AUTHORIZATION
TO TRANSPORT OIL AND NATURAL GAS

Company or Operator PUBCO PETROLEUM CORPORATION Lease Trieb

Well No. 1 Unit Letter J S 33 T 30N R 10W Pool Artes, FC

County San Juan Kind of Lease (State, Fed. or Patented) Federal

If well produces oil or condensate, give location of tanks: Unit J S 33 T 30N R 10W

Authorized Transporter of Oil or Condensate El Paso Natural Gas Company

Address Box 997 Farmington, New Mexico
(Give address to which approved copy of this form is to be sent)

Authorized Transporter of Gas El Paso Natural Gas Company

Address Box 997, Farmington, N. M.
(Give address to which approved copy of this form is to be sent)

If Gas is not being sold, give reasons and also explain its present disposition:

PUBCO PETROLEUM CORP.
MERGED INTO MESA PETROLEUM CO.
EFFECTIVE MAY 1, 1973

Reasons for Filing: (Please check proper box) New Well ()

Change in Transporter of (Check One): Oil () Dry Gas () C'head () Condensate ()

Change in Ownership () Other Change of company name (X)

Remarks: (Give explanation below)

Changed from Pubco Development, Inc. to Pubco Petroleum Corporation

The undersigned certifies that the Rules and Regulations of the Oil Conservation Commission have been complied with.

Executed this the 11th day of December 19 56

Approved DEC 12 1956 19 56

OIL CONSERVATION COMMISSION

By A. R. Kendrick

Title PETROLEUM ENGINEER DIST. NO. 3

By H. E. Maxwell, Jr.

Title Mgr. Prod. Dept.

Company PUBCO PETROLEUM CORPORATION

Address 106 West Omaha

Artes, New Mexico

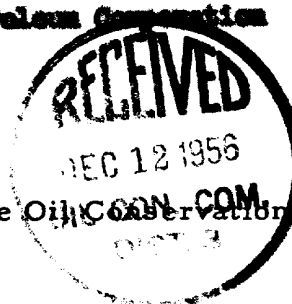

RECEIVED
 DISTRICT OFFICE
 AZTEC DISTRICT OFFICE
 OCT 11 1961

OIL CONSERVATION COMMISSION		
AZTEC DISTRICT OFFICE		
No. Copies Received	5	
DISTRICT		
Operator	1	
State Fo	1	
Operating Office		
State Land Office		
U. S. G. S.		
Transporter	2	
File	1	✓

January 28, 1970
Pubco Petroleum Corp.

<u>Lease Name and Well Number</u>	<u>Location</u>	<u>Pool</u>	<u>Present Acreage</u>	<u>Corrected Acreage</u>
-----------------------------------	-----------------	-------------	----------------------------	------------------------------

WELLS FOR WHICH FORM C-102, ACREAGE DEDICATION PLAT, MUST BE FILED
(PLEASE FILE IN TRIPLICATE)

Gage #2	H-20-30N-10W	Aztec PC	160.00	156.18
---------	--------------	----------	--------	--------

WELLS REQUIRING FILE CORRECTIONS ONLY

Gage #1	C-33-30N-10W	Aztec PC	160.00	161.12
Trieb #1	J-33-30N-10W	Aztec PC	160.00	158.14✓
Trieb Fed. #2	O-33-30N-10W	Basin Dakota	E 320.00	E 317.04



OIL CONSERVATION COMMISSION

STATE OF NEW MEXICO
1000 RIO BRAZOS ROAD - AZTEC
87410

GOVERNOR
DAVID F. CARGO
CHAIRMAN

LAND COMMISSIONER
ALEX ARMIJO
MEMBER

STATE GEOLOGIST
A. L. PORTER, JR.
SECRETARY - DIRECTOR

MEMORANDUM

FROM: EMERY C. ARNOLD, SUPERVISOR, DISTRICT #3

TO:

SUBJECT: ACREAGE CORRECTIONS, TOWNSHIP 30 NORTH, RANGE 10 WEST

The Oil Conservation Commission has received a dependent resurvey of Township 30 North, Range 10 West from the General Land Office.

In conformance with Commission policy we are changing all acreage dedications of wells producing in this township to conform with new acreages shown on the new plat. We have listed these wells in two groups - first, those for which the change will not involve an allowable change because of rule tolerances in calculating allowables and second, those wells where allowables will be affected by the acreage change. In the first instance the Commission will not require that new plats be filed to effect the corrections, as you may use this list to make file corrections and the Commission will do likewise. In the second instance the Commission will require that Form C-102, Acreage Dedication Plat, be filed with this office showing the correct acreage. The dedicated acreage total should be outlined on the plat and the acreage total should be filled in the designated blank. This form should be filed in triplicate for each well. The form need not be signed by the surveyor who staked the location as properly executed location information is already on file.

It will be appreciated if you will check the acreages shown on the list to your own records and contact us if errors are found so that the final result will be as accurate as possible.

We request that the corrected acreage plats be filed as soon as possible, preferably within the next ten days.

January 28, 1970

STATE OF NEW MEXICO
ENERGY AND MINERALS DEPARTMENT

NO. OF COPIES RECEIVED	
DISTRIBUTION	
SANTA FE	
FILE	
U.S.G.A.	
LAND OFFICE	
TRANSPORTER	OIL
OPERATOR	GAS
PERMITS OFFICE	

OIL CONSERVATION DIVISION
P. O. BOX 2088
SANTA FE, NEW MEXICO 87501

Form C-104
Revised 10-01-78
Format 06-01-83
Page 1

RECEIVED
MAR 03 1986
OIL CON. DIV.
DIST. 3

REQUEST FOR ALLOWABLE
AND
AUTHORIZATION TO TRANSPORT OIL AND NATURAL GAS

I. Operator Mesa Operating Limited Partnership

Address P.O. Box 2009, Amarillo, Texas 79189

Reason(s) for filing (Check proper box)

<input type="checkbox"/> New Well	Change in Transporter of:	
<input type="checkbox"/> Recombination	<input type="checkbox"/> Oil	<input type="checkbox"/> Dry Gas
<input checked="" type="checkbox"/> Change in Ownership	<input type="checkbox"/> Casinghead Gas	<input type="checkbox"/> Condensate

Other (Please explain) _____

If change of ownership give name and address of previous owner Mesa Petroleum Co., P.O. Box 2009, Amarillo, Texas 79189

II. DESCRIPTION OF WELL AND LEASE

Lease Name <u>Trieb Federal</u>	Well No. <u>1</u>	Pool Name, including Formation <u>Aztec Pictured Cliffs</u>	Kind of Lease <u>State, Federal or Fee Federal</u>	Lease No. _____
Location				
Unit Letter <u>J</u> : <u>1650</u> Feet From The <u>south</u> Line and <u>1650</u> Feet From The <u>east</u>				
Line of Section <u>33</u> Township <u>30N</u> Range <u>10W</u> , NMPM, <u>San Juan</u> County				

III. DESIGNATION OF TRANSPORTER OF OIL AND NATURAL GAS

Name of Authorized Transporter of Oil <input type="checkbox"/> or Condensate <input type="checkbox"/>	Address (Give address to which approved copy of this form is to be sent)
Name of Authorized Transporter of Casinghead Gas <input type="checkbox"/> or Dry Gas <input checked="" type="checkbox"/>	Address (Give address to which approved copy of this form is to be sent)
<u>El Paso Natural Gas Co.</u>	<u>P.O. Box 1492, El Paso, Texas</u>
If well produces oil or liquids, give location of tanks.	Is gas actually connected? When
Unit <u>J</u> Sec. <u>33</u> Twp. <u>30</u> Rge. <u>10</u>	<u>Yes</u>

If this production is commingled with that from any other lease or pool, give commingling order number: _____

NOTE: Complete Parts IV and V on reverse side if necessary.

VI. CERTIFICATE OF COMPLIANCE

I hereby certify that the rules and regulations of the Oil Conservation Division have been complied with and that the information given is true and complete to the best of my knowledge and belief.

Carolyn Cummings
(Signature)
Regulatory Clerk
(Title)
February 26, 1986
(Date)

OIL CONSERVATION DIVISION
APPROVED MAR - 3 1986
BY Frank J. [Signature]
TITLE SUPERVISOR DISTRICT 3

This form is to be filed in compliance with RULE 1104.
If this is a request for allowable for a newly drilled or deepened well, this form must be accompanied by a tabulation of the deviation tests taken on the well in accordance with RULE 111.
All sections of this form must be filled out completely for allowable on new and recompleted wells.
Fill out only Sections I, II, III, and VI for changes of owner, well name or number, or transporter, or other such change of condition.
Separate Forms C-104 must be filed for each pool in multiply completed wells.

NEW MEXICO OIL CONSERVATION COMMISSION
Santa Fe, New Mexico

(Form C-104)
(Revised 7/1/52)

REQUEST FOR (OIL) - (GAS) ALLOWABLE

~~RECOMPLETION~~
Recompletion

This form shall be submitted by the operator before an initial allowable will be assigned to any completed Oil or Gas well. Form C-104 is to be submitted in QUADRUPLICATE to the same District Office to which Form C-101 was sent. The allowable will be assigned effective 7:00 A.M. on date of completion or recompletion, provided this form is filed during calendar month of completion or recompletion. The completion date shall be that date in the case of an oil well when oil is delivered into the stock tanks. Gas must be reported on 15.025 psia at 60° Fahrenheit.

Astee, New Mexico December 20, 1955
(Place) (Date)

WE ARE HEREBY REQUESTING AN ALLOWABLE FOR A WELL KNOWN AS:

Pubco Development, Inc. Trish, Well No. 1, in NW $\frac{1}{4}$ SE $\frac{1}{4}$,
(Company or Operator) (Lease)
J, Sec. 55, T. 30N, R. 10W, NMPM, Astee P.C. Pool
(Unit)
San Juan County. Date Spudded 10-23-53, Date Completed 10-31-53

Please indicate location:

		•	

Elevation 6038 Total Depth 2577, P.B.

Top oil/gas pay 2954 Name of Prod. Form Pictured Cliff

Casing Perforations: _____ or

Depth to Casing shoe of Prod. String 2483

Natural Prod. Test _____ BOPD

based on _____ bbls. Oil in _____ Hrs. _____ Mins.

Test after acid or shot _____ BOPD

Based on _____ bbls. Oil in _____ Hrs. _____ Mins.

Gas Well Potential Original I.P. 1612
424 MCFD Deliverability after frac workover

Size choke in inches 2"

Date first oil run to tanks or gas to Transmission system 4-12-54

After frac workover, 10-31-55.

Transporter taking ~~PROD~~ Gas: El Paso Natural Gas Co.

Casing and Cementing Record

Size Feet Sax

<u>9 5/8</u>	<u>98</u>	<u>150</u>
<u>5 1/2</u>	<u>2483</u>	<u>187</u>
<u>2 1/2</u>	<u>2540</u>	

Remarks: frac workover: Fraced on 10-31-55 w/400 bbls. water, 20,000# fine sand, flushed
w/75 bbls. water, 45 BPM injection rate. Breakdown at 1200#. Treated at 850#.
Interval treated, 2482' to 2577', TD.

I hereby certify that the information given above is true and complete to the best of my knowledge.

Approved DEC 29 1955, 19____

OIL CONSERVATION COMMISSION

By: A. R. Kendrick
Title PETROLEUM ENGINEER DIST. NO. 3

PUBCO DEVELOPMENT, INC.
(Company or Operator)

By: H. E. Maxwell, Jr.
(Signature)

Title Supt. Prod. Dept.

Send Communications regarding well to:

Name _____

Address _____

OIL CONSERVATION COMMISSION		
AZTEC DISTRICT OFFICE		
No. Copies Received <input checked="" type="checkbox"/>		
DISTRIBUTION		
	NO. FURNISHED	
Operator	1	
Santa Fe	1	
Production Office	1	
State Land Office		
U.S.G.S.		
Trans.		
EP	1	<input checked="" type="checkbox"/>

Submit 3 Copies
Appropriate District Office
DISTRICT I
P.O. Box 1980, Hobbs, NM 88240

State of New Mexico
Energy, Minerals and Natural Resources Department

Form C-104
Revised 1-1-89
See Instructions
at Bottom of Page

OIL CONSERVATION DIVISION

P.O. Box 2088
Santa Fe, New Mexico 87504-2088

DISTRICT II
P.O. Drawer DD, Artesia, NM 88210

DISTRICT III
1000 Rio Brazos Rd., Aztec, NM 87410

REQUEST FOR ALLOWABLE AND AUTHORIZATION
TO TRANSPORT OIL AND NATURAL GAS

Operator Conoco Inc.		Well API No.
Address 3817 N.W. Expressway, Oklahoma City, OK 73112		
Reason(s) for Filing (Check proper box) <input type="checkbox"/> Other (Please explain)		
New Well <input type="checkbox"/>	Change in Transporter of:	
Recompletion <input type="checkbox"/>	Oil <input type="checkbox"/> Dry Gas <input type="checkbox"/>	
Change in Operator <input checked="" type="checkbox"/>	Casinghead Gas <input type="checkbox"/> Condensate <input type="checkbox"/>	EFFECTIVE 7-1-91
If change of operator give name and address of previous operator Mesa Operating Limited Partnership, P.O. Box 2009, Amarillo, Texas 79189		

II. DESCRIPTION OF WELL AND LEASE

Lease Name TRIEB FOOT	Well No. 1	Pool Name, Including Formation AZTEC PICTURED CLIFFS	Kind of Lease State, Federal or Fee	Lease No.
Location Unit Letter <u>J</u> : <u>1650</u> Feet From The <u>S</u> Line and <u>1650</u> Feet From The <u>E</u> Line Section <u>33</u> Township <u>30N</u> Range <u>10W</u> , NMPM, <u>JAN JUAN</u> County				

III. DESIGNATION OF TRANSPORTER OF OIL AND NATURAL GAS

Name of Authorized Transporter of Oil <input type="checkbox"/> or Condensate <input checked="" type="checkbox"/>	Address (Give address to which approved copy of this form is to be sent) Box 338, Bloomfield, New Mexico 87413
Name of Authorized Transporter of Casinghead Gas <input type="checkbox"/> or Dry Gas <input checked="" type="checkbox"/>	Address (Give address to which approved copy of this form is to be sent) P.O. Box 1492, El Paso, Texas 79999
If well produces oil or liquids, give location of tanks.	Unit <u>J</u> Sec. <u>33</u> Twp. <u>30</u> Rge. <u>10</u>
Is gas actually connected? <u>YES</u> When?	

If this production is commingled with that from any other lease or pool, give commingling order number:

IV. COMPLETION DATA

Designate Type of Completion - (X)	Oil Well	Gas Well	New Well	Workover	Deepen	Plug Back	Same Res'v	Diff Res'v
Date Spudded	Date Compl. Ready to Prod.		Total Depth			P.B.T.D.		
Elevations (DF, RKB, RT, GR, etc.)	Name of Producing Formation		Top Oil/Gas Pay			Tubing Depth		
Perforations						Depth Casing Shoe		
TUBING, CASING AND CEMENTING RECORD								
HOLE SIZE	CASING & TUBING SIZE		DEPTH SET			SACKS CEMENT		

V. TEST DATA AND REQUEST FOR ALLOWABLE

OIL WELL (Test must be after recovery of total volume of load oil and must be equal to or exceed top allowable for this depth or be for full 24 hours.)

Date First New Oil Run To Tank	Date of Test	Producing Method (Flow, pump, gas lift, etc.)	
Length of Test	Tubing Pressure	Casing Pressure	Choke Size
Actual Prod. During Test	Oil - Bbla.	Water - Bbla.	Gas - MCF

GAS WELL

Actual Prod. Test - MCF/D	Length of Test	Bbla. Condensate/MMCF	Gravity of Condensate
Testing Method (pilot, back pr.)	Tubing Pressure (Shut-in)	Casing Pressure (Shut-in)	Choke Size

VI. OPERATOR CERTIFICATE OF COMPLIANCE

I hereby certify that the rules and regulations of the Oil Conservation Division have been complied with and that the information given above is true and complete to the best of my knowledge and belief.

Signature W.W. Baker Administrative Supr.
Printed Name 5-1-91 Title
Date (405) 948-3120 Telephone No.

OIL CONSERVATION DIVISION

Date Approved MAY 03 1991

By Brian J. Sherry
Title SUPERVISOR DISTRICT #3

INSTRUCTIONS: This form is to be filed in compliance with Rule 1104

- 1) Request for allowable for newly drilled or deepened well must be accompanied by tabulation of deviation tests taken in accordance with Rule 111.
- 2) All sections of this form must be filled out for allowable on new and recompleted wells.
- 3) Fill out only Sections I, II, III, and VI for changes of operator, well name or number, transporter, or other such changes.
- 4) Separate Form C-104 must be filed for each pool in multiply completed wells.