

5-NMOC
1-Redfern
1-Christman
1-File

NEW MEXICO OIL CONSERVATION COMMISSION
Santa Fe, New Mexico

Form G-101
Revised (12/1/55)

NOTICE OF INTENTION TO DRILL

Notice must be given to the District Office of the Oil Conservation Commission and approval obtained before drilling or recompletion begins. If changes in the proposed plan are considered advisable, a copy of this notice showing such changes will be returned to the sender. Submit this notice in QUINTUPLICATE. One copy will be returned following approval. See additional instructions in Rules and Regulations of the Commission. If State Land submit 6 Copies Attach Form G-128 in triplicate to first 3 copies of form G-101

Farmington, New Mexico
(Place)

September 18, 1961
(Date)

OIL CONSERVATION COMMISSION
SANTA FE, NEW MEXICO

Gentlemen:

You are hereby notified that it is our intention to commence the Drilling of a well to be known as

Redfern & Herd, Inc.
(Company or Operator)

Maddox

(Lease)

Well No. 1, in J. The well is

(Unit)

located 2410 feet from the South line and 1750 feet from the

East

line of Section 33, T. 30N, R. 12W, NMPM.

(GIVE LOCATION FROM SECTION LINE) Basin-Dakota Pool, San Juan County

D	C	B	A
E	F	G	H
L	K	X J	I
M	N	O	P

If State Land the Oil and Gas Lease is No.

If patented land the owner is Mr. Hargis

Address Farmington, New Mexico

We propose to drill well with drilling equipment as follows: Rotary Tools

Surface to TD

The status of plugging bond is State Wide

Drilling Contractor Exeter Drilling Co.

We intend to complete this well in the Dakota Formation, T. 3
formation at an approximate depth of 6450 feet.

CASING PROGRAM

We propose to use the following strings of Casing and to cement them as indicated:

Size of Hole	Size of Casing	Weight per Foot	New or Second Hand	Depth	Sacks Cement
12-1/4"	8-5/8"	24#	New	200	140 sx.
7-7/8"	4-1/2"	10.5#	New	6450	300 sx.

If changes in the above plans become advisable we will notify you immediately.

ADDITIONAL INFORMATION (If recompletion give full details of proposed plan of work.)

The 4-1/2" casing will be cemented in two stages with the stage collar set below the Pictured Cliffs formation and the second stage cemented with sufficient cement to protect the Pictured Cliffs. The Dakota formation will be selectively perforated and sand-water fractured.

Approved: 7-10, 1961
Except as follows:

Sincerely yours,

Redfern & Herd, Inc.
(Company or Operator)

By: Original signed by T. A. Dugan

Position: Engineer
Send Communications regarding well to

Name: T. A. Dugan

Address: 1007 N. Dustin, Farmington, N.M.

OIL CONSERVATION COMMISSION

By: [Signature]

NEW MEXICO OIL CONSERVATION COMMISSION
Well Location and Acreage Dedication Plat

Section A.

Date September 25, 1961

Operator REDFERN & HERD Lease MADDOX
Well No. 1 Unit Letter J Section 33 Township 30N Range 12W NMPN:
Located 2410 Feet From south Line, 1750 Feet From east Line
County San Juan G. L. Elevation 5561 Dedicated Acreage 320 Acres
Name of Producing Formation Dakota Pool Basin

1. Is the Operator the only owner* in the dedicated acreage outlined on the plat below?
Yes X No .
2. If the answer to question one is "no," have the interests of all the owners been consolidated by communitization agreement or otherwise? Yes No . If answer is "yes," Type of Consolidation
3. If the answer to question two is "no," list all the owners and their respective interests below:

Owner

Land Description

Section B

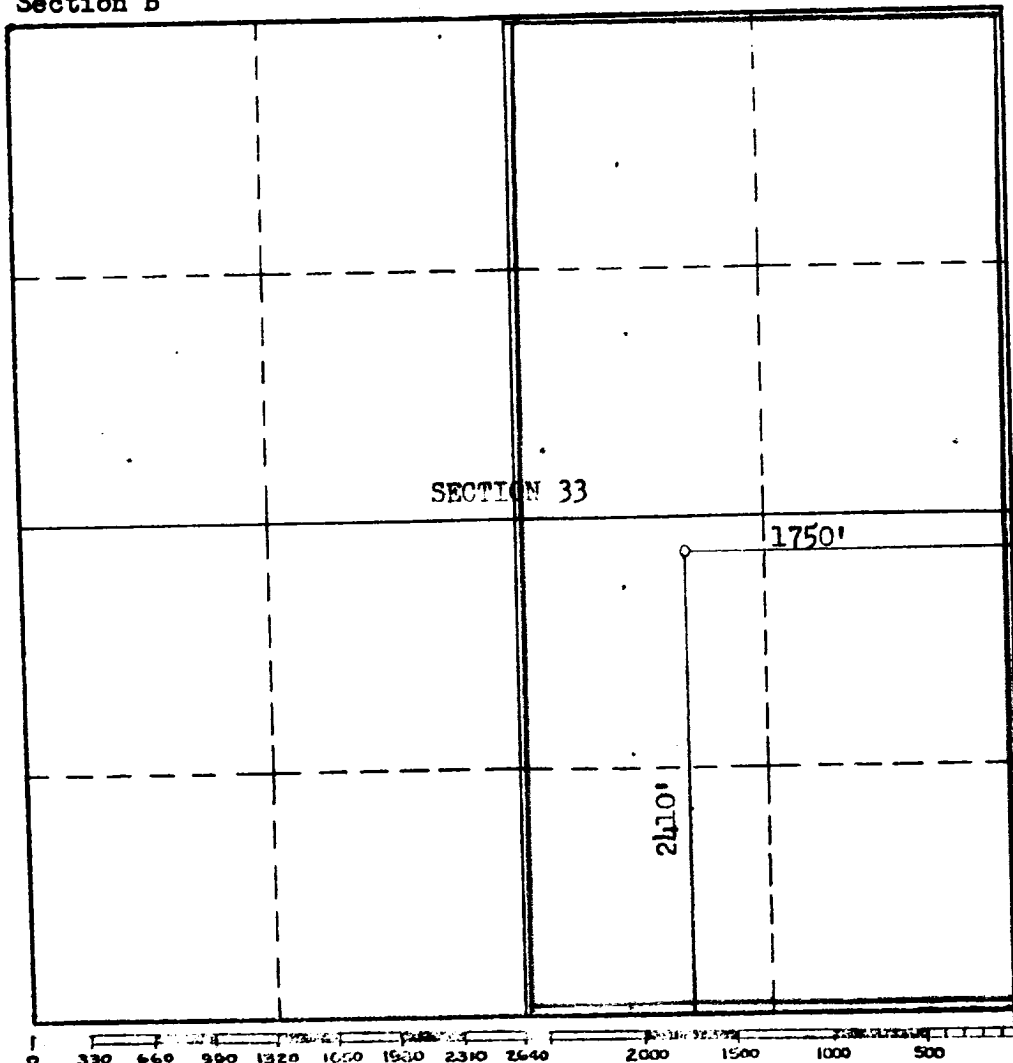

This is to certify that the information in Section A above is true and complete to the best of my knowledge and belief.

Redfern & Herd, Inc.
(Operator)

Original signed by T. A. Dugan,
(Representative)

1007 N. Dustin
Farmington, New Mexico
Address

This is to certify that the well location shown on the plat in Section B was plotted from field notes of actual surveys made by me or under my supervision and that the same is true and correct to the best of my knowledge and belief.

Date Surveyed August 18, 1961

Stephen H. Kinney
STEPHEN H. KINNEY,
Registered Professional
Engineer and/or Land Surveyor.

Certificate No. 803