

(SUBMIT IN TRIPLICATE)

UNITED STATES  
DEPARTMENT OF THE INTERIOR  
GEOLOGICAL SURVEY

Land Office Santa Fe  
Lease No. 078194  
Unit Ludwick

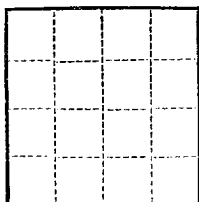

SUNDRY NOTICES AND REPORTS ON WELLS

NOTICE OF INTENTION TO DRILL	<input checked="" type="checkbox"/>	SUBSEQUENT REPORT OF WATER SHUT-OFF	
NOTICE OF INTENTION TO CHANGE PLANS		SUBSEQUENT REPORT OF SHOOTING OR ACIDIZING	
NOTICE OF INTENTION TO TEST WATER SHUT-OFF		SUBSEQUENT REPORT OF ALTERING CASING	
NOTICE OF INTENTION TO RE-DRILL OR REPAIR WELL		SUBSEQUENT REPORT OF RE-DRILLING OR REPAIR	
NOTICE OF INTENTION TO SHOOT OR ACIDIZE		SUBSEQUENT REPORT OF ABANDONMENT	3
NOTICE OF INTENTION TO PULL OR ALTER CASING		SUPPLEMENTARY WELL HISTORY	
NOTICE OF INTENTION TO ABANDON WELL			

(INDICATE ABOVE BY CHECK MARK NATURE OF REPORT, NOTICE, OR OTHER DATA)

May 23, 1956

Well No. 8 is located 1650 ft. from N line and 968 ft. from E line of sec. 31

NE Section 31  
(1/4 Sec. and Sec. No.)

30N  
(Twp.)

10W  
(Range)

NM PM  
(Meridian)

Blanco  
(Field)

San Juan  
(County or Subdivision)

New Mexico  
(State or Territory)

The elevation of the derrick floor above sea level is 6011 ft.

DETAILS OF WORK

(State names of and expected depths to objective sands; show sizes, weights, and lengths of proposed casings; indicate mudding jobs, cementing points, and all other important proposed work)

It is intended to drill a well with rotary tools thru the Mesa Verde formation. Mud circulation will be used thru the Pictured Cliffs and set intermediate casing. Gas circulation will be used thru the Mesa Verde and a liner will be set. Possible productive intervals will be perforated and fractured. Est. T.D. 5112'.

Casing Program:

10 3/4" at 170' with 125 sacks cement circulated to the surface.  
7 5/8" at 4337' with 250 sacks cement.  
5 1/2" at 5112' with 150 sacks cement.

The E/2 of Section 3 is dedicated to this well.  
E/2 SF 078914.

I understand that this plan of work must receive approval in writing by the Geological Survey before operations may be commenced.

Company El Paso Natural Gas Company

Address Box 997

Farmington, New Mexico

By [Signature]  
Title Petroleum Engineer

NEW MEXICO  
OIL CONSERVATION COMMISSION

Form O-275

WELL LOCATION AND/OR GAS PRODUCTION PLAT

DATE APRIL 4, 1956

OPERATOR EL PASO NATURAL GAS COMPANY LAND LUDWICK SF 078194

ACRES 8 SECTION 31 TOWNSHIP 30 N RANGE 10 W NUTCH

LOCALITY 1650 FEET FROM NORTH CORNER 968 FEET FROM EAST CORNER

SAN JUAN COUNTY, NEW MEXICO SECTION 6001

NAME OF LAND SURVEYOR MESA VERDE BLANCO DISTANCE 306.4

Note: All distances must be from center of wellhead or section.

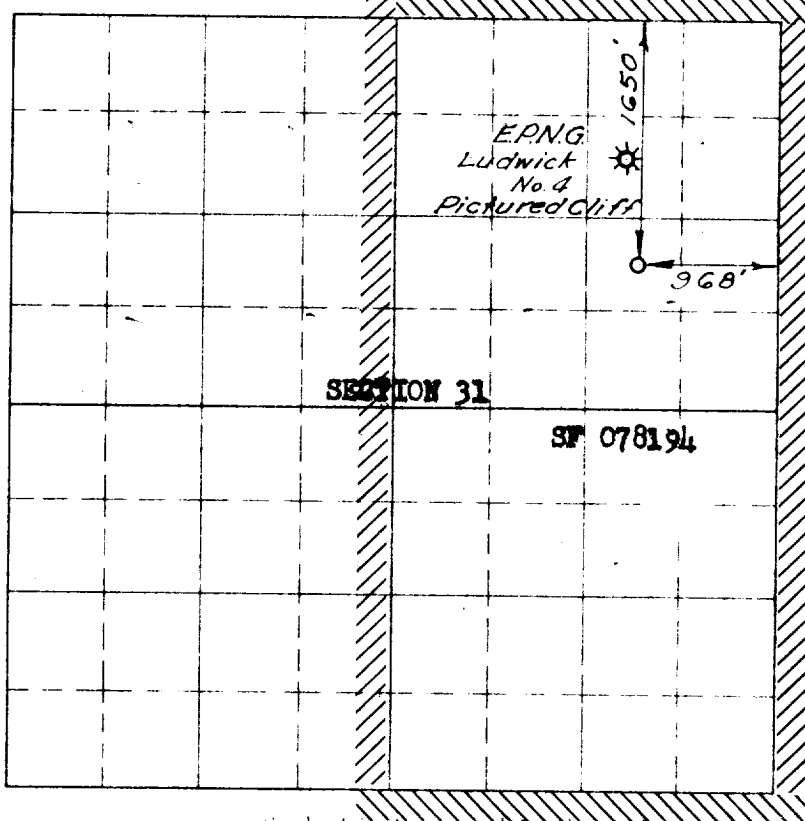

Scale: 1 inch equals 1 mile

NOTE: THIS PLAT IS RE-  
ISSUED TO SHOW CORRECTED  
LEASE NUMBER. 8 24 66

RECEIVED  
MAY 23 1956  
U.S. GEOLOGICAL SURVEY  
FARMINGTON, NEW MEXICO

NOTE

This section of  
form is to be used  
for gas wells only

This is to certify that the above plat was prepared from  
field notes of actual surveys made by me or under my  
supervision and that the same are true and correct to the  
best of my knowledge and belief.

Date Surveyed MARCH 30, 1956

C. O. Walker  
Registered Professional Engineer and/or Land Surveyor

1. Is this well a Dual Comp. ☒

Yes \_\_\_\_\_ No \_\_\_\_\_

2. If the answer to Question 1  
is yes, are there any other dually  
completed wells within the  
dedicated acreage.

Yes \_\_\_\_\_ No \_\_\_\_\_

Name Will Walker  
Petroleum Engineer

Position El Paso Natural Gas Co.

Representing Box 997, Farmington, N.M.

Address \_\_\_\_\_

(Seal)

Farmington, New Mexico