

Well Location and Acreage Dedication Plat

Section A.

Date May 21, 1963

Operator SUNRAY DX OIL COMPANY Lease NEW MEXICO FEDERAL "L"
 Well No. 2 Unit Letter F Section 34 Township 30 NORTH Range 15 WEST NMPM
 Located 2070 Feet From the NORTH Line, 1980 Feet From the WEST Line
 County SAN JUAN G. L. Elevation 5249' Dedicated Acreage 80 Acres
 Name of Producing Formation Lower Gallup Pool Undesignated

1. Is the Operator the only owner in the dedicated acreage outlined on the plat below?
 Yes X No _____
2. If the answer to question one is "no", have the interests of all the owners been consolidated by communitization agreement or otherwise? Yes _____ No _____. If answer is "yes", Type of Consolidation.
3. If the answer to question two is "no", list all the owners and their respective interests below:

OwnerLand Description

Section B.

This is to certify that the information in Section A above is true and complete to the best of my knowledge and belief.

Sunray DX Oil Company

(Operator)

Original signed by

CHARLES W. ROGERS

(Representative)

200 Petroleum Club Plaza

(Address)

Farmington, New Mexico

Note: All distances must be from outer boundaries of section.

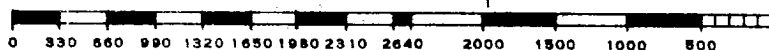
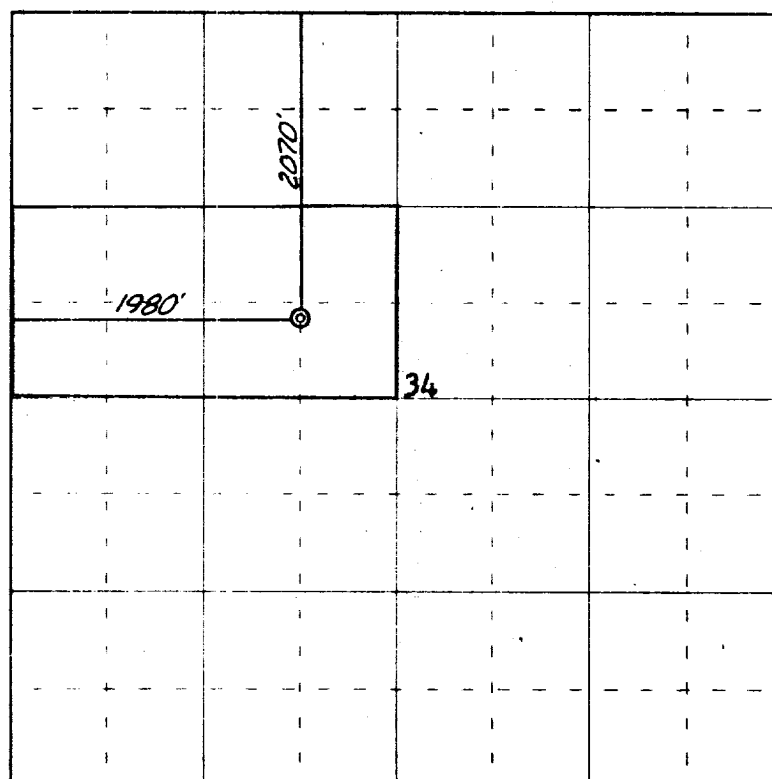

Scale 4 inches equal 1 mile

Ref: GLO plat dated 25 July 1910

This is to certify that the above plat was prepared from field notes of actual surveys made by me or under my supervision and that the same are true and correct to the best of my knowledge and belief.

Date Surveyed 20 May 1963

James P. Leese
 Registered Professional Engineer and/or Land Surveyor
 James P. Leese, N. Mex. Reg. No. 1463
 San Juan Engineering Company

Farmington, New Mexico