

Company Bay Petroleum Corporation

Lease Bassett Well No. 2

Sec. 33 T. 30 N. R. 10 W. N.M.P.M.

Location 3505' North and 1530' West of the SE Corner  
of Section 33-30-10 and being in the NE-SW-NE $\frac{1}{4}$ .

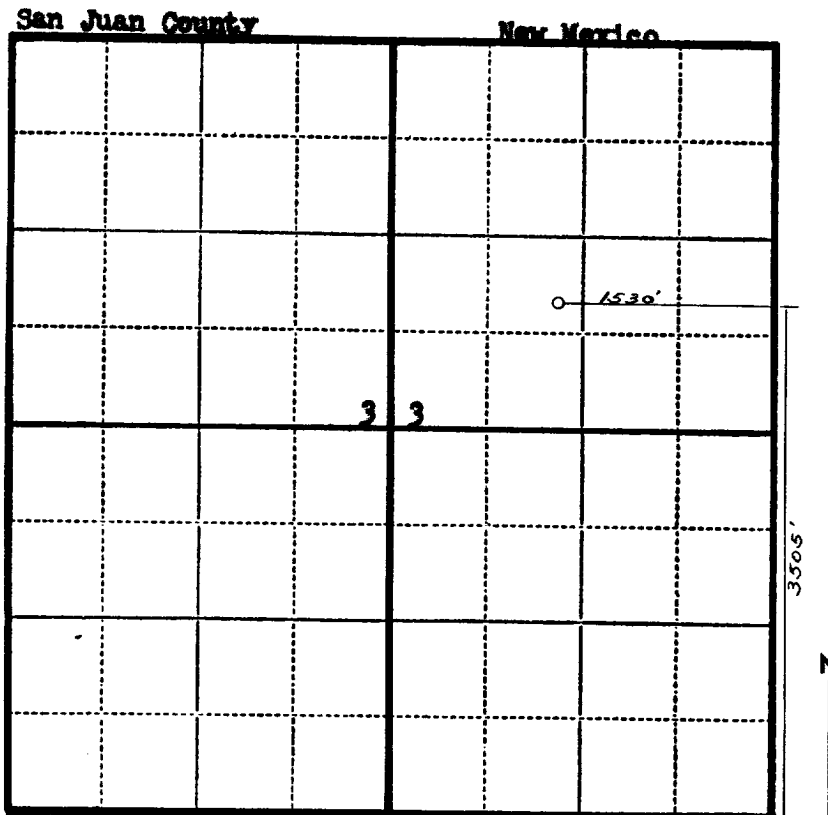

Scale—4 inches equals 1 mile.

This is to certify that the above plat was prepared from field notes of actual surveys made by me or under my supervision and that the same are true and correct to the best of my knowledge and belief.

Seal:

*Charles J. Finklea*  
Registered Professional  
Engineer and Land Surveyor.

Charles J. Finklea  
N. Mex. Reg. No. 1302

Surveyed March 20, 1952

