



LTR



Job separation sheet

Land Office **Santa Fe**
Lease No. **078214**
Unit _____

(SUBMIT IN TRIPLICATE)

UNITED STATES
DEPARTMENT OF THE INTERIOR
GEOLOGICAL SURVEY

30
N

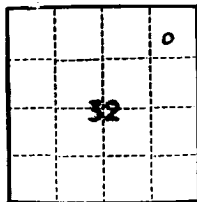

13W

SUNDRY NOTICES AND REPORTS ON WELLS

NOTICE OF INTENTION TO DRILL	XX	SUBSEQUENT REPORT OF WATER SHUT-OFF
NOTICE OF INTENTION TO CHANGE PLANS		SUBSEQUENT REPORT OF SHOOTING OR ACIDIZING
NOTICE OF INTENTION TO TEST WATER SHUT-OFF		SUBSEQUENT REPORT OF ALTERING CASING
NOTICE OF INTENTION TO RE-DRILL OR REPAIR WELL		SUBSEQUENT REPORT OF RE-DRILLING OR REPAIR
NOTICE OF INTENTION TO SHOOT OR ACIDIZE		SUBSEQUENT REPORT OF ABANDONMENT
NOTICE OF INTENTION TO PULL OR ALTER CASING		SUPPLEMENTARY WELL HISTORY
NOTICE OF INTENTION TO ABANDON WELL		

RECEIVED
JAN 10 1963
U. S. GEOLOGICAL SURVEY
FARMINGTON, NEW MEXICO

(INDICATE ABOVE BY CHECK MARK NATURE OF REPORT, NOTICE, OR OTHER DATA)

January 8, 1963

Northwest Farmington

Well No. 1-32 is located 790 ft. from $\left\{ \begin{smallmatrix} N \\ S \end{smallmatrix} \right\}$ line and 790 ft. from $\left\{ \begin{smallmatrix} E \\ W \end{smallmatrix} \right\}$ line of sec. 32

NE NE Section 32

($\frac{1}{4}$ Sec. and Sec. No.)

T30N

(Twp.)

R13W

(Range)

NMPM

(Meridian)

Basin-Dakota

(Field)

San Juan

(County or Subdivision)

New Mexico

(State or Territory)

The elevation of the derrick floor above sea level is _____ ft. 5354 G.L.

DETAILS OF WORK

(State names of and expected depths to objective sands; show sizes, weights, and lengths of proposed casings; indicate mudding jobs, cementing points, and all other important proposed work)

Compass Exploration, Inc. proposes to drill an oil and/or gas test well through the Dakota formation to an approximate total depth of 6100'.

Casing detail as follows:

8-5/8" @ 250' with sufficient cement to circulate.

4-1/2" @ 6100' with sufficient cement for 600' of filling



I understand that this plan of work must receive approval in writing by the Geological Survey before operations may be commenced.

Company **Compass Exploration, Inc.**

Address **101 University Boulevard**

Denver 6, Colorado

By

P. J. Farrelly
Chief Geologist

Title

NEW MEXICO OIL CONSERVATION COMMISSION

Well Location and Acreage Dedication Plat

SECTION A.

Date January 8, 1963

Operator Compass Exploration, Inc. Lease NW Farmington
Well No. 1-32 Unit Letter A Section 32 Township 30 North Range 13 West NMPM
Located 790 Feet From North Line, 790 Feet From East Line
County San Juan G. L. Elevation 5354 Dedicated Acreage 320 Acres
Name of Producing Formation Dakota Pool Basin Dakota

1. Is the Operator the only owner* in the dedicated acreage outlined on the plat below? Yes _____ No X
2. If the answer to question One is "No," have the interests of all the owners been consolidated by communitization agreement or otherwise? Yes X No _____. If answer is "Yes," Type of Consolidation
Communitization in process
3. If the answer to question Two is "No," list all the owners and their respective interests below:

OWNER

LAND DESCRIPTION

SECTION B.

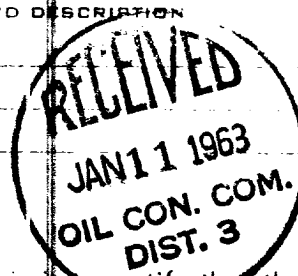
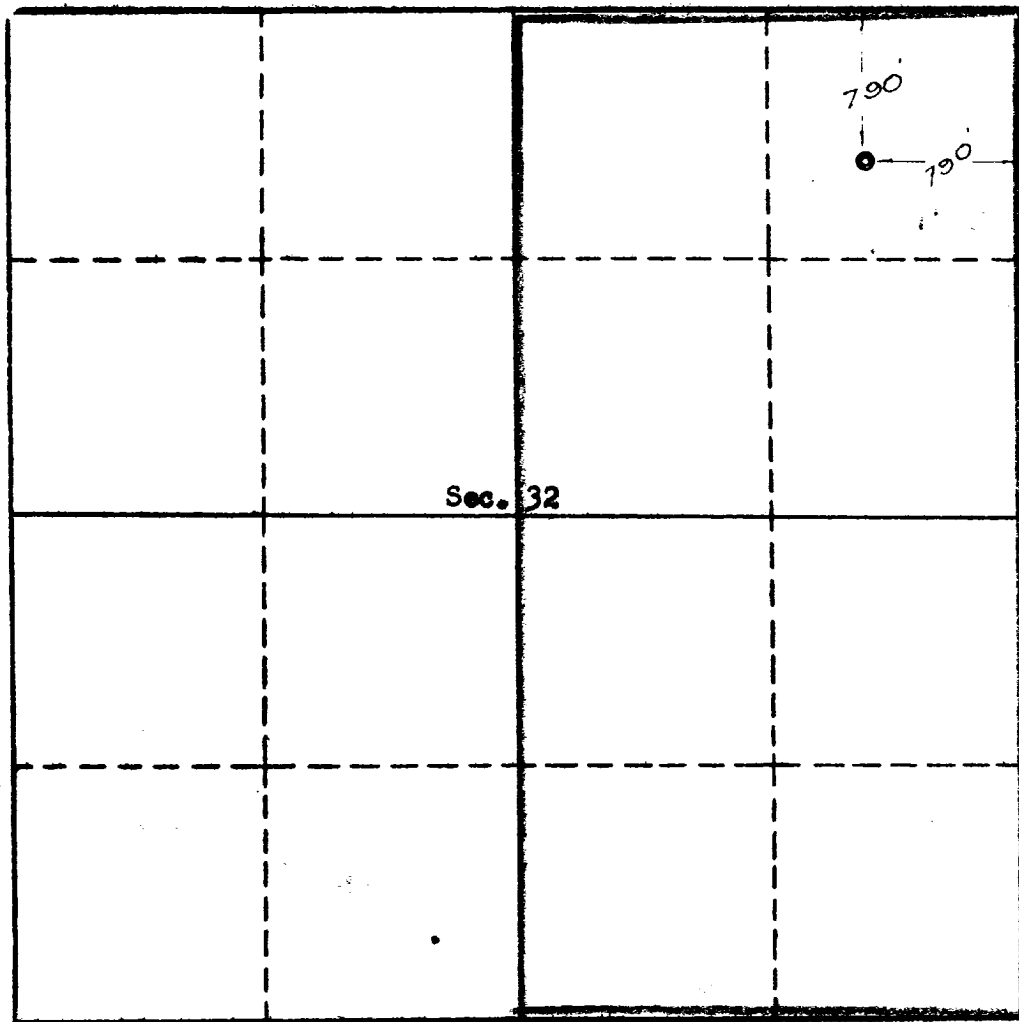

This is to certify that the information in Section A above is true and complete to the best of my knowledge and belief.

COMPASS EXPLORATION, INC.

(OPERATOR)

D. Farrelly

(REPRESENTATIVE)

101 University Boulevard
Denver 6, Colorado

(APPROVER)

This is to certify that the well location shown on the plat in Section B was plotted from field notes of actual surveys made by me or under my supervision and that the same is true and correct to the best of my knowledge and belief.

Date Surveyed Nov. 19, 1962

FARMINGTON, NEW MEXICO

Ernest V. Carlos Law Jr.
REGISTERED ENGINEER OR
LAND SURVEYOR

Certificate No. 3602