

**NEW MEXICO OIL CONSERVATION COMMISSION
WELL LOCATION AND ACREAGE DEDICATION PLAT**

Form C-102
Supersedes C-128
Effective 1-1-65

All distances must be from the outer boundaries of the Section.

Owner McCulloch Oil Corporation of California			Lease Aztec		Well No. 1-X
Section C	Section 35	Township 30 North	Range 14 West	County San Juan	
Section Location of well: 790 feet from the North line and 1850 feet from the West line					
Quantity, Acreage 5557.0	Producing Formation Dakota		Pool Basin Dakota		Dedicated Acreage: 331.47 Acres

1. Outline the acreage dedicated to the subject well by colored pencil or hachure marks on the plat below.
2. If more than one lease is dedicated to the well, outline each and identify the ownership thereof (both as to working interest and royalty).
3. If more than one lease of different ownership is dedicated to the well, have the interests of all owners been consolidated by communitization, unitization, force-pooling, etc?

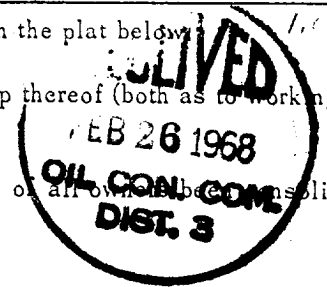

☐ Yes ☐ No If answer is "yes," type of consolidation _____

If answer is "no," list the owners and tract descriptions which have actually been consolidated. (Use reverse side of this form if necessary.) _____

No allowable will be assigned to the well until all interests have been consolidated (by communitization, unitization, forced-pooling, or otherwise) or until a non-standard unit, eliminating such interests, has been approved by the Commission.

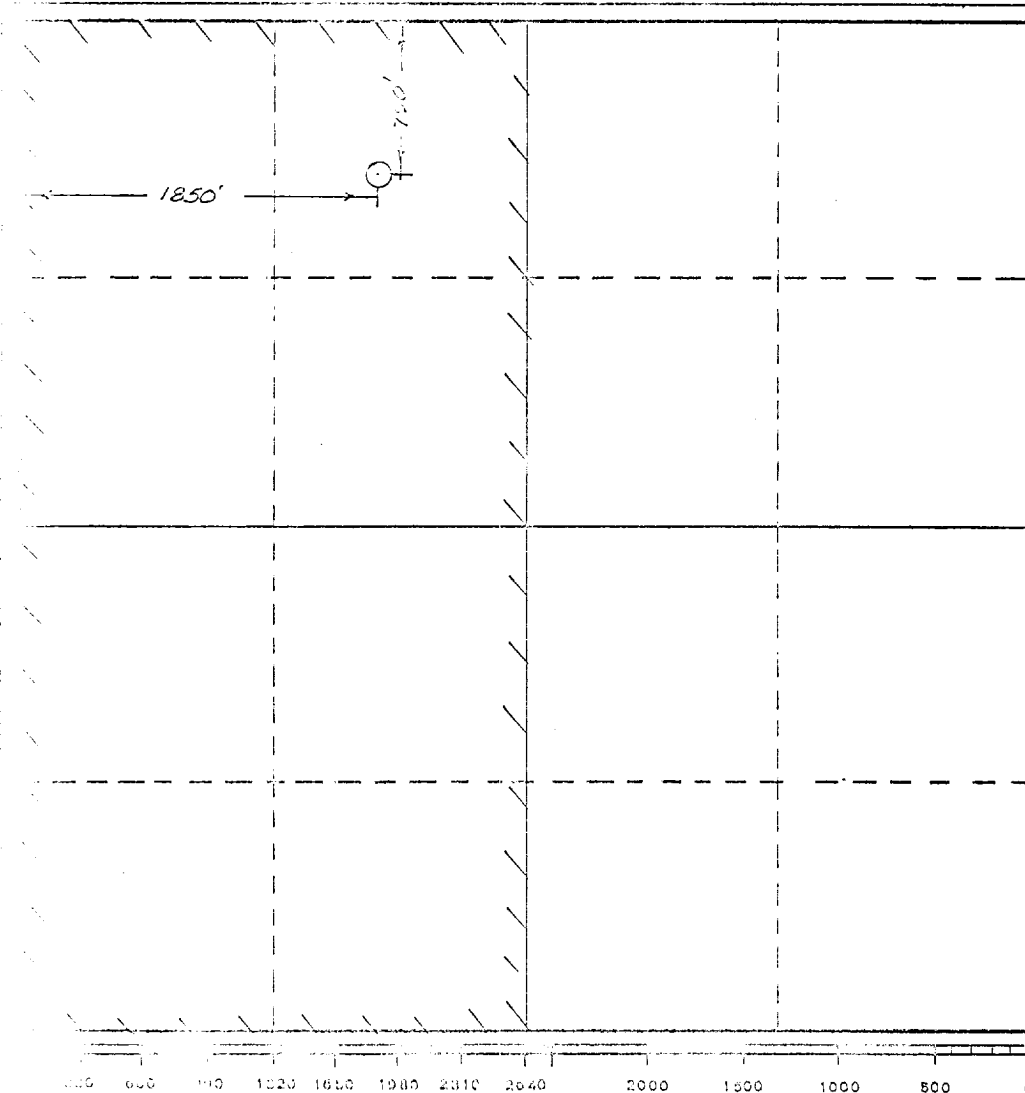

CERTIFICATION	
I hereby certify that the information contained herein is true and complete to the best of my knowledge and belief.	
<i>[Signature]</i>	
Name	
Position	District Engineer
Company	McCulloch Oil Corp. of Calif.
Date	2/19/68
I hereby certify that the well location shown on this plat was plotted from field notes of actual surveys made by me or under my supervision, and that the same is true and correct to the best of my knowledge and belief.	
Date Surveyed	7-16-62
Registered Professional Engineer and/or Land Surveyor	
James P. Leese	
Certificate No.	1463
San Juan Engineering Co.	