

(SUBMIT IN TRIPLICATE)

UNITED STATES
DEPARTMENT OF THE INTERIOR
GEOLOGICAL SURVEY

Land Office Santa Fe
Lease No. SF 078139
Unit Elliott Gas Unit K

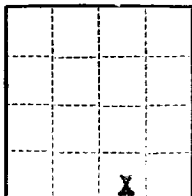

SUNDRY NOTICES AND REPORTS ON WELLS

NOTICE OF INTENTION TO DRILL.....	<input checked="" type="checkbox"/>	SUBSEQUENT REPORT OF WATER SHUT-OFF.....	
NOTICE OF INTENTION TO CHANGE PLANS.....		SUBSEQUENT REPORT OF SHOOTING OR ACIDIZING.....	
NOTICE OF INTENTION TO TEST WATER SHUT-OFF.....		SUBSEQUENT REPORT OF ALTERING CASING.....	
NOTICE OF INTENTION TO RE-DRILL OR REPAIR WELL.....		SUBSEQUENT REPORT OF RE-DRILLING OR REPAIR.....	
NOTICE OF INTENTION TO SHOOT OR ACIDIZE.....		SUBSEQUENT REPORT OF ABANDONMENT.....	
NOTICE OF INTENTION TO PULL OR ALTER CASING.....		SUPPLEMENTARY WELL HISTORY.....	
NOTICE OF INTENTION TO ABANDON WELL.....			

(INDICATE ABOVE BY CHECK MARK NATURE OF REPORT, NOTICE, OR OTHER DATA)

Elliott Gas Unit "K" Farmington, New Mexico April 22, 1960

Well No. 1 is located 1190 ft. from N line and 1675 ft. from E line of sec. 26

SW/4 SE/4 of Section 26 T-30-N R-9-W N.M.P.M.
(1/4 Sec. and Sec. No.) (Twp.) (Range) (Meridian)

Blanco Pictured Cliffs San Juan New Mexico
(Field) (County or Subdivision) (State or Territory)

The elevation of the derrick floor above sea level is _____ ft. (To be reported later)

DETAILS OF WORK

(State names of and expected depths to objective sands; show sizes, weights, and lengths of proposed casings; indicate mudding jobs, cementing points, and all other important proposed work)

We propose to drill Elliott Gas Unit "K" No. 1 with rotary tools to an approximate total depth of 2700' and complete in the Pictured Cliffs formation. Stimulation will be as indicated on reaching total depth. Proposed casing program as follows:

SIZE	DEPTH	CEMENT	REMARKS
8-5/8"	200'	160 sacks	Circulate
4-1/2"	2700'	--	Circulate to surface if possible.

Copies of location attached. Logs will be furnished on completion of well.

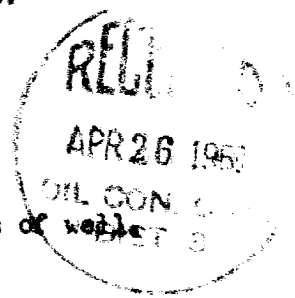

I understand that this plan of work must receive approval in writing by the Geological Survey before operations may be commenced.

Company Pan American Petroleum Corporation

Address P.O. Box 487

Farmington, New Mexico

Attn: L. O. Speer, Jr.

ORIGINAL SIGNED BY
R. M. Bauer, Jr.

By _____

Title Area Engineer

NEW MEXICO OIL CONSERVATION COMMISSION

Well Location and Acreage Dedication Plat

Section A.

Date **OCTOBER 23, 1959**

Operator **PAN AMERICAN PETROLEUM CORPORATION**
 Well No. **1** Unit Letter **0** Section **26**
 Located **1190** Feet From **the SOUTH** Line
 County **SAN JUAN** G. L. Elevation *****
 Name of Producing Formation **PICTURED CLIFFS**

ELLIOTT GAS UNIT "K"

Township **30 NORTH** Range **9 WEST**, NMPM
 Feet From **the EAST** Line
 Dedicated Acreage **160** Acres
 Pool **BLANCO PICTURED CLIFFS**

1. Is the Operator the only owner in the dedicated acreage outlined on the plat below?
 Yes _____ No **X** ***To be reported later**
2. If the answer to question one is "no", have the interests of all the owners been consolidated by communitization agreement or otherwise? Yes **X** No _____ If answer is "yes", Type of Consolidation:
COMMUNITIZATION
3. If the answer to question two is "no", list all the owners and their respective interests below:

Owner

Land Description

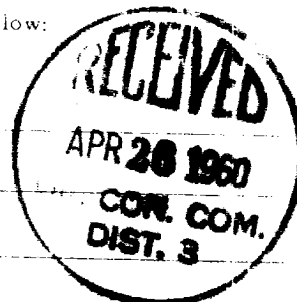

Section B.

This is to certify that the information in Section A above is true and complete to the best of my knowledge and belief.

PAN AMERICAN PETROLEUM CORPORATION
 (Operator)
R. M. BAUER, JR. *R. M. Bauer, Jr.*
 (Representative)
BOX 487, FARMINGTON, NEW MEXICO
 (Address)

Ref: GLO plat dated 2 July 1952

Note: All distances must be from outer boundaries of section.

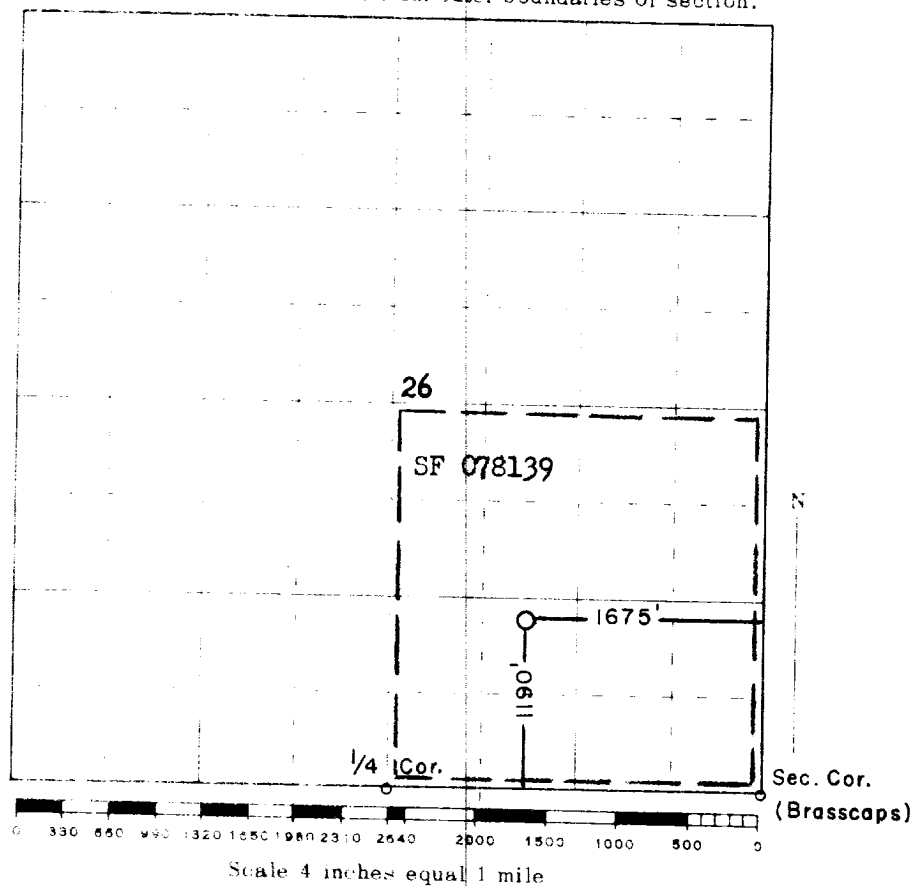

This is to certify that the above plat was prepared from field notes of actual surveys made by me or under my supervision and that the same are true and correct to the best of my knowledge and belief.

Date Surveyed **24 September 1959**

James P. Lersse
 Registered Professional Engineer and/or Land Surveyor
JAMES P. LERSE N. M. REG. No. 1463

Farmington, New Mexico

