

NEW MEXICO OIL CONSERVATION COMMISSION
Santa Fe, New Mexico

Form C-101
Revised (12/1/55)

NOTICE OF INTENTION TO DRILL

Notice must be given to the District Office of the Oil Conservation Commission and approval obtained before drilling or recompletion begins. If changes in the proposed plan are considered advisable, a copy of this notice showing such changes will be returned to the sender. Submit this notice in QUINTUPLICATE. One copy will be returned following approval. See additional instructions in Rules and Regulations of the Commission. If State Land submit 6 Copies Attach Form C- 128 in triplicate to first 3 copies of form C-101

Farmington, New Mexico

December 20, 1962

OIL CONSERVATION COMMISSION
SANTA FE, NEW MEXICO

Gentlemen:

You are hereby notified that it is our intention to commence the Drilling of a well to be known as

Pan American Petroleum Corporation (Company or Operator)

Rowland Gas Unit (Lease)

Well No. 1, in (Unit) The well is

located 1030 feet from the South line and 990 910 feet from the

East line of Section 25, T. 30-N, R. 12-W, NMPM. (GIVE LOCATION FROM SECTION LINE)

Basin Dakota

San Juan

County

If State Land the Oil and Gas Lease is No.

If patented land the owner is W. R. Rowland

Address 1503 Third Avenue, Durango, Colorado

We propose to drill well with drilling equipment as follows: Rotary Tools to total depth.

The status of plugging bond is Statewide

Drilling Contractor Brannon and Murray Drilling Company

P. O. Box 672

Solomon, Texas

We intend to complete this well in the Dakota

formation at an approximate depth of 6600 feet.

CASING PROGRAM

We propose to use the following strings of Casing and to cement them as indicated:

Size of Hole	Size of Casing	Weight per Foot	New or Second Hand	Depth	Backs Cement
12-1/4"	8-5/8"	24#	New	350'	300
7-7/8"	4-1/2"	10.5#	New	6600'	1150*

If changes in the above plans become advisable we will notify you immediately.

ADDITIONAL INFORMATION (If recompletion give full details of proposed plan of work.)

Above well to be drilled to test the Dakota Formation. Stimulation will be as indicated upon reaching total depth. Copies of Location Plat are attached. Copies of any logs run will be submitted upon completion of well.

*Oil string to be cemented by 2 Stage method with stage tool set at 100' below base of Pictured

Approved 12-21, 1962
Except as follows:

Sincerely yours,

(SEE REVERSE)

PAN AMERICAN PETROLEUM CORPORATION
(Company or Operator)

By F. H. Thompson

Position Petroleum Engineer

Send Communications regarding well to

Name L. O. Speer, Jr.

Address Box 480, Farmington, New Mexico

OIL CONSERVATION COMMISSION

By Emergency Clerk

CITIZ. First Stage cement job to fill 500' above base of Mesaverde
Formation.

Verbal permission received Kendrick to Glover December 20, 1962.

NEW MEXICO OIL CONSERVATION COMMISSION

Well Location and Acreage Dedication Plat

Section A.

Date December 20, 1962

Operator PAN AMERICAN PETROLEUM CORPORATION Lease ROWLAND GAS UNIT
 Well No. 1 Unit Letter P Section 25 Township 30 NORTH Range 12 WEST NMPM
 Located 1030 Feet From the SOUTH Line, 910 Feet From the EAST Line
 County SAN JUAN G. L. Elevation To report later Dedicated Acreage 320 Acres
 Name of Producing Formation Dakota Pool Basin Dakota

1. Is the Operator the only owner in the dedicated acreage outlined on the plat below?
 Yes _____ No X
2. If the answer to question one is "no", have the interests of all the owners been consolidated by communitization agreement or otherwise? Yes _____ No X. If answer is "yes", Type of Consolidation. See below
3. If the answer to question two is "no", list all the owners and their respective interests below:

Note: Pan American Petroleum Corporation holds the leases on N/2 SW/4 & NW/4 SE/4, S/2 SE/4 & NE/4 SE/4 and an undivided three-quarters interest in S/2 SW/4. Texas Eastern Transmission Corporation holds the remaining undivided one-quarter interest in S/2 SW/4. Well is being drilled on lease basis pending Texas Eastern Transmission's approval of declaration of unitization and operating agreement.
Well was filed March 19, 1962 as Riecke Gas Unit No. 1 in SW/4 of Section 25, but location and well name is being changed by this form.

Section B.

Note: All distances must be from outer boundaries of section.

This is to certify that the information in Section A above is true and complete to the best of my knowledge and belief.

Pan American Petroleum Corporation
 (Operator) F. H. Hollingsworth
 (Representative)
Box 480, Farmington, New Mexico
 (Address)

Ref: GLO plat dated 7 April 1881

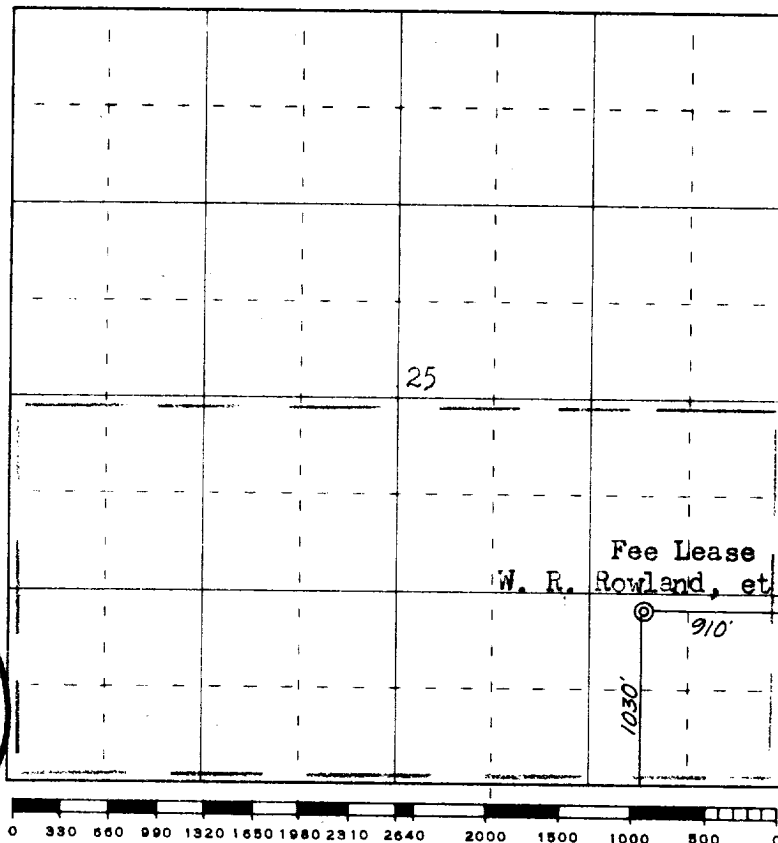

Scale 4 inches equal 1 mile

This is to certify that the above plat was prepared from field notes of actual surveys made by me or under my supervision and that the same are true and correct to the best of my knowledge and belief.

Date Surveyed 14 December 1962

James P. Leese
 Registered Professional Engineer and/or Land Surveyor
 James P. Leese, N. Mex. Reg. 1463
 San Juan Engineering Company

Farmington, New Mexico

~~5~~
53-4 ✓
2.12-2
1100-2
per 1