

(SUBMIT IN TRIPLICATE)

UNITED STATES
DEPARTMENT OF THE INTERIOR
GEOLOGICAL SURVEY

Land Office New Mexico
Lease No. 03566
Unit Stewart

SUNDRY NOTICES AND REPORTS ON WELLS

NOTICE OF INTENTION TO DRILL	<input checked="" type="checkbox"/>	SUBSEQUENT REPORT OF WATER SHUT-OFF	<div style="text-align: center;"> RECEIVED JUN 1 1961 U. S. GEOLOGICAL SURVEY FARMINGTON, NEW MEXICO </div>
NOTICE OF INTENTION TO CHANGE PLANS		SUBSEQUENT REPORT OF SHOOTING OR ACIDIZING	
NOTICE OF INTENTION TO TEST WATER SHUT-OFF		SUBSEQUENT REPORT OF ALTERING CASING	
NOTICE OF INTENTION TO RE-DRILL OR REPAIR WELL		SUBSEQUENT REPORT OF RE-DRILLING OR REPAIR	
NOTICE OF INTENTION TO SHOOT OR ACIDIZE		SUBSEQUENT REPORT OF ABANDONMENT	
NOTICE OF INTENTION TO PULL OR ALTER CASING		SUPPLEMENTARY WELL HISTORY	
NOTICE OF INTENTION TO ABANDON WELL			

(INDICATE ABOVE BY CHECK MARK NATURE OF REPORT, NOTICE, OR OTHER DATA)

June 13, 1961

Well No. 6 is located 1060 ft. from S line and 1650 ft. from W line of sec. 28

SW/4 Sec. 28
(1/4 Sec. and Sec. No.)

30N,
(Twp.)

10E
(Range)

N.M.P.M.
(Meridian)

Basin Dakota
(Field)

San Juan
(County or Subdivision)

New Mexico
(State or Territory)

The elevation of the derrick floor above sea level is 6205 ft.

DETAILS OF WORK

(State names of and expected depths to objective sands; show sizes, weights, and lengths of proposed casings; indicate mudding jobs, cementing points, and all other important proposed work)

It is intended to drill a well thru the Dakota formation using rotary tools & to perforate and fracture possible producing zones. Est. T. D. 7390'.

Casing Program:

- 9 5/8" casing at 280' with 300 sbs. cement circulated to surface.
- 4 1/2" casing at 7390' with two stage tool set at 5226' & three stage tool at 2868'.
- First Stage with 290 sacks - 150% to cover 100' above Gallup top.
- Second Stage with 200 sacks - 150% to cover 100' above Cliff House top.
- Three Stage tool with 300 sacks - 150% to cover Ojo Alamo.

The W/2 of Section 28 is dedicated to this well.

I understand that this plan of work must receive approval in writing by the Geological Survey before operations may be commenced.

Company El Paso Natural Gas Company

Address Box 990

Farmington, New Mexico

By Original Signed D.W. Meehan
Title Petroleum Engineer

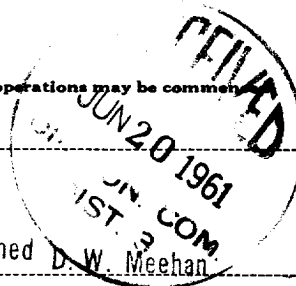

NEW MEXICO OIL CONSERVATION COMMISSION

Well Location and Acreage Dedication Plat

Section A.

Date **JUNE 7, 1961**

Operator **EL PASO NATURAL GAS COMPANY** Lease **STEWART** NM **03566**
 Well No. **8** Unit Letter **N** Section **28** Township **30-N** Range **10-W** NMPM
 Located **1060** Feet From **SOUTH** Line, **1650** Feet From **WEST** Line
 County **SAN JUAN** G. L. Location **6195** Dedicated Acreage **320** Acres
 Name of Producing Formation **DAKOTA** Pool **BASIN DAKOTA**

1. Is the Operator the only owner in the dedicated acreage outlined on the plat below?

Yes ☒ No ☐2. If the answer to question one is "no", have the interests of all the owners been consolidated by communitization agreement or otherwise? Yes ☐ No ☐ If answer is "yes", Type of Consolidation

3. If the answer to question two is "no", list all the owners and their respective interests below:

Owner

Land Description



Section B.

This is to certify that the information in Section A above is true and complete to the best of my knowledge and belief.

~~El Paso Natural Gas Company~~
 (Operator)

Original Signed **D. W. Meehan**
 (Representative)

~~Box 900~~

(Address)

~~Farmington, New Mexico~~

Note: All distances must be from outer boundaries of section.

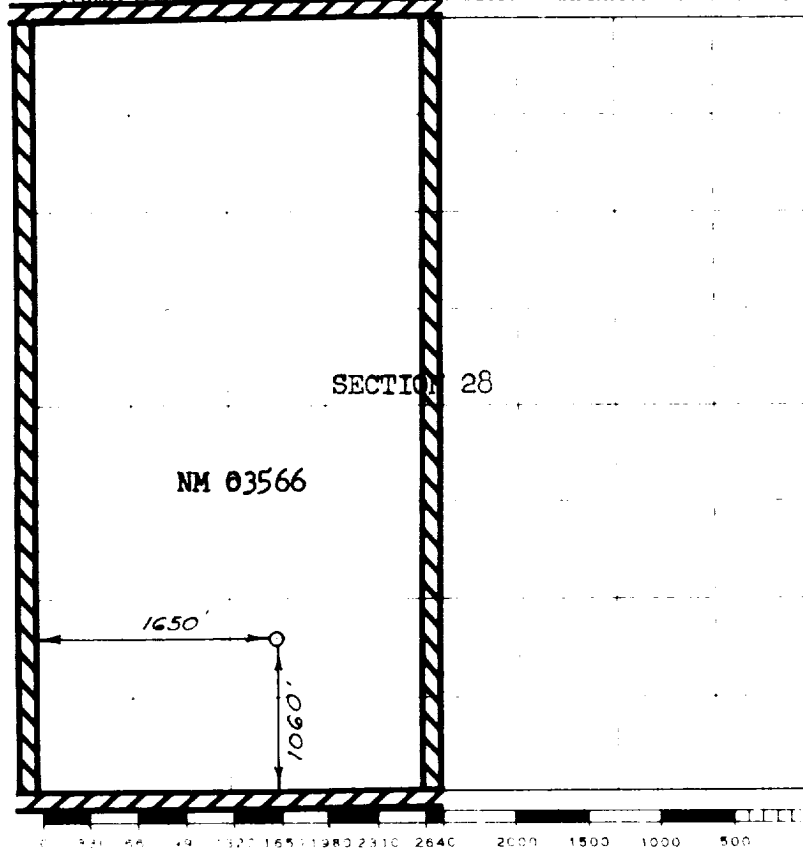

Scale 1 inch equal 1 mile

This is to certify that the above plat was prepared from field notes of actual surveys made by me or under my supervision and that the same are true and correct to the best of my knowledge and belief.

(Seal)

Date Surveyed **JUNE 6, 1961**

David O. Nielsen
 Registered Professional Engineer and/or Land Surveyor

Farmington, New Mexico