

STATE OF NEW MEXICO
OIL CONSERVATION
COMMISSION

DISTRICT NO. 3
Phone 99 P. O. Box 697
AZTEC, NEW MEXICO

(SUBMIT IN TRIPLICATE)

UNITED STATES
DEPARTMENT OF THE INTERIOR
GEOLOGICAL SURVEY

Land Office Santa Fe
Lease No. 0326
Unit _____

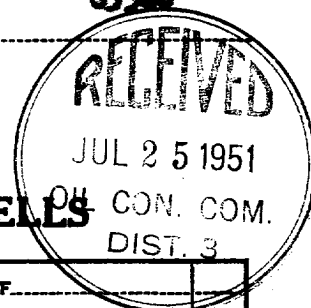

SUNDRY NOTICES AND REPORTS ON WELLS

NOTICE OF INTENTION TO DRILL.....	<input checked="" type="checkbox"/>	SUBSEQUENT REPORT OF WATER SHUT-OFF.....	
NOTICE OF INTENTION TO CHANGE PLANS.....		SUBSEQUENT REPORT OF SHOOTING OR ACIDIZING.....	
NOTICE OF INTENTION TO TEST WATER SHUT-OFF.....		SUBSEQUENT REPORT OF ALTERING CASING.....	
NOTICE OF INTENTION TO RE-DRILL OR REPAIR WELL.....		SUBSEQUENT REPORT OF REDRILLING OR REPAIR.....	
NOTICE OF INTENTION TO SHOOT OR ACIDIZE.....		SUBSEQUENT REPORT OF ABANDONMENT.....	
NOTICE OF INTENTION TO PULL OR ALTER CASING.....		SUPPLEMENTARY WELL HISTORY.....	
NOTICE OF INTENTION TO ABANDON WELL.....			

(INDICATE ABOVE BY CHECK MARK NATURE OF REPORT, NOTICE, OR OTHER DATA)

Well No. Ed G. Stewart is located 1650 ft. from [N] line and 1650 ft. from [E] line of sec. 28
1

S. 4 E. 1/4 Sec. 28

(T. 30N R. 10E)

E. 1/4 Sec. 28

Blanco La Plata

San Juan (County or Subdivision)

New Mexico (State or Territory)

The elevation of the derrick floor above sea level is _____ ft. will be furnished later

DETAILS OF WORK

(State names of and expected depths to objective sands; show sizes, weights, and lengths of proposed casings; indicate mudding jobs, cementing points, and all other important proposed work)

We propose to drill w/cable tools to top of Pictured Cliffs formation, approx. 2600', set production string of casing, drill in w/cable tools and shoot with S.N.G. for gas completion in the Pictured Cliffs.

Proposed Casing Program:

250' - 9 5/8" - Cemented to surface
2600' - 5 1/2" - Cemented with 200 sacks
2700' - 2" Syphon Line

I understand that this plan of work must receive approval in writing by the Geological Survey before operations may be commenced.

Company Delhi Oil Corporation

Address Box 1175

Farmington, New Mexico

By J. B. Howell

Title J. B. Howell
Superintendent

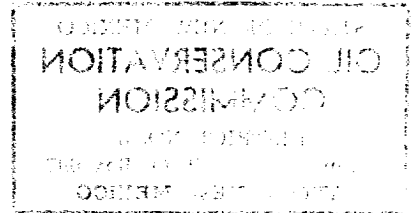

DEPARTMENT OF THE INTERIOR
GEOLOGICAL SURVEY
UNITED STATES
(SUBMIT IN TRIPlicate)

Land Office
Lease No.
Unit

SUNDRY NOTICES AND REPORTS ON WELLS

NOTICE OF INTENTION TO ABANDON WELL		
NOTICE OF INTENTION TO FILL OR ALTER CASING		
NOTICE OF INTENTION TO SHOOT OR ACIDIZE		
NOTICE OF INTENTION TO REPAIR WELL		
NOTICE OF INTENTION TO TEST WATER SHUT-OFF		
NOTICE OF INTENTION TO CHANGE PLANS		
SUBSEQUENT REPORT OF WATER SHUT-OFF		
SUBSEQUENT REPORT OF SHOOTING OR ACIDIZING		
SUBSEQUENT REPORT OF ALTERING CASING		
SUBSEQUENT REPORT OF REPAIRING OR REPAIR		
SUBSEQUENT REPORT OF ABANDONMENT		
SUPPLEMENTARY WELL HISTORY		

(INDICATE ABOVE BY CHECK MARK NATURE OF REPORT, NOTICE, OR OTHER DATA)

_____ is located _____ ft. from _____ line and _____ ft. from _____ line of sec. _____
_____ (Sec. and Range No.) _____ (Twp.) _____ (Range) _____ (Meridian)
_____ (State or Territory) _____ (County or Subdivision) _____ (State or Territory)

The elevation of the derrick floor above sea level is _____ ft.

DETAILS OF WORK

(Give names of and expected depths to objectives; show, where weights, and lengths of proposed work; indicate mudlogging jobs, cementing points, and all other important proposed work)

I understand that this plan of work must receive approval in writing by the Geological Survey before operations may be commenced.

By _____ Title _____
Address _____
Company _____

Santa Fe 03466

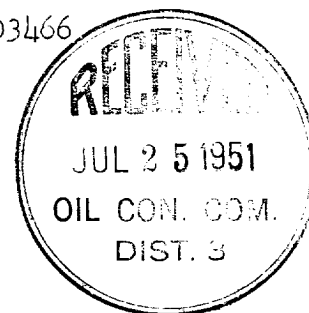

Company Delhi Oil Corporation

Lease E. & Stewart Well No. 1

Sec. 28 T. 30 N., R. 10 W., N.M.P.M.

Location 1650' from the South line and 1650'
from the West line.

San Juan County

New Mexico

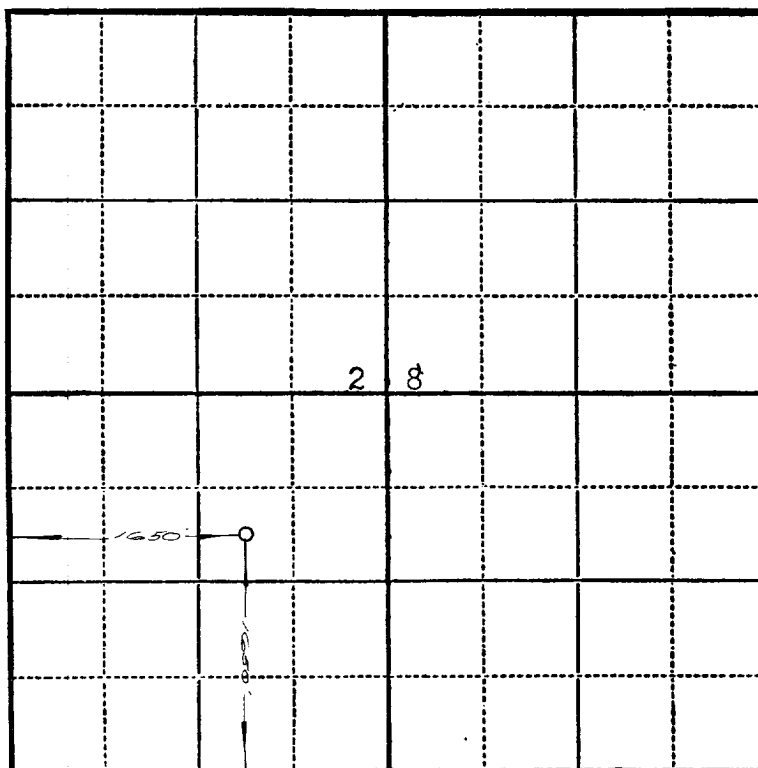

Scale—4 inches equals 1 mile.

This is to certify that the above plat was prepared from field notes of actual surveys made by me or under my supervision and that the same are true and correct to the best of my knowledge and belief.

Charles J. Finklea

Seal:

Registered Professional
Engineer and Land Surveyor.

Charles J. Finklea
N. Mex. Reg. No. 1302

Farmington, New Mexico

Surveyed July 19, 19 51