

NUMBER OF COPIES RECEIVED	
DISTRIBUTION	
SANTA FE	
FILE	
U.S.C.S.	
LAND OFFICE	
TRANSPORTER	OIL GAS
PROBATION OFFICE	
OPERATOR	

NEW MEXICO OIL CONSERVATION COMMISSION
Santa Fe, New Mexico

Form G-101
 Revised (12/1/55)

NOTICE OF INTENTION TO DRILL

Notice must be given to the District Office of the Oil Conservation Commission and approval obtained before drilling or recompletion begins. If changes in the proposed plan are considered advisable, a copy of this notice showing such changes will be returned to the sender. Submit this notice in **QUINTUPLICATE**. One copy will be returned following approval. See additional instructions in Rules and Regulations of the Commission. **If State Land submit 6 Copies Attach Form G-128 in triplicate to first 3 copies of form G-101**

Farlington, New Mexico

October 6, 1961

(Place)

(Date)

OIL CONSERVATION COMMISSION
 SANTA FE, NEW MEXICO

Gentlemen:

You are hereby notified that it is our intention to commence the Drilling of a well to be known as

Redfern & Herd, Inc.

(Company or Operator)

Johnston

(Lease)

, Well No. 1, in 1 (Unit) The well is

located 1750 feet from the South line and 790 feet from the East line of Section 28, T. 30N, R. 12W, NMPM.

(GIVE LOCATION FROM SECTION LINE)

Pool, _____ County

If State Land the Oil and Gas Lease is No. _____

If patented land the owner is W.B. Gamin

Address 2523 Granada Ave., San Diego, Calif.

We propose to drill well with drilling equipment as follows: Rotary Tools
surface to T.D.

The status of plugging bond is State Wide

Drilling Contractor Redfern Drilling Company

We intend to complete this well in the Dakota Formation formation at an approximate depth of 6250 feet.

CASING PROGRAM

We propose to use the following strings of Casing and to cement them as indicated:

Size of Hole	Size of Casing	Weight per Foot	New or Second Hand	Depth	Sacks Cement
<u>13 5/8</u>	<u>9 5/8"</u>	<u>32.50#</u>	<u>New</u>	<u>250'</u>	<u>150 sck</u>
<u>8 3/4</u>	<u>4 1/2"</u>	<u>10.5#</u>	<u>New</u>	<u>6250</u>	<u>400 sck</u>

If changes in the above plans become advisable we will notify you immediately.

ADDITIONAL INFORMATION (If recompletion give full details of proposed plan of work.)

This well will test the Dakota Formation @ an approx. depth of 6250' 4 1/2" csg. will be run and cemented in two stages. The first stage w/ sufficient cement to cover the Gallup formation and a stage collar set below the Cliffhouse and the second stage cemented w/ sufficient cement to cover the Pictured Cliffs formation. The well will then be selectively

Sincerely yours, (over)

Approved 10-9, 1961
 Except as follows:

Redfern & Herd, Inc.
 (Company or Operator)

By Original signed by T. A. Dugan

Position Engineer
 Send Communications regarding well to

Name T. A. Dugan

Address 1007 N. Durkin, Farlington, New Mex.

OIL CONSERVATION COMMISSION

By Ernest C. [Signature]

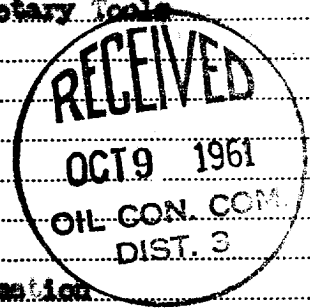

perforated in the Dakota formation and sand water fraced.

NEW MEXICO OIL CONSERVATION COMMISSION
Well Location and Acreage Dedication Plat

Section A.

Date 10-6-61

Operator REDFERN & HERD Lease Johnston
Well No. 1 Unit Letter I Section 28 Township 30N Range 12W NMPM
Located 1750 Feet From south Line, 790 Feet From east Line
County San Juan G. L. Elevation 5450 Dedicated Acreage 120 Acres
Name of Producing Formation Dakota Pool Basin

1. Is the Operator the only owner* in the dedicated acreage outlined on the plat below?
Yes No .
2. If the answer to question one is "no," have the interests of all the owners been consolidated by communitization agreement or otherwise? Yes No . If answer is "yes," Type of Consolidation _____
3. If the answer to question two is "no," list all the owners and their respective interests below:

<u>Owner</u>	<u>Land Description</u>



Section B

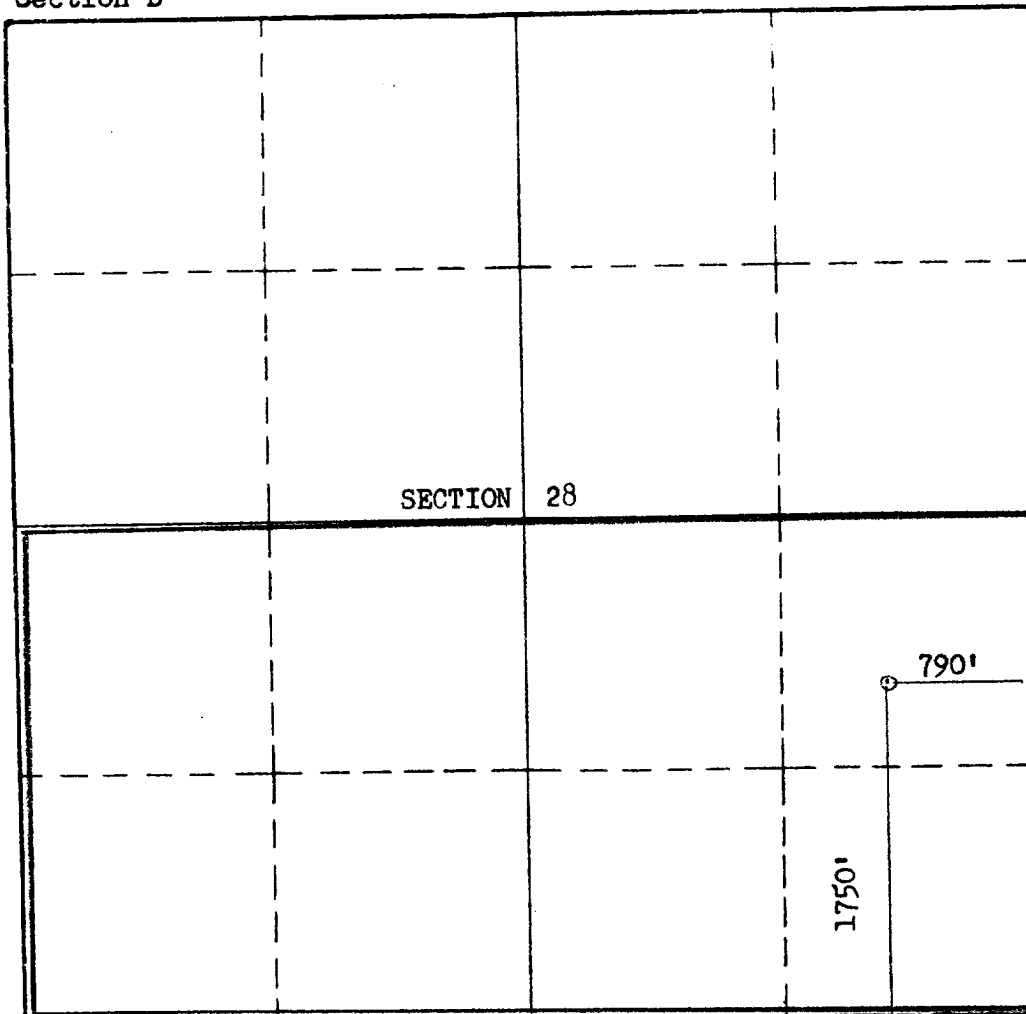

This is to certify that the information in Section A above is true and complete to the best of my knowledge and belief.

Redfern & Herd, Inc.
(Operator)

Original signed by T. A. Dugan
(Representative)

1007 North Dustin
Farmington, New Mexico
Address

This is to certify that the well location shown on the plat in Section B was plotted from field notes of actual surveys made by me or under my supervision and that the same is true and correct to the best of my knowledge and belief.

Date Surveyed October 2, 1961

Stephen H. Kinney
STEPHEN H. KINNEY
Registered Professional
Engineer and/or Land Surveyor.

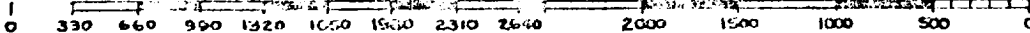

Certificate No. 805