

ILLEGIBLE

(SUBMIT IN TRIPLICATE)

UNITED STATES
DEPARTMENT OF THE INTERIOR
GEOLOGICAL SURVEY

Budget Bureau No. 42-R358.4
Approval expires 6-31-60

Land Office Santa Fe

Lease No. ST-072137 A

Unit 1

Co. Loc. No. 25-03-197-07

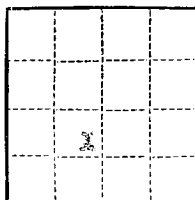

See Attached Plat & C-120

SUNDRY NOTICES AND REPORTS ON WELLS

NOTICE OF INTENTION TO DRILL	<input checked="" type="checkbox"/>	SUBSEQUENT REPORT OF WATER SHUT-OFF	
NOTICE OF INTENTION TO CHANGE PLANS		SUBSEQUENT REPORT OF SHOOTING OR ACIDIZING	
NOTICE OF INTENTION TO TEST WATER SHUT-OFF		SUBSEQUENT REPORT OF ALTERING CASING	
NOTICE OF INTENTION TO RE-DRILL OR REPAIR WELL		SUBSEQUENT REPORT OF RE-DRILLING OR REPAIR	
NOTICE OF INTENTION TO SHOOT OR ACIDIZE		SUBSEQUENT REPORT OF ABANDONMENT	
NOTICE OF INTENTION TO PULL OR ALTER CASING		SUPPLEMENTARY WELL HISTORY	
NOTICE OF INTENTION TO ABANDON WELL			

(INDICATE ABOVE BY CHECK MARK NATURE OF REPORT, NOTICE, OR OTHER DATA)

North Interflow Unit

December 30, 19 57

Well No. 1 is located 2100 ft. from N line and 1850 ft. from W line of sec. 20
NE 1/4 of SW 1/4 (1/4 Sec. and Sec. No.) T-35-N (Twp.) R-18-W (Range) - (Meridian)
Albion (Field) San Juan County (County or Subdivision) New Mexico (State or Territory)

The elevation of the derrick floor above sea level is later ft.

DETAILS OF WORK

(State names of and expected depths to objective sands; show sizes, weights, and lengths of proposed casings; indicate mudding jobs, cementing points, and all other important proposed work)

CASING PROGRAM			Cementing Record		Casing Program	
Size	Weight	Length			Depth	Remarks
6-5/8"	32	30'	Circulate to surface		1500-2400	Cliff House & massive
5-1/2"	16	70	Circulate to 9-5/8" csg.		2400-2500	Point Lookout
					4000-4100	Callup
					4300-4600	Dakota

Proposed total depth 4500 to test the Dakota
 Halliburton method of cementing to be used.
 Minimum sand for samples, fresh water oil emulsion min.

Mud 10%, operator, Amray Mid-Continent 10%, non-operator

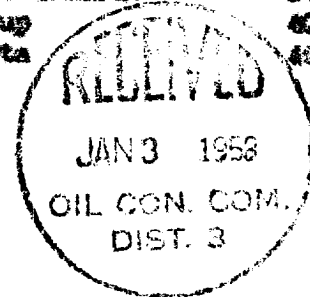

I understand that this plan of work must receive approval in writing by the Geological Survey before operations may be commenced.

Company Amable Oil & Refining Company
 Address Box 1400
Midland, Texas

By [Signature]
 Title Asst. Div. Chief Clerk

NE 1/4 sec 20

NEW MEXICO OIL CONSERVATION COMMISSION

Well Location and Acreage Dedication Plat

Section A.

Date 12-28-57

Operator HUMBLE OIL & REFG. CO Lease North Waterflow Unit
 Well No. 1 Unit Letter "K" Section 28 Township 30 North Range 15 West NMPM
 Located 1980 Feet From South Line, 1980 Feet From West Line
 County San Juan G. L. Elevation _____ Dedicated Acreage 40 Acres
 Name of Producing Formation Dakota Pool North Waterflow Wildcat

1. Is the Operator the only owner* in the dedicated acreage outlined on the plat below?
 Yes _____ No ✓.
2. If the answer to question one is "no," have the interests of all the owners been consolidated by communitization agreement or otherwise? Yes ✓ No _____. If answer is "yes," Type of Consolidation Joint Operation.
3. If the answer to question two is "no," list all the owners and their respective interests below:

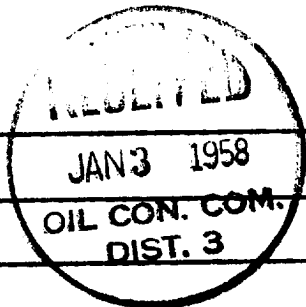
OwnerLand Description

Section B

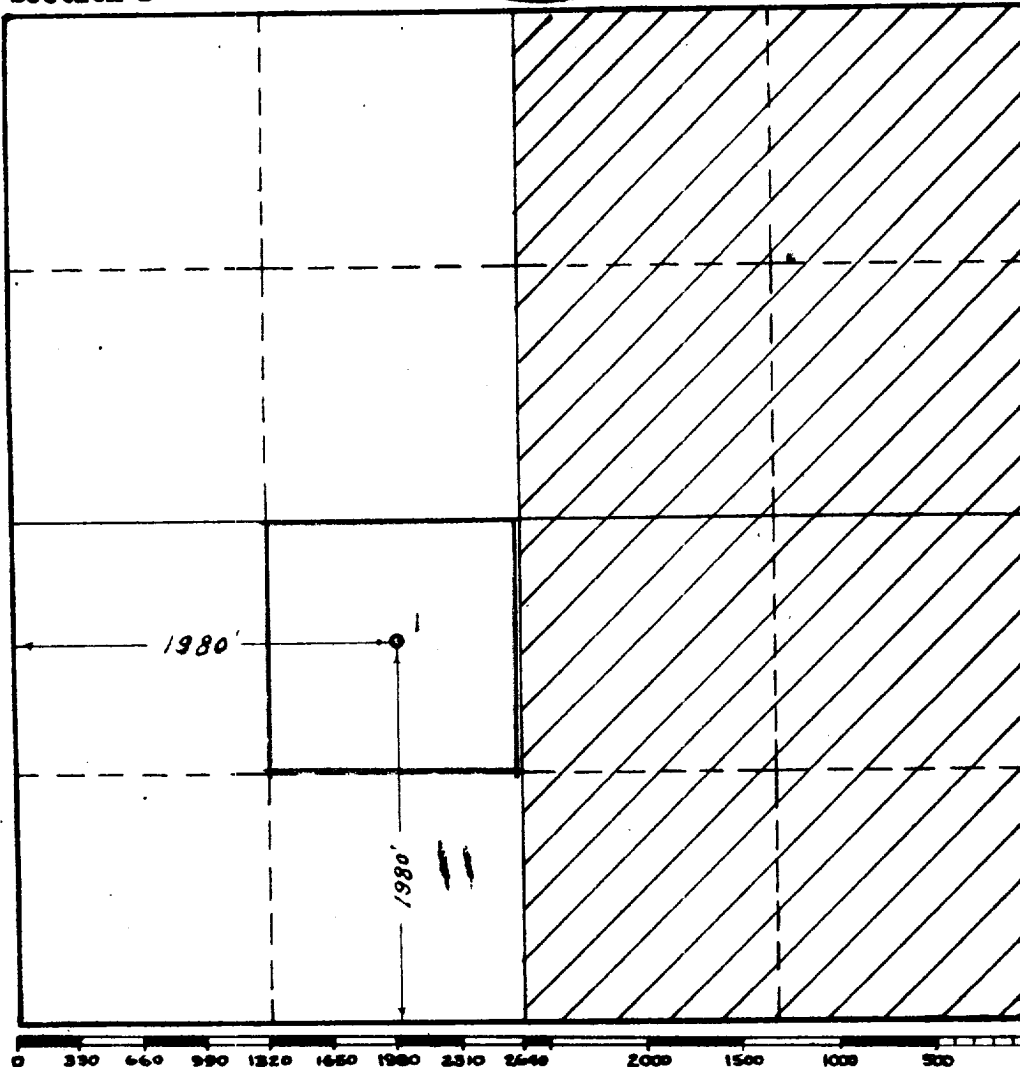

This is to certify that the information in Section A above is true and complete to the best of my knowledge and belief.

HUMBLE OIL & REFG. CO
 (Operator)

Henry J. Headman
 (Representative)
 Assistant Division Supt.
 Box 1600 Midland, Texas
 Address

This is to certify that the well location shown on the plat in Section B was plotted from field notes of actual surveys made by me or under my supervision and that the same is true and correct to the best of my knowledge and belief.

Date Surveyed 12-26-57

E. T. Shahan
 Registered Professional
 Engineer and/or Land Surveyor.

Certificate No. 1513

LEASE NO AR 63-197-57 W-A - 2454
 Fed. Lse. No. SFD 78107 & 080362

Humble

.20

21

Humble

Humble

Fee

Fee

Fee

Sunray Mid-Cont.

29

28

Humble No. P.R. 63-197-57

Humble

320 AC.

T-30-N

R-15-W

1980'

1980'

North Waterflow Unit

U. S.

SF-078107(S 1/2) SF080362 (N 1/2)

Fee

Humble

32

33

Humble

Pan American

Fee

Fee

Fee

Location
Location Abandoned
Drilling
Dry Abandoned
Oil Well
Oil Well Abandoned
Gas Well
Gas Well Abandoned

RECEIVED

JAN 3 1958

OIL CON. COM.
DIST. 3

I hereby certify that I am a duly licensed professional engineer and/or land surveyor in the State of New Mexico; that I was duly sworn to the duties of such office on this 24th day of December 1957; and that I am the author of this plat of the above land; that I am a duly licensed professional engineer and/or land surveyor in the State of New Mexico; and that I am the author of this plat of the above land.

Surveyed 24 Dec 1957

E. T. Shahan

Registered Professional Engineer & Land Surveyor
in the State of New Mexico

(Seal)

NORTH WATERFLOW UNIT - P.R. 63-197-57
W 1/2 SEC. 28 T-30-N R-15-W
SAN JUAN CO., NEW MEXICO

HUMBLE OIL & REFINING COMPANY

CIVIL ENGINEERING DIVISION

MIDLAND, TEXAS

DRAWN D. L. MCKIBBIN

CHECKED E. T. A.

APPR.

APPR.

SCALE 1" = 1000'

DATE 12-27-57

REVISED

FILE NO.

W-A 2454