

(SUBMIT IN TRIPLICATE)

Indian Agency _____

APPROVED

UNITED STATES
DEPARTMENT OF THE INTERIOR
GEOLOGICAL SURVEY

Allottee _____

Lease No. _____

JAN 5 1961
Richard B. Krahl
RICHARD B. KRAHL
ACTING DISTRICT ENGINEER

Navajo Tribal Contract No. 14-20-603-1045

SUNDRY NOTICES AND REPORTS ON WELLS

NOTICE OF INTENTION TO DRILL.....	<input checked="" type="checkbox"/>	SUBSEQUENT REPORT OF WATER SHUT-OFF.....	
NOTICE OF INTENTION TO CHANGE PLANS.....		SUBSEQUENT REPORT OF SHOOTING OR ACIDIZING.....	
NOTICE OF INTENTION TO TEST WATER SHUT-OFF.....		SUBSEQUENT REPORT OF ALTERING CASING.....	
NOTICE OF INTENTION TO REDRILL OR REPAIR WELL.....		SUBSEQUENT REPORT OF REDRILLING OR REPAIR.....	
NOTICE OF INTENTION TO SHOOT OR ACIDIZE.....		SUBSEQUENT REPORT OF ABANDONMENT.....	
NOTICE OF INTENTION TO PULL OR ALTER CASING.....		SUPPLEMENTARY WELL HISTORY.....	
NOTICE OF INTENTION TO ABANDON WELL.....			

(INDICATE ABOVE BY CHECK MARK NATURE OF REPORT, NOTICE, OR OTHER DATA)

December 7, 1960

Well No. 3 Navajo is located 2310 ft. from N line and 2310 ft. from E line of sec. 27

SE 1/4 27 30N 19W N.M.P.M.
(1/4 Sec. and Sec. No.) (Twp.) (Range) (Meridian)
Wilcox San Juan County New Mexico
(Field) (County or Subdivision) (State or Territory)

The elevation of the derrick floor above sea level is 5036 ft.

DETAILS OF WORK

(State names of and expected depths to objective sands; show sizes, weights, and lengths of proposed casings; indicate mudding jobs, cementing points, and all other important proposed work)

Propose to drill 6 1/2" hole with air to depth of approximately 250' to test the Gallup formation. If oil is encountered in commercial quantities, will run pipe and complete.

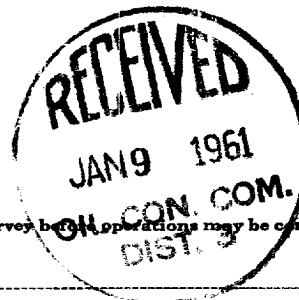

I understand that this plan of work must receive approval in writing by the Geological Survey before operations may be commenced.

Company Harrell Budd

Address 211 1/2 West Main

Farmington, New Mexico

By *Harrell Budd*

Title Harrell Budd

RECEIVED
JAN 10 1964
U.S. AIR FORCE
HONOLULU, HAWAII

RECEIVED
JAN 10 1964
U.S. AIR FORCE
HONOLULU, HAWAII

NUMBER OF COPIES RECEIVED	
DISTRIBUTION	
SANTA FE	
FILE	
U.S.G.S.	
LAND OFFICE	
TRANSPORTER	OIL GAS
PRODUCTION OFFICE	
OPERATOR	

NEW MEXICO OIL CONSERVATION COMMISSION
WELL LOCATION AND ACREAGE DEDICATION PLAT
 SEE INSTRUCTIONS FOR COMPLETING THIS FORM ON THE REVERSE SIDE

FORM C-128
 Revised 5/1/57

SECTION A

Operator HARRELL BUDD		Lease NAVAJO		Well No. 3
Unit Letter J	Section 27	Township 30 NORTH	Range 19 WEST	County SAN JUAN
Actual Footage Location of Well: 2310 feet from the SOUTH line and 2310 feet from the EAST line				
Ground Level Elev. 5036.0	Producing Formation	Pool WILDCAT	Dedicated Acreage: 40 Acres	

Reg. G.L.C. Plat dated May 11, 1953

1. Is the Operator the only owner in the dedicated acreage outlined on the plat below? YES _____ NO _____. ("Owner" means the person who has the right to drill into and to produce from any pool and to appropriate the production either for himself or for himself and another. (65-3-29 (e) NMSA 1935 Comp.)
2. If the answer to question one is "no," have the interests of all the owners been consolidated by communitization agreement or otherwise? YES _____ NO _____. If answer is "yes," Type of Consolidation _____
3. If the answer to question two is "no," list all the owners and their respective interests below:

Owner	Land Description

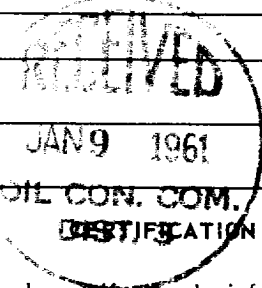

SECTION B

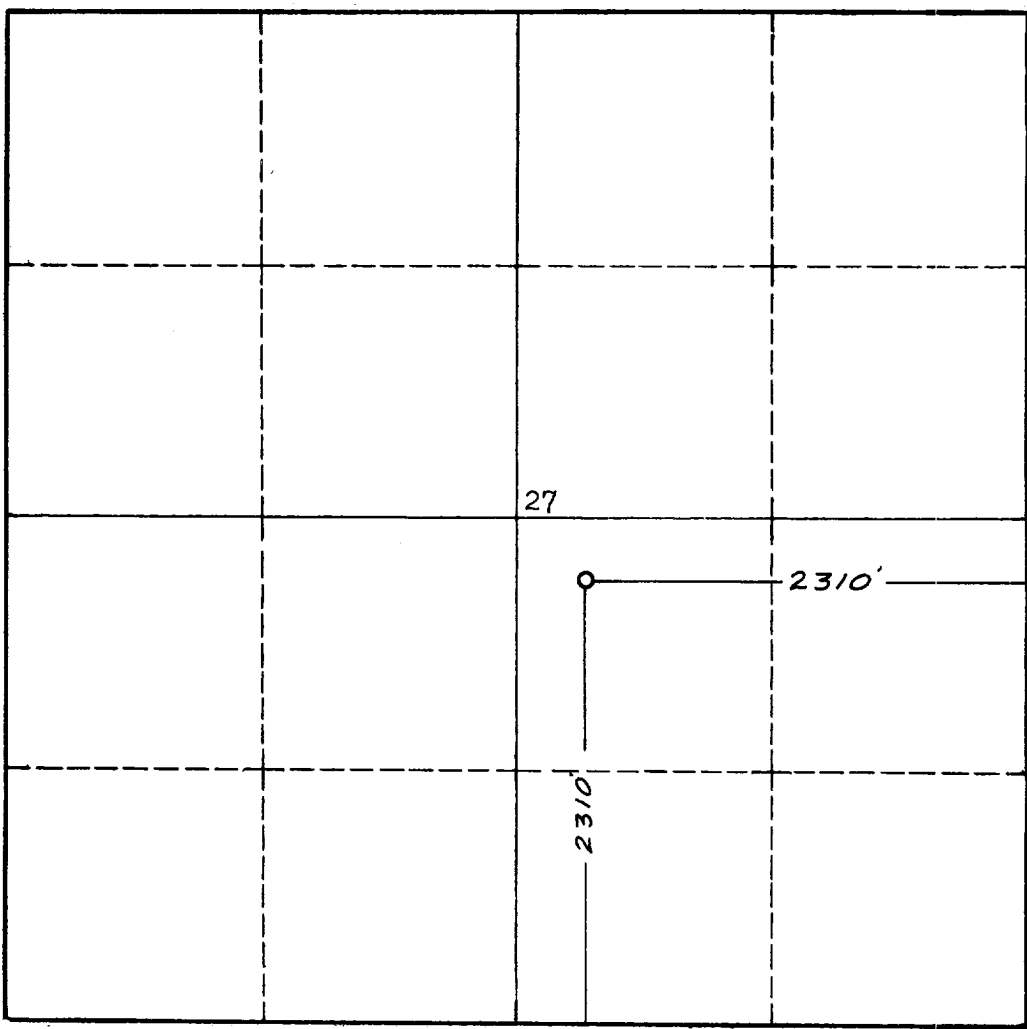

I hereby certify that the information in SECTION A above is true and complete to the best of my knowledge and belief.

Name <i>James P. Leese</i>
Position
Company
Date <i>12/7/60</i>

I hereby certify that the well location shown on the plat in SECTION B was plotted from field notes of actual surveys made by me or under my supervision, and that the same is true and correct to the best of my knowledge and belief.

Date Surveyed 27 October 1960
Registered Professional Engineer and/or Land Surveyor <i>James P. Leese</i> James P. Leese
Certificate No. 1463

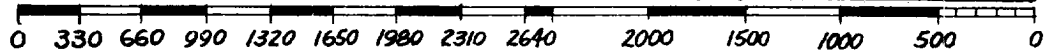

INSTRUCTIONS FOR COMPLETION OF FORM C-128

1. Operator shall furnish and certify to the information called for in Section A.
2. Operator shall outline the dedicated acreage for *both* oil and gas wells on the plat in Section B.
3. A registered professional engineer or land surveyor registered in the State of New Mexico or approved by the Commission shall show on the plat the location of the well and certify this information in the space provided.
4. All distances shown on the plat must be from the outer boundaries of the Section.
5. If additional space is needed for listing owners and their respective interests as required in question 3 of Section A, please use space below.