

District I
P.O. Box 1980, Hobbs, NM
DEPUTY OIL & GAS INSPECTOR
District II
P.O. Drawer DD, Artesia, NM 88221
District III
1900 Rio Brazos Rd, Aztec, NM 87410

State of New Mexico
Energy, Minerals and Natural Resources Department

SUBMIT COPY TO
APPROPRIATE
DISTRICT OFFICE
AND COPY TO
SANTA FE OFFICE

OIL CONSERVATION DIVISION

2040 South Pacheco Street
Santa Fe, New Mexico 87505

RECEIVED
OCT 31 1996

OIL CON. DIV.
DIST. 3

PIT REMEDIATION AND CLOSURE REPORT

Operator: PNM Gas Services (Amoco)		Telephone: 324-3764	
Address: 603 W. Elm Street Farmington, NM 87401			
Facility or Well Name: Florance #10			
Location:	Unit: <u>H</u>	Sec. <u>30</u>	T. <u>30 N</u> R. <u>9 W</u> County <u>San Juan</u>
Pit Type:	Separator <u> </u>	Dehydrator <input checked="" type="checkbox"/>	Other <u> </u>
Land Type:	BLM <input checked="" type="checkbox"/>	State <u> </u>	Fee <u> </u> Other <u> </u>
Pit Location:		Pit dimensions: length <u>20</u> width <u>20</u> depth <u>5</u>	
(Attach diagram)	Reference: wellhead <input checked="" type="checkbox"/>		other <u> </u>
Footage from reference:		<u>110'</u>	
Direction from reference:		<u>90</u> Degrees <u> </u> East <u> </u> North <input checked="" type="checkbox"/>	
		of <u> </u> <input checked="" type="checkbox"/> West <u> </u> South <u> </u>	
Depth to Ground Water:			
(Vertical distance from contaminants to seasonal high water elevation of ground water)		Less than 50 feet (20 points)	
		50 feet to 99 feet (10 points)	
		Greater than 100 feet (0 points)	<u>0</u>
Wellhead Protection Area:			
(Less than 200 feet from a private domestic water source, or, less than 1,000 feet from all other water sources)		Yes (20 points)	
		No (0 points)	<u>0</u>
Distance to Surface Water:			
(Horizontal distance to perennial lakes, ponds, rivers, streams, creeks, irrigation canals and ditches)		Less than 200 feet (20 points)	
		200 feet to 1,000 feet (10 points)	
		Greater than 1,000 feet (0 points)	<u>0</u>
RANKING SCORE (TOTAL POINTS):			<u>0</u>

Date Remediation Started: 7/15/96 Date Completed: 7/17/96

Remediation Method: Excavation X Approx. Cubic Yard 51

(Check all appropriate sections)

Landfarmed X Amount Landfarmed (cubic yds) 51

Other _____

Remediation Location: Onsite _____ Offsite Florance #91 (30-30N-09W)
(i.e., landfarmed onsite, name and location of offsite facility)

Backfill Material Location: _____

General Description of Remedial Action:

Excavated contaminated soil to pit size 23'x12'x5' and landfarmed soil offsite within a bermed area at a depth of 6" to 12". Soil was aerated by plowing/disking until soil met regulatory levels.

Ground Water Encountered: No ☒ Yes ☐ Depth _____

Final Pit Closure Sampling:

Sample Location 5 pt. composite-4 side walls and center of pit bottom.

(if multiple samples, attach sample result and diagram of sample locations and depths.)

Sample depth 5'

Sample date 7/15/96 Sample time 10:30:00 AM

Sample Results

Benzene (ppm) 0.0958

Total BTEX (ppm) 1.4821

Field headspace (ppm) _____

TPH < 5.00 Method 8015A

Vertical Extent (ft) _____ Risk Assessment form attached Yes ☐ No ☒

Ground Water Sample: Yes ☐ No ☒ (If yes, attach sample results)

I HEREBY CERTIFY THAT THE INFORMATION ABOVE IS TRUE AND COMPLETE TO THE BEST OF MY KNOWLEDGE AND MY BELIEF

DATE October 25, 1996

SIGNATURE Maureen Gannon

PRINTED NAME Maureen Gannon

AND TITLE Environmental Engineer

Site Map:

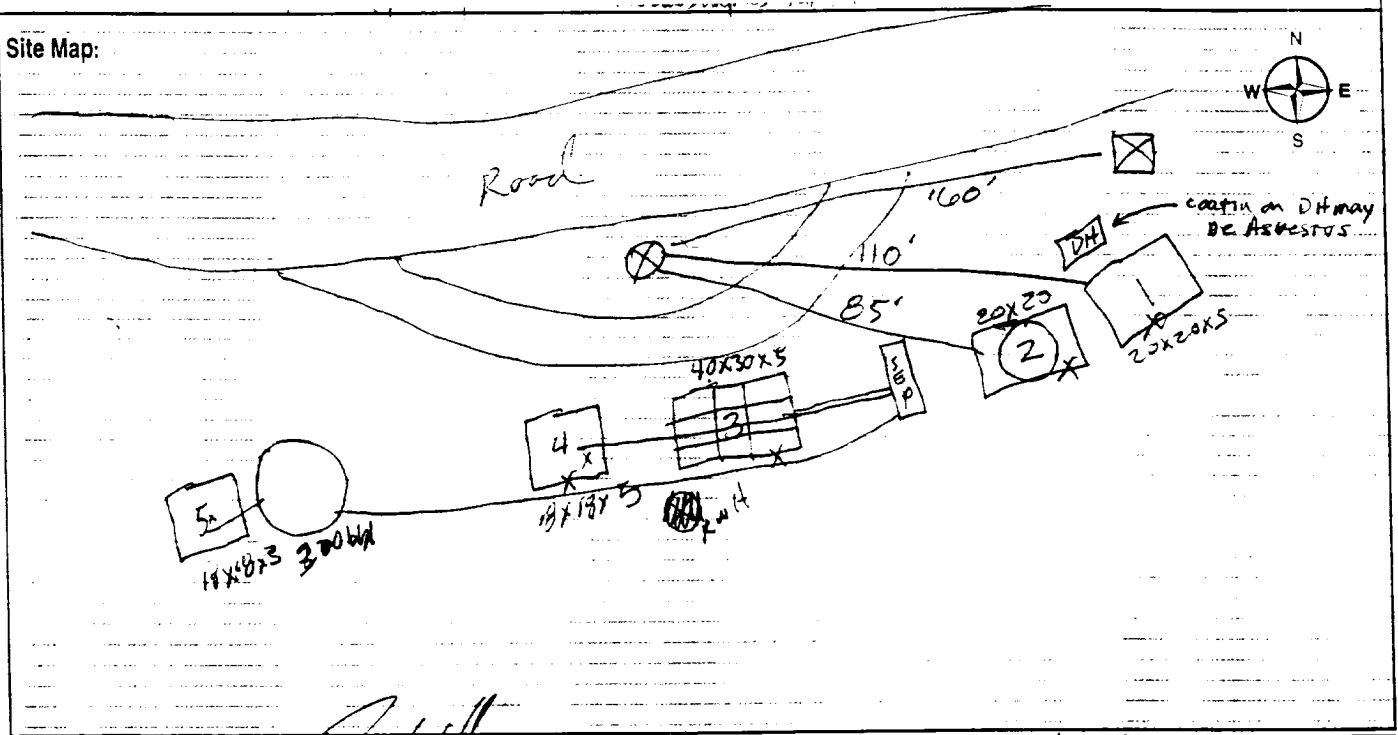

Assessor's Signature

[Handwritten Signature]

Date:

10/27/95

OFF: (505) 325-5667



LAB: (505) 325-1556

Diesel Range Organics

Attn: *Denver Bearden*
Company: *PNM Gas Services*
Address: *603 W. Elm*
City, State: *Farmington, NM 87401*

Date: *17-Jul-96*
COC No.: *4547*
Sample No. *11528*
Job No. *2-1000*

Project Name: *PNM Gas Services - Florance 10 Pit*
Project Location: *9607151030; 5pt. Composite*
Sampled by: *MS* Date: *15-Jul-96* Time: *10:30*
Analyzed by: *DC* Date: *17-Jul-96*
Sample Matrix: *Soil*

Laboratory Analysis

<i>Parameter</i>	<i>Result</i>	<i>Unit of Measure</i>	<i>Detection Limit</i>	<i>Unit of Measure</i>
<i>Diesel Range Organics (C10 - C28)</i>	<i><5.0</i>	<i>mg/kg</i>	<i>5.0</i>	<i>mg/kg</i>

Quality Assurance Report

DRO QC No.: *0479-QC*

Calibration Check

<i>Parameter</i>	<i>Method Blank</i>	<i>Unit of Measure</i>	<i>True Value</i>	<i>Analyzed Value</i>	<i>% Diff</i>	<i>Limit</i>
<i>Diesel Range (C10 - C28)</i>	<i><5.0</i>	<i>ppm</i>	<i>2,000</i>	<i>1,912</i>	<i>4.4</i>	<i>15%</i>

Matrix Spike

<i>Parameter</i>	<i>1 - Percent Recovered</i>	<i>2 - Percent Recovered</i>	<i>Limit</i>	<i>%RSD</i>	<i>Limit</i>
<i>Diesel Range (C10-C28)</i>	<i>107</i>	<i>106</i>	<i>(70-130)</i>	<i>0</i>	<i>20%</i>

Method - SW-846 EPA Method 8015A mod. - Nonhalogenated Volatile Hydrocarbons by Gas Chromatography

Approved by: *DC*
Date: *7/18/96*

P.O. BOX 2606 • FARMINGTON, NM 87499

- TECHNOLOGY BLENDING INDUSTRY WITH THE ENVIRONMENT -

OFF: (505) 325-5667



LAB: (505) 325-1556

AROMATIC VOLATILE ORGANICS

Attn: *Denver Bearden*
Company: *PNM Gas Services*
Address: *603 W. Elm*
City, State: *Farmington, NM 87401*

Date: *17-Jul-96*
COC No.: *4547*
Sample No.: *11528*
Job No.: *2-1000*

Project Name: *PNM Gas Services - Florance 10 Pit*

Project Location: *9607151030; 5pt. Composite*

Sampled by: *MS* Date: *15-Jul-96* Time: *10:30*

Analyzed by: *HR* Date: *16-Jul-96*

Sample Matrix: *Soil*

Laboratory Analysis

<i>Component</i>	<i>Result</i>	<i>Unit of Measure</i>	<i>Detection Limit</i>	<i>Unit of Measure</i>
<i>Benzene</i>	<i>95.8</i>	<i>ug/kg</i>	<i>0.2</i>	<i>ug/kg</i>
<i>Toluene</i>	<i>106.1</i>	<i>ug/kg</i>	<i>0.2</i>	<i>ug/kg</i>
<i>Ethylbenzene</i>	<i>132.0</i>	<i>ug/kg</i>	<i>0.2</i>	<i>ug/kg</i>
<i>m,p-Xylene</i>	<i>1008.0</i>	<i>ug/kg</i>	<i>0.2</i>	<i>ug/kg</i>
<i>o-Xylene</i>	<i>140.1</i>	<i>ug/kg</i>	<i>0.2</i>	<i>ug/kg</i>
<i>TOTAL</i>	<i>1482.1</i>	<i>ug/kg</i>		

Method - *SW-846 EPA Method 8020 Aromatic Volatile Organics by Gas Chromatography*

Approved by: *[Signature]*
Date: *7/18/96*

P.O. BOX 2606 • FARMINGTON, NM 87499

- TECHNOLOGY BLENDING INDUSTRY WITH THE ENVIRONMENT -

Florence #10

9-3-96

Amoco

Sec. 30, 30N, 9W

Land Farmed : Florence #91

80 yds

Amoco

Sec. 30, 30N, 9W

Composite sample # 960903 1510

6pt comp.

Soil Vapor Head space = 11.3 ppm (PID)

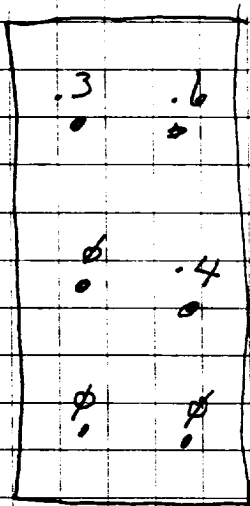

2'-12" depth

OFF: (505) 325-5667



LAB: (505) 325-1556

Diesel Range Organics

Attn: *Denver Bearden*
Company: *PNM Gas Services*
Address: *603 W. Elm*
City, State: *Farmington, NM 87401*

Date: *5-Sep-96*
COC No.: *4987*
Sample No. *11978*
Job No. *2-1000*

Project Name: *PNM Gas Services - Florance #10 Landfarm: Florance #91*
Project Location: *9609031510; 6pt. Composite, 2"-12" depth*
Sampled by: *GC* Date: *3-Sep-96* Time: *15:10*
Analyzed by: *DC* Date: *5-Sep-96*
Sample Matrix: *Soil*

Laboratory Analysis

<i>Parameter</i>	<i>Result</i>	<i>Unit of Measure</i>	<i>Detection Limit</i>	<i>Unit of Measure</i>
<i>Diesel Range Organics (C10 - C28)</i>	<i><5.0</i>	<i>mg/kg</i>	<i>5.0</i>	<i>mg/kg</i>

Quality Assurance Report

DRO QC No.: 0489-QC

Calibration Check

<i>Parameter</i>	<i>Method Blank</i>	<i>Unit of Measure</i>	<i>True Value</i>	<i>Analyzed Value</i>	<i>% Diff</i>	<i>Limit</i>
<i>Diesel Range (C10 - C28)</i>	<i><5.0</i>	<i>ppm</i>	<i>100</i>	<i>101</i>	<i>0.7</i>	<i>15%</i>

Matrix Spike

<i>Parameter</i>	<i>1 - Percent Recovered</i>	<i>2 - Percent Recovered</i>	<i>Limit</i>	<i>%RSD</i>	<i>Limit</i>
<i>Diesel Range (C10-C28)</i>	<i>98</i>	<i>114</i>	<i>(70-130)</i>	<i>11</i>	<i>20%</i>

Method - *SW-846 EPA Method 8015A mod. - Nonhalogenated Volatile Hydrocarbons by Gas Chromatography*

Approved by: *[Signature]*
Date: *9/6/96*

P.O. BOX 2606 • FARMINGTON, NM 87499

TECHNOLOGY BLENDING INDUSTRY WITH THE ENVIRONMENT -