

(SUBMIT IN TRIPLICATE)

UNITED STATES
DEPARTMENT OF THE INTERIOR
GEOLOGICAL SURVEY

Land Office **Santa Fe**
Lease No. **078977**
Unit _____

SUNDRY NOTICES AND REPORTS ON WELLS

NOTICE OF INTENTION TO DRILL	<input checked="" type="checkbox"/>	SUBSEQUENT REPORT OF WATER SHUT-OFF	<input type="checkbox"/>
NOTICE OF INTENTION TO CHANGE PLANS	<input type="checkbox"/>	SUBSEQUENT REPORT OF SHOOTING OR ACIDIZING	<input type="checkbox"/>
NOTICE OF INTENTION TO TEST WATER SHUT-OFF	<input type="checkbox"/>	SUBSEQUENT REPORT OF ALTERING CASING	<input type="checkbox"/>
NOTICE OF INTENTION TO RE-DRILL OR REPAIR WELL	<input type="checkbox"/>	SUBSEQUENT REPORT OF RE-DRILLING OR REPAIR	<input type="checkbox"/>
NOTICE OF INTENTION TO SHOOT OR ACIDIZE	<input type="checkbox"/>	SUBSEQUENT REPORT OF ABANDONMENT	<input type="checkbox"/>
NOTICE OF INTENTION TO PULL OR ALTER CASING	<input type="checkbox"/>	SUPPLEMENTARY WELL HISTORY	<input type="checkbox"/>
NOTICE OF INTENTION TO ABANDON WELL	<input type="checkbox"/>		

(INDICATE ABOVE BY CHECK MARK NATURE OF REPORT, NOTICE, OR OTHER DATA)

January 6, 1962

Federal
Well No. **2-30A** is located **2120** ft. from **N** line and **820** ft. from **E** line of sec. **30**
NW (Lot 10) **30 North 13 West** **10PM**
(1/4 Sec. and Sec. No.) (Twp.) (Range) (Meridian)
Basin-Dakota **San Juan County** **New Mexico**
(Field) (County or Subdivision) (State or Territory)

The elevation of the derrick floor above sea level is **5472** ft. **5458' G.L.**

DETAILS OF WORK

(State names of and expected depths to objective sands; show sizes, weights, and lengths of proposed casings; indicate mudlogging jobs, cementing points, and all other important proposed work)

Operator proposes to drill a well to test the oil and/or gas possibilities through the Dakota formation. Total depth on the well will be approximately 6100 feet.

Drilling and Completion:

1. Drill to 250', run approx. 250' 8-5/8" surface casing and cement with sufficient cement to circulate.
2. Drill a 7-5/8" hole to total depth, run Induction-ES and Gamma Ray-Sonic Log.
3. If production is encountered 8-1/2" production string will be run and cemented with approx. 125 sacks of cement.

I understand that this plan of work must receive approval in writing by the Geological Survey before operations may be commenced.

Company **Compass Exploration, Inc.**
Address **101 University Boulevard**
Denver 6, Colorado

By *Donny Harvey*
Title **President**

NEW MEXICO OIL CONSERVATION COMMISSION

Well Location and Acreage Dedication Plat

Section A.

Date January 8, 1962

Operator COMPASS EXPLORATION, INC. Lease Federal
 Well No. 2-30 A Unit Letter F Section 30 Township 30 NORTH Range 13 West, NMPM
 Located 2110 Feet From the NORTH Line, 820 Feet From the WEST Line
 County SAN JUAN G. L. Elevation 5458.0 Dedicated Acreage 321.74 317.19 Acres
 Name of Producing Formation DAKOTA Pool Basin-Dakota

1. Is the Operator the only owner in the dedicated acreage outlined on the plat below?

Yes X No

2. If the answer to question one is "no", have the interests of all the owners been consolidated by communitization agreement or otherwise? Yes No If answer is "yes", Type of Consolidation.

3. If the answer to question two is "no", list all the owners and their respective interests below:

Owner

Land Description

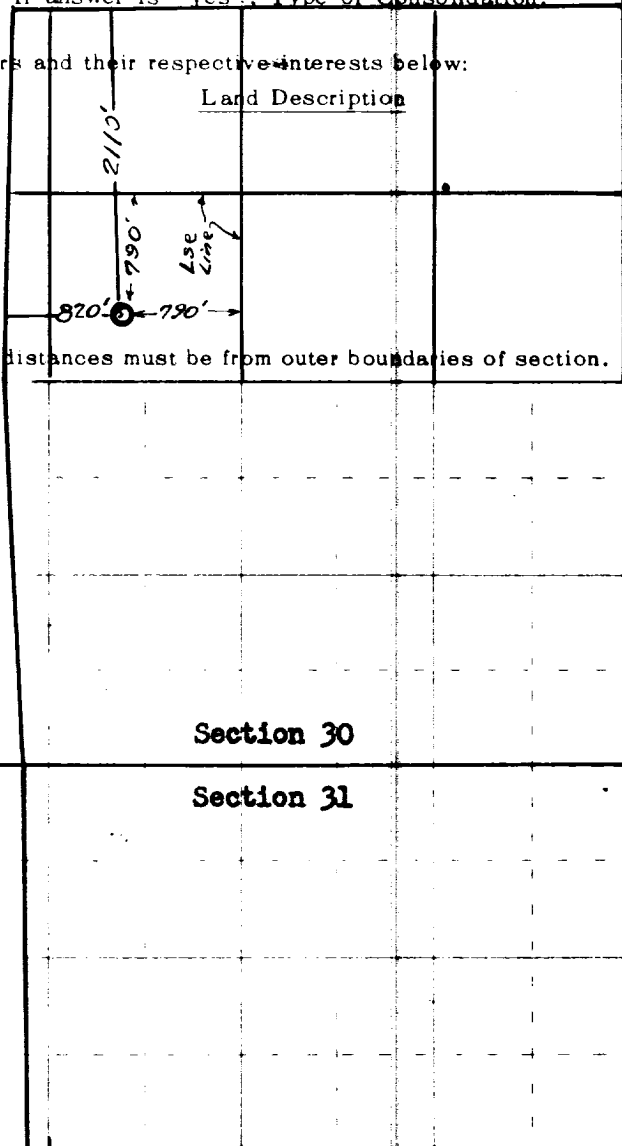

Section B.

Note: All distances must be from outer boundaries of section.

This is to certify that the information
 in Section A above is true and complete
 to the best of my knowledge and belief.

Compass Exploration, Inc.
 (Operator)

Ellellis
 (Representative)

1645 Court Place
 (Address)

Denver, Colorado

Ref: GLO plat dated 12 May 1955

Case No. 2327, Order #R-2046
 Effective 8 - 14 - 61

0 330 660 990 1320 1650 1980 2310 2640 2000 1000 500 0

Scale 4 inches equal 1 mile

This is to certify that the above plat was prepared from field notes of actual surveys
 made by me or under my supervision and that the same are true and correct to the best
 of my knowledge and belief.

Date Surveyed 4 January 1962

Registered Professional Engineer and/or Land Surveyor

James P. Tessa N. Mex. Reg. No. 1162

Farmington, New Mexico