

(SUBMIT IN TRIPLICATE)

UNITED STATES
DEPARTMENT OF THE INTERIOR
GEOLOGICAL SURVEY

Land Office Santa Fe

Lease No. SF 078213

Unit E/2, Sec. 25, T-30-N,
R-13W, N.M.P.M., San Juan
County, New Mexico

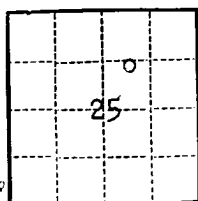

SUNDRY NOTICES AND REPORTS ON WELLS

RECEIVED

NOTICE OF INTENTION TO DRILL	<input checked="" type="checkbox"/>	SUBSEQUENT REPORT OF WATER SHUT-OFF	NOV 5 1962
NOTICE OF INTENTION TO CHANGE PLANS		SUBSEQUENT REPORT OF SHOOTING OR ACIDIZING	
NOTICE OF INTENTION TO TEST WATER SHUT-OFF		SUBSEQUENT REPORT OF ALTERING CASING	U. S. GEOLOGICAL SURVEY
NOTICE OF INTENTION TO RE-DRILL OR REPAIR WELL		SUBSEQUENT REPORT OF RE-DRILLING OR REPAIR	SAN JUAN COUNTY, NEW MEXICO
NOTICE OF INTENTION TO SHOOT OR ACIDIZE		SUBSEQUENT REPORT OF ABANDONMENT	
NOTICE OF INTENTION TO PULL OR ALTER CASING		SUPPLEMENTARY WELL HISTORY	
NOTICE OF INTENTION TO ABANDON WELL			

(INDICATE ABOVE BY CHECK MARK NATURE OF REPORT, NOTICE, OR OTHER DATA)

October 30, 1962

Well No. 2-25/ is located 1840 ft. from N line and 1750 ft. from E line of sec. 25

SW NE Sec. 25 30-N 13-W N.M.P.M.
(1/4 Sec. and Sec. No.) (Twp.) (Range) (Meridian)

Basin Dakota San Juan New Mexico
(Field) (County or Subdivision) (State or Territory)

The elevation of the derrick floor above sea level is 5821 ft. G.L.

DETAILS OF WORK

(State names of and expected depths to objective sands; show sizes, weights, and lengths of proposed casings; indicate mudding jobs, cementing points, and all other important proposed work)

1. The objective sand is the Dakota formation anticipated at 6325'.
2. Proposed casing program: 250', 8-5/8", 24.00#, J-55 cemented to surface.
6625', 4-1/2" 10.50#, J-55 cemented w/300 sacks.
3. Will set D.V. Tool below Pictured Cliffs and cement with 200 sacks unless log shows Pictured Cliff to be Non-commercial.
4. Rotary tools will be employed from surface to T.D. of 6625'.
5. Pipe will be set at approx. 6625'.
6. Well will be Sand-Water fraced in an effort to stimulate production.

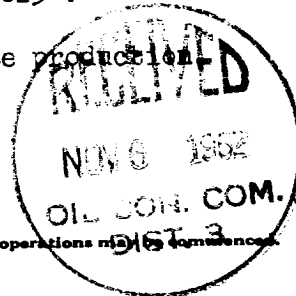

I understand that this plan of work must receive approval in writing by the Geological Survey before operations may be commenced.

Company SOUTHERN UNION PRODUCTION COMPANY

Address P. O. Box 808

Farmington, New Mexico

By L. S. Muennink

Title Area Superintendent

MEXICO OIL CONSERVATION COMMISSION
Well Location and Acreage Dedication Plat

Section A.

Date October 30, 1962

Operator SOUTHERN UNION PRODUCTION COMPANY Lease Federal
 Well No. 2-25 Unit Letter G Section 25 Township 30 NORTH Range 13 WEST NMPM
 Located 1840 Feet From the NORTH Line, 1750 Feet From the EAST Line
 County SAN JUAN G. L. Elevation 5821.0 Dedicated Acreage 300 Acres
 Name of Producing Formation Santa Fe Pool Santa Fe

1. Is the Operator the only owner in the dedicated acreage outlined on the plat below?
 Yes _____ No _____
2. If the answer to question one is "no", have the interests of all the owners been consolidated by communitization agreement or otherwise? Yes _____ No _____. If answer is "yes", Type of Consolidation.
3. If the answer to question two is "no", list all the owners and their respective interests below:

OwnerLand Description

RECEIVED
 NOV 6 1962

COM.

Section B.

Note: All distances must be from outer boundaries of section.

This is to certify that the information
 in Section A above is true and complete
 to the best of my knowledge and belief.

Southern Union Production Co.

(Operator)
L. S. Hunsaker

(Representative)
Box 308

(Address)
Farmington, New Mexico

Ref: BLM plat dated 12 Mar 1955

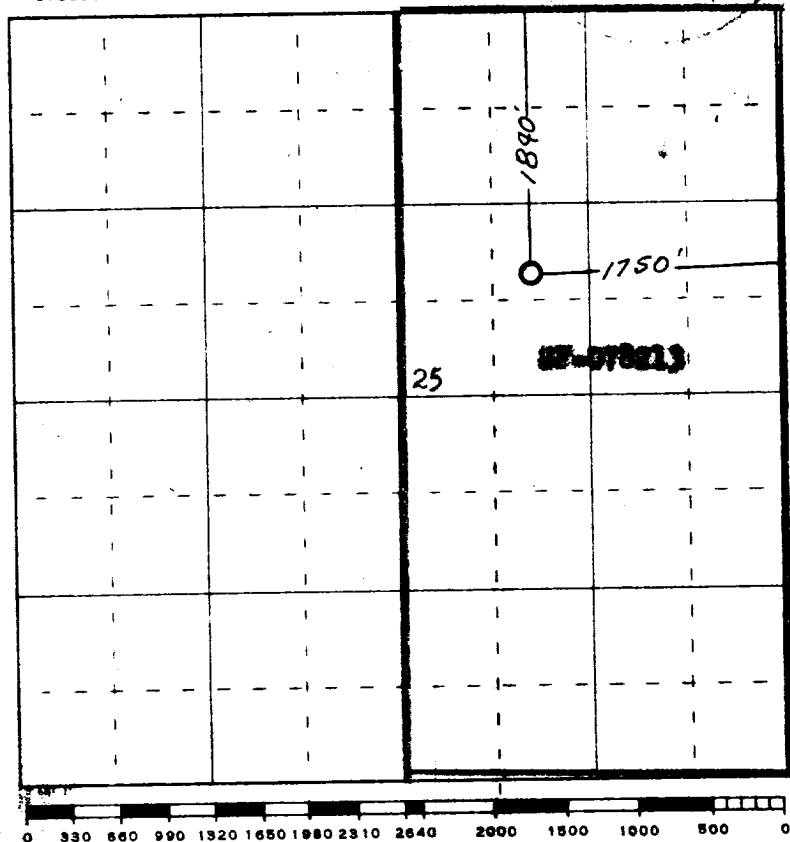

Scale 4 inches equal 1 mile

This is to certify that the above plat was prepared from field notes of actual surveys made by me or under my supervision and that the same are true and correct to the best of my knowledge and belief.

Date Surveyed 24 October 1962

Registered Professional Engineer and/or Land Surveyor
James P. Leese, N. Mex. Reg. No. 1463

(Seal)

Farmington, New Mexico