

FIELD PITS ASSESSMENT FORM

Meter: 73861 Location: FEDERAL GAS COM D #1
Operator #: _____ Operator Name: _____ P/L District: _____
Coordinates: Letter: _____ Section: _____ Township: _____ Range: _____
Or Latitude: _____ Longitude: _____
Pit Type: Dehydrator _____ Location Drip: _____ Line Drip: _____ Other: _____
Site Assessment Date: _____ Area: 02 Run: 22

NMOCD Zone:

(From NMOCD
Maps)

Inside

Outside

Land Type:

BLM ☐ (1)

State ☐ (2)

Fee ☐ (3)

Indian _____

Depth to Groundwater

Less Than 50 Feet (20 points) ☒ (1)

50 Ft to 99 Ft (10 points) ☐ (2)

Greater Than 100 Ft (0 points) ☐ (3)

Well head Protection Area :

Is it less than 1000 ft from wells, springs, or other sources of fresh water extraction? , or ; Is it less than 200 ft from a private domestic water source? ☐ (1) YES (20 points) ☐ (2) NO (0 points)

Horizontal Distance to Surface Water Body

Less Than 200 Ft (20 points) ☐ (1)

200 Ft to 1000 Ft (10 points) ☐ (2)

Greater Than 1000 Ft (0 points) ☐ (3)

Name of Surface Water Body _____

(Surface Water Body : Perennial Rivers, Major Wash, Streams, Creeks, Irrigation Canals, Ditches, Lakes, Ponds)

Distance to Nearest Ephemeral Stream ☐ (1) < 100' (Navajo Pits Only)

☐ (2) > 100'

TOTAL HAZARD RANKING SCORE: 30 **POINTS**

Remarks : _____



2709-D Pan American Freeway, NE Albuquerque, NM 87107
Phone (505) 344-3777 FAX (505) 344-4413

ATI I.D. 405331

May 19, 1994

El Paso Natural Gas Company
770 W. Navajo
Farmington, NM 87401

Project Name/Number: PIT PROJECT 24324

Attention: John Lambdin

On 05/06/94, Analytical Technologies, Inc., (AAS License No. AZ0015), received a request to analyze **aqueous** and **non-aqueous** samples. The samples were analyzed with ICPA methodology or equivalent methods. The results of these analyses and the quality control data, which follow each set of analyses, are enclosed.

Upon arrival, it was noted that sample 945055 contained headspace. The client was notified and the sample was analyzed "as is."

The laboratory was instructed to correct the sampling data for sample 945075 to 05/04/94.

If you have any questions or comments, please do not hesitate to contact us at (505) 344-3777.

H. Mitchell Rubenstein, Ph.D.
Laboratory Manager

MR:jd

Enclosure





10

FIELD SERVICES LABORATORY

ANALYTICAL REPORT

PIT CLOSURE PROJECT - Soil

SAMPLE IDENTIFICATION

	Field ID	Lab ID
SAMPLE NUMBER:	KP18	945 072
MTR CODE SITE NAME:	73861 93167- ¹⁰¹¹ 7/19/94	N/A
SAMPLE DATE TIME (Hrs):	5/14/94	1305
SAMPLED BY:	N/A	
DATE OF TPH EXT. ANAL:	5/15/94	5/15/94
DATE OF BTEX EXT. ANAL:	5/14/94	5/14/94
TYPE DESCRIPTION:	VC	gray hard sandstone

REMARKS:

RESULTS

PARAMETER	RESULT	UNITS	QUALIFIERS			
			DF	Q	M(g)	V(ml)
BENZENE	0.43	MG/KG	5			
TOLUENE	3.2	MG/KG	5			
ETHYL BENZENE	0.7	MG/KG	5			
TOTAL XYLENES	7.7	MG/KG	5			
TOTAL BTEX	12.1	MG/KG				
TPH (418.1)	<10	MG/KG			2.06	28
HEADSPACE PID	361	PPM				
PERCENT SOLIDS	88.2	%				

— TPH is by EPA Method 418.1 and BTEX is by EPA Method 820.0 —

The Surrogate Recovery was at 130 % for this sample. All QA/QC was acceptable.

Narrative:

ATI Results attached. Surrogate recovery was outside
ATI QC limits due to matrix interference.

DF = Dilution Factor Used

Approved By: John Ford

Date: 7/14/94



GAS CHROMATOGRAPHY RESULTS

TEST : BTEX (EPA 8020)
CLIENT : EL PASO NATURAL GAS CO. ATI I.D.: 405331
PROJECT # : 24324
PROJECT NAME : PIT PROJECT

SAMPLE ID. #	CLIENT I.D.	MATRIX	DATE SAMPLED	DATE EXTRACTED	DATE ANALYZED	DIL. FACTOR
3	945072	NON-AQ	05/04/94	05/09/94	05/14/94	5
24	945073	NON-AQ	05/04/94	05/09/94	05/13/94	1.5
25	945074	NON-AQ	05/04/94	05/09/94	05/13/94	10

PARAMETER	UNITS	23	24	25
BENZENE	MG/KG	0.43	1.2	0.25
TOLUENE	MG/KG	3.2	42	0.60
ETHYLBENZENE	MG/KG	0.7	16	2.3
TOTAL XYLENES	MG/KG	7.8	170	55

SURROGATE:

BROMOFLUOROBENZENE (%) 130* 50* 110

*OUTSIDE ATI QUALITY CONTROL LIMITS DUE TO MATRIX INTERFERENCE

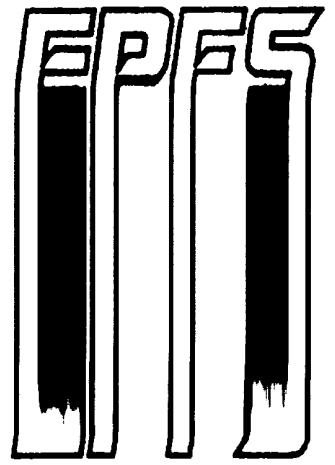

FIELD PIT SITE ASSESSMENT FORM

EL PASO FIELD SERVICES

GENERAL	
	Meter: <u>73861</u> Location: <u>FEDERAL GAS COM D #1</u>
	Operator #: <u>0203</u> Operator Name: <u>Amoco</u> P/L District: <u>KUTZ</u>
	Coordinates: Letter: <u>D</u> Section <u>30</u> Township: <u>30</u> Range: <u>12</u>
	Or Latitude _____ Longitude _____
	Pit Type: Dehydrator <input checked="" type="checkbox"/> Location Drip: _____ Line Drip: _____ Other: _____
	Site Visit Date: <u>3.22.94</u> Run: <u>02</u> <u>22</u>
SITE ASSESSMENT	
	NMOCD Zone: Inside <input type="checkbox"/> Land Type: BLM <input type="checkbox"/> (From NMOCD Vulnerable <input type="checkbox"/> Maps) Zone <input checked="" type="checkbox"/> State <input type="checkbox"/> Outside <input type="checkbox"/> Fee <input checked="" type="checkbox"/> <i>Donna S. Zant</i> DEPUTY OIL & GAS INSPECTOR SEP 11 0 1996 <i>Approved</i>
	Depth to Groundwater Less Than 50 Feet (20 points) <input type="checkbox"/> 50 Ft to 99 Ft (10 points) <input type="checkbox"/> Greater Than 100 Ft (0 points) <input checked="" type="checkbox"/>
	Wellhead Protection Area : Is it less than 1000 ft from wells, springs, or other sources of fresh water extraction? , or ; Is it less than 200 ft from a private domestic water source? <input type="checkbox"/> YES (20 points) <input checked="" type="checkbox"/> NO (0 points)
	Horizontal Distance to Surface Water Body Less Than 200 Ft (20 points) <input type="checkbox"/> 200 Ft to 1000 Ft (10 points) <input checked="" type="checkbox"/> Greater Than 1000 Ft (0 points) <input type="checkbox"/> Name of Surface Water Body <u>HOOB ARROYO</u> (Surface Water Body : Perennial Rivers, Major Wash, Streams, Creeks, Irrigation Canals, Ditches, Lakes, Ponds)
	TOTAL HAZARD RANKING SCORE: <u>10</u> POINTS
REMARKS	
	Remarks : <u>LOCATION IS FENCED OFF. PIT TO BE CLOSED IS OUTSIDE</u> <u>OF FENCE. PIT IS DRY.</u>

ORIGINAL PIT LOCATION

Original Pit : a) Degrees from North 92° Footage to Wellhead 161'
 b) Degrees from North _____ Footage to Dogleg _____
 Dogleg Name _____
 c) Length : 14' Width : 13' Depth : 1'

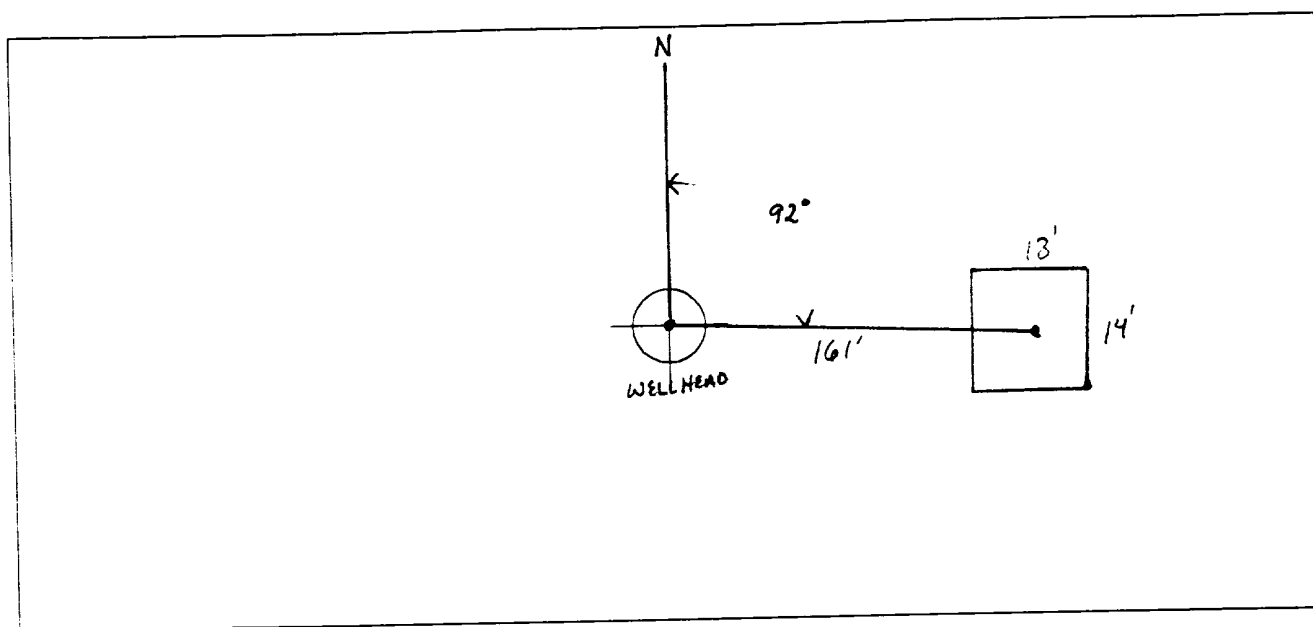

REMARKS :

STARTED TAKING PICTURES AT 2:11 P.M.
DUMP TRUCK - BOBTAIL

Completed By:

Robert Thompson
 Signature

3.22.94
 Date