

5 USGS  
2 Western Development  
1 File  
(SUBMIT IN TRIPLICATE)

UNITED STATES  
DEPARTMENT OF THE INTERIOR  
GEOLOGICAL SURVEY

Budget Bureau No. 42-R358.4.  
Form Approved.

Land Office Santa Fe  
Lease No. SF 076138  
Unit \_\_\_\_\_

SUNDRY NOTICES AND REPORTS ON WELLS

NOTICE OF INTENTION TO DRILL	<input checked="" type="checkbox"/>	SUBSEQUENT REPORT OF WATER SHUT-OFF	
NOTICE OF INTENTION TO CHANGE PLANS		SUBSEQUENT REPORT OF SHOOTING OR ACIDIZING	
NOTICE OF INTENTION TO TEST WATER SHUT-OFF		SUBSEQUENT REPORT OF ALTERING CASING	
NOTICE OF INTENTION TO RE-DRILL OR REPAIR WELL		SUBSEQUENT REPORT OF RE-DRILLING OR REPAIR	
NOTICE OF INTENTION TO SHOOT OR ACIDIZE		SUBSEQUENT REPORT OF ABANDONMENT	
NOTICE OF INTENTION TO PULL OR ALTER CASING		SUPPLEMENTARY WELL HISTORY	
NOTICE OF INTENTION TO ABANDON WELL			

(INDICATE ABOVE BY CHECK MARK NATURE OF REPORT, NOTICE, OR OTHER DATA)

August 1, 1962

Well No. Elliott 1-22 is located 860 ft. from SW line and 1620 ft. from W line of sec.

SE/4 SW/4 Section 22  
(1/4 Sec. and Sec. No.)

30N  
(Twp.)

11W  
(Range)

10PM  
(Meridian)

Basin - Dakota  
(Field)

San Juan  
(County or Subdivision)

New Mexico  
(State or Territory)

The elevation of the ground level above sea level is 5838 ft.

DETAILS OF WORK

(State names of and expected depths to objective sands; show sizes, weights, and lengths of proposed casings; indicate mudding jobs, cementing points, and all other important proposed work)

A 12 1/4" hole will be drilled to approximately 250' and 8 5/8" surface casing run and cemented with sufficient cement to circulate, approx. 150 sq. A 7 7/8" hole will then be drilled to a total depth of approximately 7000' and 4 1/2" casing run to total depth and cemented in two stages. The first stage cement will be brought up over the Point Lookout. A two stage tool will then be set below the Pictured Cliffs and cement brought up above the Fruitland Formation. The Dakota formation will then be selectively perforated and sand water fractured.

I understand that this plan of work must receive approval in writing by the Geological Survey before operations may be commenced.

Company Western Development Co.

Address 825 Petroleum Club Bldg.

Denver 2, Colorado

By Original signed by T. A. Dugan

Title Consulting Engineer

# NEW MEXICO OIL CONSERVATION COMMISSION

## Well Location and Acreage Dedication Plat

### SECTION A.

Date August 1, 1962

Operator Western Development Company Lease Killett  
Well No. 1-22 Unit Letter H Section 22 Township 30 North Range 11 West NMPM  
Located 860 Feet From South Line, 1620 Feet From West Line  
County San Juan G. L. Elevation 5838 Dedicated Acreage 320 Acres  
Name of Producing Formation Del Norte Pool Basin

1. Is the Operator the only owner\* in the dedicated acreage outlined on the plat below? Yes ☒ No ☐
2. If the answer to question One is "No," have the interests of all the owners been consolidated by communitization agreement or otherwise? Yes ☐ No ☐ If answer is "Yes," Type of Consolidation \_\_\_\_\_
3. If the answer to question Two is "No," list all the owners and their respective interests below:

OWNER

LAND DESCRIPTION



### SECTION B.

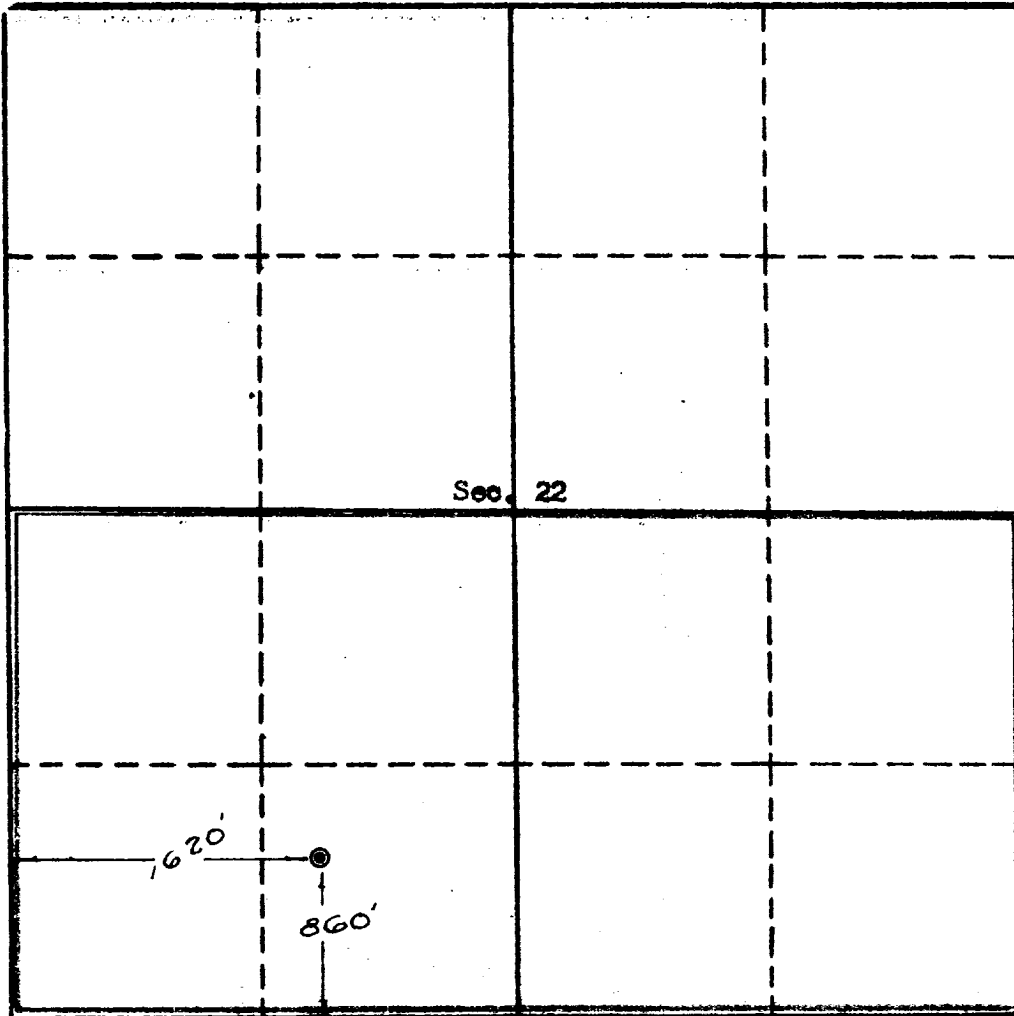

This is to certify that the information in Section A above is true and complete to the best of my knowledge and belief.

**Western Development Co.**

(OPERATOR)

Original signed by T. A. Dugan

(REPRESENTATIVE)

**709 Bloomfield Rd  
Farmington, New Mexico**

(ADDRESS)

This is to certify that the well location shown on the plat in Section B was plotted from field notes of actual surveys made by me or under my supervision and that the same is true and correct to the best of my knowledge and belief.

Date Surveyed July 21, 1962

**Four States Engineering Co.**  
FARMINGTON, NEW MEXICO

*Ernest T. Cochran*  
REGISTERED ENGINEER OR  
LAND SURVEYOR

Certificate No. 3602



